

## Equipment

### Coll-O-Crimp T-400-17



Refer to safety information regarding Coll-O-Crimp hose, hose fittings and assembly equipment compatibility on page 3.

#### Shop Press Tooling Packages

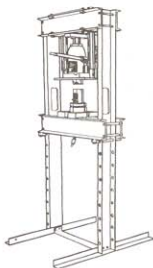

#### T-400-17 • Shop Press Tooling Package

The T-400-17 Shop Press Tooling Kit allows you to make factory-type hydraulic hose assemblies on your 25-ton shop press. With this minimum investment in equipment, and a nominal stock of packaged bulk hose and hose ends, you can begin to make Coll-O-Crimp hose assemblies in your own shop. This kit includes tooling to crimp 1/4" through 1" hose I.D. 'U' Series hose ends. Additional tooling is available to crimp 5/8" and 1-1/4" I.D. sizes.

#### Included in kit:

CATALOG NUMBER	DESCRIPTION
T-400-2C	'U' Series Collet – 1/4"
T-400-3C	'U' Series Collet – 3/8"
T-400-4C	'U' Series Collet – 1/2"
T-400-5C	'U' Series Collet – 3/4"
T-400-6C	'U' Series Collet – 1"
T-400-8	Die Ring – 3/16" thru 1-1/4"
T-400-10	Spacer Ring – Black
T-400-11	Spacer Ring – Silver
T-400-17P	Pusher
T-400-E	Shroud Decal
T-400-MSP	Instructions



#### WARNING

These kits are intended for use on shop presses not exceeding a 25-ton rating. Usage of presses exceeding this rating may result in damage to the pusher, causing metal fragments to spray which may result in serious bodily injury.

Reference pages 356-366 for Coll-O-Crimp tooling, tooling packages and pumps.

#### T-400-20A • Shop Press 757 "E" Series Tooling Package

The T-400-20A Shop Press 757 'E' Series Tooling Kit allows you to make factory-type air conditioning hose assemblies on your 25-ton shop press. With this minimum investment in equipment, and a nominal stock of packaged bulk hose and hose ends, you can begin to make Coll-O-Crimp hose assemblies in your own shop. This kit includes tooling to crimp all of the 757 'E' Series hose ends.

#### Included in kit:

CATALOG NUMBER	DESCRIPTION
T-400-114	757 'E' Series Collets
T-400-8	Die Ring Fits collets 3/16" thru 1-1/4"
T-400-10	Spacer Ring – Black
T-400-17P	Pusher
T-400-E	Shroud Decal
FS-3200	Label Set

## Equipment

### Air Conditioning Portable T-475



Refer to safety information regarding Coll-O-Crimp hose, hose fittings and assembly equipment compatibility on page 3.

#### T-475-1 • Portable Air Conditioning Press



This hand operated, lightweight and easy to use air conditioning press is engineered and designed specifically for use with Weatherhead 757 'E' series hose end fittings. Perfect for bench mounting this portable press is made of heavy duty construction for use with an air impact wrench. Uses color coded urethane

encased dies and a removable die holder to accommodate complicated shapes. Uses four standard die sizes (#6, #8, #10, and #12) that produce an OE style triple bubble crimp. No electrical requirements necessary.

**Capacity:** Crimps 2-braid dimension nylon barrier or reduced dia. hose

**Mounting:** Bench or Mount in Vise

**Weight:** 6 lbs.

Reference pages 356-367 for Coll-O-Crimp tooling, tooling packages and pumps.

Refer to safety information regarding Coll-O-Crimp crimping procedures on pages 324-328.

#### T-475 • Portable Air Conditioning Package



#### Package includes:

CATALOG NUMBER	DESCRIPTION
T-475-1	Portable A/C Press
T-475-105C	#6 Die Set - Brown
T-475-106C	#8 Die Set - Purple
T-475-107C	#10 Die Set - Almond
T-475-108C	#12 Die Set - White

Includes Bench Mount Flange, Die Set Lubricant and Steel Pipe Nipple Extension

Also includes a Custom Carrying Case with Instructions

## Equipment

### T-475-1 Crimping Procedure



Refer to safety information regarding Coll-O-Crimp hose, hose fittings and assembly equipment compatibility on page 3.

#### T-475-1 • Crimp Die Sets

1 Assembly (Part Number)

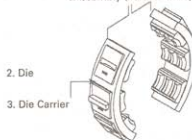

2 Die

3 Die Carrier

#### T-475-1 • Crimper Parts List

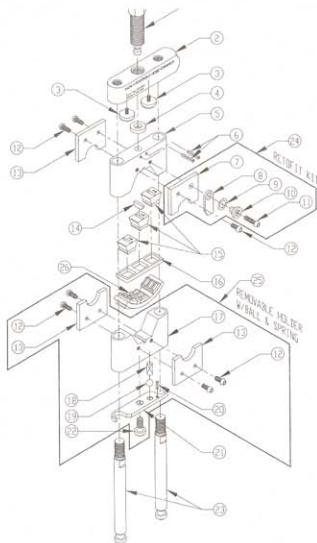

#### T-475-1 Die Set Info

ITEM	DESC.	QTY	6	8	10	12
1	Assembly Part No.	1 set	T-475-105C	T-475-106C	T-475-106C	T-475-107C
2	Die Marking	-	556	640	742	897
3	Die Carrier Color	-	Brown	Purple	Almond	White

For use with H757 Hose and 757 'E' Series Hose Ends

#### Parts List

ITEM	DESCRIPTION	QTY	PART NO.
1	Actuator Screw	1	75013
2	Actuator Bar	1	75001
3	Rubber Bumper	2	75012
4	Thrust Bushing	1	75011
5	Movable Die Holder	1	75005
6	3/16 x 1 Roll Pin	2	75010
7	Die Guide Block (Locator)*	1	75099
8	Locator Flag*	1	75086
9	Curved Disc Spring	1	75088
10	Locator Bushing	1	75087
11	1/4-20 x 1 Button Head Screw*	1	75113
12	1/4-20 x 5/8 Button Head Screw**(4)	7	75003
13	Die Guide Block**(2)	3	75002
17	Removable Die Holder**	1	75075
18	Spring-Compression**	1	75076
19	7/16 Dia. Ball**	1	75077
20	3/16 x 1/2 Roll Pin**	1	75009
21	Latch late	1	75074
22	Lock Screw**	1	75008
23	Strain Rod	2	75020
24	Retrofit it For Flag	1	75116
25	Removable Holder w/Ball & Spring	1	75081

#### Items Not Shown

ITEM	DESCRIPTION	QTY	PART NO.
A	5/32 Short Arm Hex Key	1	71731
B	Grease	1	75015
C	3/8 x 4 Pipe Nipple	1	75016
D	3/8 Flooring Flange	1	90607
E	Carrying Case	1	75017
F	Crimper Only (No Dies)	1	3700-1

\* Included in item 24 (Not assembled)

\*\* Included in item 25 (Assembled)

#### For use with H7575 Hose and 757 'E' Series Hose Ends.

ITEM	DESCRIPTION	QTY	6	8	10	12
-	Die Marking	-	556	640	742	897
26	Crimp Die No.	1 set	T-475-105C	T-475-106C	T-475-108C	T-475-108C
-	Color	-	Brown	Purple	Almond	White
16	Die Carrier	2	75134	75135	75136	75137
15	Die Segment	6	71741	75119	71743	71744

When ordering T-475-1 spare parts, contact: [www.atcoproductsinc.com](http://www.atcoproductsinc.com) or Email: [info@atcomail.com](mailto:info@atcomail.com) or call: 1-972-225-8178.

## Equipment

### T-475-1 Crimping Procedure

#### Model T-475 Portable Air Conditioning Hose Crimping Kit



#### Features

- Engineered and designed specifically for use with 757 'E' Series black, zinc finished Hose End Fittings
- Portable, hand operation
- OE style triple bubble crimp
- Heavy duty construction for use with air impact wrench
- Color coded, urethane encased dies
- Easy changeover from size to size
- Crimps 2 braid dimension nylon barrier or reduced diameter hose
- Four standard die sizes - #6, #8, #10, #12
- Capable of crimping under-hood applications
- Light weight for easy handling (less than 6 lbs)
- Removable die holder accommodates complicated shapes
- Unit can be bench mounted
- Shipped in a custom carrying case with instructions
- No electrical requirements
- U.S. Patent No. 5257525
- Made in U.S.A.

#### Operating Instructions for Model T-475-1 Air Conditioning Hose Crimper

##### General

The Model T-475-1 Crimper is a hand operated hose end crimping unit specifically designed for use with Weatherhead 757 'E' black, zinc finished Series hose ends. It is intended for use with Weatherhead H757 Air Conditioning hose.

The longer Weatherhead ferrule and triple bubble crimp of the T-475-1 insures a superior interface between the hose and the end fittings. In addition, the removable die holder allows for easy access in confined under-hood areas as well as for complicated end shapes.

crimped hoses, use only Weatherhead 757 'E' Series black, zinc finished hose and hose ends with this crimper.

The crimp dies included will crimp Weatherhead 757 'E' Series black hose ends onto Weatherhead H757 Air Conditioning hose. The dies are housed in replaceable, flexible, color coded polyurethane carriers (see crimp die set parts list on previous page for part numbers) for easy identification of crimp sizes.

#### CAUTION

To insure high quality

CATALOG NUMBER	HOSE NUMBER	COLOR	CRIMP DIAMETER
T-475-105C	H75706	Brown	.556
T-475-106C	H75708	Purple	.640
T-475-107C	H75710	Almond	.742
T-475-108C	H75712	White	.897

\*Refer to T-475-1 Crimper Parts List, page 323.

## Equipment

### T-475-1 Crimping Procedure

#### Model T-475 Portable Air Conditioning Hose Crimping Kit

##### Description of terms

The crimper can be operated with a 1/2" drive air impact wrench, ratchet or breaker bar. It takes approximately 100 foot pounds of torque to fully close the jaws and achieve a satisfactory crimp. The crimper can be bench mounted using the flange and pipe nipple provided or it can be mounted in a bench vise to stabilize the unit. If the unit is used a service vehicle with a mounted vise, it will be necessary to use a 12" minimum long extension to the pipe nipple to counteract the torque while closing the dies. This extension is not provided in the kit.

**Bench mount:** Bolt the flange to a bench top. Screw the pipe nipple and crimper to the flange plate.

**Impact wrench (1/2" DRIVE @ 100 PSIG MAX.):** Use a 1" impact socket to drive the movable die holder.

##### ⚠ CAUTION

Do not exceed 100 PSIG air pressure on the impact wrench as damage to the wrench and the crimper may result.

##### ⚠ CAUTION

Do not continue impacting after the dies are closed. This can cause damage to the crimper.

##### ⚠ CAUTION

Care should be taken when reversing the impact so that the die holder does not slam into the crimper body (actuator bar, Item 2). Bumpers are provided to minimize damage.

##### Ratchet or breaker bar:

Use a 1" socket to drive the movable die holder. It will take approximately 100 foot pounds of torque to achieve a full crimp.

##### Removable die holder:

The bottom of the crimper can be removed to accommodate special shapes or under-hood crimping. Push the latch plate (Item 21) open while holding the removable die holder. Pull the holder off the strain rods.

**Die change:** With the removable die holder removed, loosen two of the button head screws (Item B) on one side of the die holder. The die will drop out of the holder. Apply grease (Item B) to the slide surfaces. Squeeze the outer segments of the die set together and insert the die into the holder making sure that the woodruff key (Item 14) in the center segment snaps fully into the groove in the holder (Refer to Fig. 1).

While holding the die securely in the slot, retighten the two button head screws. Check to make sure that the two outer segments on each half are free to move. If they do not move freely, remove and inspect for damaged guide block pad or dirt.

##### ⚠ CAUTION

Retention of the woodruff key in the slot while tightening the screws is most important. Failure to do so will result in an irregular crimp and damage to the guide blocks and Woodruff Key (Refer to Fig 2).

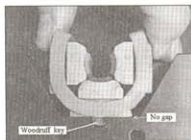

**Figure 1**  
Die carrier properly inserted in holder.

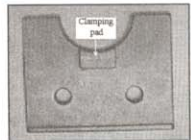

Undamaged Pad

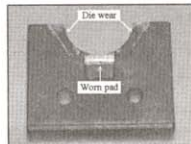

Damaged Pad

**Figure 2**

## Equipment

### T-475-1 Crimping Procedure



Refer to safety information regarding Coll-O-Crimp hose, hose fittings and assembly equipment compatibility on page 3.



Figure 3

Dies with woodruff keys in place.

#### ⚠ CAUTION

It is not necessary to over-tighten the screws. Always use the short hex key wrench provided in order to avoid damage.

#### Die Carrier:

The die carriers will become worn and produce unacceptable crimps with time. To replace the color coded die segment out of the back of the carrier. Reverse the process to assemble die segments in the new carrier.

**Woodruff Key:** The woodruff key is bonded into the slot in the center die segment. It is used to align the dies in the die holders (Refer to Fig. 3).

#### ⚠ CAUTION

If the woodruff key is not in the center segment of each half of the die set, an irregular crimp will be formed increasing the probability of leakage.

#### ⚠ CAUTION

Never use dies without woodruff key engaged in the slot of the segment and holder.

To replace the woodruff key, use a screwdriver and hammer to remove the old key. Replace the key using a drop of adhesive such as Loctite® to hold the key securely.

**Locator Flag:** There is a locator flag on the crimper. It is spring loaded and movable to locate the end of

the ferrule for proper crimp location. Swivel the flag to a position so that when the fitting is inserted into the crimper, the ferrule will stop in the proper location for crimping.

#### Crimp diameter

**measurement:** The crimp diameter can be measured by using a set of point micrometers or calipers with a point accessory kit installed. Standard measuring instruments will not reach to the crimp impression because of the pinch of the crimp. When measuring the crimp diameter, take three measurements around the center crimp ring. Add the measurements, divide by three to get the average. The average should be the target crimp diameter (+.015/-.005). Example: The #6 size is .556 target crimp diameter. The crimp should measure between .571 and .551 (Refer to Fig 4).

**Hose Wall Thickness:** The hose wall thicknesses for one braid dimension hoses are listed below. It is important to check the hose wall thickness to make sure that the crimp will be leak free.

HOSE SIZE	HOSE O.D.
#6 - 5/16 I.D.	9/16
#8 - 13/32 I.D.	11/16
#10 - 1/2 I.D.	3/4
#12 - 5/8 I.D.	15/16

#### Operation

1. Mount the crimper as described previously unless it is necessary to mount it in the vice on the service vehicle.

2. Select the proper size dies. Check all segments to make sure that all of the segments have the same numbers on the back. Each segment will be marked identifying the hose size and crimp diameter. Example: 5/16 ID hose with a .556 diameter crimp will be marked "556" (Refer to Fig. 3).
3. Lubricate the slides of the crimper die holders (Items 5 and 17) and the screw thread (Item 1) with an appropriate grease (Item B).
4. Refer to die change outlined above for proper assembly of the dies into the crimper.
5. Position the locator flag (Item 8) so the ferrule of the fitting bumps it on the side when inserted into the crimper.

#### ⚠ CAUTION

Do not locate from the bead on the fitting. This will result in the wrong crimp location.

6. Insert the hose into the fitting making sure that the hose appears in the small inspection hole on the side or end of the ferrule.

#### ⚠ CAUTION

If the hose does not appear in the inspection hole, a poor crimp may result.



Position of tip of micrometer.

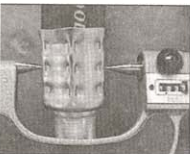

Measuring the crimp with a micrometer.

Figure 4

Loctite® is a registered trademark of Loctite Corporation.

## Equipment

### T-475-1 Crimping Procedure

 Refer to safety information regarding Coil-O-Crimp hose, hose fittings and assembly equipment compatibility on page 3.

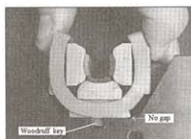

Figure 5

Crimp head completely closed.

\*Refer to T-475-1 Crimper Parts List, page 323.

7. Place the assembly into the crimper and hold it against the locator flag. Only the ferrule should touch the flag. Operate the screw (Item 1) to close the dies to the full closed position. This will provide the proper compression to achieve a leak free crimp. When the crimp dies are bottomed out, there will be a slight gap between the two die holders (Items 5 & 17). This insures that the dies are fully closed before the holders bottom out (Refer to Fig. 5).

8. Reverse the screw (Item 1) to release the crimper from the hose assembly. Take care not to drive the die holder (Item 5) against the actuator bar (Item 2) as damage to the crimper may result. The bumpers (Item 3) are provided as

a cushion to help prevent this from occurring.

9. If the crimp is performed under-hood or the fitting is a complicated shape that requires disassembly of the crimper, open the latch plate (Item 21) and remove the die holder (Item 17).

10. Inspect the first crimp to make sure that the correct dies were used, the crimp location is correct, the crimp is uniform and there is no internal deformation of the fitting.

**Note:** Some hose materials trap air in the hose layers during manufacture. When leak testing a newly pressurized hose using soap bubbles or water submersion, the air in the hose will bleed out at the fitting and hose interface indicating a false leaking condition. Leave the

hose pressurized for one hour and retest. The residual air should completely bleed out and no leak will be visible.

#### Crimper Maintenance

1. Clean and lubricate all moving parts. Use an appropriate grease (Item B) as needed when lubricating.
2. Inspect the strain rods and latch plate for wear around the contact points.
3. Make sure the actuator screw turns freely. Lubricate as noted above.
4. Check for worn or torn die carriers. Replace when crimp appears to go out of round.
5. Inspect woodruff keys. Replace if they are damaged or missing to insure good crimps.

#### Troubleshooting

PROBLEM	CAUSE	ACTION
1. Oblong or irregular crimp	<ul style="list-style-type: none"><li>• Worn carriers</li><li>• One die segment in the set is the wrong size</li><li>• Woodruff key missing</li><li>• Guide blocks installed backwards</li></ul>	<ul style="list-style-type: none"><li>• Replace carriers</li><li>• Check all segments for correct size on back of die</li><li>• Replace key</li><li>• Turn guide blocks around so raised pad clamps on die</li></ul>
2. Crimp diameter too large	<ul style="list-style-type: none"><li>• Crimper not fully closed – refer to instructions</li><li>• Incorrect size dies</li></ul>	<ul style="list-style-type: none"><li>• Recrimp until dies fully close</li><li>• Replace with correct size</li></ul>
3. Crimp diameter too small	<ul style="list-style-type: none"><li>• Incorrect size dies</li></ul>	<ul style="list-style-type: none"><li>• Replace with correct size</li></ul>
4. Crimp location too close to closed end of ferrule	<ul style="list-style-type: none"><li>• Ferrule not inserted far enough into crimper</li></ul>	<ul style="list-style-type: none"><li>• Use locator flag to properly locate ferrule position</li></ul>
5. Crimp location too close to hose	<ul style="list-style-type: none"><li>• Ferrule inserted too far into crimper (past locator flag)</li></ul>	<ul style="list-style-type: none"><li>• Use locator flag to properly locate ferrule position</li></ul>
6. Crimped fitting leaks when tested with soap bubbles	<ul style="list-style-type: none"><li>• Air trapped in the hose during manufacture</li><li>• Insufficient crimp</li><li>• Hose wall thickness is undersize (see chart)</li><li>• Fitting is defective</li></ul>	<ul style="list-style-type: none"><li>• Recheck after system has been charged for one hour – air will bleed out of the hose</li><li>• Check crimp diameter</li><li>• Recrimp with .030 undersize die</li><li>• Replace fitting/recrimp</li></ul>
7. Crimped fitting leaks when tested with electronic leak detector	<ul style="list-style-type: none"><li>• Insufficient crimp</li><li>• Hose wall thickness</li></ul>	<ul style="list-style-type: none"><li>• Check crimp diameter</li><li>• Recrimp with .030</li></ul>

## Equipment

### T-475-1 Crimping Procedure

#### T-475-1 • Crimping Procedure

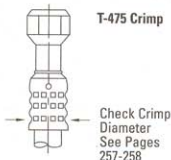
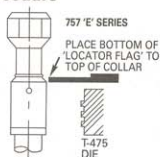

#### Coll-O-Crimp Crimping Procedure

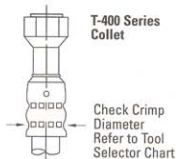
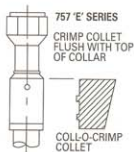

#### 757 Hose Ends

Listed to the right are certain 757 style hose ends that require the use of designated Coll-O-Crimp systems. As noted, removal of the protective cap covering on the charge port may be necessary.

CATALOG NUMBER	HOSE END DESCRIPTION	T-400, T-407	T-420	T-460, T-410, T-440T	T-462 T-465	T-480
75708E-Z99	-8, 90deg, w/Charge Port	YES/WC	YES/WC	YES/WC	YES/WC	YES/WC
75710E-Z01	-10, 90deg, w/Charge Port	YES/WC	NO	YES/WC	YES/WC	YES/WC
75712E-Z01	-12, 90deg, w/Charge Port	YES/WC	NO	YES/WC	YES/WC	YES/WC
75706E-Y36	Splicer, -6 to -6	YES	YES	YES	YES	YES
75708E-Y38	Splicer, -8 to -8	YES	YES	YES	YES	YES
75710E-Y40	Splicer, -10 to -10	NO	YES	YES	YES	YES
75712E-Y41	Splicer, -12 to -12	NO	YES	YES	NO	YES
75706E-Y38	Splicer, -6 to -8	YES	YES	YES	YES	YES
75708E-Y40	Splicer, -8 to -12	YES	YES	YES	YES	YES
75710E-Y41	Splicer, -10 to -12	NO	YES	YES	NO	YES
75706E-Y47	Splicer, -6 to -6 w/Charge Port	NO	YES	YES	NO	YES
75708E-Y48	Splicer, -8 to -8 w/Charge Port	NO	YES	YES	NO	YES
75710E-Y49	Splicer, -10 to -10 w/Charge Port	NO	YES	YES	NO	YES
75712E-Y50	Splicer, -12 to -12 w/Charge Port	NO	YES	YES	NO	NO

WOC indicates without protective cap.

WC indicates with protective cap.

#### Nominal Crimp Diameter Measurement

Measuring crimp diameters should be a part of the normal hose assembly procedure. To insure a proper crimp diameter reading, follow these steps.

1. Measure the diameter in the middle of crimped portion of the hose end.
2. Place the caliper in a position to allow a measurement across the pressed (flat) portion of the crimp.

**Note:** When using T-475 system, the bubble style crimp will have three annular rings compared to two when crimped with the T-400 series collets.

#### Nominal Crimp Diameter Measurement

Measuring crimp diameters should be a part of the normal hose assembly procedure. To insure a proper crimp diameter reading, follow these steps.

1. Measure the diameter in the middle of crimped portion of the hose end.
2. Place the caliper in a position to allow a measurement across the pressed (flat) portion of the crimp.

**Note:** When using T-400 C-O-C system, the bubble style crimp will have two annular rings compared to three when crimped with the T-475 die set.



## Equipment

### Coll-O-Crimp Portable T-465



Refer to safety information regarding Coll-O-Crimp hose, hose fittings and assembly equipment compatibility on page 3.

#### Portable Coll-O-Crimp



Reference pages 356-366 for Coll-O-Crimp tooling, tooling packages and pumps.

Refer to safety information regarding Coll-O-Crimp crimping procedures on page 331.

The Portable Coll-O-Crimp is a completely PORTABLE hose assembly system. NO ELECTRICAL POWER SOURCE IS NEEDED. Hand pump powered, lightweight, vise or stand mounted, this crimper is ideal for your portable crimping needs.

**Capacity:** 3/16" I.D. 1 fiber braid through 1-3/8" I.D. 1 wire hose and 1-1/4" 2 wire hose

#### Mounting: Vise/Stand

Size: 12-1/2" high, 8-1/2" wide, 5-1/2" deep

**Weight:** 31 lbs.

The vise bracket, die ring, pusher, decal and instruction kit are components of the T-465 Portable Coll-O-Crimp Press.

**Pump Required (sold separately):** T-460-2

T-465 • Portable Coll-O-Crimp Press ONLY



#### CAUTION

Use T-460-2 10,000 PSI hand pump only.



#### CAUTION

The Coll-O-Crimp power source has the pressure relief valve set at 10000 PSI. Damage to the press will result if higher pressures are used and warranty will be voided.

#### T-465-HP • Portable Coll-O-Crimp Package

Includes one each of the following:

CATALOG NUMBER	DESCRIPTION
T-465	Portable Coll-O-Crimp Press
T-460-2	Hand Pump (10,000 PSI)
T-450-3	Quick Disconnect Hose Assembly

For replacement pump see page 363-365.

#### T-465 HPU • Portable Coll-O-Crimp Package

Includes one each of the following:

CATALOG NUMBER	DESCRIPTION
T-465-HP	Portable Coll-O-Crimp Package
T-400-2C	'U' Series Collet - 1/4"
T-400-3C	'U' Series Collet - 3/8"
T-400-4C	'U' Series Collet - 1/2"
T-400-10	Black Spacer Ring
T-400-62	Yellow Spacer Ring

#### T-465-HP80 • Portable Coll-O-Crimp Package

Includes one each of the following:

CATALOG NUMBER	DESCRIPTION
T-465-HP	See above for contents.
T-80	Coll-O-Cut Portable Saw

#### T-465 HPU80 • Portable Coll-O-Crimp Package

Includes one each of the following:

CATALOG NUMBER	DESCRIPTION
T-465-HPU	See above for contents.
T-80	Coll-O-Cut Portable Saw

## Equipment

### Coll-O-Crimp Portable T-465



Refer to safety information regarding Coll-O-Crimp hose, hose fittings and assembly equipment compatibility on page 3.

#### T-450-C • Portable Coll-O-Crimp Stand



The T-450-C Stand is designed specifically for your Portable Coll-O-Crimp, T-465 Press. This stand allows you to use your press on a work bench or other flat surface without the need of a vise. Simply bolt the press onto the stand with the supplied bolts, and you're ready to make Coll-O-Crimp Hose Assemblies.

Refer below for repair and replacement items.

#### T-465-TB • Portable Coll-O-Crimp Tool Boxes



The T-465-TB tool boxes feature convenient press, pump and collet storage while offering easy mobility of your hose assembly equipment. Supplied as a set, the T-465-TB tool boxes are an excellent addition to the portable Coll-O-Crimp System.

Refer below for repair and replacement items.

#### Includes one each:

CATALOG NUMBER	DESCRIPTION
T-460-10B	Small Tool Box Stores the T-465 and spacer rings. 15" x 9" x 8".
T-460-10BB	Large Tool Box Stores the T-460-2 and collets. 25" x 10" x 8".

#### T-450/T-465 Portable Coll-O-Crimp Repair and Replacement Items

CATALOG NUMBER	DESCRIPTION
T-450-D1	Spacer Ring Selector Decal for Nylon Hose (H009, H209, H243, H435 and H436)
T-450-P	Pusher
T-450-Q	Quick Disconnect Coupling
T-450K	Pusher and Retainer Plate Repair Kit. Includes: T-450B Pusher bolt (1) T-450R Retainer plate (1) T-450S Retainer plate screw (2)
T-465-E	Shroud Decal

## Equipment

### T-465-1 Crimping Procedure

#### WARNING

You must hold the hose assembly in place from below throughout the crimping operation. Do not place fingers or hands at the crimping point during operation. Failure to follow this procedure could result in serious injury to your hand or finger.



1. Clamp the crimper into a vise or mount to a work bench using the mounting bracket.
2. Remove pusher and insert proper size collet halves.



3. Select proper Coll-O-Crimp hose and end fitting. Insert hose into end fitting.

**IMPORTANT:** Make sure hose is bottomed on end fitting.



4. Insert hose assembly from below between the collet halves. Align dimples on hose end with top of collet. When crimping 229 'P', 265 'P', 338 'P' or H757 'E' Series hose ends, align top of collar on hose end with top surface of collet.



5. Reference Tool Selector Chart for proper spacer ring. Place appropriate spacer ring, with proper side up, on top of collet.



6. Replace pusher by hanging it from ramplate with bolt on top. Slide it back for centering. Close valve on hand pump and start pumping to crimp.



7. When spacer ring contacts die ring, the crimp is complete. Open valve on hand pump. Allow the ram and pusher to retract.
8. Remove pusher and spacer ring. Remove crimped assembly from below through the collet halves. Visually inspect the crimped end.
9. To insure a proper crimp has been completed, measure the nominal crimp diameter. Refer to Hose End and Tool Selector Chart in the back of this catalog for procedure and crimp diameters.

## Equipment

### Coll-O-Crimp Portable T-460 & T-462



Refer to safety information regarding Coll-O-Crimp hose, hose fittings and assembly equipment compatibility on page 3.

#### T-464 • Portable Coll-O-Crimp



For T-460 Tool Box see page 374.

Refer to pages 355-366 for Coll-O-Crimp tooling, tooling packages and pumps.

Refer to safety information regarding Coll-O-Crimp crimping procedures on pages 333-334.

The T-460 is a completely portable hose assembly system. Lightweight, hand pump powered, and complete with a self-supporting base, this crimping press features layback positioning up to a 45° angle.

**Capacity:** 3/16" I.D. 1 fiber braid through 1-3/8" I.D. 1 wire hose and 1-1/4" 2 wire hose.

**Mounting:** Free standing base

**Size:** 15" high, 14" wide, 11-1/4" deep

**Weight:** 62 lbs.

#### T-466 • Portable Coll-O-Crimp



For T-462 Tool Box see page 373.

Refer to pages 356-366 for Coll-O-Crimp tooling, tooling packages and pumps.

Refer to safety information regarding Coll-O-Crimp crimping procedures on pages 333-334.

This portable Coll-O-Crimp features an air/hydraulic pump making it the ideal system if you have the availability of compressed air in your shop or in the field via a portable compressor.

**Capacity:** 3/16" I.D. 1 fiber braid through 1-3/8" I.D. 1 wire hose and 1-1/4" 2 wire hose.

**Mounting:** Free standing base

**Size:** 15" high, 14" wide, 11-1/4" deep

**Weight:** 62 lbs.

#### T-464 • Portable Coll-O-Crimp Package

Includes one each of the following:

CATALOG NUMBER	DESCRIPTION
T-460	Portable Coll-O-Crimp Press, Hand Pump & Hose Assembly Kit, T-460-M Instructions
T-400-2C	'U' Series Collet - 1/4"
T-400-3C	'U' Series Collet - 3/8"
T-400-4C	'U' Series Collet - 1/2"
T-400-10	Black Spacer Ring
T-400-62	Yellow Spacer Ring

#### Repair and Replacement Items

CATALOG NUMBER	DESCRIPTION	CATALOG NUMBER	DESCRIPTION
T-460-M	Instructions	T-460-P	Pusher
T-460-SPR	Slide Pull Rod	T-460-SF	Slide Flange
T-460-16	Hose Assembly	T-460-SP	Slide Plate
T-460-2	Hand Pump	T-460-SPK	Slide Pull Knob
T-460-E	Shroud Decal		

For replacement pump see page 363-365.

#### T-466 • Portable Coll-O-Crimp Package

Includes one each of the following:

CATALOG NUMBER	DESCRIPTION
T-462	Portable Coll-O-Crimp Press, Air/Hydraulic Pump & Hose Assembly Kit, T-460-M Instructions
T-400-2C	'U' Series Collet - 1/4"
T-400-3C	'U' Series Collet - 3/8"
T-400-4C	'U' Series Collet - 1/2"
T-400-10	Black Spacer Ring
T-400-62	Yellow Spacer Ring

#### Repair and Replacement Items

CATALOG NUMBER	DESCRIPTION	CATALOG NUMBER	DESCRIPTION
T-460-M	Instructions	T-460-SPK	Slide Pull Knob
T-460-P	Pusher	T-460-SPR	Slide Pull Rod
T-460-SF	Slide Flange	T-462-16	Hose Assembly
T-460-SP	Slide Plate	T-462-V	Regulator only
T-462-E	Shroud Decal	T-462-2	Air/Hydraulic Pump
140-06675	Air Regulator Kit		

For replacement pump see page 363-365.

## Equipment

### T-460 Crimping Procedure



Refer to safety information regarding Coll-O-Crimp hose, hose fittings and assembly equipment compatibility on page 3.



#### WARNING

You must hold the hose assembly in place from below throughout the crimping operation. Do not place fingers or hands at the crimping point during operation. Failure to follow this procedure could result in serious injury to your hand or finger.



1. Slide pusher to back of machine and insert proper size collet halves.

**Note:** Lubricate tapered cone seat with Lubriplate grease or equivalent before any crimping is done. Continued periodic lubrication is recommended.



2. Select proper Coll-O-Crimp hose end fitting. Insert hose into end fitting.

**IMPORTANT:** Make sure hose is bottomed in end fitting.



3. Insert hose assembly from below between the collet halves. Align dimples on hose end with top of collet. When crimping 229 'P', 265 'P', 338 'P' and 757 'E' Series hose ends, align top of collar on hose end with top surface of collet.



4. Refer to Tool Selector Chart for proper spacer ring. Place appropriate spacer ring, with proper side up, on top of collet. Hold uncrimped hose assembly in place throughout crimping operation.



5. Pull the pusher positioning handle as far forward as it will go. The pusher will now be in the proper position for crimping. Close valve located on rear of hand pump and start pumping to crimp.



6. When spacer ring contacts die ring, the crimp is complete. Open control valve on hand pump. Allow the ram and pusher to retract.

Slide pusher clear and remove spacer ring. Remove crimped assembly from below through the collet halves. Visually inspect the crimped end. To insure a proper crimp has been completed, measure the nominal crimp diameter. Refer to Hose End and Tool Selector Chart in the back of this catalog for nominal crimp diameters of finished assemblies.

## Equipment

### T-462 Crimping Procedure



Refer to safety information regarding Coll-O-Crimp hose, hose fittings and assembly equipment compatibility on page 3.



#### WARNING

You must hold the hose assembly in place from below throughout the crimping operation. Do not place fingers or hands at the crimping point during operation. Failure to follow this procedure could result in serious injury to your hand or finger.



1. Slide pusher to back of machine and insert proper size collet halves.

**Note:** Lubricate tapered cone seat with Lubriplate grease or equivalent before any crimping is done. Continued periodic lubrication is recommended.



2. Select proper Coll-O-Crimp hose end fitting. Insert hose into end fitting.

**IMPORTANT:** Make sure hose is bottomed in end fitting.



3. Insert hose assembly from below between the collet halves. Align dimples on hose end with top of collet. When crimping 229 'P', 265 'P', 338 'P' and 757 'E' Series hose ends, align top of collar on hose end with top surface of collet.



4. Refer to spacer ring selector chart located in the back of this catalog. Place appropriate spacer ring, with proper side up, on top of collet. Hold uncrimped hose assembly in place throughout crimping operation.



5. Holding the uncrimped hose assembly in place throughout the crimping operation, pull the pusher positioning handle as far forward as it will go. The pusher will now be in the proper position for crimping. Hold down on activation button and start crimping.



6. When spacer ring contacts die ring, the crimp is complete. Hold the red lever down to allow the pusher to retract. Slide pusher clear and remove spacer ring. Remove crimped assembly from below through the collet halves. Visually inspect the crimped end. To insure a proper crimp has been completed, measure the nominal crimp diameter. Refer to Hose End and Tool Selector Chart in back of catalog for nominal crimp diameters of finished assemblies.

## Equipment

### Coll-O-Crimp Portable T-480



Refer to safety information regarding Coll-O-Crimp hose, hose fittings and assembly equipment compatibility on page 3.

#### T-480-HP • Portable Coll-O-Crimp Press & Hand Pump Package



Refer to pages 356-367 for Coll-O-Crimp tooling, tooling packages and pumps.

Refer to safety information regarding Coll-O-Crimp crimping procedures on page 338.

Make factory-type hose assemblies anywhere-anytime! Versatile and portable, this package offers the ease of use you are looking for in a Coll-O-Crimp hose assembly system. The T-480 Coll-O-Crimp Press packages are offered in four options. Listed below are press/power unit packages.

For cabinets see page 370-373 (not included).

**Capacity:** 3/16" I.D. 1 fiber braid through 1-1/4" I.D. 6 spiral hose

**Mounting:** Free Standing Base

**Size:** 22-1/2" high, 14" long, 10-1/2" wide

**Total Weight:** 112 lbs.

#### T-480-AH • Portable Coll-O-Crimp Press & Air/Hydraulic Pump Package



Refer to pages 356-366 for Coll-O-Crimp tooling, tooling packages and pumps.

Refer to safety information regarding Coll-O-Crimp crimping procedures on page 339.

**Capacity:** 3/16" I.D. 1 fiber braid through 1-1/4" I.D. 6 spiral hose

**Mounting:** Free Standing Base

**Size:** 22-1/2" high, 14" long, 10-1/2" wide

**Total Weight:** 124 lbs.

#### T-480-2 Pump Specifications:

**Dimensions:** 7-3/16" high, 21-1/64" long, 4-3/4" wide

**Pressure:** 0-10,000 psi

**Outlet Port Size:** 3/8" NPT

**Hydraulic Oil:** Enerpac

**Reservoir Capacity:** 55 cu. in.

Includes T-480-68 blue pusher extension ring to be used with T-480 Portable Coll-O-Crimp and the T-420 collets only.

For replacement pump see page 363-366.

#### T-482-2 Pump Specifications:

**Dimensions:** 5" high, 14-5/8" long, 5-5/8" wide

**Pressure:** 0-10,000 psi

**Outlet Port Size:** 3/8" NPT

**Inlet Port:** 1/4" NPT

**Pump Inlet Air Pressure:** 60-100 psi

**Hydraulic Oil:** Enerpac

**Reservoir Capacity:** 36 cu. in.

Includes T-480-68 blue pusher extension ring to be used with T-480 Portable Coll-O-Crimp and the T-420 collets only.

**Note:** It is recommended that a filter, regulator, lubricator, and air pressure gauge be installed upstream from the pump. Filter, regulator and lubricator units are not included.

For replacement pump see page 363-366.

## Equipment

### Coll-O-Crimp Portable T-480



Refer to safety information regarding Coll-O-Crimp hose, hose fittings and assembly equipment compatibility on page 3.

#### T-480-TA • Portable Coll-O-Crimp Press & Turbo Air/Hydraulic Pump Package



Reference pages 356-367 for Coll-O-Crimp tooling, tooling packages and pumps.

Refer to safety information regarding Coll-O-Crimp crimping procedures on page 340.

**Capacity:** 3/16" I.D. 1 fiber braid through 1-1/4" I.D. 6 spiral hose

**Mounting:** Free Standing Base

**Size:** 22-1/2" high, 14" long, 10-1/2" wide

**Total Weight:** 116 lbs.

#### T-480-3 Pump

##### Specifications:

**Dimensions:** 8-1/4" high, 12-3/8" long, 8" wide

**Pressure:** 0-10,000 psi

**Outlet Port Size:** 3/8" NPT

**Inlet Port:** 1/4" NPT

**Pump Inlet Air Pressure:** 40-150 psi

**Hydraulic Oil:** Enerpac

**Reservoir Capacity:** 150 cu. in.

Includes T-480-68 blue pusher extension ring to be used with T-480 Portable Coll-O-Crimp and the T-420 collets only.

**Note:** It is recommended that a filter, regulator, lubricator, and air pressure gauge be installed upstream from the pump. Filter, regulator and lubricator units are not included.

For replacement pump see page 363-366.

#### T-480-EP • Portable Coll-O-Crimp Press & 110v Electric Pump Package



Reference pages 356-367 for Coll-O-Crimp tooling, tooling packages and pumps.

Refer to safety information regarding Coll-O-Crimp crimping procedures on page 340.

**Capacity:** 3/16" I.D. 1 fiber braid through 1-1/4" I.D. 6 spiral hose

**Mounting:** Free Standing Base

**Size:** 22-1/2" high, 14" long, 10-1/2" wide

**Total Weight:** 134 lbs.

#### T-481-110 Pump

##### Specifications:

**Electrical Power Source:** 15amp, 110v grounded 1Ph 50/60HZ

**Dimensions:** 14-1/4" high, 9-5/8" long, 9-5/8" wide

**Pressure:** 0-10,000 psi

**Outlet Port Size:** 3/8" NPT

**Hydraulic Oil:** Enerpac

**Reservoir Capacity:** 115.5 cu. in.

**Flow:** .5 to 1.0 gpm

**Motor Rating:** 1/2 hp universal, 9 amps at 10,000 psi

Includes T-480-68 blue pusher extension ring to be used with T-480 Portable Coll-O-Crimp and the T-420 collets only.

For replacement pump see page 363-366.



## Equipment

### Coll-O-Crimp Portable T-480

 Refer to safety information regarding Coll-O-Crimp hose, hose fittings and assembly equipment compatibility on page 3.

#### T-480 • Portable Coll-O-Crimp Repair & Replacement Items

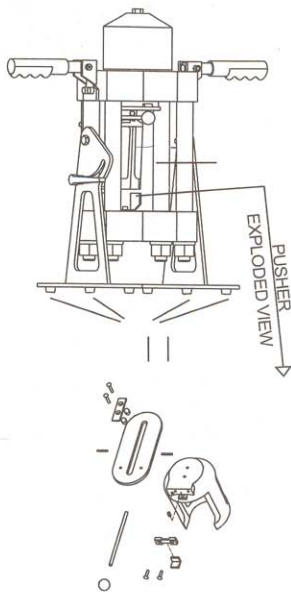

CATALOG NUMBER	DESCRIPTION
T-480-P	Pusher
T-480-PSK	Pusher Stop Repair Kit (Includes pusher clip, 2 machine screws, pusher stop & spring)
T-480-SP	Slider Plate
140-05485-01	Roll Pin
T-480-SFK	Slide Flange Kit (Includes slide flange, 2 bushings & 2 machine screws)
T-480-SPR	Slide Pull Rod
T-480-SPK	Slide Pull Knob
140-06601	Vinyl Grip
T-480-TBK	Tilt Bracket Knob
140-06894	Foot Pad
T-480-69	Tool Locator Bracket
T-480-16	10,000 PSI replacement hose assembly for 480-HP
T-480-17	10,000 PSI replacement hose assembly for T-480-TA and T-480-EP
T-480-18	10,000 PSI replacement hose assembly for 480-AH
140-06906	Hydraulic Quick Coupler used with the T-480-TA and T-480-EP System
T-480-3	Turbo Air/Hydraulic replacement pump for T-480-TA System
T-481-110	Electric replacement pump for T-480-EP System
T-480-2	Hand replacement pump for T-480-HP System
T-482-2	Air/Hydraulic replacement pump for T-480-AH System
T-480-E	Shroud Decal
T-480-M	Set-up & Operating Guide for T-480 System

## Equipment

### Portable T-480-HP Crimping Procedure

#### WARNING

You must hold the hose assembly in place from below throughout the crimping operation. Do not place fingers or hands at the crimping point during operation. Failure to follow this procedure could result in serious injury to your hand or finger.

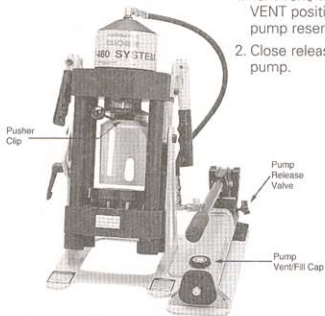

1. Turn vent/ fill cap to VENT position to vent pump reservoir.
2. Close release valve on pump.



**Note:** Periodically lubricate die cavity with Weatherhead T-400-G lubricant.

3. Release the pusher clip and slide pusher back.
4. Select the proper Weatherhead hose, end fittings, and tooling (refer to the Hose End and Tool Selector Chart). Insert the hose into the end fitting, making sure that the hose is bottomed in end fitting.



5. Loosen knob and tilt press as necessary. Insert one end of hose assembly from below the base plate and between the collet halves. Align knurl on end fitting with top of collet, making sure that collet halves are evenly aligned.
6. Holding uncrimped hose assembly in place, position T-480-68 blue pusher extension ring on top of collet.
7. Slide pusher forward, making sure pusher clip has locked.
8. Operate pump handle until T-480-68 blue pusher extension ring contacts the base plate, indicating that the crimp is complete. Open the RELEASE valve to retract pusher. Release the pusher clip and slide the pusher back. Remove the blue pusher extension ring from top of collet and then the crimped hose assembly from below.

**Note:** Visually inspect the crimped end. Measure the nominal crimp diameter and verify that the crimp is within 1/16" from the locating knurl on the collar, see figure C, page 342.

#### FOR T-400 TOOLING

**Note:** The T-480-68 blue extension ring is NOT used with T-400 tooling.

9. When crimping with Coll-O-Crimp I tooling the procedure is the same except;
  - a. Insert the T-420-25 adapter die ring into the base plate die cavity.
  - b. Periodically lubricate the T-420-25 adapter die ring or base plate die cavity.
  - c. Use T-400 collets and spacer rings.
  - d. Align dimples on the end fitting with top of collet. When crimping 229 'P', 265 'P', 338 'P' and 757 'E' Series hose ends, align top of collar on hose end with top surface of collet.

## Equipment

### Portable T-480-AH Crimping Procedure

#### WARNING

You must hold the hose assembly in place from below throughout the crimping operation. Do not place fingers or hands at the crimping point during operation. Failure to follow this procedure could result in serious injury to your hand or finger.

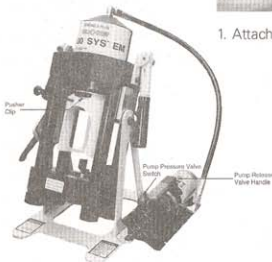

1. Attach air supply to pump.



- Note:** Periodically lubricate the die ring with Weatherhead T-400-G lubricant.
2. Release the pusher clip and slide pusher back.
  3. Select the proper Weatherhead hose, end fittings and tooling (refer to Hose End and Tool Selector Chart). Insert the hose into the end fitting, making sure that the hose is bottomed in end fitting.



4. Loosen knob and tilt press as necessary. Insert one end of hose assembly from below the base plate and between the collet halves. Align knurl on end fitting with top of collet, making sure that collet halves are evenly aligned.
5. Holding uncrimped hose assembly in place, position T-480-68 blue extension ring on top of collet.
6. Slide pusher forward, making sure pusher clip has locked.

7. Press ACTIVATION button and hold until T-480-68 blue pusher extension ring contacts the base plate, indicating that the crimp is complete. Depress PRESSURE valve to retract pusher. Release the pusher clip and slide the pusher back. Remove the blue pusher extension ring from top of collet and then crimped hose assembly from below.

**Note:** Visually inspect the crimped end. Measure the nominal crimp diameter and verify that the crimp is within 1/16" from the locating knurl on the collar, see figure C, page 342.

#### FOR T-400 TOOLING

**Note:** The T-480-68 blue extension ring is NOT used with T-400 tooling.

8. When crimping with Coll-O-Crimp I tooling the procedure is the same except;
  - a. Insert the T-420-25 adapter die ring into the base plate die cavity.
  - b. Periodically lubricate the T-420-25 adapter die ring or base plate die cavity.
  - c. Use T-400 collets and spacer rings.
  - d. Align dimples on the end fitting with top of collet. When crimping 229 'P', 265 'P', 338 'P' and 757 'E' Series hose ends, align top of collar on hose end with top surface of collet.

## Equipment

### Portable T-480-TA Crimping Procedure

#### WARNING

You must hold the hose assembly in place from below throughout the crimping operation. Do not place fingers or hands at the crimping point during operation. Failure to follow this procedure could result in serious injury to your hand or finger.



1. Connect hose assembly to pump and crimper.
2. Attach air supply to pump.
3. Vent pump by opening vent screw 1-2 turns.



- Note:** Periodically lubricate the die ring with Weatherhead T-400-G lubricant.
4. Release the pusher clip and slide pusher back.
  5. Select the proper Weatherhead hose, end fittings and tooling (refer to Hose End and Tool Selector Chart). Insert the hose into the end fitting, making sure that the hose is bottomed in end fitting.



6. Loosen knob and tilt press as necessary. Insert one end of hose assembly from below the base plate and between the collet halves. Align knurl on end fitting with top of collet, making sure that collet halves are evenly aligned.



7. Holding uncrimped hose assembly in place, position T-480-68 blue extension ring on top of collet.
8. Slide pusher forward, making sure pusher clip has locked.



9. Depress the PRESSURE end of treadle and hold until T-480-68 blue pusher extension ring contacts the base plate, indicating that the crimp is complete. Depress the RELEASE end of treadle to retract pusher. Release the pusher clip and slide the pusher back. Remove the blue pusher extension ring from top of collet and then the crimped hose assembly from below.

**Note:** Visually inspect the crimped end. Measure the nominal crimp diameter and verify that the crimp is within 1/16" from the locating knurl on the collar, see figure C, page 342.

#### FORT-400 TOOLING

**Note:** The T-480-68 blue extension ring is NOT used with T-400 tooling.

10. When crimping with Coll-O-Crimp I tooling the procedure is the same except:
  - a. Insert the T-420-25 adapter die ring into the base plate die cavity.
  - b. Periodically lubricate the T-420-25 adapter die ring or base plate die cavity.
  - c. Use T-400 collets and spacer rings.
  - d. Align dimples on the end fitting with top of collet. When crimping 229 'P', 265 'P', 338 'P' and 757 'E' Series hose ends, align top of collar on hose end with top surface of collet.

## Equipment

### Portable T-480-EP Crimping Procedure

#### WARNING

You must hold the hose assembly in place from below throughout the crimping operation. Do not place fingers or hands at the crimping point during operation. Failure to follow this procedure could result in serious injury to your hand or finger.



1. Connect hose assembly to pump and crimper. Check all connections to be sure they are tight and leak free.
2. Open the pump vent plug by turning it 1-2 turns.

**Note:** Periodically lubricate the die ring with Weatherhead T-400-G lubricant.



3. Release the pusher clip and slide pusher back.
4. Select the proper Weatherhead hose, end fittings and tooling (refer to Hose End and Tool Selector Chart). Insert the hose into the end fitting, making sure that the hose is bottomed in end fitting.



5. Loosen knob and tilt press as necessary. Insert one end of hose assembly from below the base plate and between the collet halves. Align knurl on end fitting with top of collet, making sure that collet halves are evenly aligned.



6. Holding uncrimped hose assembly in place, position T-480-68 blue extension ring on top of collet.
7. Slide pusher forward, making sure pusher clip has locked.



8. Turn pump switch, located on side of shroud, to "ON" position. Press ADVANCE on pendant switch and hold until blue spacer extension ring contacts the base plate, indicating that the crimp is complete. Press RETRACT on the pendant switch and pusher will retract. Remove the blue pusher extension ring from top of collet and then the crimped hose assembly from below.

**Note:** Visually inspect the crimped end. Measure the nominal crimp diameter and verify that the crimp is within 1/16" from the locating knurl on the collar, see figure C, page 342.

#### FORT-400 TOOLING

**Note:** The T-480-68 blue extension ring is NOT used with T-400 tooling.

9. When crimping with Coll-O-Crimp I tooling the procedure is the same except:
  - a. Insert the T-420-25 adapter die ring into the base plate die cavity.
  - b. Periodically lubricate the T-420-25 adapter die ring or base plate die cavity.
  - c. Use T-400 collets and spacer rings.
  - d. Align dimples on the end fitting with top of collet. When crimping 229 'P', 265 'P', 338 'P' and 757 'E' Series hose ends, align top of collar on hose end with top surface of collet.

## Equipment

### Portable T-480 Operating

#### Insertion Depth

Push hose end on hose until hose is bottomed in end fitting. To insure that hose is bottomed in collar, mark the insertion depth on the hose before inserting it into the hose end.



Figure A

HOSE I.D.	'U' SERIES RUBBER	'E' SERIES NYLON/	069 'E' SERIES TRUCK HOSE	757 'E' SERIES REFRIGERANT HOSE
3/16	—	7/8	1	—
1/4	1-1/2	7/8	1	—
5/16	—	15/16	1-3/32	1
3/8	1-7/16	15/16	—	—
13/32	—	—	1-3/32	1-1/8
1/2	1-7/16	1-1/16	1-3/32	1-3/32
5/8	1-15/16	—	1-5/16	1-3/32
3/4	2-1/8	1-1/4	—	—
7/8	—	—	1-5/16	—
1	2-3/16	1-11/32	—	—
1-1/8	—	—	1-3/8	—

#### Nominal Crimp Diameter Measurement

Measuring crimp diameters should be a part of the normal hose assembly procedure. To insure a proper crimp diameter reading, follow these steps:

1. Measure the diameter in the middle of crimped portion of the hose end.
2. Place the caliper in a position to allow a measurement across the pressed (flat) portion of the crimp.
3. Refer to Hose End and Tool Selector Chart for nominal crimp diameter.

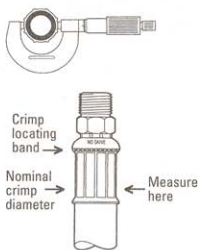

Figure C

**Note:** In the larger sizes, calipers may be used; however, in the smaller sizes, and in the 'E' Series thermoplastic hose ends, a point micrometer will provide an accurate reading.

#### Coll-O-Crimp Spacer Ring

Typical spacer ring illustrating both sides of ring.

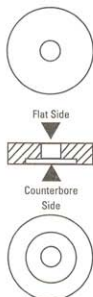

Figure B

#### 757 'E' Series Hose End

757 'E' Series hose ends must be positioned with top of collar level with top of collet.

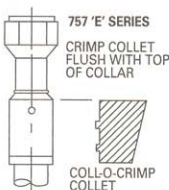

Figure D

## Equipment

### Coll-O-Crimp T-400



Refer to safety information regarding Coll-O-Crimp hose, hose fittings and assembly equipment compatibility on page 3.

#### Coll-O-Crimp T-400



The Coll-O-Crimp I is the time-proven "Mini-Factory" that you can easily set up in your own shop. Fast, easy, compact and various power sources available make this crimper versatile for even the smallest of workshops.

**Capacity:** 3/16" I.D. 1 fiber braid through 1-3/8" I.D. 1 wire hose and 1-1/4" I.D. 2 wire hose.

**Mounting:** Bench; FH-135X or C40X Cabinet.

For cabinets see pages 370-373.

**Size:** 16-1/4" high, 8" wide, 21-3/4" deep

**Weight:** 113 lbs.

Packages continued on next page.

Refer to pages 356-367 for Coll-O-Crimp tooling, tooling packages and pumps.

**Note:** 25 ton (T-400-1 is C-O-C press only)



Refer to safety information regarding Coll-O-Crimp crimping procedures on page 345.



#### CAUTION

The Coll-O-Crimp power source has the pressure relief valve set at 4000 to 4200 PSI. Damage to the press will result if higher pressures are used and warranty may be voided.

#### T-400 • Coll-O-Crimp I Package

Includes one each of the following:

CATALOG NUMBER	DESCRIPTION
T-400-1	Coll-O-Crimp Press, T-400-BB Switch, and T-400-M Instructions
T-400-2C	'U' Series Collet - 1/4"
T-400-3C	'U' Series Collet - 3/8"
T-400-4C	'U' Series Collet - 1/2"
T-400-5C	'U' Series Collet - 3/4"
T-400-6C	'U' Series Collet - 1"
T-400-10	Spacer Ring - Black
T-400-11	Spacer Ring - Silver
T-400-62	Spacer Ring - Yellow
T-400-16**	36" T-421U Pump to Press Hose Assembly
T-400-8	Die Ring

Pump Required (sold separately): T-421U, T421U-110, T-402-2 or T-403-2 see pages 345-347.

\*\*Not supplied when ordering a T-402 or T-403 package.

#### T-400 Coll-O-Crimp I Press/Pump Packages

The T-400 Coll-O-Crimp Press and tooling package can be supplied with a variety of power units for your particular needs. Listed below are press/power unit packages. For cabinets see pages 371-374.

#### T-401 • C-O-C I & 220v Electric Pump Package

Includes one each of the following:

CATALOG NUMBER	DESCRIPTION
T-400	Press and tooling package
T-421U	Electric Pump (220v, 1 phase)

#### T-401-110 • C-O-C I & 110v Electric Pump Package

Includes one each of the following:

CATALOG NUMBER	DESCRIPTION
T-400	Press and tooling package
T-421U-110	110v, 1 Phase Pump

#### T-402 • C-O-C I & Air/Hydraulic Pump Package

Includes one each of the following:

CATALOG NUMBER	DESCRIPTION
T-400	Press and tooling package/Less T-400-16
T-402-2	Air/Hydraulic Pump
T-400-18	108" Hose assembly and fittings

## Equipment

### Coll-O-Crimp T-400



Refer to safety information regarding Coll-O-Crimp hose, hose fittings and assembly equipment compatibility on page 3.

Packages continued from previous page.



Refer to safety information regarding Coll-O-Crimp crimping procedures on page 345.

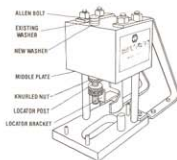

#### T-400 Coll-O-Crimp I Press/ Pump Packages Continued

The T-400 Coll-O-Crimp I Press and tooling package can be supplied with a variety of power units for your particular needs. Listed below are press/power unit packages. For cabinets see page 371-374.

#### T-400-9 • Crimp Locator

The T-400-9 allows you to make large volumes of hose assemblies by automatically aligning hose ends in proper crimp location.

#### Installation Procedure

1. Remove the front Allen bolt using an Allen wrench or tool provided with kit.
2. Add the washer provided with the kit to existing washer as shown and

#### T-403 • C-O-C I & Hand Pump Package

Includes one each of the following:

CATALOG NUMBER	DESCRIPTION
T-400	Press and tooling package/Less T-400-16
T-403-2	Hand Pump
T-400-19	60" hose assembly and fittings

#### T-4 14 • C-O-C I & 12v Electric Pump Package

Includes one each of the following:

CATALOG NUMBER	DESCRIPTION
T-400	Press and tooling package
T-412	12 volt DC Electric Pump

**Note:** 25 ton (T-400-1 is C-O-C press only)

torque the bolt down to approximately 75 ft.-lbs.

3. Attach the locator post of the pre-assembled locator to the bottom of the middle plate and lock it in place with one of the knurled nuts.
4. Align the dimples on the first assembly with top of collet to locate the crimp. Drop the locator bracket down to rest on top of the hose end. Lock the

bracket in position with remaining two knurled nuts. The locator now can be used, instead of dimples, to locate crimp accurately and consistently on the remaining hose ends of the same size and type.

**Note:** Remove locator assembly when crimping bent tube ends.

#### T-400-1 Coll-O-Crimp I Repair and Replacement Items

CATALOG NUMBER	DESCRIPTION
T-400-B	Pusher Bolt
T-400-BB	Switch to interface T400-1 crimper to T421U pump or T-421U-110 pump
T-400-G	1.5 oz. Tube High Efficiency * Grease
T-400-K1	Seal Replacement Kit for T-400-1 Press
T-400-E	Shroud Decal
T-400-M	Instructions for T-400-1
T-400-S	Replacement press shroud with Decals.
T-400-8	Die Ring
T-400-13	Replacement collet cage for T-400 'U' Series collets, 1/4" and 3/8" sizes only, and 229 'P' Series collets, all sizes, with a 'C' suffix (2 required for each collet).
T-400-14	Replacement collet cage for T-400 'U' Series collets with a 'C' suffix, 1/2" through 1" only, (2 required for each collet).
T-400-90	Replacement collet cage for T-400 'E', 069 'E', and 'E' Series collets with a 'C' suffix (2 required for each collet).
T-432-15	Pusher



#### CAUTION

The Coll-O-Crimp power source has the pressure relief valve set at 4000 to 4200 PSI. Damage to the press will result if higher pressures are used and warranty may be voided.



## Equipment

### Coll-O-Crimp T-400 Crimping Procedure

#### WARNING

You must hold the hose assembly in place from below throughout the crimping operation. Do not place fingers or hands at the crimping point during operation. Failure to follow this procedure could result in serious injury to your hand or finger.



1. Place die ring T-400-8 on base plate against front stops.
2. Insert properly-sized matched collet halves in the die ring. See chart on press.



3. Place the correct Coll-O-Crimp hose end on hose. Be sure hose is bottomed in hose end.



4. Insert hose assembly from below between the collet halves. Align the dimples on the hose end with the top of the collet. When crimping 229 'P', 265 'P', or 338 'P' or 757 'E' Series ends, the collar should be flush with the top of the collet.



5. Place specified side of spacer ring face down on collet with uncrimped hose assembly held in place. Refer to the Hose End & Tool Selection Chart in the back of this catalog for further instruction.
6. Slide entire assembly back against rear locating stops.



7. Activate pump to crimp hose end to hose. When spacer ring contacts die ring, crimping is complete. Release the electric switch to retract pusher. Slide entire assembly forward and remove spacer ring.



8. Remove factory-quality crimped hose assembly and visually inspect the crimped end. The crimp on the collar should be located  $\pm 1/16$ " from the dimples or ridges.
9. To insure a proper crimp has been completed, measure the nominal crimp diameter. Refer to Hose End and Tool Selector Chart in back of catalog for procedure and crimp diameters.

## Equipment

### Coll-O-Crimp T-407



Refer to safety information regarding Coll-O-Crimp hose, hose fittings and assembly equipment compatibility on page 3.

#### T-407-1 • Production Coll-O-Crimp Press



\*Removal of crimp locator allows for crimping of 45° and 90° angle hose end configurations.

Refer to pages 356-367 for Coll-O-Crimp tooling, tooling packages and pumps.

Refer to safety information regarding Coll-O-Crimp crimping procedures on page 345.

The T-407-1 Production Coll-O-Crimp, as its name implies, is at its best in the fast production of \*straight configuration hose end crimping. Taking advantage of the swiveling bracket which supports the crimper, tooling can be put in place and the press locked in at up to a 90° angle, facilitating quick hose end crimping. A crimp locator is included. When set to position, the crimp locator allows for a preset of the correct crimp location so hose assemblies can be built in volume, with accuracy and precision. The T-407-1 offers crimping capabilities of 3/16"-1 fiber braid through 1-3/8" I.D. 1 wire hose and 1-1/4" I.D. 2 wire hose.

#### T-433-1 • Foot Switch



Lightweight and easy to use, the T-433-1 is designed with the operator in mind. Colored safety orange, the T-433-1 electric foot switch allows for hands free operation.

**Weight:** (for press and pump) 198 lbs.

**Size Press:** 16-1/4" high, 21-3/4" deep

**Includes one each of the following:**

CATALOG NUMBER	DESCRIPTION
T-400-M	Instructions
T-400-B	Die Ring
T-400-9	Crimp Locator
T-400-19	60" hose assembly and fittings

#### T-407 • Production Coll-O-Crimp Package

The T-407 comes with a high volume pump and a foot switch.

**Size Pump:** 26" high, 18" wide  
(Pump is wired for 220v, 1 phase)

**Includes one each of the following:**

CATALOG NUMBER	DESCRIPTION
T-407-1	Production C-O-C Press
T-433	Two-Stage Piston Pump and foot switch

**Note:** The T-433 pump which is shipped as part of the T-407 Production Coll-O-Crimp System.

For use with T-407-1 C-O-C Production System.

## Equipment

### Coll-O-Crimp Super I T-420



Refer to safety information regarding Coll-O-Crimp hose, hose fittings and assembly equipment compatibility on page 3.

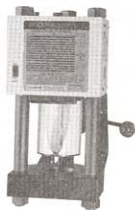

The Coll-O-Crimp Super I is a versatile machine ideal for your shop, factory, construction, and mine locations. Big capacity combined with lever activated crimping gives you wide coverage and a quick and simple way to make factory-quality hose assemblies.

**Capacity:** 3/16" I.D. 1 fiber braid through 1-1/4" 6 spiral hose; for hoses other than 4

and 6 spiral, conversion tooling is required. See pages 284-287 for details.

**Mounting:** Bench or C-40X cabinet.

See pages 296-299 for cabinet (not included).

**Size:** 22" high, 10" wide, 20-1/2" deep

**Weight:** 210 lbs.

**Pump Required (sold separately):** T-421U or T-421U-110

**T-420-1 • Coll-O-Crimp Super I Press ONLY Includes T-420-M Instructions**

#### ⚠ CAUTION

The Coll-O-Crimp power source has the pressure relief valve set at 4000 to 4200 PSI. Damage to the press will result if higher pressures are used and warranty will be voided.

#### T-420-N • Coll-O-Crimp Super I Package

Includes one each of the following:

CATALOG NUMBER	DESCRIPTION
T-420-1	Coll-O-Crimp Super I Press and T-420-M Instructions
T-421U	220v Electric Pump
T-400-2C	'U' Series Collet- 1/4"
T-400-3C	'U' Series Collet- 3/8"
T-400-4C	'U' Series Collet- 1/2"
T-400-5C	'U' Series Collet- 3/4"
T-400-6C	'U' Series Collet- 1"
T-400-10	Spacer Ring- Black
T-400-11	Spacer Ring- Silver
T-400-62	Spacer Ring Yellow
T-410-22	36" Pump to Press Hose Assembly
T-420-25	Adapter Ring for T-400 Series Collets
T-420-4CN	430 'U' Series Collet- 1/2"
T-420-5CN	430 'U' Series Collet- 3/4"
T-420-6CN	430 'U' Series Collet- 1"
T-420-7CN	430 'U' Series Collet- 1-1/4"

#### T-420N-110 • Coll-O-Crimp Super I Package

Includes one each of the following:

CATALOG NUMBER	DESCRIPTION
T-420-1	Coll-O-Crimp Super I Press and T-420-M Instructions
T-421U-110	110v Electric Pump
T-400-2C	'U' Series Collet- 1/4"
T-400-3C	'U' Series Collet- 3/8"
T-400-4C	'U' Series Collet- 1/2"
T-400-5C	'U' Series Collet- 3/4"
T-400-6C	'U' Series Collet- 1"
T-400-62	Spacer Ring- Yellow
T-400-10	Spacer Ring- Black
T-400-11	Spacer Ring- Silver
T-410-22	36" Pump to Press Hose Assembly
T-420-25	Adapter Ring for T-400 Series Collets
T-420-4CN	430 'U' Series Collet- 1/2"
T-420-5CN	430 'U' Series Collet- 3/4"
T-420-6CN	430 'U' Series Collet- 1"
T-420-7CN	430 'U' Series Collet- 1-1/4"

#### Coll-O-Crimp Super I Repair and Replacement Items

CATALOG NUMBER	DESCRIPTION	CATALOG NUMBER	DESCRIPTION
T-420-1M	Micro-Switch for T-420-1 Press	T-420-G	Linkage Assembly
140-0677	Tool Locator Bracket	T-420-2R	Rack
T-420-B	Pusher Bolt and Washers	T-420-2K	Pinion Shaft Assembly
T-420-E	Shroud Decal	T-420-2S	Replacement Pinion Gear Shaft
T-420-H	Handle	T-420-2G	Replacement Pinion Gear
T-420-L	Light Bulb	T-400-G	1.5 oz. Tube High Efficiency * Grease
T-420-LA	Light Assembly	T-421U-BC	Breather Cap for T-421U Pump
T-420-LS	Light Switch	140-06745	Pusher Wear Plates includes (1) Left and (1) Right
T-420-M	Instructions for T-420-1	140-06748	Pusher Wear Plates Screws (1)
T-420-P	Pusher Set (2) with Wear Plates and Screws		See pages 364 for replacement pumps.
T-420-S	Press Shroud with Decals		Refer to pages 356-367 for Coll-O-Crimp tooling, tooling packages and pumps.
T-420-26	Insert - Base Plate		Refer to safety information regarding Coll-O-Crimp crimping procedures on pages 349-350.

## Equipment

### Coll-O-Crimp T-440



Refer to safety information regarding Coll-O-Crimp hose, hose fittings and assembly equipment compatibility on page 3.



Reference pages 356-367 for Coll-O-Crimp tooling, tooling packages and pumps.

**Note:** Seal kits for T-410 and T-440 are not sold separately. Crimpers must be sent in and torqued by Weatherhead.

Refer to safety information regarding Coll-O-Crimp crimping procedures on pages 349-350.

The Coll-O-Crimp II Plus is ideal for factory, high performance machine operations, construction and mine locations. This machine offers the capabilities of crimping all of the crimp style hose ends Weatherhead offers. With this coverage, this heavy-duty crimper can handle all of your crimping needs.

#### CAUTION

The Coll-O-Crimp power source has the pressure relief valve set at 5000 PSI. Damage to the press will result if higher pressures are used and warranty may be voided.

**Capacity:** 3/16" I.D. 1 fiber braid through 2" 6 spiral hose; for hoses other than 4 and 6 spiral, conversion tooling is required. See page 356-361 for details.

**Mounting:** Bench

**Size:** 27" high, 12" wide, 21" deep

**Weight:** 450 lbs.

**Pump Required (sold separately):** T-441, see page 347.

**Note:** These packages include tooling to crimp H430 hose. For additional tooling order from pages 356-361.

**Note:** For T-410 press, use T-410-BB switch.

#### T-440-N • Coll-O-Crimp II Plus Package

Includes one each of the following:

CATALOG NUMBER	DESCRIPTION
T-440-1	C-O-C II Plus Press, T-440-M Instructions and 140-06741 Switch
T-441	220v 2-stage Electric Pump
T-410-4CN	430 'U' N/S Collet - 1/2" I.D.
T-410-5CN	430 'U' N/S Collet - 3/4" I.D.
T-410-6CN	430 'U' N/S Collet - 1" I.D.
T-410-7CN	430 'U' N/S Collet - 1-1/4" I.D.
T-410-8N	430 'U' N/S Collet - 1-1/2" I.D.
T-410-9N	430 'U' N/S Collet - 2" I.D.
T-410-22	36" Pump to Press Hose Assembly

#### Repair & Replacement Items:

CATALOG NUMBER	DESCRIPTION
T-410-26R	Base Plate Insert (7") (T-440-1)
T-410-26	Base Plate Insert (6") (T-410-1)
T-410-28	Tool Locator Bracket
T-410-B	Pusher Bolt and Washers
T-410-E	Shroud Decal
T-440-M	Instructions for T-440-1
T-410-P	Pusher Set (2) for T-410-1 and T-440-1
T-410-1M	Microswitch for T-410-1 & T-440-1
T-421-FP	4 prong female electrical outlet See page 245 for illustration.
T-400-G	1.5 oz. Tube High Efficiency * Grease
140-06741	Pump Switch for the T-440-1 crimper using T-441 pump
T-410-BB	Pump Switch for T-410-1 crimper using T-421U or T-421U-110 pump only

## Equipment

### T-420 & T-440 Crimping Procedure



Procedure when using T-410 or T-420 series collets. Spacer ring may be required, please refer to Hose End & Tool Selector Chart in the back of this catalog for tooling specifications.



#### WARNING

You must hold the hose assembly in place from below throughout the crimping operation. Do not place fingers or hands at the crimping point during operation. Failure to follow this procedure could result in serious injury to your hand or finger.

#### T-440 Used In Example



1. Open pusher halves. Select proper size collet for hose type being crimped. Insert collet as shown.



2. Place proper size Coll-O-Crimp hose end on hose. Be sure hose is bottomed in hose end.



3. Insert hose assembly from below, between collet halves. Crimp locating knurls must align with top surface of collet.

- 2a. When making a hose assembly on the T-440-1 C-O-C machine using a 47032E-632 on each end, you must manually remove the spring loaded collet retainer ring in order for the hose end to fit through the opening.



4. T-440-1: Close pusher halves and activate pump by turning on switch. When pusher contacts the base plate, the crimp is complete.



5. T-440-1: Release switch. Pusher will automatically return. Open pusher halves. Remove factory crimped assembly and inspect.



6. To insure a proper crimp has been completed, measure the nominal crimp diameter. Refer to the Hose End and Tool Selector Chart in back of catalog for procedure and crimp diameter.

4. T-420-1: Pull activating lever down. Pusher halves will close. Continue to pull activating lever down (pump will activate) until pusher contacts the base plate. The crimp is complete. Release activating lever. Pusher will automatically return, and pusher halves will open. Remove hose assembly and measure nominal crimp diameter (see step 6).

<sup>1</sup>When using sizes 24 and 32 of 430 'U' series hose ends on T-440 Press.

<sup>1</sup>When using 430 'E' Series Hose Ends and when using size 12 through 32 of 430 'U' series hose ends.

<sup>\*</sup>When using H35016 and H54516 with 430 'U' Series Hose ends.

## Equipment

### T-420 & T-440 Crimping Procedure



Procedure when using T-400 series collets. Please refer to Hose End & Tool Selector Chart in the back of this catalog for tooling specifications.



#### WARNING

You must hold the hose assembly in place from below throughout the crimping operation. Do not place fingers or hands at the crimping point during operation. Failure to follow this procedure could result in serious injury to your hand or finger.

#### T-420 Used In Example



1. Hold switch "ON," As ram starts down, rotate the ram return stops "OUT" from their "IN" position. Release switch. Ram will return to the full up position allowing enough clearance for insertion of required tooling.



2. Open pusher halves and place adapter ring in the base plate cavity. Select proper size collet for hose type and size being crimped. Insert collet halves in adapter ring.



3. Place proper size Coll-O-Crimp hose end on hose. Be sure to bottom on hose.



4. Select proper spacer ring. Reference Spacer Ring Selector Chart located on front of press, or Hose End and Tool Selector Chart in back of catalog. Insert hose assembly from below, between collet halves. Align the dimples on the hose end collar with the top of the collet. When using the 229'P', 265'P', 338'P' and 757'E' series hose ends, the collar should be flush with the top of the collet.

5. Place appropriate side of spacer ring on top of collet.



6a. T-440-1: Close pusher halves. Hold switch on. When spacer ring bottoms on adapter ring the crimp is complete.

6b. Release switch to shut off pump and retract pusher halves. Open pusher halves. Remove factory-crimped hose assembly and inspect the crimp.

7a. T-420-1: Pull activating lever down. Pusher halves will close. Continue to pull activating lever down (pump will activate) until pusher contacts the base plate. The crimp is complete.



7b. Release activating lever. Pusher will automatically return and pusher halves will open. Remove factory-crimped hose assembly and inspect the crimp.

8. To insure a proper crimp has been completed, measure the nominal crimp diameter. Refer to Hose End and Tool Selector Chart in back of catalog for procedure and crimp diameters.

## Equipment

### Coll-O-Crimp T-605VS



Refer to safety information regarding Coll-O-Crimp hose, hose fittings and assembly equipment compatibility on page 3.



Refer to page 141 for Coll-O-Crimp tooling and tooling packages.

The T-605VS is designed for high-speed production crimping of hydraulic and fluid transfer hose assemblies. Equipped with Weatherhead "bump-and-skirt" dies, the T-605VS produces OEM-quality crimps on Weatherhead 'U', '430U' and 'E' series hose ends. Optional flat-crimp dies allow crimping of other Weatherhead hose ends and Weatherhead "Wolf" Couplings.

**Capacity:** 3/16" I.D. fiber-braid through 2" 6-spiral hydraulic, pneumatic and fluid transfer hoses

**Mounting:** Tool Stand or Bench Mount

**Weight:** 293 lbs.

**Standard Voltage:** 230 three-phase

**T-605VS-1 • Variable Crimp System ONLY!**

#### T-605VS • T-605 Crimping System Package

Includes one each of the following:

CATALOG NUMBER	DESCRIPTION
T-605VS-1	Variable Crimp System
T-605-CS	QC Tool Stand
T-605-80FP	Complete Set (17) Dies for Flat Crimp
T-605-104U	'U' Series, 'S' Series and 265 'P' Series Die Sets
T-605-430U	430 'U' Series Die Set

#### T-605VS-U • T-605 Crimping System Package

Includes one each of the following:

CATALOG NUMBER	DESCRIPTION
T-605VS-1	Variable Crimp System
T-605-CS	QC Tool Stand
T-605-104U	'U' Series, 'S' Series and 265 'P' Series Die Sets
T-605-430U	430 'U' Series Die Set

#### T-605VS-B • T-605 Crimping System Package

Includes one each of the following:

CATALOG NUMBER	DESCRIPTION
T-605VS-1	Variable Crimp System
T-605-CS	QC Tool Stand
T-605-80FP	Complete Set (17) Dies for Flat Crimp

#### Additional T-605 Crimping System Parts:

CATALOG NUMBER	DESCRIPTION
T-605-CS	QC Tool Stand
T-605-TH	Tool Holder - Wall or Floor Mounted
T-605-DH	Quick Change Die Holder
T-605-DP	Set of retaining Pins for Dies

## Equipment

### Coll-O-Crimp T-605VS



Refer to safety information regarding Coll-O-Crimp hose, hose fittings and assembly equipment compatibility on page 3.

#### T-605



**Note:** Collets may be ordered individually.

#### T-605-80FP • Complete Set (17) Dies for Flat Crimp\*

Kit includes one each of the following:

CATALOG NUMBER	DESCRIPTION
T-605-FP10	Crimp range 10-12mm (0.394"-0.472")
T-605-FP12	Crimp range 12-14mm (0.472"-0.551")
T-605-FP14	Crimp range 14-16mm (0.551"-0.629")
T-605-FP16	Crimp range 16-19mm (0.629"-0.748")
T-605-FP19	Crimp range 19-22mm (0.748"-0.866")
T-605-FP22	Crimp range 22-26mm (0.866"-1.023")
T-605-FP26	Crimp range 26-30mm (1.023"-1.181")
T-605-FP30	Crimp range 30-34mm (1.181"-1.338")
T-605-FP34	Crimp range 34-39mm (1.338"-1.535")
T-605-FP39	Crimp range 39-45mm (1.535"-1.771")
T-605-FP45	Crimp range 45-51mm (1.771"-2.007")
T-605-FP51	Crimp range 51-57mm (2.007"-2.244")
T-605-FP57	Crimp range 57-63mm (2.244"-2.480")
T-605-FP63	Crimp range 63-69mm (2.480"-2.716")
T-605-FP69	Crimp range 69-75mm (2.716"-2.953")
T-605-FP74	Crimp range 74-80mm (2.913"-3.149")
T-605-FP78	Crimp range 78-87mm (3.071"-3.425")

\* For use when a full length flat crimp is required (i.e., only for Weatherhead 'M' Series hose ends and for crimping Weatherhead industrial hose). Not recommended for 'U' Series hose ends. Please refer to the Hose End & Tool Selector Chart for nominal crimp diameters for Weatherhead industrial hoses with Weatherhead 'U', '430' 'U' and 'M' Series hose ends.

#### T-605-104U • 'U' Series, 'S' Series & 265 'P' Series Die Set for Crimping System T-605VS

Kit includes one each of the following:

CATALOG NUMBER	DESCRIPTION
T-605-10404	Crimp dies for 04 'U', 04 'S', 26504 'P' & 26506 'P' hose ends
T-605-10406	Crimp dies for 06 'U', 06 'S' & 26508 'P' hose ends
T-605-10408	Crimp dies for 08 'U' & 08 'S' hose ends
T-605-10410	Crimp dies for 10 'U' & 26512 'P' hose ends
T-605-10412	Crimp dies for 12 'U' & 12 'S' hose ends
T-605-10416	Crimp dies for 16 'U' & 16 'S' hose ends
T-605-10420	Crimp dies for 20 'U' & 20 'S' hose ends

#### T-605-430U • 430 'U' Series Die Set for Crimping System T-605VS

Kit includes one each of the following:

CATALOG NUMBER	DESCRIPTION
T-605-43008	Crimp dies for 43008 'U' hose ends
T-605-43012	Crimp dies for 43012 'U' hose ends
T-605-43016	Crimp dies for 43016 'U' hose ends
T-605-43020	Crimp dies for 43020 'U' hose ends
T-605-43024	Crimp dies for 43024 'U' hose ends
T-605-43032	Crimp dies for 43032 'U' hose ends

#### T-605-069E • 430 'U' Series Die Set for Crimping System T-605VS

Kit includes one each of the following:

CATALOG NUMBER	DESCRIPTION
T-605-E1	Crimp dies for 04 'E' & 06904 'E' hose ends
T-605-E2	Crimp dies for 05 'E' & 06905 'E' hose ends
T-605-E3	Crimp dies for 06 'E' & 06906 'E' hose ends
T-605-E4	Crimp dies for 08 'E' & 06908 'E' hose ends
T-605-E5	Crimp dies for 06908 'E' & 06910 'E' hose ends
T-605-E6	Crimp dies for 06910 'E' hose ends
T-605-E7	Crimp dies for 12 'E' & 06912 'E' hose ends
T-605-E8	Crimp dies for 16 'E' & 06916 'E' hose ends
T-605-E9	Crimp dies for 06920 'E' hose ends



## ET1000 Portable Crimp Machine

### ET1000 • Portable Crimp Machine



The completely PORTABLE ET1000 crimp machine boasts a broad crimp capability with an ease-of-use that is sure to please hose assemblers. With 3 power source options, Air/Hydraulic, Hand, and Electric, this new portable machine can travel to the work-site. The machine comes equipped with a stand pre-drilled for mounting to a work-bench or tabletop. This new crimp machine has been approved to crimp. For Tooling and Crimp diameters refer to the Collet/Spacer Ring Selection Chart # W-EQCR-TP001-E.

The ET1000 Portable Crimp Machine is a mid-size machine positioned between the other two popular portable crimp machines (the T460 and T480 machines.)

The ET1000 uses the popular Coll-O-Crimp 2-piece collet assemblies and spacer rings to control crimp diameters.

#### Capacity:

Weatherhead U-series fittings and applicable hoses in sizes 1/4" through 1-1/4"

Weatherhead W-series fittings and applicable hoses in sizes 1/4" through 1"

**Mounting:** Stand

**Weight:** 70 lbs. (less pump)

#### Pump Options (sold separately):

2-stage hand, T-480-2  
(see page 291)

Air/Hydraulic, T-482-2  
(see page 292)

Electric (110 volt \_ hp),  
T-481-110 (see page 292)



Refer to safety information regarding hose, hose fittings and assembly equipment compatibility on pages 3.

#### ET1000 Machine Packages

(These packages include the basic machine with stand and various pumps. No tooling included.)

ET1000-001 = Machine & No pump, no tooling (basic machine only)

ET1000-002 = Machine, Hand-pump, no tooling

ET1000-003 = Machine, Air-hydraulic pump, no tooling

ET1000-004 = Machine, 110 volt \_ hp electric pump, no tooling

#### Repair, Replacement & Accessory Items:

ET1000-0001	Stand
ET1000C-0006	Pusher
140-06701	1.5 oz. Tube of High Efficiency PTFE Lubricant

**Note:** for other repair and replacement items refer to the Operators Manual that is shipped with each machine.

# ET1000 Crimping Procedures for Large Collets

## Description of Components



ET1000 Crimp Machine



Die Ring  
Adapter



Split Collet  
Assembly



Spacer Rings

## Crimping Procedures (using larger collets)



### Step 1:

Slide the pusher to the back position.

Using the Collet/Spacer Ring Selector Chart, select the proper collet assembly and spacer ring.

Lubricate the inside cone of the die ring and external surfaces of the collet assembly with a high-efficiency PTFE based lubricant.

Insert the collet assembly into the base die ring.

### Step 2:

Insert the hose assembly through the bottom of the base die ring and between the two collet assembly halves. Align the fitting with the top of the collet halves as referenced on the Collet/Spacer Ring Selector Chart.

### Step 3:

Place the spacer ring in the appropriate position on top of the collet assembly (either flat-side up or flat-side down as referenced in the Collet/Spacer Ring Selector Chart).

### Step 4:

Pull the pusher forward into the detent holding position with the pusher positioning handle.

### Step 5:

Begin crimping by actuating the pump. **When the spacer ring bottoms out against the base die ring, the crimping is complete.**

**Note:** Visually inspect the crimp and verify the correct crimp diameter and length.

## ET1000 Crimping Procedures for Small Collets

### Crimping Procedures (using smaller collets)



#### Step 1:

Slide the pusher to the back position.

Using the Collet/Spacer Ring Selector Chart, select the proper collet assembly and spacer ring.

Lubricate the inside cone of the base die ring and the outside cone of the die ring adapter plate.

Place the die ring adapter plate into the base die ring.



#### Step 2:

Lubricate the external surfaces of collet assembly halves with a high-efficiency PTFE-based lubricant.

Insert the collet assembly into the die ring adapter plate.



#### Step 3:

Insert the hose assembly through the bottom of the base die ring and up between the two collet assembly halves. Align the fitting with the top of the collet halves as referenced on the Collet/Spacer Ring Selector Chart.



#### Step 4:

Place the spacer ring in the appropriate position on top of the collet assembly (either flat-side up or flat-side down as referenced in the Collet/Spacer Ring Selector Chart).



#### Step 5:

Pull the pusher forward into the detent holding position with the pusher positioning handle.

#### Step 6:

Begin crimping by actuating the pump. **When the spacer ring bottoms out against the die ring adapter plate**, the crimping is complete.

**Note:** Visually inspect the crimp and verify the correct crimp diameter and length.

## Equipment

### Collet Kits



Refer to safety information regarding Coll-O-Crimp hose, hose fittings and assembly equipment compatibility on page 3.



#### T-400-30 • 'E' Series Collet Kit

This kit can be used with the following C-O-C systems: T-400-1, T-420-1, T-440-1, T-460, T-462, T-465 and T-480.

**Note:** See Hose End and Tool Selector Chart in the back of this catalog for proper Collet selection for hose style and size desired.

**Note:** Collets may be order individually.

The Eaton tools listed are offered in kits for any given hose type, or collets and tools can be purchased individually by catalog number. Refer to Hose End and Tool Selector Chart at the back of this catalog for proper spacer rings.

#### T-400-66 • 069 'E' Series Collet Kit

This kit can be used with the following C-O-C systems: T-400-1, T-420-1, T-440-1, T-460, T-462, T-465 and T-480.

#### T-400-67 • 'U' Series Collet Kit

This kit can be used with the following C-O-C systems: T-400-1, T-420-1, T-440-1, T-460, T-462, T-465 and T-480.

#### T-400-84 • 229 'P' Series Collet Kit

This kit can be used with the following C-O-C systems: T-400-1, T-420-1, T-440-1, T-460, T-462, T-465 and T-480.

Kit includes one each of the following:

CATALOG NUMBER	DESCRIPTION
T-400-113C	Collet - 3/16" (H243 only)
T-400-31C	Collet - 1/4"
T-400-32C	Collet - 5/16"
T-400-33C	Collet - 3/8"
T-400-34C	Collet - 1/2"
T-400-35C	Collet - 3/4"
T-400-36C	Collet - 1"
FS-1200	Label Set/Layout Guide

Spacer Rings not included in T-400-30 kit.

Kit includes one each of the following:

CATALOG NUMBER	DESCRIPTION
T-400-54C	Collet - 3/16"
T-400-55C	Collet - 1/4"
T-400-56C	Collet - 5/16"
T-400-57C	Collet - 13/32"
T-400-58C	Collet - 1/2"
T-400-59C	Collet - 5/8"
T-400-60C	Collet - 7/8"
T-400-61C	Collet - 1-1/8"
T-400-70	Collet - 1-3/8"
FS-1500	Label Set/Layout Guide

Spacer Rings not included in T-400-66 kit.

Kit includes one each of the following:

CATALOG NUMBER	DESCRIPTION
T-400-2C	Collet - 1/4"
T-400-3C	Collet - 3/8"
T-400-4C	Collet - 1/2"
T-400-64C	Collet - 5/8"
T-400-5C	Collet - 3/4"
T-400-6C	Collet - 1"
T-400-12	Collet - 1-1/4"
FS-1100	Label Set/Layout Guide

Spacer Rings not included in T-400-67 kit. \*Through size -12 only.

Kit includes one each of the following:

CATALOG NUMBER	DESCRIPTION
T-400-80C	Collet - 3/16"
T-400-82C	Collet - 13/32"
T-400-81C	Collet - 5/16"
T-400-83C	Collet - 1/2"

Spacer Rings not included in T-400-84 kit.

# Equipment

## Collet Kits



Refer to safety information regarding Coll-O-Crimp hose, hose fittings and assembly equipment compatibility on page 3.



### T-400-104 • 338 'P' Series Collet Kit

This kit can be used with the following C-O-C systems: T-400-1, T-420-1, T-440-1, T-460, T-462, T-465 and T-480.

Kit includes one each of the following:

CATALOG NUMBER	DESCRIPTION
T-400-102C	Collet – 3/8"
T-400-103C	Collet – 1/2"
FS-2900	Label Set

Spacer Rings not included in T-400-104 kit.

### T-400-114 • 757 'E' Series Collet Kit

This kit can be used with the following C-O-C systems: T-400-1, T-420-1, T-440-1, T-460, T-462, T-465 and T-480.

Kit includes one each of the following:

CATALOG NUMBER	DESCRIPTION
T-400-105C	Collet – 5/16"
T-400-107C	Collet – 1/2"
T-400-106C	Collet – 13/32"
T-400-108C	Collet – 5/8"

Spacer Ring not included in T-400-114 kit.

### T-400-129 • 336 'E' Series Collet Kit

This kit can be used with the following C-O-C systems: T-400-1, T-420-1, T-440-1, T-460, T-462 and T-480.

Kit includes one each of the following:

CATALOG NUMBER	DESCRIPTION
T-400-120C	Collet – 3/16"
T-400-122C	Collet – 3/8"
T-400-121C	Collet – 1/4"
T-400-123C	Collet – 1/2"
FS-3500	Label Set

\* For size 3/4" order T-420-156. For 1" size order T-42016C. For use with T-420-1 and T480-1 only.

### T-400-131 • 'M' Series Collet Kit

This kit can be used with the following C-O-C system: T-400-1, T-420-1, T-440-1, T460, T462 and T-480.

Kit includes one each of the following:

CATALOG NUMBER	DESCRIPTION
T-400-109C	Collet – 1/4"
T-400-110C	Collet – 3/8"
T-400-111C	Collet – 1/2"

### 'M' Series Collet • Size 10

CATALOG NUMBER	DESCRIPTION
T-410-30C	10M Collet – Collet for 5/8" size 'M' Series ends. This collet can be used for a T-410 and T-440 ONLY.
T-420-30C	10M Collet – Collet for 5/8" size 'M' Series ends. This collet can be used for a T-420 and T-480 ONLY.

## Equipment

### Collet Kits



Refer to safety information regarding Coll-O-Crimp hose, hose fittings and assembly equipment compatibility on page 3.



#### T-410-70 • 470 'E' Series Collet Kit

This kit can be used with the following C-O-C systems: T-410-1 and T-440-1 ONLY. (For 6 Spiral Hose H470)

**Note:** See Hose End and Tool Selector Chart in the back of this catalog for proper Collet selection for hose style and size desired.

**Note:** Collets may be order individually.

#### T-410-80 • 430 'U' Series No Skive Collet Kit

This kit can be used with the following C-O-C systems: T-410-1 and T-440-1 ONLY.

#### T-420-70 • 470 'E' Series Collet Kit

This kit can be used with the following C-O-C systems: T-420-1 and T-480 (For 4 and 6 Spiral Hose H470)

#### T-420-80 • 430 'U' Series No Skive Collet Kit

This kit can be used with the following C-O-C systems: T-420-1 and T-480

#### Kit includes one each of the following:

CATALOG NUMBER	DESCRIPTION
T-470-8C	Collet - 1/2"
T-470-12C	Collet - 3/4"
T-470-16C	Collet - 1"
T-470-20	Collet - 1-1/4"
T-470-24	Collet - 1-1/2"
T-440-32*	Collet - 2"
FS-1800	Label Set/Layout Guide

\*.32 size requires T-440 system.

#### Kit includes one each of the following:

CATALOG NUMBER	DESCRIPTION
T-410-4CN	Collet - 1/2"
T-410-5CN	Collet - 3/4"
T-410-6CN	Collet - 1"
T-410-7CN	Collet - 1-1/4"
T-410-8N	Collet - 1-1/2"
T-410-9N	Collet - 2"
FS-3100	Label Set

#### Kit includes one each of the following:

CATALOG NUMBER	DESCRIPTION
T-420-8C	Collet - 1/2"
T-420-9C	Collet - 3/4"
T-420-10C	Collet - 1"
T-420-11	Collet - 1-1/4"
FS-1800	Label Set

#### Kit includes one each of the following:

CATALOG NUMBER	DESCRIPTION
T-420-4CN	Collet - 1/2"
T-420-5CN	Collet - 3/4"
T-420-6CN	Collet - 1"
T-420-7CN	Collet - 1-1/4"
FS-3100	Label Set

## Equipment

### Collet Kits



Refer to safety information regarding Coll-O-Crimp hose, hose fittings and assembly equipment compatibility on page 3.



Refer to Hose End and tool Selector chart at the back of this catalog for proper spacer rings.

#### T-480-80 • 'U' and 430 'U' Series Collet Kit

This kit can be used with the following C-O-C systems: T-420-1, and T-480 ONLY.

**Kit includes one each of the following:**

CATALOG NUMBER	DESCRIPTION
T-400-2C	Collet - 1/4"
T-400-3C	Collet - 3/8"
T-400-4C	Collet - 1/2"
T-400-5C	Collet - 3/4"
T-400-6C	Collet - 1"
T-400-10	Spacer Ring - Black
T-400-11	Spacer Ring - Silver
T-400-62	Spacer Ring - Yellow
T-420-25	Adapter Ring for T-400 Series Collets
T-420-4CN	Collet - 1/2"
T-420-5CN	Collet - 3/4"
T-420-6CN	Collet - 1"
T-420-7CN	Collet - 1-1/4"

#### 265 'P' Series Collets

For Hose Styles: H265, H275 and H285

These collets can be used with all C-O-C systems.

T-400-2C is used for crimping 1/4" and 3/8" hose and fittings. T-400-3C is used for crimping 1/2" hose. T-400-64C is used for crimping 3/4" hose and fittings.

**Kit includes one each of the following:**

CATALOG NUMBER	DESCRIPTION
T-400-2C	Collet - 1/4"
T-400-3C	Collet - 3/8"
T-400-64C	Collet - 5/8"

**Note:** See Hose End and Tool Selector Chart in the back of this catalog for proper Collet selection for hose style and size desired.

**Note:** Collets may be order individually.

#### T-410-27 • Conversion Kit

For use if you have collets used on our smaller T-400 Coll-O-Crimp I and you are upgrading to a Coll-O-Crimp II Plus.

The Eaton tools listed below are offered in kits for any given hose type. For example, if you have a Coll-O-Crimp II Plus press and desire to be in the rubber hose business, order T-410-27 conversion kit and T-400-67 for all the collets needed to crimp rubber hose. Collets and tools may also be purchased individually by catalog number.

Example:

If you desire to crimp hose other than 4 or 6 spiral hose, you will need the T-410-25 Adapter Die Ring which is included in the conversion kit above. This ring allows the use of standard Coll-O-Crimp I tooling, in the Coll-O-Crimp II Plus Press.

**Kit includes one each of the following:**

CATALOG NUMBER	DESCRIPTION
T-410-10	Spacer Ring Black
T-410-11	Spacer Ring Silver
T-410-25	Adapter Die Ring
T-410-41	Spacer Ring Yellow

#### 069 'E' Series Collet • Size 32

This collet can be used for a T-410 and T-440 ONLY.

CATALOG NUMBER	DESCRIPTION
T-410-71C	069 'E' Collet - Collet for 2" size 069 'E' Series ends.

## Equipment

### Collet Kits



Refer to safety information regarding Coll-O-Crimp hose, hose fittings and assembly equipment compatibility on page 3.



#### Collet Cage Replacements

CATALOG NUMBER	DESCRIPTION
T-400-13	Replacement collet cages for: T-400-2C, T-400-3C, T-400-80C, T-400-81C, T-400-82C, T-400-83C, T-400-100C, T-400-101C
T-400-14	Replacement collet cages for: T-400-4C, T-400-5C, T-400-6C, T-400-64C, T-400-105C, T-400-106C, T-400-107C, T-400-108C, T-400-109C, T-400-110C, T-400-111C, T-400-120C, T-400-121C, T-400-122C, T-400-123C
T-400-15	Replacement collet cages for: T-400-31C, T-400-32C, T-400-46C, T-400-47C, T-400-102C, T-400-103C, T-400-113C
T-400-90	Replacement collet cages for: T-400-33C, T-400-34C, T-400-35C, T-400-36C, T-400-48C, T-400-49C, T-400-54C, T-400-55C, T-400-56C, T-400-57C, T-400-58C, T-400-59C, T-400-60C, T-400-61C
T-420-14NS	Replacement collet cages for: T-410-4CN, T-410-5CN, T-410-6CN, T-410-7CN, T-410-72CN, T-410-73CN, T-420-4CN, T-420-5CN, T-420-6CN, T-420-7CN
T-420-14	Replacement collet cages for: T-410-4C, T-410-5C, T-410-6C, T-410-7C, T-410-8C, T-420-4C, T-420-5C, T-420-6C, T-420-7C, T-420-8C, T-420-9C, T-420-10C, T-420-30C, T-470-8C, T-470-12C, T-470-16C

**Note:** These items are half cages. Order 2 for complete cage.

#### Adapter Die Rings

CATALOG NUMBER	DESCRIPTION
T-400-8	Adapter Die Ring for T-400 Collets (T-400-1 Press)
T-410-25	Adapter Die Ring for T-400 Collets (T-410-1, T-440-1 Presses)
T-420-25	Adapter Die Ring for T-400 Collets (T-420-1 Press) and T-480 Packages

#### Die Ring Lubricant

CATALOG NUMBER	DESCRIPTION
T-400-G	1.5 oz. Tube High Efficiency Grease



## Equipment

### Spacer Rings



Refer to safety information regarding Coll-O-Crimp hose, hose fittings and assembly equipment compatibility on page 3.



**Note:** See Hose End and Tool Selector Chart in the back of this catalog for proper Spacer Ring selection for hose style and size desired.

**Note:** Spacer rings may ONLY be ordered individually, no sets available.

#### Spacer Rings • T-400-1 C-O-C I

CATALOG NUMBER	COLOR (5" DIA.)	CATALOG NUMBER	COLOR (5" DIA.)
T-400-10	Black	T-400-38	Red
T-400-11	Silver	T-400-62	Yellow
T-400-37	Green	T-400-112	Tan

#### Spacer Rings • T-420-1 C-O-C Super I

CATALOG NUMBER	COLOR (5" DIA.)	CATALOG NUMBER	COLOR (5" DIA.)
T-400-10	Black	T-400-38	Red
T-400-11	Silver	T-400-62	Yellow
T-400-37	Green	T-400-112	Tan
T-420-29*	Orange		

\* Spacer Ring for use on Coll-O-Crimp Super I Press ONLY.

If you desire to crimp hose using T-400 collets, you will need the T-420-25 Adapter Die Ring. This ring allows the use of standard Coll-O-Crimp I tooling.

CATALOG NUMBER	DESCRIPTION
T-420-25	Adapter Die Ring for T-400 Collets
T-420-E	Spacer Ring Selector Decal

#### Spacer Rings • T-440-1 C-O-C II Plus

CATALOG NUMBER	COLOR (5" DIA.)	CATALOG NUMBER	COLOR (5" DIA.)
T-410-10	Black	T-410-40	Red
T-410-11	Silver	T-410-41	Yellow
T-410-12	White	T-410-42	Tan
T-410-39	Green	T-410-93	Orange

**T-410 Spacer rings can only be used on T-410-1 or T-440-1 Crimpers.**

If you desire to crimp hose using T-400 collets, you will need the T-410-25 Adapter Die Ring. This ring allows the use of standard Coll-O-Crimp I tooling.

CATALOG NUMBER	DESCRIPTION
T-410-25	Adapter Die Ring for T-400 Collets

## Equipment

### Spacer Rings



Refer to safety information regarding  
Coil-O-Crimp hose, hose fittings and  
assembly equipment compatibility  
on page 3.



#### Spacer Rings • T-460 Portable C-O-C

CATALOG NUMBER	COLOR (5" DIA.)	CATALOG NUMBER	COLOR (5" DIA.)
T-400-10	Black	T-400-38	Red
T-400-11	Silver	T-400-62	Yellow
T-400-37	Green	T-400-112	Tan

#### Spacer Rings • T-462 Portable C-O-C

CATALOG NUMBER	COLOR (5" DIA.)	CATALOG NUMBER	COLOR (5" DIA.)
T-400-10	Black	T-400-38	Red
T-400-11	Silver	T-400-62	Yellow
T-400-37	Green	T-400-112	Tan

#### Spacer Rings • T-465 Portable C-O-C

CATALOG NUMBER	COLOR (5" DIA.)	CATALOG NUMBER	COLOR (5" DIA.)
T-400-10	Black	T-400-38	Red
T-400-11	Silver	T-400-62	Yellow
T-400-37	Green	T-400-112	Tan

#### Spacer Rings • T-480 Portable C-O-C

CATALOG NUMBER	COLOR (5" DIA.)	CATALOG NUMBER	COLOR (5" DIA.)
T-400-10	Black	T-400-38	Red
T-400-11	Silver	T-400-62	Yellow
T-400-37	Green	T-400-112	Tan
T-420-29	Orange	T-480-68*	Blue

\*To be used with T-480 portable C-O-C and the T-420 collets ONLY.

## Equipment

### Coll-O-Crimp Pumps

#### T-402-2 • Air/Hydraulic Pump



For use with T-400-1.

(Some models have air port on right side)

**Note:** It is recommended that a filter, regulator, lubricator and air pressure gauge be installed in the air line as close as possible to the pump. Filter, Regulator and Lubricator units not included.

#### Pump Specifications:

**Dimensions:** 5-1/4" high, 12-1/2" long, 5" wide

**Weight:** 18 lbs.

**Operation Pressure:** 4000-4200 PSI

**Reservoir Capacity:** 1 pint

**Hydraulic Oil:** Use Enerpac Oil ONLY

**Outlet Port Size:** 3/8" NPT

**Inlet (Air) Port Size:** 1/4" NPT

**Inlet Air Pressure Required:** 60 to 120 PSI

**Filter:** F23A3T02

**Regulator:** R23RGL02

**Lubricator:** L43MPL02

#### T-403-2 • Hand Pump



For use with T-400-1.

#### Pump Specifications:

**Dimensions:** 7 high, 21" long, 4-3/4" wide

**Weight:** 9 lbs.

**Operation Pressure:** 4000-4200 PSI

**Reservoir Capacity:** 1 qt.

**Outlet Port Size:** 3/8"

**NPT Hydraulic Oil:** Use Enerpac Oil ONLY

#### T-411 • Electric Pump (220 volt)

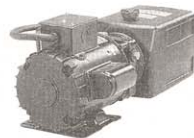

For repair and replacement items for the following pumps please contact an Enerpac Distributor at [www.enerpac.com](http://www.enerpac.com): T-402-2, T-403-2, T-460-2, T-462-2, T-480-2, T-480-3, T-481-110 & T-482-2.

**Replacement pump for T-410-1 C-O-C II Press ONLY.**

#### Replacement Parts:

CATALOG NUMBER	DESCRIPTION
<b>Newer Pumps:</b>	
T-421-FP	220v 4 wire Female electrical receptacle. See page 245 for illustration.
<b>Older T-411 Pumps:</b>	
T-411-B	By-pass module
T-411-G	Release Handle Spring (Models prior to 1982)
T-411-S	Micro-Switch (Models prior to 1982)
<b>Older T-401-1 Pumps:</b>	
T-401-1B	Replacement Gasket between motor and square reservoir
T-401-1BC	Breather Cap for Fenner-Stone pumps
T-401-1G	Relief Handle Spring (Models prior to 1982)
T-401-1S	Toggle Switch
T-401-SVF	Fenner Shuttle Valve
140-06761	Relay for T-421U or T-421U-BC pumps

## Equipment

### Coll-O-Crimp Pumps

#### T-412 • Mobile Electric Pump



For use with T-400-1 and  
T-420-1.

#### Pump Specifications:

**Dimensions:** 7-1/2" high, 14-1/2" long, 9" wide

**Weight:** 65 lbs.

**Operation Pressure:** 4000-4200 PSI

**Reservoir Capacity:** 3 quarts

**Outlet Port Size:** 3/4"-16 straight thread

**Motor:** 2 volt D.C.

**Hydraulic Oil:** SAE 10W hydraulic oil or (ATF) Automatic Transmission Fluid

**Flow:** 0.5 GPM

#### Replacement Parts:

CATALOG NUMBER	DESCRIPTION
T-401-1B	Replacement Gasket between motor and square reservoir
T-401-1BC	Breather Cap for Fenner-Stone pumps

#### T-421U • Electric Pump (220 Volt)

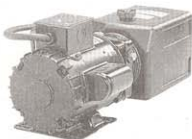

For use with T-400-1 and  
T-420-1.

#### Pump Specifications:

**Dimensions:** 7-1/2" high, 22" long, 10" wide

**Weight:** 75 lbs.

**Operation Pressure:** 4000-4200 PSI

**Reservoir Capacity:** 6 quarts

**Outlet Port Size:** 3/4"-16 Straight Thread

**Motor:** 1 H.P., 3450 R.P.M., 220 volts, 60 cycle, single phase  
At 50 Hertz, RPM = 2,850  
At 60 Hertz, RPM = 3,450

**Hydraulic Oil\*:** ISO 32 hydraulic oil or (ATF) automatic transmission fluid

**Flow:** 2.5 GPM @ 750 PSI, 0.5 GPM @ 4000 PSI

**Note:** It is recommended that the electric pump be used on a 15 amp. fused circuit. Pump wired for 220 volts, single phase.

#### Replacement Parts:

CATALOG NUMBER	DESCRIPTION
140-06761	Relay for T-421U, T-441 and T-441 pumps only
T-421U-BC	Breather Cap
T-421-FP	220v 4 wire Female electrical receptacle

\*For low temperature applications automatic transmission fluid can be substituted.

#### T-421U-110 • Electric Pump (110 Volt)

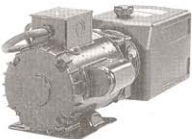

For use with T-400-1 and  
T-420-1.

For dimensional data other than voltage information, refer to T-421U see above.

**Note:** It is recommended that the electric pump be used on an individual 30 amp. fused circuit.

Pump wired for 110 volts, single phase.

#### Replacement Parts:

CATALOG NUMBER	DESCRIPTION
T-421U-BC	Breather Cap
T-421-FP	220v 4 wire Female electrical receptacle

## Equipment

### Coll-O-Crimp Pumps

#### T-433 • Two Stage Piston Pump (220v)



For use with T-407 Production Press, T-400-1 or T-420-1.

The Weatherhead T-433 two stage piston pump power unit is a high capacity pump especially suited for the T-407 Production crimp. It features a two stage piston pump providing high flow at low pressure for fast ram approach and low flow at high pressure for actual crimping. When used in conjunction with the T-433-2 connector cable, the T-433 can be used as an optional high capacity pump for the T-400-1 or T-420-1 Coll-O-Crimp® presses.

#### Pump Specifications:

##### Dimensions:

22" high, 12" long, 15" long

**Weight:** 127 lbs.

##### Operation Pressure:

4,000 PSI

##### Reservoir Capacity:

2 gallons

##### Outlet Port Size:

3/8" Pipe Thread

##### Motor:

1-1/2" H.P., 220 volts 60hz single phase

##### Hydraulic Oil:

Use Enerpac Oil ONLY

**Flow:** 2.78 GPM @ 800 PSI,  
0.52 GPM @ 4000 PSI

#### Replacement Parts:

T-421-FP 220v 4 wire Female electrical receptacle. See page 292.

T-433-2 Interlock Cable

T-433-1 Foot Switch Assembly

#### T-441 • Electric Pump (220 Volt)

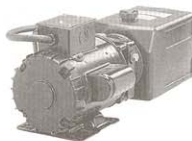

For use with T-440-1 only.

The Weatherhead T-441 power unit is designed for use with the latest Coll-O-Crimp® II Plus press. (Shown above only). It features a two-stage pump providing high flow at low pressure for fast ram approach and low flow at high pressure for actual crimping.

#### Pump Specifications:

**Dimensions:** 7-1/2" high, 22" long, 10" wide

**Weight:** 75 lbs.

##### Operation Pressure:

5,000 PSI

#### Reservoir Capacity:

6 quarts

##### Outlet Port Size:

3/4-16 Straight Thread O-Ring

**Motor:** 1 H.P., 3450 R.P.M., 220 volts, 60 cycle, single phase

**Hydraulic Oil:** ISO 32 hydraulic oil automatic transmission fluid

**Flow:** 2.5 GPM @ 750 PSI,  
0.5 GPM @ 5000 PSI

#### Replacement Parts:

T-421U-BC Breather Cap

T-421-FP 220v 4 wire Female electrical receptacle. See page 292.

140-06761 Relay for T-421U or T-421U-BC pumps

**Note:** T441 pump is to be used with T440-1 press only. When replacing the pump on a standard T-410 Coll-O-Crimp® II Press (without the black switchbox on the side of the press) refer to the repair and replacement items on page 231.)

#### T-460-2 • Hand Pump



For use with T-450-1, T-460 and T-465

#### Pump Specifications:

**Dimensions:** 5-5/8" High, 13-1/4" long, 3-3/4" wide

**Weight:** 4-1/2 lbs.

##### Operation Pressure:

0-10,000 PSI

##### Reservoir Capacity:

20 cu in.

##### Relief Valve Setting:

10,000 PSI

##### Hydraulic Oil:

Use Enerpac Oil ONLY

**Note:** For repair and replacement items for the following pumps please contact an Enerpac Distributor at [www.enerpac.com](http://www.enerpac.com): T-402-2, T-403-2, T-433, T-460-2, T-462-2, T-480-2, T-480-3, T-481-110 & T-482-2.

## Equipment

### Coll-O-Crimp Pumps

#### T-462-2 • Air/Hydraulic Pump



For use with T-462.

The Weatherhead T-462-2 power unit is a air/hydraulic pump designed for use with the T-462 portable system. Ideal if you have the availability of compressed air in your shop or in the field via a portable compressor.

#### Pump Specifications:

**Dimensions:** 4" high, 13" long

**Weight:** 8 lbs.

**Operation Pressure:** 0-10,000 PSI

**Reservoir Capacity:** 10 cu in.

**Relief Valve Setting:** 10,000 PSI

**Hydraulic Oil:** Use Enerpac Oil ONLY

Regulator to be set for 100-120 PSI inlet air.

#### T-480-2 • Two-Stage Hand Pump



For use with T-480-HP.

#### Pump Specifications:

**Dimensions:** 7-3/16" high x 21-1/64" long x 4-3/4" wide

**Weight:** 9 lbs.

**Operation Pressure:** 0-10,000 PSI

**Hydraulic Oil:** Use Enerpac Oil ONLY

#### T-480-3 • Turbo Air/ Hydraulic Pump



For use with T-480-TA.

#### Pump Specifications:

**Dimensions:** 8-1/4" High x 12-3/8" long x 8" wide

**Weight:** 16-1/2 lbs.

**Operation Pressure:** 0-10,000 PSI

**Hydraulic Oil:** Use Enerpac Oil ONLY

For repair and replacement items for the following pumps please contact an Enerpac Distributor at [www.enerpac.com](http://www.enerpac.com): T-402-2, T-403-2, T-460-2, T-462-2, T-480-2, T-480-3, T-481-110 & T-482-2.

## Equipment

### Coll-O-Crimp Pumps

#### T-481-110 • Electric Pump (110 volt)



For use with T-480-EP.

#### Pump Specifications:

**Dimensions:**14-14"High x  
9-5/8" long x 9-5/8" wide

**Weight:**32 lbs.

**Operation Pressure:**  
0-10,000 PSI

**Hydraulic Oil:** Use Enerpac  
Oil ONLY

#### T-482-2 • Air/Hydraulic Pump

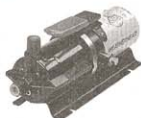

For use with T-480-AH.

#### Pump Specifications:

**Dimensions:**5"High, 14-5/8"  
long, 5-5/8" wide

**Weight:**12 lbs.

**Operation Pressure:**  
0-10,000 PSI

**Hydraulic Oil:** Use Enerpac  
Oil ONLY

#### T-421-FP • 4 Prong Female Electrical Outlet

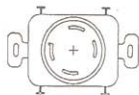

All Weatherhead 220v Coll-O-Crimp power pumps are equipped with a four prong electrical outlet as illustrated. To obtain corresponding female wall receptacle order T-421-FP. For use with T-421U, T-441 & T-433 pumps.

#### Repair and Replacement Items for Discontinued T-401-1 Pump

For repair and replacement items for the following pumps please contact an Enerpac Distributor at [www.enerpac.com](http://www.enerpac.com): T-402-2, T-403-2, T-480-2, T-462-2, T-480-2, T-480-3, T-481-110 & T-482-2.

CATALOG NUMBER	DESCRIPTION
T-401-1B	Replacement Gasket between motor and square reservoir
T-401-1BC	Breather Cap for Fenner-Stone pumps
T-401-1G	Relief Handle Spring (Models prior to 1982)
T-401-1S	Toggle Switch
T-401-SVF	Shuttle Valve for Fenner-Stone pump

## Equipment

### Conversion Tooling



Refer to safety information regarding Coll-O-Crimp hose, hose fittings and assembly equipment compatibility on page 3.

#### T-400-NP60 • Dayco to Weatherhead Conversion Kit



The T-400-NP60 Conversion Kit is designed to allow the use of standard Weatherhead Coll-O-Crimp tooling, hose and hose ends in the Dayco NP60, (2) tie rod, crimp machine. Everything is included to convert the crimper to accept Weatherhead tooling. This kit gives the crimper capacity to crimp up to and including 1-1/4" I.D. 4 spiral wire hose assemblies.

See pages 356-360 for collets and pages 361 for spacer rings.

#### T-400-NP60 Kit Includes:

<u>PART DESCRIPTION</u>	<u>QTY</u>
Base Plate Assembly	1
Dayco Pusher Spacer	1
3/8-16 x 1.75 Cap Screw	1
Adapter Ring for T-400 Collets	1
Instruction Kit	1

#### T-400-DE60 • Dayco to Weatherhead Conversion Kit



The T-400-DE60 Conversion Kit is designed to allow the use of standard Weatherhead Coll-O-Crimp tooling, hose and hose ends in the Dayco DE60, (4) tie rod, crimp machine. Everything is included to convert the crimper to accept Weatherhead tooling. This kit gives the crimper capacity to crimp up to and including 1-1/4" I.D. 4 spiral wire hose assemblies.

See pages 356-360 for collets and pages 361 for spacer rings.

#### T-400-DE60 Kit Includes:

<u>PART DESCRIPTION</u>	<u>QTY</u>
Base Plate Assembly	1
Dayco Pusher Spacer	1
3/8-16 x 1.75 Cap Screw	1
Adapter Ring for T-400 Collets	1
Instruction Kit	1



## Equipment

### Conversion Tooling



Refer to safety information regarding Coll-O-Crimp hose, hose fittings and assembly equipment compatibility on page 3.



#### T-400-GT • Gates PC707 Conversion Kit

The T-400-GT Conversion Kit is designed to allow the use of standard Weatherhead Coll-O-Crimp tooling, hose, and hose ends in the Gates PC707 crimper. Everything is included to convert the crimper to accept Weatherhead tooling. This kit gives the crimper capacity to crimp up to and including 1-1/4" I.D. 2 wire hose factory-type hose assemblies. This kit does not include the T-400-8 Die Ring which is required for crimping. If you do not already have the die ring or collets, you can order the kit below.

##### T-400-GT kit includes:

Pusher 10-24 x 1/4 Set  
Screws (2)  
Spacer (2) Instructions

#### T-400-PH • Parker 80c Conversion Kit

The T-400-PH Conversion Kit is designed to allow the use of standard Weatherhead Coll-O-Crimp tooling, hose, and hose ends in the Parker 80c crimper. Everything is included to convert the crimper to accept Weatherhead tooling. This kit gives the crimper capacity to crimp up to and including 1-1/4" I.D. 2 wire hose factory-type hose assemblies. If you do not already have the collets and spacer rings, you can order the kit below.

##### T-400-PH Kit includes:

1/4-20 x 1 Cap Screw (4) Dowel Pin Spacer (2)  
1/4" Lockwasher (4) Spacer Bracket (4)  
Adapter Die Ring Instructions

#### T-400-GTK • Gates PC707 Conversion Kit

Kit includes one each of the following:

CATALOG NUMBER	DESCRIPTION
T-400-GT	Conversion Kit
T-400-2C	'U' Series Collet - 1/4"
T-400-3C	'U' Series Collet - 3/8"
T-400-4C	'U' Series Collet - 1/2"
T-400-5C	'U' Series Collet - 3/4"
T-400-6C	'U' Series Collet - 1"
T-400-8	Die Ring - 3/16" thru 1-1/4"
T-400-10	Spacer Ring - Black
T-400-11	Spacer Ring - Silver

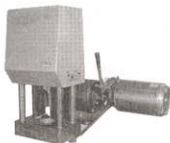

#### T-400-PHK • Parker 80c Conversion Kit

Kit includes one each of the following:

CATALOG NUMBER	DESCRIPTION
T-400-PH	Conversion Kit
T-400-2C	'U' Series Collet - 1/4"
T-400-3C	'U' Series Collet - 3/8"
T-400-4C	'U' Series Collet - 1/2"
T-400-5C	'U' Series Collet - 3/4"
T-400-6C	'U' Series Collet - 1"
T-400-10	Spacer Ring - Black
T-400-11	Spacer Ring - Silver

## Equipment

### Conversion Tooling



Refer to safety information regarding Coll-O-Crimp hose, hose fittings and assembly equipment compatibility on page 3.



#### T-400-GY • Goodyear 99060 Conversion Kit

The T-400-GY Conversion Kit is designed to allow the use of standard Weatherhead Coll-O-Crimp tooling, hose and hose ends in the Goodyear 99060 crimper. Everything is included to convert the crimper to accept Weatherhead tooling. This kit gives the crimper capacity to crimp up to and

including 1-1/4" I.D. 2 wire hose factory-type hose assemblies. This kit does not include the T-400-8 Die Ring which is required for crimping. If you do not already have the die ring or collets, you can order the kit below.

#### T-400-GY Kit includes:

Bracket, Base and Instructions

#### T-400-GYK • Goodyear 99060 Conversion Kit

Kit includes one each of the following:

CATALOG NUMBER	DESCRIPTION
T-400-GY	Conversion Kit
T-400-2C	'U' Series Collet - 1/4"
T-400-3C	'U' Series Collet - 3/8"
T-400-4C	'U' Series Collet - 1/2"
T-400-5C	'U' Series Collet - 3/4"
T-400-6C	'U' Series Collet - 1"
T-400-8	Die Ring - 3/16" thru 1-1/4"
T-400-10	Spacer Ring - Black
T-400-11	Spacer Ring - Silver

## Equipment

### Cabinets

#### C-40X • Stock Cabinet



Ideal for mounting the T-400-1 Coll-O-Crimp I Press and Pump or T-420-1 Coll-O-Crimp Super I. The sturdy C-40X Cabinet contains 40 heavy-duty plastic drawers that can be divided into one, two, three, or four compartments providing space for a large selection of Coll-O-Crimp hose ends and adapters.

**Drawers:** PD-40 (one drawer)

**Dividers:** PD-20 (24 per set)

**Size:** 46-1/2" high, 40" wide, 26" deep at base, 18" deep at top

**Weight:** 228 lbs.

#### FH-135X • Stock Cabinet



The sturdy FH-135X Cabinet contains 50 heavy-duty plastic drawers that can be divided into one, two, or three compartments allowing you ample space for a large selection of Coll-O-Crimp hose ends and adapters. Ideal for mounting the Coll-O-Crimp I Press and Pump.

**Drawers:** PD-95 (one drawer)

**Dividers:** PD-15 (30 per set)

**Size:** 46-1/2" high, 33" wide, 14-1/2" deep

**Weight:** 115 lbs.

#### FH-15X • Stock Cabinet

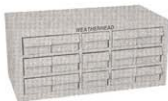

Here is the ideal way to organize your inventory of hose ends and adapters. The rugged FH-15X Cabinet contains 15 plastic drawers for stocking hose ends and adapters.

**Drawers:** PD-95 (one drawer)

**Dividers:** PD-15 (30 per set)

**Size:** 13-5/8" high, 14-3/8" deep, 30-1/4" wide

**Weight:** 45 lbs.

## Equipment

### Cabinets

#### FH-40X • Stock Cabinet

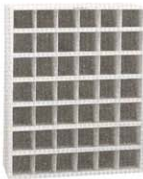

Provides convenient storage areas for those large size fittings and hose ends. This durable 20 gage steel cabinet is made to handle abuse.

**Size:** 35" wide, 42" high, 12" deep

**Weight:** 200 lbs.

**Note:** Will not support Weatherhead Coll-O-Crimp equipment.

#### FH-72X • Stock Cabinet

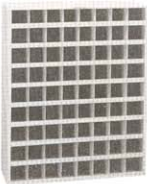

Large capacity all-welded cabinet provides 72 storage compartments. Fabricated from 20 gage steel, the FH-72X will provide years of continued service.

**Size:** 35" wide, 42" high, 12" deep

**Weight:** 200 lbs.

**Note:** Will not support Weatherhead Coll-O-Crimp equipment.

#### C-5X • Stock Cabinet



This mini-cabinet is designed to contain your oversized Weatherhead hose ends which may not currently have an organized home.

**Size:** 30" wide, 5-7/8" high, 9-5/16" deep

**Weight:** 10 lbs.

## Equipment

### Cabinets

#### TC-20 • Collet Cabinet

The TC-20 Cabinet provides you easy access to all of your tooling needs. There is ample space for collets, spacer rings, and related Coll-O-Crimp tooling.

**Size:** 28-1/2" high, 26-1/2" wide, 12-3/4" deep

**Weight:** 37-1/2 lbs.



#### HD-1X • Hose Cabinet

The HD-1X Cabinet offers you the ideal solution for keeping 50 foot lengths of hose off your floor. Vertical slots in the cabinet keep your hoses organized and clean. Consider bolting an FH-15X Stacking Cabinet on top of the HD-1X to keep an inventory of hose ends readily available.

**Size:** 36" high, 24" deep, 31" wide

**Weight:** 83 lbs.



#### HD-2X • Hose Center Display

The HD-2X hose display is built with a heavy steel inner frame which supports the weight of the hose reels, while its tough wooden sides provide additional durability. It is designed to hold both Weatherhead bulk reels and boxed product. Handles are even provided to make loading the hose as safe and easy as possible.

**Measurements:** 22" wide x 30" deep x 57" tall

**Weight:** 54 lbs. (UPS Shipping)

**Max. Capabilities:** (3) Reels or (2) Reels & (4) Boxes (Hose not included)



## Equipment

### Cabinets and Bags

#### T-460-10BB Coll-O-Crimp Tool Box



The T-460-10BB Tool Box complements our T-460 and T-462 portable crimpers by offering you storage for your collets, spacer rings, and perhaps an assortment of hose ends.

**Measurements:** 25"x9"x8"

#### T-460-TR Tool Rack



The T-460-TR wall mounted tool rack is rugged and built to last! The perfect shop accessory for Coll-O-Crimp machines, the T-460-TR stores up to 10 collets and 4 spacer rings- organized and within easy reach.

(The T-460-TR rack does not include tooling)

**Measurements:** 24 -1/2" Wide x 16" High x 7-1/2" Deep

**Weight:** 16 lbs.

#### Plastic Bags



Weatherhead heavy-duty plastic bags for Weatherhead fittings come in sizes 5"x6", 6"x10", and 8"x12". The bags include convenient spaces for labeling.

CATALOG NUMBER	DESCRIPTION	QTY
5x6 PB	Plastic Bag	100
6x10 PB	Plastic Bag	100
8x12 PB	Plastic Bag	100

## Equipment

### Label Sets

#### Self Adhesive Label Sets



For C-40X, FH-15X and FH-135X Cabinets

LABEL NUMBER	DESCRIPTION
FS-100	Swivel Adapters
FS-200	JIC Steel Adapters
FS-300	Split Flange Adapters
FS-400	Field Attachable Hose Ends - 009 'B' Series
FS-500	Barb-Tite® 100 'B' and 105 'B' Series Hose Ends
FS-600	Field Attachable Hose Ends - 069 'D' & 247 'N' Series
FS-700	Field Attachable Hose Ends - 425 'N' Series
FS-800	Field Attachable Hose Ends - 338 'B' Series & Brass Air Brake Fittings for Copper Tubing
FS-1100	Coll-O-Crimp Hose Ends - 'U' Series
FS-1200	Coll-O-Crimp Hose Ends - 'E' Series
FS-1300	Coll-O-Crimp Hose Ends - 430 'E' Series
FS-1500	Coll-O-Crimp Hose Ends - 069 'E' Series
FS-1600	7000 Series Flareless Fitting
FS-1800	Coll-O-Crimp Hose Ends - 470 'E' Series and 570 'S' Series
FS-2000	Steel Pipe
FS-2200	Ready-Lok® Hose Ends and Adapters
FS-2300	Drain Cocks, Valves and Select 338 'B' Series Hose Ends
FS-2400	FOR-SEAL® Adapters Label Set
FS-2500	Metric Hose Ends ('U' Series) and Metric Flareless Nuts/Sleeves
FS-2800	Field Attachable Hose Ends - 213 'N' Series
FS-2900	Coll-O-Crimp Hose Ends - 338 'P' Series
FS-3100	Coll-O-Crimp Hose Ends - 430 'U' Series No-Skive
FS-3200	Coll-O-Crimp Hose Ends - 757 'E' Series
FS-3300	Quick Connect Air Brake 1800 Series
FS-3400	Coll-O-Crimp Hose Ends - 'M' Series
FS-3500	Coll-O-Crimp Hose Ends - 336 'E' Series

#### A-2103 Mylar Hose Labels

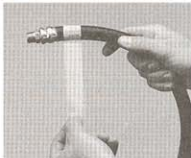

Eaton now offers Mylar labels for marking hose assemblies. They are self adhesive Mylar strips, 1" wide by 3-3/4" long, with a 1" x 1" white area on one end for printed information. They are supplied on a fan-folded computer form, 3 labels per row, 8 rows per page, 2500 labels to a carton. The format is suitable for use in typewriters and tractor feed or friction drive printers.

Whether for compliance with federal hose assembly labeling requirements, or for simply meeting customer demands for labeling hose assemblies, we strongly recommend labeling become part of your hose assembly "manufacturing" procedure. The National Highway Traffic Safety Administration places responsibility for labeling an air brake hose assembly in the hands of the "manufac-

turer" of the hose assembly. (Not the manufacturer of the hose or hose ends.) For a summary of air brake hose assembly labeling recommendations, see "Air Brake Hose Assembly Guidelines." For specific air brake hose assembly regulations, consult "Federal Motor Vehicle Safety Standard (FMVSS) 571.106," available from NHTSA, at the address listed below. For use other than air brake applications, customers may want additional information on the labels. Generally, the labels will accept 9-10 characters per row, on 4 or 5 rows. The information can be handwritten, typed or printed on the labels. The main concern is resistance to the elements. Procedure for applying the labels is simple:

1. Print the appropriate information on the label.
2. Wrap the tag around the hose assembly; printed end first.
3. Cover the printed end with the clear mylar tail of the label.
4. The clear tail will protect the printed area from the elements.

Office Of Vehicle Safety Standards  
National Highway Traffic Safety Administration  
400 Seventh Street SW  
Washington, DC 20590  
Phone (202) 366-5317  
[www.nhtsa.dot.gov](http://www.nhtsa.dot.gov)

## Equipment Assortments

### AB-8 & AB-9 • Air Brake Air Chamber Hose



### Assembly Assortment of 3/8" and 1/2" I.D. Lines

Each selection of fourteen ready-made air chamber hose assemblies facilitate replacement of hoses. Eliminates time and cost of making special assemblies. Wall rack keeps assemblies handy and ready to use.

### AB-8 • 1/2" I.D. Air Brake Air Chamber Lines

LENGTH	QUANTITY	CATALOG NUMBER
18-1/2"	1	38353-01800
20-3/8"	1	38353-02037
24-1/8"	1	38353-02400
28-3/8"	1	38353-02837
30-1/8"	1	38353-03000
32"	1	38353-03200
34-3/8"	1	38353-03437
36-1/8"	1	38353-03600
41-1/8"	1	38353-04112
		AB-8X (rack only)

Replacement Labels: AB-8L

### AB-9 • 3/8" I.D. Lines Air Brake Air Chamber Lines

LENGTH	QUANTITY	CATALOG NUMBER
18-1/2"	1	38166-01812
20-3/8"	2	38166-02137
24-1/8"	2	38166-02412
28-3/8"	2	38166-02837
30-1/8"	2	38166-03012
32"	1	38166-03200
34-3/8"	1	38166-03437
36-1/8"	2	38166-03612
41-1/8"	1	38166-04112
		AB-9X (rack only)

Replacement Labels: AB-9L

### CA-130 & CA-230 • Clamp Assortments



You can now increase your all-stainless steel or part-stainless steel clamp sales with these all-purpose clamp assortments. These rugged assortments can be wall mounted or stand free using less than 2 sq. ft. of counter space. They load easily and organize your merchandise effectively.

### CA-130 • Part-Stainless Steel

CATALOG NUMBER	QUANTITY
6205-004	20
6205-006	10
6203-010	20
6203-016	20
6203-020	20
6203-024	10
6203-036	10
CA-10X (rack only)	1

### CA-230 • All-Stainless Steel

CATALOG NUMBER	QUANTITY
6206-004	20
6206-006	10
6204-010	20
6204-016	20
6204-020	20
6204-024	10
6204-036	10
CA-10X (rack only)	1



## Equipment Assortments

### RG-24 • Hydraulic O-Ring Assortment



Eaton's RG-24 is your solution to storing a useful inventory of hydraulic o-rings. This kit contains o-rings for Eaton's straight thread and FOR-SEAL® tube fitting applications as well as popular (code 61) split flange hydraulic applications. The RG-24 comes enclosed in a handy steel case with a carrying handle. Consider an

RG-24 for an over-the-counter sales merchandiser or keep one in your equipment shop or maintenance trailer to prepare for those critical "got-to-have-it" applications.

Twenty-four individual compartments keep your hydraulic o-ring inventory separated by part number, and labelled illustrations on the inside of

the assortment prevent the mix-up of o-rings. Compact, organized and reasonably priced, if you specialize in hydraulic applications which call for o-rings – we've got your number – RG-24.

#### RG-24 • O-Ring Assortment Contents

PART NUMBER	SPLIT FLANGE QUANTITY	PART NUMBER	FOR-SEAL® QUANTITY	PART NUMBER	STRAIGHT THR. QUANTITY
8x252	12	4629x4	12	7629x4	12
12x252	12	4629x6	12	7629x5	12
16x252	12	4629x8	12	7629x6	12
20x252	12	4629x10	12	7629x8	12
24x252	12	4629x12	12	7629x10	12
32x252	12	4629x16	12	7629x12	12
		4629x20	12	7629x16	12
		4629x24	12	7629x20	12
				7629x24	12
				7629x32	12

### FL-310 • Fuel Hose and Fittings Assortment



FL-310 contains 250' of Weatherhead fuel line hose, a variety of brass hose end fittings, and gear-type clamps for easy, instant service on fuel and oil line assemblies.

A well-designed cabinet keeps 1/4", 5/16", 3/8", or 7/16" I.D. hose on reels free of kinks and tangles...

ready for instant use. Ten clear plastic drawers with color-coded illustrated labels are provided for storing hose end fittings and clamps. H057 hose is compatible with unleaded gasolines and low pressure fuel systems.

**Size:** 30" wide, 13-1/2" high, 13" deep

CATALOG NUMBER	QUANTITY	CATALOG NUMBER	QUANTITY
05704B-102	10	05706B-104	10
05704B-104	5	05706B-106	5
05704B-C02	5	05706B-1568	5
05705B-102	10	05706B-1570	5
05705B-104	10	05706B-C02	5
05705B-1560	5	05706B-C04	5
05705B-1561	5	6202	20
05705B-C02	5	CL-434	1
05705B-C04	5	FL-310X	1
05706B-102	10	H05704	100'
		H05705	100'
		H05706	50'

## Equipment Assortments

### SR3100W • Weatherhead Air Conditioning Assortment



Air Conditioning Assortment Kit; containing the most popular steel air conditioning hose ends for use with H757 air conditioning hose.

#### Included in Kit:

(various sizes)

- Bumped Tube O-Ring Male Swivels
- Bumped Tube O-Ring Male Swivel 90° Tube Elbows
- O-Ring Assortment
- Stackable Sturdy Steel Case (18" x 12" x 3")

CATALOG NUMBER	QTY.	CATALOG NUMBER	QTY.	CATALOG NUMBER	QTY.	CATALOG NUMBER	QTY.
75706E-Z47	4	75706E-Z87	4	75708E-Z08	4	ZW74706	4
75708E-Z49	4	75708E-Z89	4	75710E-Z10	4	ZW74708	4
75710E-Z51	4	75710E-Z91	4	75712E-Z12	4	ZW74710	4
75712E-Z51	4	75712E-Z91	4	75706E-Z66	4	ZW74712	4
75712E-Z53	4	75712E-Z93	4	75708E-Z68	4		
		75706E-Z06	4	75710E-Z70	4		

### FF12139 • E-Z Clip System™



The E-Z Clip System is designed for assembly with Weatherhead Multi-Refrigerant hose GH134. It's engineered connection exceeds SAE J2064 and has been vibration and impulse tested.

**Note:** The E-Z Clip System has been designed to work exclusively with Weatherhead GH134 Hose.

#### Kit Contents Components

PART NUMBER	DESCRIPTION	QTY/PER KIT
1F40104-size	Clips	20 each size
1F40105-size	Cages	10 each size
FT1357	Assy. Tool	1
T-135	Hose Cutter	1
T-135B	Replacement Blade	1

### BL-456 • Barb-Tite® Fittings and Hose Assortment



Making up an air line – oil line – transmission or power steering return line? The BL-456 assortment puts Eaton Barb-Tite® fittings and 1/4", 5/16", and 3/8" I.D. 350 PSI maximum operating pressure H101 hose at your fingertips for quick and easy assembly. Simply push ends on hose, and you have a hose assembly. No clamps required!

Measure the hose on top of the cabinet with the rule provided and then select the proper hose ends from the assortment in the two metal drawers. Within minutes the hose assembly is ready for installation.

**Size:** 15" wide, 16-1/2" high, 13-3/16" deep  
16 Compartments in each drawer.

CATALOG NUMBER	QUANTITY	CATALOG NUMBER	QUANTITY	CATALOG NUMBER	QUANTITY	CATALOG NUMBER	QUANTITY
10004B-102	4	10004B-B04	4	10005B-C02	4	10006B-606	4
10004B-104	4	10004B-B05	4	10005B-C04	4	10006B-B06	4
10004B-304	4	10004B-Y04	4	10005B-Y05	4	10006B-Y06	4
10004B-305	4	10005B-102	4	10006B-102	4	H10104	25'
10004B-405	4	10005B-104	4	10006B-104	4	H10105	25'
10004B-604	4	10005B-405	4	10006B-106	4	H10106	25'
10004B-A04	4	10005B-B05	4	10006B-306	4	FS-501	1
10004B-A05	4	10005B-B06	4	10006B-406	4	BL-456X	1
10004B-B03	4						

# Equipment Assortments

## Fleet Hose and Fitting Assortment



These assortments are ideal for servicing that fleet account. The DOT-approved hose and fittings will enable the user to make up cham-

ber lines, connect to glad-hand couplings, and provide routing for air brake lines. The general purpose H069 provides for fuel, oil, water,

power steering, and transmission lines. A self-contained assortment in a super cabinet, all set up for easy serviceability!

### FA-100 • Fleet Hose and Fitting Assortment (with Cabinet)

CATALOG NUMBER	QUANTITY	CATALOG NUMBER	QUANTITY	CATALOG NUMBER	QUANTITY
H06904	50'	24706N-106	5	24710N-608	5
H06906	50'	24706N-406	5	24710N-610	2
H06908	50'	24706N-604	5	33806-A	20
H06910	50'	24706N-605	5	33806-B	5
H16606	50'	24706N-606	5	33806B-Y06	5
H16608	50'	24706N-608	5	33806B-Y24	5
H33806	50'	24706N-756	5	33806B-Y26	2
24704N-102	5	24706N-B06	5	33806B-Y28	5
24704N-104	5	24708N-106	5	33806B-Y34	5
24704N-604	5	24708N-108	5	33806B-Y36	5
24704N-B04	5	24708N-406	5	33806B-Y38	5
24705N-104	5	24708N-608	5	FH-15X	1
24705N-605	5	24710B-Y58	2	HD-1X	1
24705N-B05	5	24710B-Y60	5		
24706N-104	5	24710N-108	5		

### FA-100-CO • Fleet Hose and Fitting Assortment (Contents Only)

CATALOG NUMBER	QUANTITY	CATALOG NUMBER	QUANTITY	CATALOG NUMBER	QUANTITY
H06904	50'	24706N-106	5	24710N-608	5
H06906	50'	24706N-406	5	24710N-610	2
H06908	50'	24706N-604	5	33806-A	20
H06910	50'	24706N-605	5	33806-B	5
H16606	50'	24706N-606	5	33806B-Y06	5
H16608	50'	24706N-608	5	33806B-Y24	5
H33806	50'	24706N-756	5	33806B-Y26	2
24704N-102	5	24706N-B06	5	33806B-Y28	5
24704N-104	5	24708N-106	5	33806B-Y34	5
24704N-604	5	24708N-108	5	33806B-Y36	5
24704N-B04	5	24708N-406	5	33806B-Y38	5
24705N-104	5	24708N-608	5		
24705N-605	5	24710B-Y58	2		
24705N-B05	5	24710B-Y60	5		
24706N-104	5	24710N-108	5		

## HA-574 • Fuel Hose Merchandiser



Now you can make those custom hose assemblies in minutes for instant service on fuel and oil line replacements. The attractive HA-574 includes H057 hose in all popular sizes for low pres-

sure fuel, EEC and PCV lines. Weatherhead H057 low pressure fuel line hose has Nitrile inner tube, fiber braid reinforcement, and Hypalon cover for long life compatibility with gasohol,

leaded and unleaded fuels. The HC-574X rack can be easily installed on pegboard, wall, or metal shelving with the included hardware.

CATALOG NUMBER	QUANTITY	DESCRIPTION
H05703	25'	Hose
H05704	25'	Hose
H05705	25'	Hose
H05706	25'	Hose
HC-574X	1	Rack + 4 Dowels

# Equipment

## Assortments

### MA-100 • Metric Adapter Assortment

(with Cabinet)



The MA-100 is an ideal assortment to begin a metric adapter inventory. Offered are a variety of male British Standard Tapered Pipe and British Standard Parallel fittings in straight and 90° elbow configurations, sizes ranging from 1/8" through 1-1/4". Two male DIN (German metric) fittings adapt SAE fittings and hose

ends to metric size tubing, and a third DIN fitting connects SAE fittings with metric female swivel adapters, sizes ranging from 6mm through 42mm. The C5165X metric sleeves adapt metric tubing used with standard JIC fittings. The MA-100 is supplied with cabinet for accurate and easy access to your metric fittings.

### Replacement Drawers:

PD-49 (one drawer)

### Replacement Dividers:

PD-75 Set (25/set)

### MA-100 Contents

CATALOG NUMBER	QTY.	CATALOG NUMBER	QTY.	CATALOG NUMBER	QTY.	CATALOG NUMBER	QTY.	CATALOG NUMBER	QTY.
7165X6MM	5	M9700X5X8	2	MB5515X6X4	5	MC5208X6X6	2	MH7105X6	5
7165X8MM	2	M9700X6X10	2	MB5515X6X6	5	MC5208X8X10	2	MH7105X8	5
7165X10MM	5	M9700X8X12	2	MB5515X8X6	5	MC5208X10X14	2	MH7105X10	5
7165X12MM	5	M9700X10X14	2	MB5515X8X8	5	MC5208X12X16	2	MH7105X12	5
7165X14MM	5	M9700X12X20	2	MB5515X10X12	5	MC5315X4X10	2	MH7105X14	5
7165X15MM	5	M9700X16X25	2	MB5515X12X12	5	MC5315X4X12	2	MH7105X16	5
7165X16MM	5	M9700X20X32	1	MB5515X16X16	2	MC5315X6X14	2	MH7105X20	5
7165X18MM	5	M9800X4X4	2	MB5515X20X20	2	MC5315X6X16	2	MH7105X25	5
7165X20MM	5	M9800X5X4	2	MC5205X4X2	5	MC5315X8X18	2	MH7105X30	5
7165X22MM	5	M9800X6X4	2	MC5205X4X4	5	MC5315X10X20	2	ML7105X6	5
7165X25MM	5	M9800X8X4	2	MC5205X5X4	5	MC5315X12X22	2	ML7105X8	5
7165X28MM	5	M9800X8X6	2	MC5205X6X4	5	MC5315X12X27	2	ML7105X10	5
7165X30MM	5	M9800X8X8	2	MC5205X6X6	5	MC5315X16X33	2	ML7105X12	5
M7629X10	5	M9800X10X8	2	MC5205X8X6	5	MC5315X20X42	1	ML7105X15	5
M7629X14	5	M9800X12X8	2	MC5205X8X8	5	MC5405X4X4	5	ML7105X18	5
M7629X16	5	M9800X12X12	2	MC5205X10X8	5	MC5405X5X4	5	ML7105X22	5
M7629X18	5	M9800X16X12	2	MC5205X10X12	5	MC5405X6X4	5	ML7105X28	5
M7629X20	5	M9800X16X16	2	MC5205X12X12	5	MC5405X6X6	5	C5165X4X6MM	5
M7629X22	5	M9800X20X20	1	MC5205X16X16	2	MC5405X8X6	5	C5165X5X8MM	5
M7629X27	5	MB5315X4X2	5	MC5205X20X20	2	MC5405X8X8	5	C5165X6X10MM	5
M7629X33	5	MB5315X4X4	5	MC5206X4X6	2	MC5405X10X12	5	C5165X8X12MM	5
M7629X42	5	MB5315X5X4	5	MC5206X6X8	2	MC5405X12X15	5	C5165X10X14MM	5
M9600X4X4	2	MB5315X6X4	5	MC5206X8X10	2	MC5405X16X16	2	C5165X10X15MM	5
M9600X5X4	2	MB5315X6X6	5	MC5206X8X12	2	MC5405X20X20	2	C5165X10X16MM	5
M9600X6X4	2	MB5315X8X6	5	MC5206X10X15	2	MC5515X4X12	2	C5165X12X18MM	5
M9600X6X6	2	MB5315X8X8	5	MC5206X12X18	2	MC5515X6X14	2	C5165X14X20MM	5
M9600X8X6	2	MB5315X10X12	5	MC5207X4X6	2	MC5515X6X16	2	C5165X16X25MM	5
M9600X8X8	2	MB5315X12X12	5	MC5207X6X8	2	MC5515X8X18	2	C5165X20X30MM	5
M9600X10X8	2	MB5315X16X16	2	MC5207X8X10	2	MC5515X10X20	2	C5165X20X32MM	5
M9600X12X12	2	MB5315X20X20	2	MC5207X8X12	2	MC5515X12X22	2	C-5X	1
M9600X16X16	2	MB5515X4X4	5	MC5207X10X15	2	MC5515X12X27	2	C-63X	1
M9600X20X20	1	MB5515X5X4	5	MC5207X12X18	2	MC5515X16X33	1	CL-502	1
M9700X4X6	2							TA-1002	1

## Equipment

### Assortments

#### MA-200 • Metric Hose End Assortment

(with Cabinet)

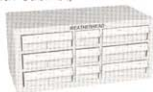

The MA-200 Hose End Assortment offers an excellent introductory stock of metric hose ends. Coverage includes 'U' Series British Standard Tapered Pipe (BSPT) and British Standard Parallel Pipe (BSPP) in male straight, and female swivel

in straight and 90° tube elbow connections, swivels, and split flange ends for Komatsu and Link Belt applications and DIN stand-pipe hose ends in light and heavy series. One FH-15X stock cabinet is supplied for storage.

#### MA-200 Contents

CATALOG NUMBER	QTY.	CATALOG NUMBER	QTY.	CATALOG NUMBER	QTY.	CATALOG NUMBER	QTY.	CATALOG NUMBER	QTY.
04U-14K	2	06U-76P	2	12U-162	2	16U-P66	2	MH7105X14	2
04U-154	5	08U-158	5	12U-30K	2	7165X8MM	5	MH7105X16	2
04U-354	5	08U-22K	2	12U-362	2	7165X10MM	4	MH7105X20	2
04U-38T	2	08U-358	5	12U-52T	2	7165X12MM	2	MH7105X25	2
04U-40T	2	08U-360	5	12U-55T	2	7165X14MM	2	MH7105X30	1
04U-P54	5	08U-45T	2	12U-G12	2	7165X15MM	2	ML7105X8	2
04U-74P	2	08U-46T	2	12U-G42	2	7165X16MM	2	ML7105X10	2
06U-156	5	08U-P56	2	12U-P62	2	7165X18MM	2	ML7105X12	2
06U-18K	2	08U-P58	2	12U-82P	2	7165X20MM	2	ML7105X15	2
06U-356	5	08U-78P	2	16U-166	2	7165X22MM	2	ML7105X18	2
06U-358	2	08U-80P	5	16U-33K	2	7165X25MM	2	ML7105X22	2
06U-40T	2	10U-24K	2	16U-366	2	7165X28MM	2	ML7105X28	2
06U-42T	2	10U-48T	2	16U-58T	2	7165X30MM	1	FH-15X	2
06U-44T	2	10U-50T	2	16U-60T	1	MH7105X8	2	FS-2500	1
06U-P56	2	10U-G09	2	16U-G16	2	MH7105X10	2		
06U-P58	2	10U-G69	2	16U-G46	2	MH7105X12	2		

#### FA-15 • Portable Coil-O-Crimp Assortment

(with Cabinet)



This portable assortment includes everything you need to service your hydraulic hose needs on the job site. Three sizes of 2 wire hose plus a variety of hose ends and adapters combined with a crimping system that requires no electrical power source makes this assortment the ultimate for

field repairs. A 15-drawer cabinet is included for storage. Also available are assortments with a cut-off saw or less the equipment.

**FA-15:** Includes contents listed below.

**FA-15-CO:** Includes contents listed below less equipment and cabinet.

**FA-15-NH:** Includes contents listed below less hose.

**FA-15-80:** Includes contents listed below plus T-80 Saw.

#### FA-15 Contents

CATALOG NUMBER	QTY.	CATALOG NUMBER	QTY.	CATALOG NUMBER	QTY.	CATALOG NUMBER	QTY.	CATALOG NUMBER	QTY.
04U-102	5	06U-506	5	06U-P08	5	08U-P08	5	H42508	50'
04U-104	10	06U-508	5	08U-106	5	08U-P10	5	T-465-HPU	1
04U-106	5	06U-606	10	08U-108	10	9205X2X2	5	FS-1100	1
04U-604	10	06U-608	5	08U-112	5	9205X4X4	5	FS-100	1
04U-605	5	06U-666	5	08U-508	5	9205X6X6	5		
04U-606	5	06U-668	5	08U-510	5	9205X8X8	5		
04U-B04	5	06U-755	5	08U-512	5	9405X4X4	5		
04U-J04	5	06U-756	5	08U-608	10	9405X6X6	5		
06U-104	10	06U-806	5	08U-610	5	9405X8X8	5		
06U-106	10	06U-866	5	08U-612	5	FH-15X	1		
06U-108	5	06U-J06	5	08U-688	5	H42504	50'		
06U-406	5	06U-J08	5	08U-J08	5	H42506	50'		

# Equipment

## Assortments

### FA-135 • Coll-O-Crimp I Assortment

(with Cabinet)



This assortment includes everything you need to start servicing hydraulic hose applications in your own shop. Five sizes of 2 wire hose along with a variety of hose ends and adaptors gives you the versatility you need. In addition there is hose for power steering applications and a cabinet for storage. Also available are assortments with a cut-off saw or less the equipment.

FA-135: Includes contents listed below.

FA-135-CO: Includes contents listed below less equipment and cabinet.

FA-135-NH: Includes contents listed below less hose.

FA-135-10B: Includes contents listed below plus T-10B Saw.

### FA-135 Contents

CATALOG NUMBER	QUANTITY	CATALOG NUMBER	QUANTITY	CATALOG NUMBER	QUANTITY
04U-102	5	06U-J08	5	12U-P12	5
04U-104	10	06U-P06	5	16U-116	5
04U-106	5	06U-P08	5	16U-516	2
04U-504	5	08U-058	5	16U-616	5
04U-505	5	08U-106	5	16U-676	1
04U-506	5	08U-108	10	16U-J16	1
04U-604	10	08U-112	5	41157X6	5
04U-605	5	08U-208	2	9205X2X2	5
04U-606	5	08U-508	5	9205X4X4	5
04U-664	5	08U-510	5	9205X6X6	5
04U-B04	5	08U-512	5	9205X6X8	5
04U-J04	5	08U-608	10	9205X8X6	5
06U-104	10	08U-610	5	9205X8X8	5
06U-106	10	08U-612	5	9405X4X4	5
06U-108	5	08U-668	5	9405X6X6	5
06U-206	5	08U-670	5	9405X8X8	5
06U-406	5	08U-758	5	9405X12X12	2
06U-448	5	08U-760	5	C5205X4X4	2
06U-506	5	08U-J08	5	C5205X6	4
06U-508	5	08U-P08	5	C5205X6X6	4
06U-606	10	08U-P10	5	C5205X8	4
06U-608	5	08U-R70	5	C5205X10	2
06U-610	5	12U-112	10	FH-135X	1
06U-666	5	12U-116	2	FS-1100	1
06U-668	5	12U-412	5	FS-100	1
06U-686	5	12U-512	5	FS-200	1
06U-755	5	12U-514	2	H32406	50'
06U-756	5	12U-516	2	H42504	50'
06U-B05	5	12U-610	5	H42506	50'
06U-B06	5	12U-612	10	H42508	50'
06U-B46	5	12U-614	5	H42512	50'
06U-B66	5	12U-616	2	H42516	50'
06U-J04	5	12U-672	2	T-401	1
06U-J06	5	12U-J12	5		

# Equipment

## Assortments

### CA-50 • Coll-O-Crimp Super I Assortment (with Cabinet)

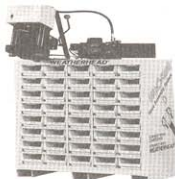

The CA-50 assortment includes everything you need to service your larger hydraulic applications. Five sizes of 2 wire hose and four sizes of 4 wire hose combined with a variety of hose ends and adapters gives you the coverage you need. Included with this

assortment are skiving tools and a 40-drawer cabinet for mounting your press and storage. Also available are assortments with a cut-off saw or less the equipment.

**CA-50:** Includes contents listed below.

**CA-50-CO:** Includes contents listed below less equipment and cabinet.

**CA-50-NH:** Includes contents listed below less hose.

**CA-50-60A:** Includes contents listed below plus T-60A Saw.

### CA-50 Contents

CATALOG NUMBER	QTY.	CATALOG NUMBER	QTY.	CATALOG NUMBER	QTY.	CATALOG NUMBER	QTY.
04U-102	5	08U-512	5	43012U-G12	1	C5205X4	4
04U-104	10	08U-608	10	43012U-G42	1	C5205X4X4	2
04U-106	5	08U-610	5	43012U-G72	1	C5205X6	4
04U-504	5	08U-612	5	43016U-116	2	C5205X6X6	4
04U-506	5	08U-668	5	43016U-616	2	C5205X8	4
04U-604	10	08U-670	5	43016U-G16	1	C5205X8X8	4
04U-605	5	08U-688	5	43016U-G46	1	C5205X10	2
04U-606	5	08U-758	5	43016U-G76	1	C5205X12	2
04U-664	5	08U-760	5	43020U-120	1	C5205X16	1
04U-604	5	08U-J08	5	43020U-620	1	C5315X8	1
04U-J04	5	08U-P08	5	43020U-G20	1	C5405X6	2
08U-104	10	08U-P10	5	43020U-G50	1	C5405X6X6	2
08U-106	10	12U-112	10	43020U-G80	1	C5405X8	2
08U-108	5	12U-116	2	9205X2X2	5	C5405X8X8	2
08U-406	5	12U-412	5	9205X4X4	5	C5405X10	1
08U-506	5	12U-512	5	9205X6X6	5	C5515X8	1
08U-508	5	12U-610	5	9205X6X8	5	H24504	50'
08U-604	5	12U-612	10	9205X8X6	5	H24506	50'
08U-606	10	12U-614	5	9205X8X8	5	H24508	50'
08U-608	5	12U-616	2	9205X12X12	2	H24512	50'
08U-610	5	12U-672	2	9205X16X16	1	H24516	50'
08U-666	5	12U-692	2	9405X4X4	5	H43008	50'
08U-668	5	12U-J12	5	9405X6X6	5	H43012	50'
08U-755	5	16U-116	5	9405X8X8	5	H43016	50'
08U-756	5	16U-516	2	9405X12X12	2	H43020	50'
08U-B06	5	16U-616	5	9405X16X16	1	T-420-N	1
08U-B66	5	16U-676	1	C-40X	1	FS-1100	1
08U-J06	5	16U-J16	1	C5105X4	2	FS-100	1
08U-J08	5	43008U-108	2	C5105X6	2	FS-200	1
08U-P08	5	43008U-608	2	C5105X8	2	FS-3100	1
08U-106	5	43008U-G08	1	C5105X12	1		
08U-108	10	43008U-G41	1	C5165X4	10		
08U-112	5	43008U-G71	1	C5165X6	10		
08U-508	5	43012U-112	2	C5165X8	10		
08U-510	5	43012U-612	2	C5165X12	5		

## Equipment

### Assortments

#### TA-1002 • Thread Measuring Kit

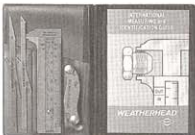

Measuring tube and pipe fitting threads can be a most difficult task if not completely understood. Tools needed include a thread pitch gauge, calipers and seat angle gauges. To aid you, Eaton has a kit to fit your needs, the TA-1002 thread measuring kit.

#### This handy kit includes:

- Thread Pitch Gauge (American and metric)
- Inside/Outside Caliper (inches and millimeters)
- 2 Seat Angle Gauges (37°/45° and a 12°/30°)
- 24-Page International Measuring and Identification Guide and Instruction Booklet

- Carrying Case for Easy Convenient and Storage

**Weight:** .5 lb.

#### TA-1004 • Metric Thread Identification Kit



Contained in a durable steel carrying case, TA-1004 will help you with identification of metric, British pipe and JIS thread configurations. Identification pieces are configured for 20 metric and 8 British pipe sizes, an increase of three metric sizes compared to the TA-1003.

#### This handy kit includes:

- Steel Carrying Case
- Stainless Steel Caliper
- Metric and British Thread Pitch Gauges
- British Thread Measuring Templates (4 measuring 8 sizes) made of durable aircraft grade aluminum.

- Metric Thread Measuring Templates (10 measuring 20 sizes) made of durable aircraft grade aluminum.
- Kit Content Identification Chart



## Equipment

### Field Attachable Assembly Equipment



Refer to safety information regarding Coll-O-Crimp hose, hose fittings and assembly equipment compatibility on page 3.

#### T-300 • Field Attachable Hose End Assembly Machine



The Weatherhead T-300 Machine eliminates lost time and hard work when making replacement hose assemblies with bulk hose and field attachable hose ends. Simple, effortless operation provides uniform, safe assemblies time after time. This heavy-duty machine assembles straight, swivel, elbow and flange-type ends on all medium and high pressure wire braid hose from 3/16" through 2" I.D.

CATALOG NUMBER	DESCRIPTION
T-300	Assembly Machine – complete with tripod stand, adjustable locator, chuck handle and foot switch
T-300X	Assembly Machine without tripod stand
T-301	Tripod Stand
T-306	Nipple Chuck Wire Carrier
T-307	Adjustable Locator
T-308	Foot Switch – complete with cord

**Motor:** Universal, reversible, 110-115 volts, 25-60 cycle, 1/2 H.P., 8 amps

**Weight:** 167 lbs.

#### Mandrel Assembly Tools

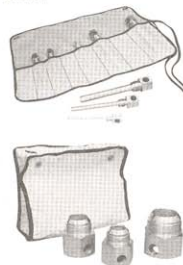

These tools are required for assembling 069 'D' Series hose ends in sizes 4 through 12 to prevent cutting the hose inner tube. Size 16 through 32 mandrels are used as a holding device when assembling 069 'D' Series swivel ends. Mandrels can be ordered individually or in sets as shown.

**TH-8 Mandrel Set:**  
Contains 1 each of the mandrels listed plus

**TH-8 BAG** pocket roll bag for convenient storage.

HOSE I.D.	CATALOG NUMBER	SWIVEL END APPLICATION
3/16"	T-JS4	SAE 37° & 45°
1/4"	T-JS5	SAE 37° & 45°
5/16"	T-J6	SAE 37°
5/16"	T-S6	SAE 45°
13/32"	T-JS8	SAE 37° & 45°
1/2"	T-JS10	SAE 37° & 45°
5/8"	T-J12	SAE 37°
5/8"	T-S12	SAE 45°

**TH-14 Mandrel Set:**  
Contains 1 each of the mandrels listed plus

**TH-14 BAG** zipper bag for convenient storage.

HOSE I.D.	CATALOG NUMBER	SWIVEL END APPLICATION
7/8"	T-J16	SAE 37°
1-1/8"	T-J20	SAE 37°
1-3/8"	T-J24	SAE 37°
1-13/16"	T-J32	SAE 37°

## Equipment

### Field Attachable Assembly Equipment



Refer to safety information regarding  
Coil-O-Crimp hose, hose fittings and  
assembly equipment compatibility on  
page 3.

#### T-101A • Barb-Tite® End Assembly Tool



Assembly of Barb-Tite® push-on hose ends is made easy with this handy tool. Easy and fast operation assures dependable, leak proof assemblies. Simply clamp hose in jaws, place hose end on push rod and pull the handle. Engineered for a lifetime of rugged service.

**Weight:** 1 lb.

**Capacity:** 1/4" to 1/2" I.D.  
hose only.

#### T-201 • Barb-Tite® End Assembly Tool



This bench-mounted tool is actually two tools in one. Not only does it assemble Barb-Tite® hose ends, it is also a hose cutter. To cut your hose, simply retract the handle, place the hose in the cutter area and pull the handle. After cutting the hose to the desired length, place the hose under the cam handle locking it in place with the hose end aligned with the appropriate mark on the label. Place the barbed end of the fitting against the end of the hose and then pull the handle forward to complete the installation. The T-201 Assembly Tool is an easy-to-use tool that does everything you need to create a hose assembly.

#### Replacement Blade: T-201B

**Note:** This tool is designed to cut fiber-reinforced rubber hose only.

**Capacity:** 1/4" to 3/4" I.D.  
hose ONLY.

## Equipment

### Hose Cutting Equipment



Refer to safety information regarding Coll-O-Crimp hose, hose fittings and assembly equipment compatibility on page 3.

#### T-80 • Coll-O-Cut® Portable Hand- Powered Cutter



Portable! Efficient!  
Economical! No outside power source needed. Quick, clean cuts through all fiber, 1 and 2 wire braid hose up to 1" I.D.

Ideal companion for the T-465 Portable Coll-O-Crimp Machine. Completely portable hose assembly capabilities – only from Eaton.

**Weight:** 15 lbs

**Replacement Blade:**  
T-1080

#### T-60A • Portable Cutter



An excellent heavy-duty cutting machine. The T-60A is a portable power saw that can cut all hoses, including wire-reinforced. Includes three abrasive blades.

**Replacement Blade:**  
T-1060A 14" diameter

**Motor:** 3-1/2 H.P.,  
110/115 volts

**Amps:** 15

**Weight:** 45 lbs.

**RPM:** 3500

**Note:** 3 blades are mounted on shaft for shipping purposes. Remove prior to use.

#### T-10B • Hose Cutting Machine



The T-10B hose cutting machine assures quick, clean, right angle cuts, eliminating ragged and frayed cut ends which make hose assembly difficult and are a possible cause of premature hose failure. A powerful 1 H.P. motor and belt-driven blade cut all low, medium and high pressure fabric and wire-braided hose from 3/16" through 1-1/4" I.D. 2 wire hose. Specifically designed for cutting hose, the T-10B is a natural companion to the T-400-1 Coll-O-Crimp and T-300 hose assembly machines.

The T-10B is shipped complete with a 7" smooth edge cutting wheel capable of cutting one-wire hose through 1-1/4", T-1047. To receive T-10B with a scalloped blade T-1047-1 capable of cutting two-wire hose through 1-1/4" instead of standard smooth blade, order T-10B-1.

**Replacement Blades:**

T-1047 (Smooth)

T-1047-1 (Scalloped)

**Replacement Belt for  
T-10B & T-10C:**

T-10-V1 Belt

**Motor:** 1 H.P., 3450 RPM,  
115, 60 cycle, single phase

**Size:** 13" wide, 24" long, 17" high

**Weight:** 85 lbs.

**Amps Drawn:** 115 volts – 15

**Replacement Parts:**

T-10-D Hose/Dowel

T-10-H Handle

T-10-P Pusher

## Equipment

### Hose Cutting Equipment



Refer to safety information regarding Coll-O-Crimp hose, hose fittings and assembly equipment compatibility on page 3.

#### T-9-1 & T-9-3 • Hose Cutting Machine



The T-9-1 and T-9-3 provide the capability for cutting multi-spiral and braided wire-reinforced hose through 2" I.D. This machine is a perfect companion for the T-440 Coll-O-Crimp II Plus. Includes scalloped blade.

**Note:** The T-9-1 and T-9-3 are shipped less a line cord and plug. An electrician is recommended for direct electrical hook-up.

#### T-9-1:

**Motor:** 3 H.P., 230 volts, 60 cycle, single phase

**Size:** 24" wide, 24" deep, 24" high

**Weight:** Approx. 255 lbs.

**Amps Drawn:**  
At 230 volts – 17

#### T-9-3:

**Motor:** 3 H.P., 230 volts, 60 cycle, 3 phase

**Size and Weight:**  
Same as T-9-1

**Amps Drawn:**  
At 230 volts – 8

#### Replacement Blade:

T-75-14 Scalloped

T-75-17 Carborundum

T-75-11 Smooth

**Guard:** T-9-G

#### T-70 • Hose Cutting Machine

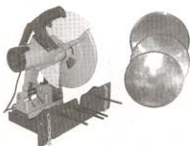

This cutting machine easily handles all one and two braided wire hose through 4" I.D., up to 2" I.D. 4-spiral and up to 1-1/2" I.D. 6 multi-spiral reinforced hose. That makes this machine ideal for cutting most hydraulic and pneumatic hoses as well as a variety of industrial fluid transfer hoses. The T-70 uses a 14" cutting blade for cutting all 1 & 2 wire braid and through 2" 4 spiral hose. The

scalloped toothed blade is for cutting industrial transfer hoses through 4" and the smooth beveled blade for cutting hose with a wire braid cover. T-70 includes a scalloped blade.

#### Replacement Blade:

T-1070 Steel Scalloped

T-1071 Steel Scalloped Toothed

T-1072 Steel Smooth Beveled

**Motor:** 4.2 H.P., 110/115 volts, single phase

**Size:** 22" wide, 19" deep, 25" high

**Weight:** Approx. 65 lbs.  
**Amps Drawn:** 115 volts – 20

#### Hose Cutting and Skiving Wheels

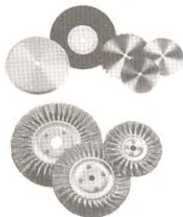

CATALOG NUMBER	TYPE	BLADE DIA.	HOLE DIA.	MACHINE USED ON
<b>Cutting Wheels</b>				
T-1042	Carborundum	8"	5/8"	T-10A
T-1047	Steel Smooth	7"	5/8"	T-10B & T-10C
T-1047-1	Steel Scalloped	7"	5/8"	T-10B & T-10C
T-1060	Carborundum	12"	1"	T-60
T-1060A	Carborundum	14"	1"	T-60A
T-1070	Steel Scalloped	14"	1"	T-70
T-1071	Steel Scalloped Toothed	14"	1"	T-70
T-1072	Steel Smooth Beveled	14"	1"	T-70
T-1080	Carborundum	8"	1"	T-80
T-75-11	Steel Smooth	10"	3/4"	T-9/T-75
T-75-14	Steel Scalloped	10"	3/4"	T-9/T-75
T-75-17	Carborundum	10"	3/4"	T-9/T-75
<b>Skiving Wheels</b>				
T-1040	Wire	6"	5/8"	T-10
T-1046	Wire	8"	5/8"	T-10A
T-75-12	Wire	8"	1"	T-75
<b>Belts</b>				
T-76-B	Reinforced	1"		Old T-76/T-76-1

## Equipment

### Hose Cutting Equipment



Refer to safety information regarding Coll-O-Crimp hose, hose fittings and assembly equipment compatibility on page 3.

#### T-1037 • Knife



An inexpensive, reliable knife useful in splitting twin-line and multiple-line hoses quickly and easily.

**Replacement Blade:**  
T-1037B

**Replacement Handle:**  
T-1037H

#### T-135 • Plastic Tube and Hose Cutter



An economical alternative to quality tube and hose cutting. This versatile tool is lightweight and durable for long service life.

**Replacement Blade:** T-135B  
**Capacity:** Up to 1" hose I.D.

**Note:** Not for use with wire-reinforced hose.

#### T-138 • Hose and Tube Cutter



One hand operation for quick, clean cuts through plastic or nylon compound tubing and solid or fiber-reinforced hose up to 1-1/2" O.D.

- Any wireless hose or tubing.
- Power steering hose (H324)
- Air Conditioning hose (H757)

- Air brake hose (H338)
- Air system nylon tubing (NT100)
- Thermoplastic hose (H435, H436, H335, and H336)
- Low pressure plastic tubing (PT200, PT230, PT240)

**Replacement Blade:**  
T-138B

**Note:** Not for use with wire-reinforced hose.

#### T-191 • Plastic Tube and Hose Cutter



A tool designed to be small, only 2-7/8" long. The versatile T-191 offers quick and clean square cuts on 1/16" to 1/2" O.D. plastic tubing and non-wire reinforced hose. The T-191 can be either bench or wall mounted and offers the safety of closing automatically when not in use.

**Spare Parts:** T-191B  
Replacement Blade (one per package)

## Equipment

### Presetting Tools

#### T-570-1 • Ermeto-Quick Set™ Preset Machine



The Ermeto-Quick Set Machine is ideal for bulk assemblies. It has a positive-stop action, which guarantees uniform repeatability, and a hand pump operation which yields quick cycle time, reducing assembly time. The T-570 is an easy tool to use that will save you time and money.

#### T-570 Package includes:

PART NUMBER	DESCRIPTION
T-460-2	Hand Pump (10,000 PSI)
T-450-3	Quick Disconnect Hose Assembly
T-570-1	Ermeto® Preset Machine
T-570-4	Preset Die
T-570-6	Preset Die
T-570-8	Preset Die
T-570-12	Preset Die
T-570-16	Preset Die
T-571-4	Tube Support
T-571-6	Tube Support
T-571-8	Tube Support
T-571-12	Tube Support
T-571-16	Tube Support

-20, -24, and -32 sizes also available.

#### Metric Flareless Hand Presetting Tools



Presetting tools provide a more accurate and positive leak-proof method of coupling flareless fittings. Presetting the steel metric sleeves prior to fitting assembly will permit the maximum high performance obtainable with flareless fittings. These tools are available for both the Light (DIN 3901/3902L) and Heavy (DIN 3901/3902S) flareless series.

#### Light Series 3901/3902L

CATALOG NUMBER	TUBE O.D. (MM)	THREAD SIZE
TL-7008	8	M14x1.5
TL-7010	10	M16x1.5
TL-7012	12	M18x1.5
TL-7015	15	M22x1.5
TL-7018	18	M26x1.5
TL-7022	22	M30x2.0
TL-7028	28	M36x2.0

#### Heavy Series 3901/3902S

CATALOG NUMBER	TUBE O.D. (MM)	THREAD SIZE
TH-7008	8	M16x1.5
TH-7010	10	M18x1.5
TH-7012	12	M20x1.5
TH-7014	14	M22x1.5
TH-7016	16	M24x1.5
TH-7020	20	M30x2.0
TH-7025	25	M36x2.0
TH-7030	30	M42x2.0

#### Ermeto® Hand Presetting Tools 7000 Series

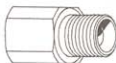

Presetting tools provide a more accurate and positive leak-proof method of coupling flareless fittings. Presetting steel Ermeto® sleeves on tubing prior to fitting assembly will permit the maximum high performance obtainable with flareless fittings. Due to possible thread galling, the use of presetting tools is required when assembling stainless steel fittings.

CATALOG NUMBER	TUBE O.D. (INCHES)	THREAD SIZE
T-7002	1/8	5/16-24
T-7003	3/16	3/8-24
T-7004	1/4	7/16-20
T-7005	5/16	1/2-20
T-7006	3/8	9/16-18
T-7008	1/2	3/4-16
T-7010	5/8	7/8-14
T-7012	3/4	1 1/16-12
T-7016	1	1 5/16-12
T-7020	1-1/4	1 5/8-12
T-7024	1-1/2	1 7/8-12
T-7032	2	2 1/2-12

## Equipment

### Counterbore and Brazing Tools

#### SAE Straight O-Ring Boss Tapping and Counterboring Tools



These Eaton precision counterborer and tap tools are available in the full range of sizes. They provide the correct SAE contour and UNF-2B threads for proper

containment of Flareless '7000' Series Ermeto® and Flare-Twin® straight-thread o-ring tube fittings.

THREAD TAP CATALOG NO.	UNF-2B THREAD SIZE OF THREAD TAP	DRILL SIZE	FOR FITTING SIZE	FOR TUBE O.D.	COUNTERBORER CATALOG NO.
T-5002	5/16-24	I	2	1/8	T-5102
T-5003	3/8-24	O	3	3/16	T-5103
T-5004	7/16-20	W	4	1/4	T-5104
T-5005	1/2-20	29/64	5	5/16	T-5105
T-5006	9/16-18	1/2	6	3/8	T-5106
T-5008	3/4-16	11/16	8	1/2	T-5108
T-5010	7/8-14	51/64	10	5/8	T-5110
T-5012	1 1/16-12	31/32	12	3/4	T-5112
T-5014	1 3/16-12	1 3/32	14	7/8	T-5114
T-5016	1 5/16-12	1 7/32	16	1	T-5116
T-5020	1 5/8-12	1 17/32	20	1 1/4	T-5120
T-5024	1 7/8-12	1 25/32	24	1 1/2	T-5124
*T-5032*	2 1/2-12	2 27/64	32	2	*T-5132*

\*Special order only.

#### T-560 • Magnatorch Brazing Machine



This Magnatorch Brazing Machine from Eaton is perfect for making large numbers of FOR-SEAL® Tube Fitting Assemblies. By providing 360 degree induction heating, the brazing process is fast, clean and flameless. A heavy-duty cart is also provided with table top work area, vice, and storage drawer to make up a complete brazing station.

#### T-562 • Circa Torch



This braze tool from Eaton provides an excellent way to braze FOR-SEAL® fittings. Heat is evenly distributed among six flame ports creating a fast, convenient way to make tube assemblies.



#### WARNING

Torch only to be used with acetylene!

## Equipment

### Hose Bore Cleaning Brushes

#### Individual Brushes



HOSE I.D. (INCH)	CATALOG NUMBER	BRISTLE O.D. (INCH)	BRISTLE LENGTH (INCH)	OVERALL LENGTH (INCH)
3/16-3/8	T-1106	3/8	2	24
1/2-5/8	T-1110	1/2	3	24
3/4-1	T-1116	1	4	24
1-1/8-1-1/2	T-1124	1-1/2	4	24
2-3	T-1132	2	5	24

#### T-1100 • 3-Piece Kit



Includes one of each of the following:

HOSE I.D. (INCH)	CATALOG NUMBER	BRISTLE O.D. (INCH)	BRISTLE LENGTH (INCH)	OVERALL LENGTH (INCH)
3/16-3/8	T-1106	3/8	2	24
1/2-5/8	T-1110	1/2	3	24
3/4-1	T-1116	1	4	24



## Equipment

### Skiving Tools and Wrenches

#### Hand Skiving Tool

(For H430, H439 and H470 Hose)



Order hand skiving tool components by the individual catalog numbers listed below.

See page 26 for skiving instructions.

HOSE SIZE	SKIVING TOOL CUTTING HEAD H470
1/2" I.D.	T-410-50
3/4" I.D.	T-410-52
1" I.D.	T-410-53
1-1/4" I.D.	T-410-54
1-1/2" I.D.	T-410-55
2" I.D.	T-410-56

**T-410-36:** Handle

**T-410-37:** Replacement Cutting Blades

#### Rapid Wrenches



The Rapid Wrench is a heavy-duty, high quality wrench that ratchets for quick installation and removal of tube fittings and hose ends. These wrenches have jaws that snap open and close completely around the fitting giving 6-point contact. Needing only 30° of rotation to ratchet, they allow easy access to tight locations. Available individually or in a set with pouch, these wrenches are a welcome addition to any tool box.

**T-139:** 7-Piece Set with Pouch – 1/2" through 7/8"

**T-139P:** Pouch for 7-Piece Set

**T-152:** 11-Piece Set with Pouch

**T-152P:** Pouch for 11-Piece Set

CATALOG NUMBER	WRENCH HEX SIZE
T-140	3/8"
T-141	7/16"
T-142	1/2"
T-143	9/16"
T-144	5/8"
T-145	11/16"
T-146	3/4"
T-147	13/16"
T-148	7/8"
T-151	15/16"
T-149	1"

## Equipment

### Power Steering Make-Up Information

#### H32406 • Passenger Car Power Steering Hose



The Coll-O-Crimp System may be used to supplement the original equipment-type power steering hose assembly inventory by using hose ends listed below and tubing (from the old hose assembly) to duplicate out-of-stock or slow moving hose assemblies.

**Reinforcement:** 2 Fiber Braids

**Cubical Expansion:** 8 to 17 cc ft. @ 1300 PSI

**Temp. Range:** -40°F to +250°F

#### SAE J188 Type 2

HOSE I.D.	HOSE O.D.	CATALOG NUMBER	RECOM. OPER. PRESS.	MIN. BURST PRESS.	BEND RADII
3/8	13/16	H32406	1500	6000	3-1/8

All dimensions in inches; pressure in PSI.

On many of the late model cars the formed tubing from the old line with its complicated bends can be utilized to make up a new assembly. Just use a tube cutter to cut the old tube as close to the hose as possible, then make up a hose assembly with a flareless tube end (i.e., 06U-756) and attach to the old tubing. Reference flareless tube assembly instructions on page 296-298.

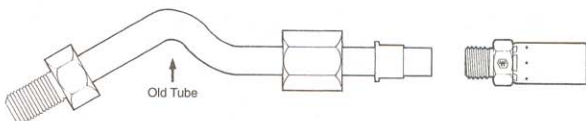

**42x6**  
SAE 45° Flare Union



**252x6, 252x7**  
Inverted Flare to Female Pipe



**1439, 1440, 41157x6**  
O-Ring Port to JIC 37° Flare  
**M41157x6x14, M41157x6x16, M41157x6x18**  
Metric O-Ring Port to JIC 37° Flare



**1444, 1445, 1446, 1447**  
O-Ring Port to Female Inverted Flare



**1553, 1554, 1563**  
Inverted Flare to SAE 45° Flare

## Equipment

### Power Steering Make-Up Information

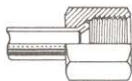

Original End

1/4" SAE Swivel 7/16-20

CONFIGURATION	USE CATALOG NO.
Straight	06U-604
45° Elbow	06U-684
90° Elbow (Short)	06U-664
90° Elbow (Long)	06U-644
Reuse old tube	06U-754

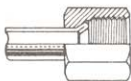

Original End

5/16" SAE Swivel 1/2-20

CONFIGURATION	USE CATALOG NO.
Reuse old tube	06U-755

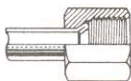

Original End

3/8" SAE Swivel 5/8-18

CONFIGURATION	USE CATALOG NO.
Straight	06U-406
45° Elbow	06U-486
90° Elbow	06U-446
Reuse old tube	06U-756

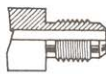

Original End

3/8" SAE 45° Rigid 5/8-18

CONFIGURATION	USE CATALOG NO.
Straight	06U-406 with 42x6
45° Elbow	06U-486 with 42x6
90° Elbow	06U-446 with 42x6
Reuse old tube	06U-756



Original End

1/4" Inv. Swivel 7/16-24

CONFIGURATION	USE CATALOG NO.
Straight	06U-B04
45° Elbow	06U-B44
90° Elbow	06U-B64
Reuse old tube	06U-754

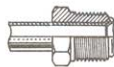

Original End

5/16" Inv. Swivel 1/2-20

CONFIGURATION	USE CATALOG NO.
Straight	06U-B05 or 06U-406 with 1553
45° Elbow	06U-B45 or 06U-486 with 1553
90° Elbow	06U-B65 or 06U-446 with 1553
Reuse old tube	06U-755

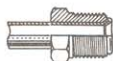

Original End

3/8" Inv. Swivel 5/8-18

CONFIGURATION	USE CATALOG NO.
Straight	06U-B06 or 06U-406 with 1563
45° Elbow	06U-B46 or 06U-486 with 1563
90° Elbow	06U-B66 or 06U-446 with 1563
Reuse old tube	06U-756



Original End

1/4" Inv. Swivel 7/16-24

CONFIGURATION	USE CATALOG NO.
Straight	06U-B04
45° Elbow	06U-B44
90° Elbow	06U-B64
Reuse old tube	06U-754



Original End

7/16" Inv. Swivel with 3/89 Tube Opening 11/16-18

CONFIGURATION	USE CATALOG NO.
Straight	06U-B07 or 06U-406 with 1554
45° Elbow	06U-B47 or 06U-486 with 1554
90° Elbow	06U-B67 or 06U-446 with 1554
Reuse old tube	06U-756
New tubing/nut	105x6x7



Original End

3/8" Inv. Seat 5/8-18

CONFIGURATION	USE CATALOG NO.
Straight	06U-104 with 252x6



Original End

7/16" Inv. Seat 11/16-18

CONFIGURATION	USE CATALOG NO.
Straight	06U-104 with 252x7

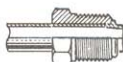

Original End

O-Ring Tube End 3/8" Tube - 5/8-18

CONFIGURATION	USE CATALOG NO.
Straight	06U-606 with 41157x6
45° Elbow	06U-686 with 41157x6
90° Elbow	06U-666 with 41157x6
Reuse old tube	06U-756

## Equipment

### Power Steering Make-Up Information

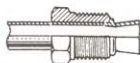

#### Original End

O-Ring Tube End (Chrysler) 5/16" Swivel 1/2-20

CONFIGURATION	USE CATALOG NO.
Reuse old tube	06U-755



#### Original End

O-Ring Tube End (Ford) 1/4" Tube - 9/16-18 (Special)

CONFIGURATION	USE CATALOG NO.
Straight	06U-604 with 1440
45° Elbow	06U-684 with 1440
90° Elbow	06U-664 with 1440
Reuse old tube	06U-755

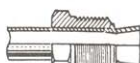

#### Original End

O-Ring Tube End 3/8" Tube - 5/8-18 (Special)

CONFIGURATION	USE CATALOG NO.
Straight	06U-606 with 1439
45° Elbow	06U-686 with 1439
90° Elbow	06U-666 with 1439
Reuse old tube	06U-756

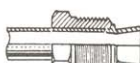

#### Original End

O-Ring Tube End (Ford) 7/16" Tube - 11/16-18 (Special)

CONFIGURATION	USE CATALOG NO.
Straight	06U-B06 with 1444
45° Elbow	06U-B46 with 1444
90° Elbow	06U-B66 with 1444
Reuse old tube	06U-756



#### Original End

O-Ring Tube End 3/8" Tube - M14x1.5

CONFIGURATION	USE CATALOG NO.
Straight	06U-B06 with 1445
45° Elbow	06U-B46 with 1445
90° Elbow	06U-B66 with 1445
Reuse old tube	06U-756



#### Original End

O-Ring Tube End 3/8" Tube - M16x1.5

CONFIGURATION	USE CATALOG NO.
Straight	06U-B06 with 1446
45° Elbow	06U-B46 with 1446
90° Elbow	06U-B66 with 1446
Reuse old tube	06U-756

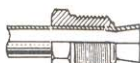

#### Original End

O-Ring Tube End 3/8" Tube - M18x1.5

CONFIGURATION	USE CATALOG NO.
Straight	06U-B06 with 1447
45° Elbow	06U-B46 with 1447
90° Elbow	06U-B66 with 1447
Reuse old tube	06U-756