

Tube O.D.	1/8	3/16	1/4	5/16	3/8
Thread Size-B	5/16-24	3/8-24	7/16-24	1/2-20	9/16-20

- **Typical Application**

Oil, air, water and lubrication systems.

- **Pressure**

Operating pressure of 500 psi for 1/8" to 1/4" sizes, 250 psi for 5/16" and 3/8" sizes.

- **Vibration**

Fair resistance.

- **Temperature Range**

-65°F to +250°F (-53°C to +121°C) range at maximum operating pressures.

- **Material**

CA360 Brass.

- **Used With**

Aluminum and copper tubing. Not recommended for steel tubing.

- **Advantages**

Easy to assemble, no flaring. Two (2) piece construction.

- **Conformance**

Meets ASA and ASME specifications.

- **How to Order**

Order individually by catalog number.

- **NOTE**

Refer to current price list for availability of cataloged items. Quotations and delivery of non-stock items supplied on request. Configurations and dimensions subject to change without notice.

- **Assembly Instructions**

1. Cut tubing to desired length.
2. Slide nut on end of tube. Threaded end "A" of nut must face toward fitting.
3. Insert tube into fitting body. Be sure tube is bottomed on fitting shoulder.
4. Lubricate threads and assemble nut to fitting body.
5. Tighten nut, hand tight. From hand tight, tighten with a wrench 1-1/2 additional turns to form proper seal.

Threaded Sleeve

**Brass
Fittings**

Nut



Tube O.D.	Catalog Number	Hex C	D	L
1/8	6100x2	3/8	.130	.50
3/16	6100x3	7/16	.193	.53
1/4	6100x4	1/2	.255	.56
3/8	6100x6*	5/8	.380	.61

Male Connector

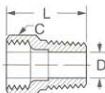

Tube O.D.	Male Pipe Thread	Catalog Number	Hex C	D	L
1/8	1/8	6200x2	7/16	.078	.62
1/8	*	6200x2x21	7/16	.080	.62
3/16	1/8	6200x3	7/16	.141	.69
1/4	1/8	6200x4	1/2	.188	.75
3/8	1/4	6200x6*	5/8	.312	.97

*Thread Size 1/4-28 Tapered Male Thread

Union

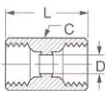

Tube O.D.	Catalog Number	Hex C	D	L
1/4	6300x4*	1/2	.187	1.00

Male Elbow

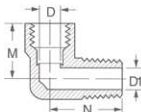

Tube O.D.	Male Pipe Thread	Catalog Number	D	D1	M	N
1/8	1/8	6400x2	.073	.125	.50	.66
1/8	*	6400x2x21	.078	.080	.50	.52
3/16	1/8	6400x3	.141	.156	.56	.62
1/4	1/8	6400x4	.188	.188	.52	.62

*Thread Size 1/4-28 Tapered Male Thread

*MTO - Made To Order

BRASS