

 Refer to safety information regarding tubing selection on page 1.

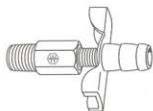

Drain Cocks and Drain Valves have been a specialty with Weatherhead since 1919. Millions are in use. The original design has proved so efficient that it is still the leader with most original equipment manufacturers. The metal-to-metal seat requires only hand tightening to assure positive leak-proof performance.

- **Material:** brass bodies/steel handles, except where noted.
- **Pressure:** 150 psi maximum (does not include hose or plastic tubing.)
- **Used With:** Copper, aluminum, steel, hose and plastic tubing where applicable.
- **Temperature:** -65°F to +250°F (-53°C to +121°C). (Refer to tubing temperature range.)
- **Conformance:** Designed for automotive or industrial use. Not intended for natural gas, LPG, nuclear or aircraft applications, except as noted.

## External Seat

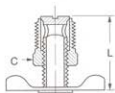

Male Pipe Thread	Catalog Number	Hex C	L
1/8	135	7/16	.90
1/4	145	9/16	1.00
3/8	270	11/16	1.25
1/2	108	7/8	1.52

## External Seat

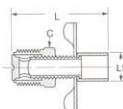

Male Pipe Thread	Catalog Number	Hex C	L	L1
1/4	6788	9/16	1.56	.44

## Internal Seat

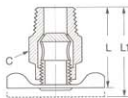

Male Pipe Thread	Catalog Number	Hex C	L	L1
1/8	130	17/32	1.15	1.30
1/4	140	5/8	1.32	1.50
1/4	190	9/16	1.25	1.41
3/8	230	11/16	1.34	1.50

## Internal Seat (Long)

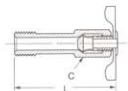
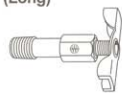

Male Pipe Thread	Catalog Number	Hex C	L
1/8	185	7/16	1.72

# Drain Cocks

Brass  
Fittings

## Internal Seat

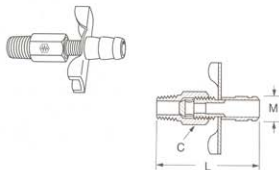

Male Pipe Thread	Catalog Number	Hex C	L	M
1/8	6783	13/32	1.63	.344

## Internal Seat Drain Valve

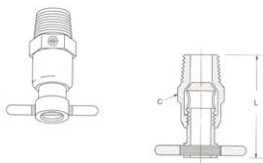

Male Pipe Thread	Catalog Number	Hex C	L
1/8	1424A	1/2	1.219
1/4	1425A	9/16	1.313
3/8	1426A	11/16	1.688

## Air Vent

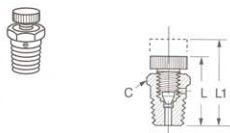

Set screw has 10-32 national fine thread.

Male Pipe Thread	Catalog Number	Hex C	L	L1
1/8	705	13/32	.78	.88

## Angle Bib Drain

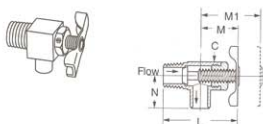

Male Pipe Thread	Catalog Number	Square C	L	M	M1	N
1/8	150	7/16	1.12	.57	.95	.38
1/4	120	5/8	1.76	.94	1.50	.66

## Angle Bib Drain

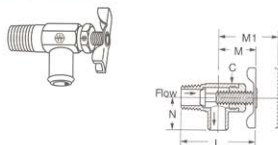

Hose I.D.	Male Pipe Thread	Catalog Number	Square C	L	M	M1	N
3/8	1/4	6660	9/16	1.33	.62	1.01	.66

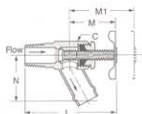
**Hose to Pipe  
(Steel Body)**

Hose Size	Male Pipe Thread	Catalog Number	Hex C	L	M	M1	N
5/8	3/8	211273A	11/16	2.85	1.41	1.91	1.30

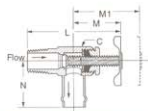
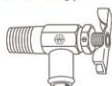
**Hose to Pipe  
(Steel Body)**

Hose I.D.	Male Pipe Thread	Catalog Number	Square C	L	M	M1	N
5/8	3/8	211280A	11/16	2.85	1.10	1.47	1.19

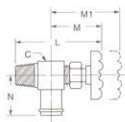
**Pipe to Hose Shut-Off  
(Brass Body)**

Red color coded aluminum handle.  
Handle Catalog Number **1427**.

Hose Size	Male Pipe Thread	Catalog Number	Square C	L	M	M1	N
3/8	3/8	1422	3/4	2.93	1.78	2.25	1.12
5/8	3/8	1423	13/16	2.93	1.81	2.25	1.35
3/4	3/8	1433	15/16	3.00	1.81	2.25	1.35
3/4	1/2	1451	15/16	3.12	1.93	2.25	1.35

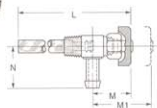
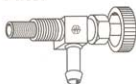
**Gasoline Shut-Off with Screen  
Filter**

Hose Size	Male Pipe Thread	Catalog Number	L	M	M1	N
1/4	1/8	6600	3.36	.80	.97	.84

**Air Tank Drain Valve**

NOTE: Pull cable sideways.  
\*No loop on cable end.

Male Pipe Thread	Cable Length	Catalog Number
1/4	7"	1421-7
1/4	18"	1421-18
1/4	24"	1421-24
1/4	32"	1421-32
1/4	60"	1421-60
1/4	60"	1421-60A*