

 Refer to safety information regarding tubing selection on page 1.

## Special Steel Bushing



Male Thread	Female Pipe Thread	Catalog Number	Hex C	D	L
1-1/16-16UN-2A	1/8	7977	1-1/8	.328	.94
1-1/16-16UN-2A	3/8	7978	1-1/8	.562	.94

## Water Line Elbow



Hose I.D.	Male Pipe Thread	Catalog Number	D	M	N
5/8	3/8	05710B-C06	.500	1.25	1.35

## Male JIC 37° Flare to O-Ring Port Adapter (Steel)

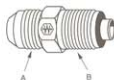

Tube Size A	Port Size B	Catalog Number	Thread B	Hex C	D	L
1/4	1/4	41157x4	7/16-24	7/16	.122	1.33
3/8	3/8	41157x6	5/8-18	5/8	.262	1.47
1/2	1/2	41157x8	3/4-16	3/4	.368	1.91
5/8	5/8	41157x10	7/8-14	15/16	.472	2.23
3/4	3/4	41157x12	1-1/16-16	1-1/8	.609	2.13

Includes O-Ring.

## Male JIC 37° Flare to Metric O-Ring Port Adapter (Steel) (with o-ring)



Tube O.D.	Thread B	Catalog Number	Hex C	D	L
3/8	M14x1.5	M41157x6x14	3/4	.266	1.62
3/8	M16x1.5	M41157x6x16	3/4	.266	1.62
3/8	M18x1.5	M41157x6x18	3/4	.266	1.62

Includes O-Ring.

**Application:** GM power steering with Saginaw steering and rack and pinion steering systems.

### Adapter

Example assembly No. C35880x4

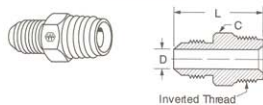

Tube O.D.	Inverted Thread	Catalog Number	Hex C	D	L
1/4	7/16-24	C5880x4	1/2	.172	1.08
5/16	1/2-20	C5880x5	9/16	.234	1.14
3/8	5/8-18	C5880x6	11/16	.297	1.22
1/2	3/4-18	C5880x8	13/16	.391	1.46

### Female JIC 37° Swivel to Male Pipe Adapter

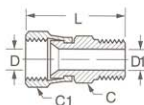

Tube O.D.	Male Pipe Size	Catalog Number	Hex C	Hex C1	D	D1	L
1/4	1/4	9100x4x4	9/16	9/16	.172	.281*	1.50
5/16	1/4	9100x5x4	11/16	5/8	.234	.281*	1.57
3/8	1/4	9100x6x4	11/16	11/16	.297	.281	1.69
3/8	3/8	9100x6x6	11/16	11/16	.297	.406*	1.69
1/2	3/8	9100x8x6	7/8	7/8	.391	.406*	1.87
1/2	1/2	9100x8x8	7/8	7/8	.391	.531*	2.05
5/8	3/8	9100x10x6	1	1	.484	.406	1.91
5/8	1/2	9100x10x8	1	1	.484	.531*	2.11
3/4	1/2	9100x12x8	1-1/8	1-1/4	.609	.531	2.21
3/4	3/4	9100x12x12	1-1/8	1-1/4	.609	.719*	2.21
1	3/4	9100x16x12	1-3/8	1-1/2	.844	.719	2.36
1	1	9100x16x16	1-3/8	1-1/2	.844	.938*	2.55
1-1/4	1-1/4	9100x20x20	1-7/8	2	1.078	1.250*	2.73

\*Optional counterbore for D1.

### Male JIC 37° to Male Metric Standpipe

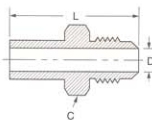

Tube O.D.	Tube O.D. (mm)	Catalog Number	Hex C	L	D
1/4	6MM	MC5019x4x6	9/16	1.58	.16
1/4	8MM	MC5019x4x8	9/16	1.68	.17
3/8	10MM	MC5019x6x10	3/4	1.67	.28
1/2	12MM	MC5019x8x12	7/8	1.97	.32
1/2	14MM	MC5019x8x14	7/8	1.89	.39
5/8	15MM	MC5019x10x15	1	2.03	.43
5/8	16MM	MC5019x10x16	1	2.07	.47
3/4	16MM	MC5019x12x16	1-1/4	2.22	.47
3/4	18MM	MC5019x12x18	1-1/4	2.12	.55
3/4	20MM	MC5019x12x20	1-1/4	2.38	.61
1	22MM	MC5019x16x22	1-1/2	2.21	.67
1	25MM	MC5019x16x25	1-1/2	2.54	.79

For metric flareless nuts and sleeves see page 211.

### Male JIC 37° to O-Ring Port Adapter

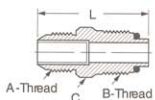

Tube Size	Port Size	Catalog Number	Replacement O-Ring	Thread A	Thread B	Hex C	L
1/4	1/4	41157x4	7629x1	7/16-20	7/16-24	7/16	1.33
3/8	3/8	41157x6	7629x3	9/16-18	5/8-18	3/4	1.91
1/2	1/2	41157x8	7629x5	3/4-16	3/4-16	3/4	1.47
5/8	5/8	41157x10	7629x7	7/8-14	7/8-14	15/16	2.23
3/4	3/4	41157x12	7629x8	1-1/16-12	1-1/16-16	1-1/8	2.13