

## Female Straight Thread O-Ring to Male Pipe Adapter

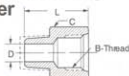

Fem. Port Size	Male Pipe Thread	Catalog Number	Straight Thread B	Hex C	D	L
3/8	3/8	C3239x6x6	9/16-18	13/16	.406	1.38
3/8	1/2	C3239x6x8	9/16-18	7/8	.500	1.61
1/2	3/8	C3239x8x6	3/4-16	1	.406	1.46
1/2	1/2	C3239x8x8	3/4-16	1	.562	1.69
5/8	1/2	C3239x10x8	7/8-14	1-1/4	.531	1.81

## Coupling Stainless Steel No. 3321x (Ref. SAE No. 140138)

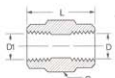

Fem. Pipe Thread	Fem. Pipe Thread	Catalog Number	Hex C	D	D1	L
1/8	1/8	C3309x2*	5/8	.332	.332	.75
1/4	1/8	C3309x4x2*	3/4	.437	.332	1.13
1/4	1/4	C3309x4*	3/4	.437	.437	1.13
3/8	1/4	C3309x6x4*	7/8	.562	.437	1.13
3/8	3/8	C3309x6*	7/8	.562	.562	1.13
1/2	1/4	C3309x8x4*	1-1/8	.687	.437	1.50
1/2	3/8	C3309x8x6*	1-1/8	.687	.562	1.50
1/2	1/2	C3309x8*	1-1/8	.687	.687	1.50
3/4	1/2	C3309x12x8	1-3/8	.906	.687	1.53
3/4	3/4	C3309x12*	1-3/8	.906	.906	1.53
1	3/4	C3309x16x12	1-5/8	1.125	.906	1.89
1	1	C3309x16*	1-5/8	1.125	1.125	1.89
1-1/4	1-1/4	C3309x20	2	1.468	1.468	1.93
1-1/2	1-1/2	C3309x24	2-3/8	1.703	1.703	1.93
2	2	C3309x32	2-7/8	2.188	2.188	1.96

## Hex Nipple Stainless Steel No. 3081x (Ref. SAE No. 140137)

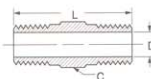

Male Pipe Thread	Male Pipe Thread	Catalog Number	Hex C	D	L
1/16	1/16	C3069x1	5/16	.141	.940
1/8	1/16	C3069x2x1	7/16	.141	.970
1/8	1/8	C3069x2*	7/16	.188	1.06
1/4	1/8	C3069x4x2*	5/8	.188	1.26
1/4	1/4	C3069x4*	5/8	.281	1.45
3/8	1/8	C3069x6x2*	3/4	.188	1.26
3/8	1/4	C3069x6x4*	3/4	.281	1.45
3/8	3/8	C3069x6*	3/4	.406	1.45
1/2	1/4	C3069x8x4*	7/8	.281	1.70
1/2	3/8	C3069x8x6*	7/8	.406	1.70
1/2	1/2	C3069x8*	7/8	.531	1.89
3/4	1/2	C3069x12x8*	1-1/8	.531	1.96
3/4	3/4	C3069x12*	1-1/8	.719	1.96
1	3/4	C3069x16x12	1-3/8	.719	2.16
1	1	C3069x16*	1-3/8	.938	2.34
1-1/4	1-1/4	C3069x20	1-3/4	1.250	2.48
1-1/2	1-1/2	C3069x24	2	1.500	2.61
2	2	C3069x32	2-1/2	1.938	2.83

## Male For-Seal® to Male Pipe Adapter

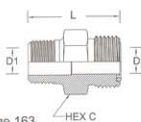

Replacement O-rings page 163.

Tube O.D.	Male Pipe Thread	Catalog Number	Hex C	D	D1	L
3/8	3/8	4205x6x6	3/4	.264	.406	1.30
1/2	3/8	4205x8	7/8	.378	.406	1.45
1/2	1/2	4205x8x8	7/8	.378	.484	1.64
5/8	1/2	4205x10	1-1/16	.484	.531	1.82
3/4	1/2	4205x12x8	1-1/4	.406	.484	1.87
3/4	3/4	4205x12	1-1/4	.609	.719	1.94
3/4	1	4205x12x16	1-3/8	.609	.938	1.87
1	1	4205x16	1-1/2	.811	.938	2.19
1-1/4	1-1/4	4205x20	1-3/4	1.024	1.250	2.30

## Male Straight Thread O-Ring to Male Pipe Adapter

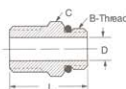

Replacement O-rings page 147.

Male Port Size	Male Pipe Thread	Catalog Number	Straight Thread B	Hex C	D	L
1/4	1/8	C3249x4x2	7/16-20	9/16	.172	1.05
3/8	1/4	C3249x6x4	9/16-18	11/16	.281	1.30
1/2	3/8	C3249x8x6	3/4-16	7/8	.391	1.36
1/2	1/2	C3249x8x8	3/4-16	7/8	.391	1.55
5/8	1/2	C3249x10x8	7/8-14	1	.434	1.69
3/4	3/4	C3249x12x12	1-1/16-12	1-1/4	.609	1.73
1	1	C3249x16x16	1-5/16-12	1-1/2	.844	2.06
1-1/4	1-1/4	C3249x20x20	1-5/8-12	1-7/8	1.078	2.17
1-1/2	1-1/2	C3249x24x24	1-7/8-12	2-1/8	1.312	2.26
2	2	C3249x32x32	2-1/2-12	2-7/8	1.781	2.47

\* Available in stainless steel.

### Straight Thread O-Ring to Male For-Seal® Extended (Ref. SAE No. 520122)

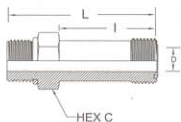
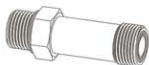

For replacement Straight Thread O-ring, see page 147.

Tube O.D.	Port Size	Catalog Number	Hex C	D	I	L
3/8	3/8	4316x6	3/4	.264	1.46	2.27
1/2	1/2	4316x8	7/8	.378	1.75	2.67
3/4	3/4	4316x12	1-1/4	.609	2.52	3.76
1	1	4316x16	1-1/2	.811	2.87	4.14
1-1/4	1-1/4	4316x20	1-7/8	1.024	3.41	4.76
1-1/2	1-1/2	4316x24	2-1/8	1.260	3.82	5.26

### Male JIC 37° to Female Swivel For-Seal®

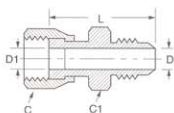

Female Tube O.D.	Male Tube Size	Catalog Number	Hex C	Hex C1	D	D1	L
1/4	1/4	4213x4	11/16	5/8	.172	.165	1.50
3/8	3/8	4213x6	13/16	3/4	.297	.284	1.62
1/2	1/2	4213x8	15/16	7/8	.392	.358	1.90
5/8	5/8	4213x10	1-1/8	1-1/16	.484	.453	2.25
3/4	3/4	4213x12	1-3/8	1-1/4	.609	.547	2.48
1	1	4213x16	1-5/8	1-1/2	.811	.783	2.84

### Male Connector

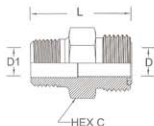

Tube O.D.	Male Pipe Thread	Catalog Number	Hex C	D	D1	L
3/8	3/8	4205x6x6	3/4	.264	.406	1.30
1/2	3/8	4205x8	7/8	.378	.406	1.45
1/2	1/2	4205x8x8	7/8	.378	.484	1.64
5/8	1/2	4205x10	1-1/16	.484	.531	1.82
3/4	1/2	4205x12x8	1-1/4	.406	.484	1.87
3/4	3/4	4205x12	1-1/4	.609	.719	1.94
3/4	1	4205x12x16	1-3/8	.609	.938	1.87
1	1	4205x16	1-1/2	.811	.938	2.19
1-1/4	1-1/4	4205x20	1-3/4	1.024	1.250	2.30