

Female Straight Thread O-Ring to Male Pipe Adapter

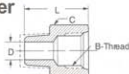

Fem. Port Size	Male Pipe Thread	Catalog Number	Straight Thread B	Hex C	D	L
3/8	3/8	C3239x6x6	9/16-18	13/16	.406	1.38
3/8	1/2	C3239x6x8	9/16-18	7/8	.500	1.61
1/2	3/8	C3239x8x6	3/4-16	1	.406	1.46
1/2	1/2	C3239x8x8	3/4-16	1	.562	1.69
5/8	1/2	C3239x10x8	7/8-14	1-1/4	.531	1.81

Coupling Stainless Steel No. 3321x (Ref. SAE No. 140138)

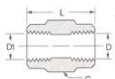

Fem. Pipe Thread	Fem. Pipe Thread	Catalog Number	Hex C	D	D1	L
1/8	1/8	C3309x2*	5/8	.332	.332	.75
1/4	1/8	C3309x4x2*	3/4	.437	.332	1.13
1/4	1/4	C3309x4*	3/4	.437	.437	1.13
3/8	1/4	C3309x6x4*	7/8	.562	.437	1.13
3/8	3/8	C3309x6*	7/8	.562	.562	1.13
1/2	1/4	C3309x8x4*	1-1/8	.687	.437	1.50
1/2	3/8	C3309x8x6*	1-1/8	.687	.562	1.50
1/2	1/2	C3309x8*	1-1/8	.687	.687	1.50
3/4	1/2	C3309x12x8	1-3/8	.906	.687	1.53
3/4	3/4	C3309x12*	1-3/8	.906	.906	1.53
1	3/4	C3309x16x12	1-5/8	1.125	.906	1.89
1	1	C3309x16*	1-5/8	1.125	1.125	1.89
1-1/4	1-1/4	C3309x20	2	1.468	1.468	1.93
1-1/2	1-1/2	C3309x24	2-3/8	1.703	1.703	1.93
2	2	C3309x32	2-7/8	2.188	2.188	1.96

Hex Nipple Stainless Steel No. 3081x (Ref. SAE No. 140137)

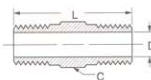

Male Pipe Thread	Male Pipe Thread	Catalog Number	Hex C	D	L
1/16	1/16	C3069x1	5/16	.141	.940
1/8	1/16	C3069x2x1	7/16	.141	.970
1/8	1/8	C3069x2*	7/16	.188	1.06
1/4	1/8	C3069x4x2*	5/8	.188	1.26
1/4	1/4	C3069x4*	5/8	.281	1.45
3/8	1/8	C3069x6x2*	3/4	.188	1.26
3/8	1/4	C3069x6x4*	3/4	.281	1.45
3/8	3/8	C3069x6*	3/4	.406	1.45
1/2	1/4	C3069x8x4*	7/8	.281	1.70
1/2	3/8	C3069x8x6*	7/8	.406	1.70
1/2	1/2	C3069x8*	7/8	.531	1.89
3/4	1/2	C3069x12x8*	1-1/8	.531	1.96
3/4	3/4	C3069x12*	1-1/8	.719	1.96
1	3/4	C3069x16x12	1-3/8	.719	2.16
1	1	C3069x16*	1-3/8	.938	2.34
1-1/4	1-1/4	C3069x20	1-3/4	1.250	2.48
1-1/2	1-1/2	C3069x24	2	1.500	2.61
2	2	C3069x32	2-1/2	1.938	2.83

Male For-Seal® to Male Pipe Adapter

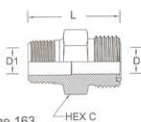

Replacement O-rings page 163.

Tube O.D.	Male Pipe Thread	Catalog Number	Hex C	D	D1	L
3/8	3/8	4205x6x6	3/4	.264	.406	1.30
1/2	3/8	4205x8	7/8	.378	.406	1.45
1/2	1/2	4205x8x8	7/8	.378	.484	1.64
5/8	1/2	4205x10	1-1/16	.484	.531	1.82
3/4	1/2	4205x12x8	1-1/4	.406	.484	1.87
3/4	3/4	4205x12	1-1/4	.609	.719	1.94
3/4	1	4205x12x16	1-3/8	.609	.938	1.87
1	1	4205x16	1-1/2	.811	.938	2.19
1-1/4	1-1/4	4205x20	1-3/4	1.024	1.250	2.30

Male Straight Thread O-Ring to Male Pipe Adapter

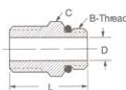

Replacement O-rings page 147.

Male Port Size	Male Pipe Thread	Catalog Number	Straight Thread B	Hex C	D	L
1/4	1/8	C3249x4x2	7/16-20	9/16	.172	1.05
3/8	1/4	C3249x6x4	9/16-18	11/16	.281	1.30
1/2	3/8	C3249x8x6	3/4-16	7/8	.391	1.36
1/2	1/2	C3249x8x8	3/4-16	7/8	.391	1.55
5/8	1/2	C3249x10x8	7/8-14	1	.434	1.69
3/4	3/4	C3249x12x12	1-1/16-12	1-1/4	.609	1.73
1	1	C3249x16x16	1-5/16-12	1-1/2	.844	2.06
1-1/4	1-1/4	C3249x20x20	1-5/8-12	1-7/8	1.078	2.17
1-1/2	1-1/2	C3249x24x24	1-7/8-12	2-1/8	1.312	2.26
2	2	C3249x32x32	2-1/2-12	2-7/8	1.781	2.47

* Available in stainless steel.

Refer to safety information regarding tubing selection on page 1.

- **Typical Application:** Pressure hydraulic systems.
- **Sealing Method:** Performed by an elastomeric O-ring.
- **NOTE:** For pressure, material and plating information, refer to appropriate steel fitting sections of this catalog:

Pipe - See page 141. For-Seal - See page 149. JIC 37° - See page 159.

Ermeto - See page 190. Swivel Adapters - See page 214.

Straight Thread O-Ring Hex Socket Plug (Ref. SAE No. 090109B)



Replacement O-rings page 194.
NOTE: Parts furnished with zinc plate.

Port Size	Catalog Number	Hex C	L
1/8	7238x2	1/8	.40
3/16	7238x3	1/8	.40
1/4	7238x4	3/16	.47
5/16	7238x5	3/16	.47
3/8	7238x6	1/4	.50
1/2	7238x8	5/16	.58
5/8	7238x10	3/8	.65
3/4	7238x12	9/16	.77
7/8	7238x14	9/16	.77
1	7238x16	5/8	.77
1-1/4	7238x20	3/4	.78

Straight Thread O-Ring Hex Head Plug (Ref. SAE No. 090109A)

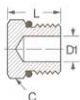

Replacement O-rings page 194.
NOTE: Parts furnished with zinc plate.

Port Size	Catalog Number	Hex C	L	D1 Opt.
1/8	7237x2	7/16	.60	.093
3/16	7237x3	1/2	.60	.125
1/4	7237x4	9/16	.67	.203
5/16	7237x5	5/8	.67	.234
3/8	7237x6	11/16	.73	.297
1/2	7237x8	7/8	.80	.422
5/8	7237x10	1	.93	.500
3/4	7237x12	1-1/4	1.09	.656
7/8	7237x14	1-3/8	1.09	.718
1	7237x16	1-1/2	1.12	.875
1-1/4	7237x20	1-7/8	1.20	1.093
1-1/2	7237x24	2-1/8	1.27	1.344
2	7237x32	2-3/4	1.42	1.815

Male Straight Thread/Female Straight Thread O-Ring Boss

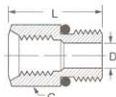

Replacement O-rings page 194.
NOTE: Parts furnished with zinc plate.

Male Port Size	Fem. Port Size	Catalog Number	Hex C	D	L
1/2	3/8	7033x8x6	7/8	.391	1.16
5/8	1/2	7033x10x8	1	.484	1.34
3/4	1/2	7033x12x8	1-1/4	.671	1.44
7/8	3/4	7033x14x12	1-3/8	.719	1.72
1	1/2	7033x16x8	1-1/2	.687	1.12
1	3/4	7033x16x12	1-1/2	.844	1.70
1-1/4	3/4	7033x20x12	1-7/8	.968	1.20
1-1/2	1-1/4	7033x24x20	2-1/8	1.312	1.75
2	1-1/2	7033x32x24	2-3/4	1.781	1.44

Straight Thread O-Ring Union

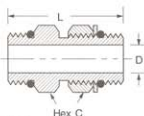

Replacement O-rings page 194.

Port Size	Catalog Number	Hex C	D	L
1/4	C5314x4x4	9/16	.172	1.37
3/8	C5314x6x6	11/16	.297	1.50
1/2	C5314x8x8	7/8	.391	1.56
5/8	C5314x10x10	1	.484	1.80
3/4	C5314x12x12	1-1/4	.609	2.33
1	C5314x16x16	1-1/2	.844	2.28
1-1/4	C5314x20x20	1-7/8	1.078	2.13
1-1/2	C5314x24x24	2-1/8	1.312	2.13
2	C5314x32x32	2-3/4	1.781	2.13