

Straight Thread O-Ring to Male For-Seal® Extended (Ref. SAE No. 520122)

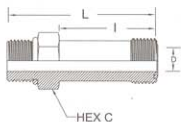
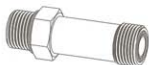

For replacement Straight Thread O-ring, see page 147.

Tube O.D.	Port Size	Catalog Number	Hex C	D	I	L
3/8	3/8	4316x6	3/4	.264	1.46	2.27
1/2	1/2	4316x8	7/8	.378	1.75	2.67
3/4	3/4	4316x12	1-1/4	.609	2.52	3.76
1	1	4316x16	1-1/2	.811	2.87	4.14
1-1/4	1-1/4	4316x20	1-7/8	1.024	3.41	4.76
1-1/2	1-1/2	4316x24	2-1/8	1.260	3.82	5.26

Male JIC 37° to Female Swivel For-Seal®

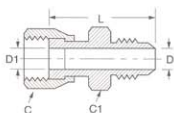

Female Tube O.D.	Male Tube Size	Catalog Number	Hex C	Hex C1	D	D1	L
1/4	1/4	4213x4	11/16	5/8	.172	.165	1.50
3/8	3/8	4213x6	13/16	3/4	.297	.284	1.62
1/2	1/2	4213x8	15/16	7/8	.392	.358	1.90
5/8	5/8	4213x10	1-1/8	1-1/16	.484	.453	2.25
3/4	3/4	4213x12	1-3/8	1-1/4	.609	.547	2.48
1	1	4213x16	1-5/8	1-1/2	.811	.783	2.84

Male Connector

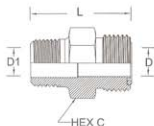

Tube O.D.	Male Pipe Thread	Catalog Number	Hex C	D	D1	L
3/8	3/8	4205x6x6	3/4	.264	.406	1.30
1/2	3/8	4205x8	7/8	.378	.406	1.45
1/2	1/2	4205x8x8	7/8	.378	.484	1.64
5/8	1/2	4205x10	1-1/16	.484	.531	1.82
3/4	1/2	4205x12x8	1-1/4	.406	.484	1.87
3/4	3/4	4205x12	1-1/4	.609	.719	1.94
3/4	1	4205x12x16	1-3/8	.609	.938	1.87
1	1	4205x16	1-1/2	.811	.938	2.19
1-1/4	1-1/4	4205x20	1-3/4	1.024	1.250	2.30

Straight Thread O-Ring to For-Seal® Extended (Ref. SAE No. 520122)



For replacement straight thread O-ring, see page 194.
Replacement For-Seal O-ring page 163.

Tube O.D.	Port Size	Catalog Number	Hex C	D	I	L
3/8	3/8	4316x6	3/4	.264	1.46	2.27
1/2	1/2	4316x8	7/8	.378	1.75	2.67
3/4	3/4	4316x12	1-1/4	.609	2.52	3.76
1	1	4316x16	1-1/2	.811	2.87	4.14
1-1/4	1-1/4	4316x20	1-7/8	1.024	3.41	4.76
1-1/2	1-1/2	4316x24	2-1/8	1.260	3.82	5.26

Female Straight Thread O-Ring to Male Pipe Adapter

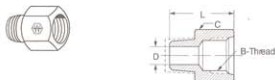

Fem. Port Size	Male Pipe Thread	Catalog Number	Straight Thread B	Hex C	D	L
3/8	3/8	C3239x6x6	9/16-18	13/16	.406	1.38
3/8	1/2	C3239x6x8	9/16-18	7/8	.500	1.61
1/2	3/8	C3239x8x6	3/4-16	1	.406	1.46
1/2	1/2	C3239x8x8	3/4-16	1	.562	1.69
5/8	1/2	C3239x10x8	7/8-14	1-1/4	.531	1.81

Straight Thread O-Ring Connector to Ermeto® Stainless Steel No. 7327x (Ref. SAE No. 080120)

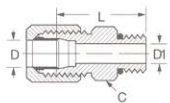

Replacement O-rings page 194.

Tube O.D.	Port Size	Catalog Number	Hex C	D	L	D1 Opt.
3/16	3/16	7315x3	1/2	.125	1.04	—
1/4	1/4	7315x4*	9/16	.203	1.13	—
1/4	5/16	7315x4x5*	5/8	.203	1.13	—
1/4	3/8	7315x4x6*	11/16	.203	1.19	.281
5/16	5/16	7315x5	5/8	.234	1.13	—
3/8	3/8	7315x6*	11/16	.281	1.21	—
3/8	1/2	7315x6x8	7/8	.281	1.29	.422
1/2	1/2	7315x8*	7/8	.422	1.38	—
1/2	5/8	7315x8x10*	1	.422	1.51	.500
1/2	3/4	7315x8x12*	1-1/4	.422	1.67	.656
5/8	5/8	7315x10*	1	.500	1.57	—
3/4	3/4	7315x12*	1-1/4	.656	1.79	—
3/4	1	7315x12x16	1-1/2	.656	1.82	.876
7/8	7/8	7315x14	1-3/8	.718	1.79	—
1	3/4	7315x16x12	1-1/2	.875	1.82	.656
1	1	7315x16*	1-1/2	.875	1.82	—
1-1/4	1-1/4	7315x20	1-7/8	1.093	1.90	—
1-1/2	1-1/2	7315x24	2-1/8	1.344	1.97	—
2	2	7315x32	2-3/4	1.813	2.13	—

Male Straight Thread O-Ring to Female Pipe Swivel (Ref. SAE No. 140157)

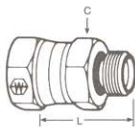

Replacement O-rings page 194.

Port Size	NPSM Swivel Nut	Catalog Number	Hex C	L
1/4	1/4-18	9315x4x4	9/16	.970
1/4	3/8-18	9315x4x6	5/8	1.060
5/16	1/4-18	9315x5x4	5/8	1.109
3/8	1/4-18	9315x5x4	11/16	1.171
3/8	3/8-18	9315x6x6	11/16	1.090
3/8	1/2-14	9315x6x8	13/16	1.210
1/2	1/4-18	9315x8x4	7/8	1.234
1/2	3/8-18	9315x8x6	7/8	1.200
1/2	1/2-14	9315x8x8	7/8	1.260
1/2	3/4-14	9315x8x12	1	1.406
5/8	3/8-18	9315x10x6	1	1.375
5/8	1/2-14	9315x10x8	1	1.400
5/8	3/4-14	9315x10x12	1	1.546
3/4	1/2-14	9315x12x8	1-1/4	1.540
3/4	3/4-14	9315x12x12	1-1/4	1.600
7/8	3/4-14	9315x14x12	1-3/8	1.703
1	3/4-14	9315x16x12	1-1/2	1.734
1	1-11-1/2	9315x16x16	1-1/2	1.710
1-1/4	1-11-1/2	9315x20x16	1-7/8	1.828
1-1/4	1-1/2-11-1/2	9315x20x20	1-7/8	1.890
1-1/2	1-1/2-11-1/2	9315x24x24	2-1/8	1.953
2	2-11-1/2	9315x32x32	2-3/4	2.156

* Available in stainless steel.