

| Tube O.D.     | 1/8     | 3/16   | 1/4     | 5/16   | 3/8     | 1/2    | 5/8    | 3/4       | 7/8       | 1         | 1-1/4    | 1-1/2    | 2        |
|---------------|---------|--------|---------|--------|---------|--------|--------|-----------|-----------|-----------|----------|----------|----------|
| Thread Size-B | 5/16-24 | 3/8-24 | 7/16-20 | 1/2-20 | 9/16-18 | 3/4-16 | 7/8-14 | 1-1/16-12 | 1-3/16-12 | 1-5/16-12 | 1-5/8-12 | 1-7/8-12 | 2-1/2-12 |

**Forged Fittings and Adapters**  
**5000 Series Pressure Rating Chart**

| Connection Type                     | 1/8" | 3/16" | 1/4" | 5/16" | 3/8" | 1/2" | 5/8" | 3/4" | 7/8" | 1"   | 1-1/4" | 1-1/2" | 2"   |
|-------------------------------------|------|-------|------|-------|------|------|------|------|------|------|--------|--------|------|
| SAE Fittings                        | 6000 | 5000  | 5000 | 5000  | 5000 | 4000 | 4000 | 4000 | 4000 | 4000 | 3000   | 3000   | 3000 |
| W/Adjustable Straight Thread O-Ring | 5000 | 5000  | 4500 | 4000  | 4000 | 4000 | 3000 | 3000 | 2500 | 2500 | 2000   | 1500   | 1125 |
| With Male Pipe                      | 6000 |       | 5000 |       | 5000 | 4000 |      | 4000 |      | 4000 | 3000   | 2500   | 2500 |
| With Female Pipe                    | 5000 |       | 5000 |       | 4000 | 3000 |      | 2500 |      | 2000 | 1500   | 1500   | 1000 |

**Brazed Fittings (TF)/SAE**  
**5000 Series Pressure Rating Chart**

| Connection Type                     | 1/8" | 3/16" | 1/4" | 5/16" | 3/8" | 1/2" | 5/8" | 3/4" | 7/8" | 1"   | 1-1/4" | 1-1/2" | 2"   |
|-------------------------------------|------|-------|------|-------|------|------|------|------|------|------|--------|--------|------|
| SAE Fittings                        | 5000 | 5000  | 5000 | 5000  | 5000 | 4500 | 3500 | 3500 | 3000 | 3000 | 2500   | 2000   | 1500 |
| W/Adjustable Straight Thread O-Ring | 5000 | 5000  | 4500 | 4000  | 4000 | 4000 | 3000 | 3000 | 2500 | 2000 | 1500   | 1125   |      |
| With Male or Female Pipe            | 5000 | 5000  | 5000 | 5000  | 4000 | 3000 | 3000 | 2500 | 2500 | 2000 | 1150   | 1000   | 1000 |

- Typical Application**  
Hydraulic, instrumentation and chemical processing systems.

- Pressure**  
Refer to the pressure charts above. The maximum working pressure of an adapter is the lower working pressure of the end size. Ex: C3069x8x6, 8 = 4000 psi and 6 = 5000 psi. Maximum working pressure is 4000 psi.

- Vibration**  
Good resistance. Vibration resistance decreases with increase in tube size. Use two piece design when greater vibration resistance is required.

- Temperature Range**  
-65°F to +400°F (-53°C to +204°C) at maximum operating pressures.

- Material**  
Carbon Steel - AISI/SAE 12L14  
Stainless Steel - Type 316  
Plating - Zinc, yellow dichromate.

- Used With**  
Copper, brass, steel, aluminum and other tubing that can be flared. See page 28-32 for material compatibility.

- Advantages**  
Zinc Plate. Choice of two or three-piece design. Broad selection of styles and sizes. Interchangeable with all sources.

- Conformance**  
Meets specifications and standards of ASA, ASME and SAE.

- How to Order**  
To order a three-piece assembly, prefix the catalog number with a "3". Example: To order a male connector C5205x4 with nut and sleeve assembled, order C35205x4. To order a two-piece assembly, order nut and body separately. Example: Order male connector C5205x4 and two-piece style nut C5115x4. Bodies, nuts and sleeves can be ordered separately by catalog number. Stainless steel bodies, nuts and sleeves are ordered separately by catalog number.

To order Weathercote finish (black phosphate coating) use "W" prefix in place of "C". Example: W5205x4 (special order only).

To order with pipe sealants (Seal-A-Thread), add a "Z" suffix to the catalog number. Example: C5205x4Z (special order only).

- NOTE**  
Refer to current price list for availability of cataloged items. Quotations and delivery of non-stock items supplied on request. Configurations and dimensions subject to change without notice. Additional information can be found in SAE J514.

- NOTE (Continued)**  
Weatherhead fittings with a "C" prefix are made from a forged construction. Example: C5405x4. Weatherhead fittings with a "TF" prefix are made from a brazed construction. Example: TF5405x4.

- Assembly Instructions**
  - Cut tubing to desired length. Make sure all burrs are removed and ends are cut square.
  - Slide nut on tube. Threaded end of nut "A" must face toward fitting body. (See above.)
  - Slide sleeve on tube (3-piece assembly only). Collar end "B" of sleeve must face toward fitting body. (See above.)
  - Flare end of tubing with 37° flaring tool.
    - Check flare diameter. For dimensional data on 37° flares, see page 26.
    - Examine flare for excessive thin-out.
    - On thin wall, welded or brazed tubing, use double flare to prevent pinch-off and cracked flares.
  - Lubricate threads and assemble to fitting body. Nut should be turned hand tight.
  - Tighten assembly until finger tight, then until a sharp torque rise is encountered. From that point, apply one-sixth turn with a wrench.

**Label Set: FS-200 (adhesive)**

### Dimensional Data

#### Dimensional Data Two-Piece Assemblies

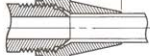

#### Dimensional Data Three-Piece Assemblies

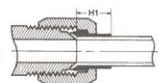

NOTE: H & H1 are dimensions of fittings assembled to hand tight condition.

| Tube O.D. | H   | H1   |
|-----------|-----|------|
| 1/8       | —   | .31  |
| 3/16      | —   | .38  |
| 1/4       | .59 | .36  |
| 5/16      | .66 | .41  |
| 3/8       | .69 | .47  |
| 1/2       | .81 | .50  |
| 5/8       | .94 | .64  |
| 3/4       | —   | .61  |
| 7/8       | —   | .69  |
| 1         | —   | .75  |
| 1-1/4     | —   | .73  |
| 1-1/2     | —   | 1.05 |
| 2         | —   | 1.08 |

### Straight Thread O-Ring Thread Sizes

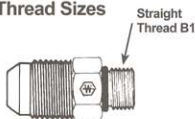

| Port Size | Thread Size B1 | Port Size | Thread Size B1 |
|-----------|----------------|-----------|----------------|
| 1/8       | 5/16-24        | 3/4       | 1-1/16-12      |
| 3/16      | 3/8-24         | 7/8       | 1-3/16-12      |
| 1/4       | 7/16-20        | 1         | 1-5/16-12      |
| 5/16      | 1/2-20         | 1-1/4     | 1-5/8-12       |
| 3/8       | 9/16-18        | 1-1/2     | 1-7/8-12       |
| 1/2       | 3/4-16         | 2         | 2-1/2-12       |
| 5/8       | 7/8-14         |           |                |

### Straight Thread O-Ring Fitting

#### Straight Thread O-Ring Fitting

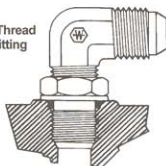

#### Adjustable Fittings

- Permit exact positioning of tees and elbows.
  - Provide a leakproof joint.
  - Eliminate distorted bosses from over tightening.
1. Lubricate O-ring by coating with a light oil or petrolatum and push back-up washer and O-ring to the extreme rear of the O-ring groove.
  2. Turn the lock nut down until it just contacts the back-up washer.
  3. Screw fitting by hand into straight thread boss until the back-up washer contacts the face of the boss.
  4. Position the fitting by backing out (counter-clockwise) up to one full turn. Hold fitting in desired position and tighten lock nut with a wrench.
  5. Assemble tube to fitting. Retighten lock nut.
- NOTE: O-ring, lock nuts and back-up washers are preassembled on all straight thread fittings.

### Swivel Fitting (Used with Connector)

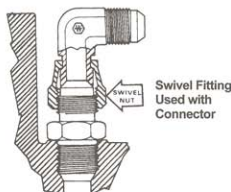

Weatherhead swivel end fittings can be used with a straight connector when space limitations will not permit full rotation of standard straight thread elbows and tees.

1. Screw connector into the O-ring boss and tighten.
2. Thread swivel nut onto connector.
3. Hold fitting in desired position and tighten swivel nut with a wrench.

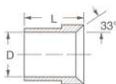
**Sleeve 3 Piece**  
**Stainless Steel No. 5177x**  
 (Ref. SAE No. 070115)

| Tube<br>O.D. | Catalog<br>Number | D     | L    |
|--------------|-------------------|-------|------|
| 1/8          | C5165x2-          | .130  | .34  |
| 3/16         | C5165x3-          | .193  | .34  |
| 1/4          | C5165x4-          | .255  | .41  |
| 5/16         | C5165x5-          | .318  | .44  |
| 3/8          | C5165x6-          | .380  | .50  |
| 1/2          | C5165x8-          | .505  | .56  |
| 5/8          | C5165x10-         | .631  | .66  |
| 3/4          | C5165x12-         | .756  | .68  |
| 7/8          | C5165x14-         | .881  | .76  |
| 1            | C5165x16-         | 1.006 | .78  |
| 1-1/4        | C5165x20-         | 1.260 | .91  |
| 1-1/2        | C5165x24-         | 1.510 | 1.12 |
| 2            | C5165x32-         | 2.014 | 1.19 |

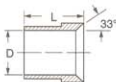
**Sleeve 3 Piece Metric**  
 (Ref. SAE No. 070115)

Adapts Standard SAE Flare-Twin® fittings for use with metric tubing.

| Tube<br>O.D.<br>(Inch Size) | Tube<br>O.D.<br>(Metric Size) | Catalog<br>Number | D     | L    |
|-----------------------------|-------------------------------|-------------------|-------|------|
| 1/4                         | 6MM                           | C5165x4x6MM       | .241  | .41  |
| 5/16                        | 8MM                           | C5165x5x8MM       | .320  | .44  |
| 3/8                         | 10MM                          | C5165x6x10MM      | .399  | .50  |
| 1/2                         | 12MM                          | C5165x8x12MM      | .478  | .56  |
| 5/8                         | 14MM                          | C5165x10x14MM     | .556  | .66  |
| 5/8                         | 15MM                          | C5165x10x15MM     | .596  | .66  |
| 5/8                         | 16MM                          | C5165x10x16MM     | .636  | .66  |
| 3/4                         | 18MM                          | C5165x12x18MM     | .717  | .68  |
| 7/8                         | 20MM                          | C5165x14x20MM     | .793  | .76  |
| 1                           | 25MM                          | C5165x16x25MM     | .990  | .78  |
| 1-1/4                       | 30MM                          | C5165x20x30MM     | 1.191 | .91  |
| 1-1/4                       | 32MM                          | C5165x20x32MM     | 1.270 | .91  |
| 1-1/2                       | 38MM                          | C5165x24x38MM     | 1.510 | 1.12 |

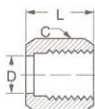
**Nut 3 Piece**  
**Stainless Steel No. 5117x**  
 (Ref. SAE No. 070110)

SAE style 'B'

| Tube<br>O.D. | Catalog<br>Number | Hex<br>C | D     | L    |
|--------------|-------------------|----------|-------|------|
| 1/8          | C5105x2-          | 3/8      | .181  | .55  |
| 3/16         | C5105x3-          | 7/16     | .243  | .61  |
| 1/4          | C5105x4-          | 9/16     | .306  | .62  |
| 5/16         | C5105x5-          | 5/8      | .375  | .68  |
| 3/8          | C5105x6-          | 11/16    | .441  | .73  |
| 1/2          | C5105x8-          | 7/8      | .571  | .85  |
| 5/8          | C5105x10-         | 1        | .698  | .98  |
| 3/4          | C5105x12-         | 1-1/4    | .835  | 1.03 |
| 7/8          | C5105x14-         | 1-3/8    | .961  | 1.09 |
| 1            | C5105x16-         | 1-1/2    | 1.089 | 1.13 |
| 1-1/4        | C5105x20-         | 2        | 1.347 | 1.23 |
| 1-1/2        | C5105x24-         | 2-1/4    | 1.617 | 1.42 |
| 2            | C5105x32-         | 2-7/8    | 2.167 | 1.75 |

**2 Piece Nut (Short)**

| Tube<br>O.D. | Catalog<br>Number | Hex<br>C | D    | L    |
|--------------|-------------------|----------|------|------|
| 1/4          | C5125x4           | 9/16     | .255 | .59  |
| 5/16         | C5125x5           | 5/8      | .318 | .59  |
| 3/8          | C5125x6           | 11/16    | .380 | .66  |
| 1/2          | C5125x8           | 7/8      | .505 | .81  |
| 5/8          | C5125x10          | 1        | .631 | .94  |
| 3/4          | C5125x12          | 1-1/4    | .756 | 1.14 |

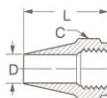
**2 Piece Nut**  
 (Ref. SAE No. 070111)

SAE style 'A'

| Tube<br>O.D. | Catalog<br>Number | Hex<br>C | D     | L    |
|--------------|-------------------|----------|-------|------|
| 1/4          | C5115x4           | 9/16     | .255  | 1.00 |
| 5/16         | C5115x5           | 5/8      | .318  | 1.06 |
| 3/8          | C5115x6           | 11/16    | .380  | 1.09 |
| 1/2          | C5115x8           | 7/8      | .505  | 1.28 |
| 5/8          | C5115x10          | 1        | .631  | 1.48 |
| 3/4          | C5115x12          | 1-1/4    | .756  | 1.66 |
| 7/8          | C5115x14          | 1-3/8    | .881  | 1.81 |
| 1            | C5115x16          | 1-1/2    | 1.006 | 1.94 |
| 1-1/4        | C5115x20          | 2        | 1.260 | 2.19 |
| 1-1/2        | C5115x24          | 2-1/4    | 1.510 | 2.31 |

### Bulkhead Nut

Stainless Steel No. 7936x  
(Ref. SAE No. 070118)

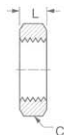

| Tube O.D. | Catalog Number | Hex C | L   |
|-----------|----------------|-------|-----|
| 1/8       | C5924x2        | 9/16  | .22 |
| 3/16      | C5924x3        | 5/8   | .22 |
| 1/4       | C5924x4        | 11/16 | .25 |
| 5/16      | C5924x5        | 3/4   | .28 |
| 3/8       | C5924x6        | 13/16 | .27 |
| 1/2       | C5924x8        | 1     | .31 |
| 5/8       | C5924x10       | 1-1/8 | .36 |
| 3/4       | C5924x12       | 1-3/8 | .41 |
| 7/8       | C5924x14       | 1-1/2 | .41 |
| 1         | C5924x16       | 1-5/8 | .41 |
| 1-1/4     | C5924x20       | 1-7/8 | .41 |
| 1-1/2     | C5924x24       | 2-1/8 | .41 |
| 2         | C5924x32       | 2-3/4 | .41 |

### Cap

Stainless Steel No. 5141x  
(Ref. SAE No. 070112)

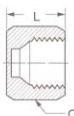

| Tube O.D. | Catalog Number | Hex C | L    |
|-----------|----------------|-------|------|
| 1/8       | C5129x2        | 3/8   | .50  |
| 3/16      | C5129x3        | 7/16  | .56  |
| 1/4       | C5129x4        | 9/16  | .59  |
| 5/16      | C5129x5        | 5/8   | .61  |
| 3/8       | C5129x6        | 11/16 | .62  |
| 1/2       | C5129x8        | 7/8   | .75  |
| 5/8       | C5129x10       | 1     | .84  |
| 3/4       | C5129x12       | 1-1/4 | .91  |
| 1         | C5129x16       | 1-1/2 | 1.02 |
| 1-1/4     | C5129x20       | 2     | 1.06 |
| 1-1/2     | C5129x24       | 2-1/4 | 1.19 |
| 2         | C5129x32       | 2-7/8 | 1.44 |

### Plug

Stainless Steel No. 5241x  
(Ref. SAE No. 070109)

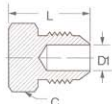

| Tube O.D. | Catalog Number | Hex C   | L    | D1 Opt. |
|-----------|----------------|---------|------|---------|
| 1/4       | C5229x4        | 1/2     | .80  | .172    |
| 5/16      | C5229x5        | 9/16    | .80  | .234    |
| 3/8       | C5229x6        | 5/8     | .84  | .297    |
| 1/2       | C5229x8        | 13/16   | .94  | .391    |
| 5/8       | C5229x10       | 15/16   | 1.10 | .484    |
| 3/4       | C5229x12       | 1-1/8   | 1.28 | .609    |
| 7/8       | C5229x14       | 1-1/4   | 1.31 | .719    |
| 1         | C5229x16       | 1-3/8   | 1.33 | .844    |
| 1-1/4     | C5229x20       | 1-11/16 | 1.45 | 1.078   |
| 1-1/2     | C5229x24       | 2       | 1.65 | 1.312   |
| 2         | C5229x32       | 2-5/8   | 2.05 | 1.781   |

### Reducer

Stainless Steel No. 5027x  
(Ref. SAE No. 070123)  
Example assembly No. C35015x

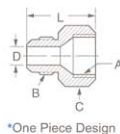
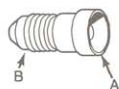

\*One Piece Design

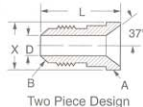

Two Piece Design

| Female Reduction A | Male Reduction B | Catalog Number | D     | L    | Dia. X | Hex C |
|--------------------|------------------|----------------|-------|------|--------|-------|
| 3/8                | 1/4              | C5015x6x4      | .172  | .97  | .502   | —     |
| 1/2                | 1/4              | C5015x8x4      | .172  | 1.00 | .682   | —     |
| 1/2                | 3/8              | C5015x8x6      | .297  | 1.00 | .682   | —     |
| 5/8*               | 1/4              | C5015x10x4     | .172  | 1.47 | —      | 1     |
| 5/8*               | 3/8              | C5015x10x6     | .297  | 1.41 | —      | 1     |
| 5/8*               | 1/2              | C5015x10x8     | .391  | 1.41 | —      | 1     |
| 3/4                | 1/4              | C5015x12x4     | .172  | 1.09 | .972   | —     |
| 3/4                | 3/8              | C5015x12x6     | .297  | 1.09 | .972   | —     |
| 3/4                | 1/2              | C5015x12x8     | .391  | 1.19 | .972   | —     |
| 3/4*               | 5/8              | C5015x12x10    | .484  | 1.58 | —      | 1-1/4 |
| 7/8*               | 3/8              | C5015x14x6     | .297  | 1.59 | —      | 1-3/8 |
| 7/8*               | 1/2              | C5015x14x8     | .391  | 1.69 | —      | 1-3/8 |
| 7/8*               | 5/8              | C5015x14x10    | .484  | 1.73 | —      | 1-3/8 |
| 7/8*               | 3/4              | C5015x14x12    | .609  | 1.80 | —      | 1-3/8 |
| 1*                 | 1/2              | C5015x16x8     | .391  | 1.72 | —      | 1-1/2 |
| 1*                 | 5/8              | C5015x16x10    | .484  | 1.79 | —      | 1-1/2 |
| 1*                 | 3/4              | C5015x16x12    | .609  | 1.47 | 1.222  | —     |
| 1*                 | 7/8              | C5015x16x14    | .719  | 1.87 | —      | 1-1/2 |
| 1-1/4              | 3/4              | C5015x20x12    | .609  | 1.50 | 1.534  | —     |
| 1-1/4*             | 1                | C5015x20x16    | .844  | 2.00 | —      | 2     |
| 1-1/2*             | 1-1/4            | C5015x24x20    | 1.078 | 2.15 | —      | 2-1/4 |
| 2*                 | 1-1/2            | C5015x32x24    | 1.312 | 2.61 | —      | 2-7/8 |

NOTE: Order 3-piece nut C5105x to use reducer.  
No sleeve necessary.

\* Available in stainless steel.

**Small Hex Union**

 Stainless Steel No. **5318x**

(Ref. SAE No. 070101)

Example assembly No. C35305x2

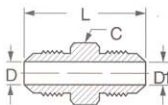

| Tube<br>O.D. | Tube<br>O.D. | Catalog<br>Number | Hex<br>C | D     | D1    | L    |
|--------------|--------------|-------------------|----------|-------|-------|------|
| 1/8          | 1/8          | C5305x2           | 7/16     | .062  | .062  | 1.17 |
| 3/16         | 3/16         | C5305x3           | 7/16     | .125  | .125  | 1.23 |
| 1/4          | 1/4          | C5305x4           | 1/2      | .172  | .172  | 1.37 |
| 5/16         | 1/4          | C5305x5x4         | 9/16     | .234  | .172  | 1.37 |
| 5/16         | 5/16         | C5305x5           | 9/16     | .234  | .234  | 1.37 |
| 3/8          | 1/4          | C5305x6x4         | 5/8      | .297  | .172  | 1.40 |
| 3/8          | 5/16         | C5305x6x5         | 5/8      | .297  | .234  | 1.40 |
| 3/8          | 3/8          | C5305x6           | 5/8      | .297  | .297  | 1.41 |
| 1/2          | 3/8          | C5305x8x6         | 13/16    | .391  | .297  | 1.52 |
| 1/2          | 1/2          | C5305x8           | 13/16    | .391  | .391  | 1.62 |
| 5/8          | 1/2          | C5305x10x8        | 15/16    | .484  | .391  | 1.78 |
| 5/8          | 5/8          | C5305x10          | 15/16    | .484  | .484  | 1.88 |
| 3/4          | 1/2          | C5305x12x8        | 1-1/8    | .609  | .391  | 1.95 |
| 3/4          | 5/8          | C5305x12x10       | 1-1/8    | .609  | .484  | 2.05 |
| 3/4          | 3/4          | C5305x12          | 1-1/8    | .609  | .609  | 2.16 |
| 7/8          | 7/8          | C5305x14          | 1-1/4    | .719  | .719  | 2.21 |
| 1            | 3/4          | C5305x16x12       | 1-3/8    | .844  | .609  | 2.20 |
| 1            | 1            | C5305x16          | 1-3/8    | .844  | .844  | 2.25 |
| 1-1/4        | 1-1/4        | C5305x20          | 1-11/16  | 1.078 | 1.078 | 2.43 |
| 1-1/2        | 1-1/2        | C5305x24          | 2        | 1.312 | 1.312 | 2.75 |
| 2            | 2            | C5305x32          | 2-5/8    | 1.781 | 1.781 | 3.40 |

**Large Hex Union**

 Stainless Steel No. **5318x**

(Ref. SAE No. 070101)

Example assembly No. C35306x4

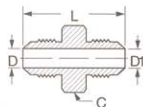

5318x6x4, 5318x8x6

| Tube<br>O.D. | Catalog<br>Number | Hex<br>C | D     | D1    | L    |
|--------------|-------------------|----------|-------|-------|------|
| 1/4          | C5306x4           | 11/16    | .172  | .172  | 1.37 |
| 5/16         | C5306x5           | 3/4      | .234  | .234  | 1.37 |
| 3/8          | C5306x6           | 13/16    | .297  | .297  | 1.41 |
| 1/2          | C5306x8           | 1        | .391  | .391  | 1.62 |
| 5/8          | C5306x10          | 1-1/8    | .484  | .484  | 1.88 |
| 3/4          | C5306x12          | 1-3/8    | .609  | .609  | 2.16 |
| 1            | C5306x16          | 1-5/8    | .844  | .844  | 2.25 |
| 1-1/4        | C5306x20          | 1-7/8    | 1.078 | 1.078 | 2.43 |
| 1-1/2        | C5306x24          | 2-1/8    | 1.312 | 1.312 | 2.75 |

**Bulkhead Union**

 Stainless Steel No. **5337x**

(Ref. SAE No. 070601)

Example assembly No. C35325x4

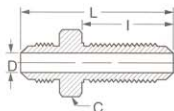
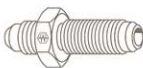

| Tube<br>O.D. | Catalog<br>Number | Hex<br>C | D     | I    | L    |
|--------------|-------------------|----------|-------|------|------|
| 3/16         | C5325x3           | 5/8      | .125  | 1.14 | 1.90 |
| 1/4          | C5325x4           | 11/16    | .172  | 1.23 | 2.07 |
| 5/16         | C5325x5           | 3/4      | .234  | 1.23 | 2.07 |
| 3/8          | C5325x6           | 13/16    | .297  | 1.31 | 2.18 |
| 1/2          | C5325x8           | 1        | .391  | 1.47 | 2.44 |
| 5/8          | C5325x10          | 1-1/8    | .484  | 1.61 | 2.74 |
| 3/4          | C5325x12          | 1-3/8    | .609  | 1.78 | 3.09 |
| 1            | C5325x16          | 1-5/8    | .844  | 1.78 | 3.14 |
| 1-1/4        | C5325x20          | 1-7/8    | 1.078 | 1.83 | 3.31 |

For Bulkhead nut see page 167. Included with assembly.



### Male Connector

Stainless Steel No. 5217x

(Ref. SAE No. 070102)

Example assembly No. C35205x4

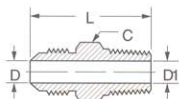

\*Optional counterbore for D1.

| Tube O.D. | Male Pipe Thread | Catalog Number | Hex C   | D     | D1 Opt. | L    |
|-----------|------------------|----------------|---------|-------|---------|------|
| 1/8       | 1/8              | C5205x2        | 7/16    | .062  | .188*   | 1.11 |
| 3/16      | 1/8              | C5205x3        | 7/16    | .125  | .188*   | 1.14 |
| 1/4       | 1/8              | C5205x4        | 1/2     | .172  | .188*   | 1.22 |
| 1/4       | 1/4              | C5205x4x4      | 9/16    | .172  | .281*   | 1.42 |
| 1/4       | 3/8              | C5205x4x6      | 3/4     | .172  | .406*   | 1.42 |
| 1/4       | 1/2              | C5205x4x8      | 7/8     | .172  | .531*   | 1.68 |
| 5/16      | 1/8              | C5205x5        | 9/16    | .234  | .188    | 1.22 |
| 5/16      | 1/4              | C5205x5x4      | 5/8     | .234  | .281*   | 1.42 |
| 5/16      | 3/8              | C5205x5x6      | 13/16   | .234  | .406*   | 1.42 |
| 3/8       | 1/8              | C5205x6x2      | 5/8     | .297  | .188    | 1.24 |
| 3/8       | 1/4              | C5205x6        | 5/8     | .297  | .281    | 1.43 |
| 3/8       | 3/8              | C5205x6x6      | 3/4     | .297  | .297*   | 1.43 |
| 3/8       | 1/2              | C5205x6x8      | 7/8     | .297  | .531*   | 1.69 |
| 1/2       | 1/4              | C5205x8x4      | 13/16   | .391  | .281    | 1.53 |
| 1/2       | 3/8              | C5205x8        | 13/16   | .391  | .406*   | 1.53 |
| 1/2       | 1/2              | C5205x8x8      | 15/16   | .391  | .531*   | 1.79 |
| 1/2       | 3/4              | C5205x8x12     | 1-1/8   | .391  | .719*   | 1.85 |
| 5/8       | 3/8              | C5205x10x6     | 15/16   | .484  | .406    | 1.70 |
| 5/8       | 1/2              | C5205x10       | 15/16   | .484  | .531*   | 1.89 |
| 5/8       | 3/4              | C5205x10x12    | 1-1/8   | .484  | .484*   | 1.95 |
| 3/4       | 1/2              | C5205x12x8     | 1-1/8   | .609  | .531    | 2.06 |
| 3/4       | 3/4              | C5205x12       | 1-1/8   | .609  | .719*   | 2.06 |
| 3/4       | 1                | C5205x12x16    | 1-3/8   | .609  | .938*   | 2.25 |
| 7/8       | 3/4              | C5205x14       | 1-1/4   | .718  | .718*   | 2.09 |
| 1         | 3/4              | C5205x16x12    | 1-3/8   | .844  | .719    | 2.25 |
| 1         | 1                | C5205x16       | 1-3/8   | .844  | .938*   | 2.30 |
| 1         | 1-1/4            | C5205x16x20    | 1-11/16 | .844  | 1.250*  | 2.40 |
| 1-1/4     | 1                | C5205x20x16    | 1-11/16 | 1.078 | .938    | 2.42 |
| 1-1/4     | 1-1/4            | C5205x20       | 1-11/16 | 1.078 | 1.250*  | 2.45 |
| 1-1/2     | 1-1/4            | C5205x24x20    | 2       | 1.312 | 1.250*  | 2.65 |
| 1-1/2     | 1-1/2            | C5205x24       | 2       | 1.312 | 1.500*  | 2.68 |
| 2         | 2                | C5205x32       | 2-5/8   | 1.781 | 1.938*  | 3.11 |

### Female Connector

Stainless Steel No. 5267x

(Ref. SAE No. 070103)

Example assembly No. C35255x4

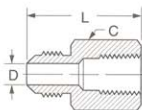

| Tube O.D. | Fem. Pipe Thread | Catalog Number | Hex C | D     | L    |
|-----------|------------------|----------------|-------|-------|------|
| 1/8       | 1/8              | C5255x2        | 9/16  | .062  | 1.12 |
| 3/16      | 1/8              | C5255x3        | 9/16  | .125  | 1.13 |
| 1/4       | 1/8              | C5255x4        | 9/16  | .172  | 1.19 |
| 1/4       | 1/4              | C5255x4x4      | 3/4   | .172  | 1.39 |
| 5/16      | 1/8              | C5255x5        | 9/16  | .234  | 1.17 |
| 5/16      | 1/4              | C5255x5x4      | 3/4   | .234  | 1.39 |
| 3/8       | 1/4              | C5255x6        | 3/4   | .297  | 1.40 |
| 3/8       | 3/8              | C5255x6x6      | 7/8   | .297  | 1.46 |
| 1/2       | 3/8              | C5255x8        | 7/8   | .391  | 1.56 |
| 1/2       | 1/2              | C5255x8x8      | 1-1/8 | .391  | 1.79 |
| 5/8       | 3/8              | C5255x10x6     | 7/8   | .484  | 1.89 |
| 5/8       | 1/2              | C5255x10       | 1-1/8 | .484  | 1.89 |
| 3/4       | 1/2              | C5255x12x8     | 1-1/8 | .609  | 2.05 |
| 3/4       | 3/4              | C5255x12       | 1-3/8 | .609  | 2.06 |
| 7/8       | 3/4              | C5255x14       | 1-3/8 | .875  | 2.06 |
| 1         | 1                | C5255x16       | 1-5/8 | .844  | 2.35 |
| 1-1/4     | 1-1/4            | C5255x20       | 2     | 1.078 | 2.49 |
| 1-1/2     | 1-1/2            | C5255x24       | 2-3/8 | 1.312 | 2.62 |
| 2         | 2                | C5255x32       | 2-7/8 | 1.781 | 2.97 |

### Female Bulkhead Connector

Example assembly No. C35275x4



For Bulkhead nut see page 167. Included with assembly.

| Tube O.D. | Fem. Pipe Thread | Catalog Number | Hex C | D    | I    | L    |
|-----------|------------------|----------------|-------|------|------|------|
| 1/4       | 1/8              | C5275x4        | 11/16 | .172 | 1.23 | 1.84 |
| 3/8       | 1/4              | C5275x6        | 13/16 | .297 | 1.31 | 2.06 |
| 1/2       | 3/8              | C5275x8        | 1     | .391 | 1.47 | 2.35 |
| 5/8       | 1/2              | C5275x10       | 1-1/8 | .484 | 1.61 | 2.66 |
| 3/4       | 3/4              | C5275x12       | 1-3/8 | .609 | 1.78 | 2.91 |
| 1         | 1                | C5275x16       | 1-5/8 | .844 | 1.78 | 3.09 |

\* Available in stainless steel.

## Male JIC 37° SAE to Female For-Seal®

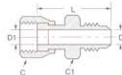

| Female<br>Tube<br>O.D. | Male<br>37° Tube<br>Size | Catalog<br>Number | Hex<br>C1 | Hex<br>C | D    | D1   | L    |
|------------------------|--------------------------|-------------------|-----------|----------|------|------|------|
| 1/4                    | 1/4                      | 4213x4            | 11/16     | 5/8      | .172 | .165 | 1.50 |
| 3/8                    | 3/8                      | 4213x6            | 13/16     | 3/4      | .297 | .264 | 1.62 |
| 1/2                    | 1/2                      | 4213x8            | 15/16     | 7/8      | .397 | .358 | 1.90 |
| 5/8                    | 5/8                      | 4213x10           | 1-1/8     | 1-1/16   | .484 | .453 | 2.25 |
| 3/4                    | 3/4                      | 4213x12           | 1-3/16    | 1-1/4    | .609 | .547 | 2.48 |
| 1                      | 1                        | 4213x16           | 1-5/8     | 1-1/2    | .811 | .783 | 2.84 |

## Straight Thread O-Ring Connector

Stainless Steel No. 5327x

(Ref. SAE No. 070120)

Example assembly No. C35315x4

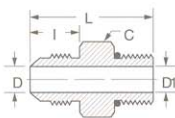

| Tube<br>O.D. | Port<br>Size | Catalog<br>Number | Hex<br>C | D     | D1<br>Opt. | I    | L    |
|--------------|--------------|-------------------|----------|-------|------------|------|------|
| 1/8          | 1/8          | C5315x2-          | 7/16     | .062  | .062*      | .45  | 1.06 |
| 3/16         | 3/16         | C5315x3           | 1/2      | .125  | .125*      | .48  | 1.10 |
| 1/4          | 1/4          | C5315x4-          | 9/16     | .172  | .172*      | .55  | 1.23 |
| 1/4          | 5/16         | C5315x4x5-        | 5/8      | .172  | .234*      | .55  | 1.23 |
| 1/4          | 3/8          | C5315x4x6         | 11/16    | .172  | .297*      | .55  | 1.29 |
| 1/4          | 1/2          | C5315x4x8         | 7/8      | .172  | .391*      | .55  | 1.37 |
| 5/16         | 1/4          | C5315x5x4         | 5/8      | .234  | .172       | .55  | 1.23 |
| 5/16         | 5/16         | C5315x5           | 5/8      | .234  | .234*      | .55  | 1.23 |
| 5/16         | 3/8          | C5315x5x6         | 11/16    | .234  | .297*      | .55  | 1.29 |
| 3/8          | 1/4          | C5315x6x4         | 11/16    | .297  | .172       | .56  | 1.27 |
| 3/8          | 5/16         | C5315x6x5         | 11/16    | .297  | .234       | .56  | 1.27 |
| 3/8          | 3/8          | C5315x6-          | 11/16    | .297  | .297*      | .56  | 1.30 |
| 3/8          | 1/2          | C5315x6x8-        | 7/8      | .297  | .391*      | .56  | 1.38 |
| 3/8          | 5/8          | C5315x6x10        | 1        | .297  | .484*      | .56  | 1.50 |
| 1/2          | 3/8          | C5315x8x6         | 13/16    | .391  | .297       | .66  | 1.44 |
| 1/2          | 1/2          | C5315x8-          | 7/8      | .391  | .391*      | .66  | 1.48 |
| 1/2          | 5/8          | C5315x8x10-       | 1        | .391  | .484*      | .66  | 1.60 |
| 1/2          | 3/4          | C5315x8x12-       | 1-1/4    | .391  | .609*      | .66  | 1.76 |
| 5/8          | 1/2          | C5315x10x8        | 1        | .484  | .391       | .76  | 1.64 |
| 5/8          | 5/8          | C5315x10-         | 1        | .484  | .484*      | .76  | 1.70 |
| 5/8          | 3/4          | C5315x10x12       | 1-1/4    | .484  | .609*      | .76  | 1.86 |
| 5/8          | 1            | C5315x10x16       | 1-1/2    | .484  | .844*      | .76  | 1.89 |
| 3/4          | 1/2          | C5315x12x8        | 1-1/4    | .609  | .391       | .86  | 1.94 |
| 3/4          | 5/8          | C5315x12x10       | 1-1/8    | .609  | .484       | .86  | 1.88 |
| 3/4          | 3/4          | C5315x12-         | 1-1/4    | .609  | .609*      | .86  | 1.97 |
| 3/4          | 7/8          | C5315x12x14       | 1-3/8    | .609  | .718*      | .86  | 1.96 |
| 3/4          | 1            | C5315x12x16       | 1-1/2    | .609  | .844*      | .86  | 1.99 |
| 3/4          | 1-1/4        | C5315x12x20       | 1-7/8    | .609  | 1.078*     | .86  | 2.08 |
| 7/8          | 7/8          | C5315x14          | 1-3/8    | .719  | .719*      | .89  | 1.99 |
| 1            | 5/8          | C5315x16x10       | 1-1/2    | .844  | .484       | .91  | 2.07 |
| 1            | 3/4          | C5315x16x12       | 1-1/2    | .844  | .609       | .91  | 2.04 |
| 1            | 1            | C5315x16-         | 1-1/2    | .844  | .844*      | .91  | 2.04 |
| 1            | 1-1/4        | C5315x16x20       | 1-7/8    | .844  | 1.078*     | .91  | 2.12 |
| 1-1/4        | 1            | C5315x20x16       | 1-7/8    | 1.078 | .844       | .96  | 2.33 |
| 1-1/4        | 1-1/4        | C5315x20          | 1-7/8    | 1.078 | 1.078*     | .96  | 2.17 |
| 1-1/4        | 1-1/2        | C5315x20x24       | 2-1/8    | 1.078 | 1.312*     | .96  | 2.24 |
| 1-1/2        | 1-1/4        | C5315x24x20       | 2-1/8    | 1.312 | 1.078*     | 1.08 | 2.53 |
| 1-1/2        | 1-1/2        | C5315x24          | 2-1/8    | 1.312 | 1.312*     | 1.08 | 2.37 |
| 1-1/2        | 2            | C5315x24x32       | 2-3/4    | 1.312 | 1.781*     | 1.08 | 2.53 |
| 2            | 1-1/2        | C5315x32x24       | 2-3/4    | 1.781 | 1.312*     | 1.33 | 2.81 |
| 2            | 2            | C5315x32          | 2-3/4    | 1.781 | 1.781      | 1.33 | 2.78 |

\*Optional counterbore for D1.  
Replacement O-rings page 183.

## Straight Thread O-Ring Extended Connector

(Ref. SAE No. 070122)

Example assembly No. C35316x4

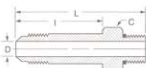

| Tube<br>O.D. | Port<br>Size | Catalog<br>Number | Hex<br>C | D     | I    | L    |
|--------------|--------------|-------------------|----------|-------|------|------|
| 1/4          | 1/4          | C5316x4           | 9/16     | .172  | 1.39 | 2.08 |
| 3/8          | 3/8          | C5316x6           | 11/16    | .297  | 1.56 | 2.31 |
| 1/2          | 3/8          | C5316x8x6         | 7/8      | .297  | 1.56 | 2.38 |
| 1/2          | 1/2          | C5316x8           | 7/8      | .391  | 1.88 | 2.70 |
| 5/8          | 5/8          | C5316x10          | 1        | .484  | 2.09 | 3.04 |
| 3/4          | 3/4          | C5316x12          | 1-1/4    | .609  | 2.50 | 3.61 |
| 1            | 1            | C5316x16          | 1-1/2    | .844  | 2.84 | 3.98 |
| 1-1/4        | 1-1/4        | C5316x20          | 1-7/8    | 1.078 | 3.47 | 4.69 |

Replacement O-rings page 183.

\* Available in stainless steel.

### Adapter

Example assembly No. C35880x4

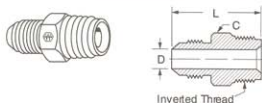

| Tube O.D. | Inverted Thread | Catalog Number | Hex C | D    | L    |
|-----------|-----------------|----------------|-------|------|------|
| 1/4       | 7/16-24         | C5880x4        | 1/2   | .172 | 1.08 |
| 5/16      | 1/2-20          | C5880x5        | 9/16  | .234 | 1.14 |
| 3/8       | 5/8-18          | C5880x6        | 11/16 | .297 | 1.22 |
| 1/2       | 3/4-18          | C5880x8        | 13/16 | .391 | 1.46 |

### Female JIC 37° Swivel to Male Pipe Adapter

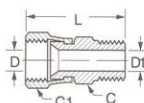

| Tube O.D. | Male Pipe Size | Catalog Number | Hex C | Hex C1 | D     | D1     | L    |
|-----------|----------------|----------------|-------|--------|-------|--------|------|
| 1/4       | 1/4            | 9100x4x4       | 9/16  | 9/16   | .172  | .281*  | 1.50 |
| 5/16      | 1/4            | 9100x5x4       | 11/16 | 5/8    | .234  | .281*  | 1.57 |
| 3/8       | 1/4            | 9100x6x4       | 11/16 | 11/16  | .297  | .281   | 1.69 |
| 3/8       | 3/8            | 9100x6x6       | 11/16 | 11/16  | .297  | .406*  | 1.69 |
| 1/2       | 3/8            | 9100x8x6       | 7/8   | 7/8    | .391  | .406*  | 1.87 |
| 1/2       | 1/2            | 9100x8x8       | 7/8   | 7/8    | .391  | .531*  | 2.05 |
| 5/8       | 3/8            | 9100x10x6      | 1     | 1      | .484  | .406   | 1.91 |
| 5/8       | 1/2            | 9100x10x8      | 1     | 1      | .484  | .531*  | 2.11 |
| 3/4       | 1/2            | 9100x12x8      | 1-1/8 | 1-1/4  | .609  | .531   | 2.21 |
| 3/4       | 3/4            | 9100x12x12     | 1-1/8 | 1-1/4  | .609  | .719*  | 2.21 |
| 1         | 3/4            | 9100x16x12     | 1-3/8 | 1-1/2  | .844  | .719   | 2.36 |
| 1         | 1              | 9100x16x16     | 1-3/8 | 1-1/2  | .844  | .938*  | 2.55 |
| 1-1/4     | 1-1/4          | 9100x20x20     | 1-7/8 | 2      | 1.078 | 1.250* | 2.73 |

\*Optional counterbore for D1.

### Male JIC 37° to Male Metric Standpipe

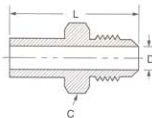
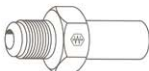

| Tube O.D. | Tube O.D. (mm) | Catalog Number | Hex C | L    | D   |
|-----------|----------------|----------------|-------|------|-----|
| 1/4       | 6MM            | MC5019x4x6     | 9/16  | 1.58 | .16 |
| 1/4       | 8MM            | MC5019x4x8     | 9/16  | 1.68 | .17 |
| 3/8       | 10MM           | MC5019x6x10    | 3/4   | 1.67 | .28 |
| 1/2       | 12MM           | MC5019x8x12    | 7/8   | 1.97 | .32 |
| 1/2       | 14MM           | MC5019x8x14    | 7/8   | 1.89 | .39 |
| 5/8       | 15MM           | MC5019x10x15   | 1     | 2.03 | .43 |
| 5/8       | 16MM           | MC5019x10x16   | 1     | 2.07 | .47 |
| 3/4       | 16MM           | MC5019x12x16   | 1-1/4 | 2.22 | .47 |
| 3/4       | 18MM           | MC5019x12x18   | 1-1/4 | 2.12 | .55 |
| 3/4       | 20MM           | MC5019x12x20   | 1-1/4 | 2.38 | .61 |
| 1         | 22MM           | MC5019x16x22   | 1-1/2 | 2.21 | .67 |
| 1         | 25MM           | MC5019x16x25   | 1-1/2 | 2.54 | .79 |

For metric flareless nuts and sleeves see page 211.

### Male JIC 37° to O-Ring Port Adapter

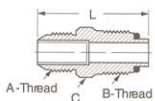

| Tube Size | Port Size | Catalog Number | Replacement O-Ring | Thread A  | Thread B  | Hex C | L    |
|-----------|-----------|----------------|--------------------|-----------|-----------|-------|------|
| 1/4       | 1/4       | 41157x4        | 7629x1             | 7/16-20   | 7/16-24   | 7/16  | 1.33 |
| 3/8       | 3/8       | 41157x6        | 7629x3             | 9/16-18   | 5/8-18    | 5/8   | 1.47 |
| 1/2       | 1/2       | 41157x8        | 7629x5             | 3/4-16    | 3/4-16    | 3/4   | 1.91 |
| 5/8       | 5/8       | 41157x10       | 7629x7             | 7/8-14    | 7/8-14    | 15/16 | 2.23 |
| 3/4       | 3/4       | 41157x12       | 7629x8             | 1-1/16-12 | 1-1/16-16 | 1-1/8 | 2.13 |



## 90° Elbow - Female JIC 37° Swivel to Male Straight Thread O-Ring

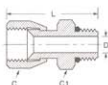

For replacement Straight Thread O-rings, see page 183.

| Tube O.D. | Port Size | Catalog Number | Hex C | Hex C1 | L    | D    |
|-----------|-----------|----------------|-------|--------|------|------|
| 1/4       | 1/4       | C5216x4x4      | 9/16  | 9/16   | 1.32 | .17  |
| 1/4       | 3/8       | C5216x4x6      | 11/16 | 11/16  | 1.37 | .17  |
| 3/8       | 3/8       | C5216x6x6      | 11/16 | 11/16  | 1.51 | .30  |
| 3/8       | 1/2       | C5216x6x8      | 11/16 | 7/8    | 1.58 | .30  |
| 1/2       | 3/8       | C5216x8x6      | 7/8   | 3/4    | 1.62 | .30  |
| 1/2       | 1/2       | C5216x8x8      | 7/8   | 7/8    | 1.61 | .39  |
| 5/8       | 5/8       | C5216x10x10    | 1     | 1      | 1.96 | .48  |
| 3/4       | 3/4       | C5216x12x12    | 1-1/4 | 1-1/4  | 2.17 | .61  |
| 1         | 1         | C5216x16x16    | 1-1/2 | 1-1/2  | 2.30 | .84  |
| 1-1/4     | 1-1/4     | C5216x20x20    | 2     | 1-7/8  | 2.47 | 1.08 |
| 1-1/2     | 1-1/2     | C5216x24x24    | 2-1/8 | 2-1/8  | 2.63 | 1.31 |
| 2         | 2         | C5216x32x32    | 2-3/4 | 2-3/4  | 2.95 | 1.78 |

## Female JIC 37° Swivel to Female Pipe



| Tube O.D. | Female Pipe | Catalog Number | Hex C | Hex C1 | L    | D    |
|-----------|-------------|----------------|-------|--------|------|------|
| 1/4       | 1/4         | C5256x4x4      | 9/16  | 3/4    | 1.32 | .172 |
| 3/8       | 3/8         | C5256x6x6      | 11/16 | 7/8    | 1.63 | .297 |
| 1/2       | 1/2         | C5256x8x8      | 7/8   | 1-1/8  | 1.81 | .391 |
| 3/4       | 3/4         | C5256x12       | 1-1/4 | 1-1/4  | 2.08 | .609 |
| 1         | 1           | C5256x16       | 1-1/2 | 1-1/2  | 2.62 | .844 |

## 45° Male Elbow Stainless Steel No. 5367x (Ref. SAE No. 070302) Example assembly No. C35355x4

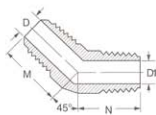

| Tube O.D. | Male Pipe Thread | Catalog Number | D     | D1    | M    | N    | Across Flats |
|-----------|------------------|----------------|-------|-------|------|------|--------------|
| 1/8       | 1/8              | C5355x2        | .062  | .188  | .66  | .52  | 7/16         |
| 3/16      | 1/8              | C5355x3        | .125  | .188  | .66  | .52  | 7/16         |
| 1/4       | 1/8              | C5355x4        | .172  | .188  | .72  | .64  | 7/16         |
| 1/4       | 1/4              | C5355x4x4      | .172  | .281  | .83  | .86  | 9/16         |
| 5/16      | 1/8              | C5355x5        | .234  | .188  | .77  | .67  | 9/16         |
| 5/16      | 1/4              | C5355x5x4      | .234  | .281  | .83  | .86  | 9/16         |
| 3/8       | 1/8              | C5355x6x2      | .297  | .188  | .83  | .69  | 9/16         |
| 3/8       | 1/4              | C5355x6        | .297  | .281  | .83  | .86  | 9/16         |
| 3/8       | 3/8              | C5355x6x6      | .297  | .406  | .98  | .95  | 3/4          |
| 3/8       | 1/2              | C5355x6x8      | .297  | .531  | 1.06 | 1.17 | 7/8          |
| 1/2       | 1/4              | C5355x8x4      | .391  | .281  | .98  | .95  | 3/4          |
| 1/2       | 3/8              | C5355x8        | .391  | .406  | .98  | .95  | 3/4          |
| 1/2       | 1/2              | C5355x8x8      | .391  | .531  | .99  | 1.17 | 7/8          |
| 5/8       | 3/8              | C5355x10x6     | .484  | .406  | 1.11 | 1.00 | 7/8          |
| 5/8       | 1/2              | C5355x10       | .484  | .531  | 1.11 | 1.17 | 7/8          |
| 3/4       | 1/2              | C5355x12x8     | .609  | .531  | 1.28 | 1.20 | 1-1/16       |
| 3/4       | 3/4              | C5355x12       | .609  | .719  | 1.28 | 1.20 | 1-1/16       |
| 1         | 3/4              | C5355x16x12    | .844  | .719  | 1.47 | 1.27 | 1-5/16       |
| 1         | 1                | C5355x16       | .844  | .938  | 1.47 | 1.48 | 1-5/16       |
| 1-1/2     | 1-1/2            | C5355x24       | 1.312 | 1.500 | 1.78 | 1.77 | 1-7/8        |
| 1/8       | 1/8              | TF5355x2       | .062  | .188  | .66  | .52  | 7/16         |
| 1/4       | 1/8              | TF5355x4       | .172  | .188  | .72  | .64  | 1/2          |
| 1/4       | 1/4              | TF5355x4x4     | .172  | .281  | .81  | .86  | 5/8          |
| 5/16      | 1/8              | TF5355x5       | .234  | .188  | .76  | .64  | 9/16         |
| 5/16      | 1/4              | TF5355x5x4     | .234  | .281  | .83  | .86  | 5/8          |
| 3/8       | 1/8              | TF5355x6x2     | .297  | .188  | .81  | .66  | 5/8          |
| 3/8       | 1/4              | TF5355x6       | .297  | .281  | .82  | .86  | 5/8          |
| 3/8       | 3/8              | TF5355x6x6     | .297  | .406  | .91  | .95  | 13/16        |
| 3/8       | 1/2              | TF5355x6x8     | .297  | .531  | 1.03 | 1.17 | 15/16        |
| 1/2       | 1/4              | TF5355x8x4     | .391  | .281  | .98  | .94  | 13/16        |
| 1/2       | 3/8              | TF5355x8       | .391  | .406  | .98  | .95  | 13/16        |
| 1/2       | 1/2              | TF5355x8x8     | .391  | .531  | 1.12 | 1.17 | 15/16        |
| 5/8       | 3/8              | TF5355x10x6    | .484  | .406  | 1.11 | 1.06 | 15/16        |
| 5/8       | 1/2              | TF5355x10      | .484  | .531  | 1.11 | 1.17 | 15/16        |
| 5/8       | 3/4              | TF5355x10x12   | .484  | .719  | 1.26 | 1.20 | 1-1/8        |
| 3/4       | 1/2              | TF5355x12x8    | .609  | .531  | 1.28 | 1.17 | 1-1/8        |
| 3/4       | 3/4              | TF5355x12      | .609  | .719  | 1.28 | 1.20 | 1-1/8        |
| 3/4       | 1                | TF5355x12x16   | .609  | .938  | 1.42 | 1.48 | 1-3/8        |
| 1         | 3/4              | TF5355x16x12   | .844  | .719  | 1.47 | 1.28 | 1-3/8        |
| 1         | 1                | TF5355x16      | .844  | .938  | 1.47 | 1.48 | 1-3/8        |
| 1-1/4     | 1-1/4            | TF5355x20      | 1.078 | 1.250 | 1.59 | 1.67 | 1-3/4        |
| 1-1/2     | 1-1/2            | TF5355x24      | 1.312 | 1.500 | 1.78 | 1.77 | 2            |
| 2         | 2                | TF5355x32      | 1.781 | 1.938 | 2.22 | 2.11 | 2-5/8        |

### 45° Elbow - Swivel Nut

Stainless Steel No. 5368x

(Ref. SAE No. 070321)

Example assembly No. C35356x4

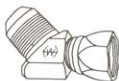
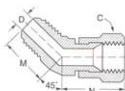

\*Special Order Only

### 45° Bulkhead Union Elbow

(Ref. SAE No. 070801)

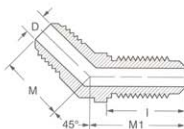
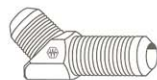

For Bulkhead nut see page 167. Included with assembly.

\* Available in stainless steel.

| Tube O.D. | Catalog Number | Hex C | D     | M    | N    | Across Flats |
|-----------|----------------|-------|-------|------|------|--------------|
| 1/4       | C5356x4        | 9/16  | .172  | .72  | .94  | 7/16         |
| 5/16      | C5356x5*       | 5/8   | .234  | .77  | 1.00 | 9/16         |
| 3/8       | C5356x6*       | 11/16 | .297  | .83  | 1.12 | 9/16         |
| 1/2       | C5356x8*       | 7/8   | .391  | .98  | 1.28 | 3/4          |
| 5/8       | C5356x10       | 1     | .484  | 1.11 | 1.44 | 7/8          |
| 3/4       | C5356x12       | 1-1/4 | .609  | 1.28 | 1.50 | 1-1/16       |
| 7/8       | C5356x14       | 1-3/8 | .718  | 1.39 | 1.62 | 1-5/16       |
| 1         | C5356x16       | 1-1/2 | .845  | 1.47 | 1.75 | 1-5/16       |
| 1-1/4     | C5356x20*      | 2     | 1.078 | 1.59 | 2.03 | 1-5/8        |
| 1-1/2     | C5356x24       | 2-1/4 | 1.312 | 1.78 | 2.25 | 1-7/8        |
| 1/4       | TF5356x4       | 9/16  | .172  | .72  | .94  | 1/2          |
| 5/16      | TF5356x5       | 5/8   | .234  | .77  | 1.00 | 9/16         |
| 3/8       | TF5356x6       | 11/16 | .297  | .83  | 1.12 | 5/8          |
| 1/2       | TF5356x8       | 7/8   | .391  | .98  | 1.28 | 13/16        |
| 5/8       | TF5356x10      | 1     | .484  | 1.11 | 1.44 | 15/16        |
| 3/4       | TF5356x12      | 1-1/4 | .609  | 1.28 | 1.50 | 1-1/8        |
| 1         | TF5356x16      | 1-1/2 | .845  | 1.47 | 1.75 | 1-3/8        |
| 1-1/4     | TF5356x20      | 2     | 1.078 | 1.59 | 2.03 | 1-3/4        |
| 1-1/2     | TF5356x24      | 2-1/4 | 1.312 | 1.78 | 2.25 | 2            |
| 2         | TF5356x32      | 2-7/8 | 1.781 | 2.22 | 2.91 | 2-5/8        |

| Tube O.D. | Catalog Number | D    | M    | M1   | Across Flats | I    |
|-----------|----------------|------|------|------|--------------|------|
| 1/4       | TF5375x4       | .172 | .72  | 1.53 | 1/2          | 1.11 |
| 5/16      | TF5375x5       | .234 | .76  | 1.53 | 9/16         | 1.11 |
| 3/8       | TF5375x6       | .297 | .83  | 1.67 | 5/8          | 1.18 |
| 1/2       | TF5375x8       | .391 | .98  | 1.94 | 13/16        | 1.38 |
| 5/8       | TF5375x10      | .484 | 1.11 | 2.17 | 15/16        | 1.52 |
| 3/4       | TF5375x12      | .609 | 1.28 | 2.44 | 1-1/8        | 1.69 |
| 1         | TF5375x16      | .844 | 1.47 | 2.56 | 1-3/8        | 1.69 |

**45° Elbow - Straight Thread  
O-Ring**

(Ref. SAE No. 070320)

Example assembly No. C35365x4

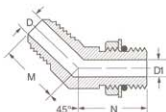

Replacement O-rings page 183.

\*Special Order Only.

| Tube<br>O.D. | Port<br>Size | Catalog<br>Number | D     | D1    | M    | N    | Across<br>Flats |
|--------------|--------------|-------------------|-------|-------|------|------|-----------------|
| 1/4          | 1/4          | C5365x4           | .172  | .172  | .72  | 1.05 | 7/16            |
| 5/16         | 5/16         | C5365x5           | .234  | .234  | .77  | 1.05 | 9/16            |
| 3/8          | 3/8          | C5365x6           | .297  | .297  | .83  | 1.14 | 9/16            |
| 1/2          | 1/2          | C5365x8           | .391  | .391  | .98  | 1.30 | 3/4             |
| 1/2          | 5/8          | C5365x8x10        | .391  | .484  | .99  | 1.52 | 7/8             |
| 5/8          | 5/8          | C5365x10          | .484  | .484  | 1.11 | 1.52 | 7/8             |
| 3/4          | 5/8          | C5365x12x10       | .609  | .484  | 1.28 | 1.57 | 1-1/16          |
| 3/4          | 3/4          | C5365x12          | .609  | .609  | 1.28 | 1.73 | 1-1/16          |
| 1            | 1            | C5365x16          | .844  | .844  | 1.47 | 1.86 | 1-5/16          |
| 1-1/4        | 1-1/4        | C5365x20          | 1.078 | 1.078 | 1.59 | 1.91 | 1-5/8           |
| 1-1/2        | 1-1/2        | C5365x24*         | 1.312 | 1.312 | 1.78 | 1.91 | 1-7/8           |
| 1/4          | 1/4          | TF5365x4          | .172  | .172  | .72  | 1.05 | 1/2             |
| 5/16         | 5/16         | TF5365x5          | .234  | .234  | .77  | 1.05 | 9/16            |
| 3/8          | 3/8          | TF5365x6          | .297  | .297  | .83  | 1.14 | 5/8             |
| 3/8          | 1/2          | TF5365x6x8        | .297  | .391  | .87  | 1.30 | 13/16           |
| 1/2          | 3/8          | TF5365x8x6        | .391  | .297  | .98  | 1.17 | 13/16           |
| 1/2          | 1/2          | TF5365x8          | .391  | .391  | .98  | 1.30 | 13/16           |
| 1/2          | 5/8          | TF5365x8x10       | .391  | .484  | .99  | 1.52 | 15/16           |
| 5/8          | 1/2          | TF5365x10x8       | .484  | .391  | 1.09 | 1.41 | 15/16           |
| 5/8          | 5/8          | TF5365x10         | .484  | .484  | 1.09 | 1.52 | 15/16           |
| 5/8          | 3/4          | TF5365x10x12      | .484  | .609  | 1.22 | 1.73 | 1-1/8           |
| 3/4          | 5/8          | TF5365x12x10      | .609  | .484  | 1.30 | 1.58 | 1-1/8           |
| 3/4          | 3/4          | TF5365x12         | .609  | .609  | 1.28 | 1.73 | 1-1/8           |
| 3/4          | 1            | TF5365x12x16      | .609  | .844  | 1.45 | 1.86 | 1-3/8           |
| 7/8          | 7/8          | TF5365x14         | .718  | .718  | 1.39 | 1.80 | 1-1/4           |
| 1            | 3/4          | TF5365x16x12      | .844  | .609  | 1.47 | 1.86 | 1-3/8           |
| 1            | 1            | TF5365x16         | .844  | .844  | 1.47 | 1.86 | 1-3/8           |
| 1-1/4        | 1-1/4        | TF5365x20         | 1.078 | 1.250 | 1.59 | 1.91 | 1-3/4           |
| 1-1/2        | 1-1/2        | TF5365x24         | 1.312 | 1.312 | 1.78 | 1.91 | 2               |
| 2            | 2            | TF5365x32         | 1.781 | 1.938 | 2.22 | 1.86 | 2-5/8           |

**90° Union Elbow**

Stainless Steel No. 5517x

(Ref. SAE No. 070201)

Example assembly No. C35505x4

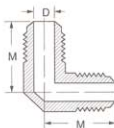

| Tube<br>O.D. | Catalog<br>Number | D     | M    | Across<br>Flats |
|--------------|-------------------|-------|------|-----------------|
| 1/4          | C5505x4*          | .172  | .89  | 7/16            |
| 5/16         | C5505x5*          | .234  | .95  | 9/16            |
| 3/8          | C5505x6*          | .297  | 1.06 | 9/16            |
| 1/2          | C5505x8*          | .391  | 1.25 | 3/4             |
| 5/8          | C5505x10*         | .484  | 1.45 | 7/8             |
| 3/4          | C5505x12*         | .609  | 1.66 | 1-1/16          |
| 1            | C5505x16*         | .844  | 1.81 | 1-5/16          |
| 1-1/4        | C5505x20*         | 1.078 | 2.06 | 1-5/8           |
| 1-1/2        | C5505x24*         | 1.312 | 2.33 | 1-7/8           |
| 1/4          | TF5505x4          | .172  | .89  | 1/2             |
| 5/16         | TF5505x5          | .234  | .95  | 1/2             |
| 3/8          | TF5505x6          | .297  | 1.06 | 5/8             |
| 1/2          | TF5505x8          | .391  | 1.25 | 13/16           |
| 5/8          | TF5505x10         | .484  | 1.45 | 15/16           |
| 3/4          | TF5505x12         | .609  | 1.66 | 1-1/8           |
| 7/8          | TF5505x14         | .718  | 1.73 | 1-1/4           |
| 1            | TF5505x16         | .844  | 1.81 | 1-3/8           |
| 1-1/4        | TF5505x20         | 1.078 | 2.06 | 1-3/4           |
| 1-1/2        | TF5505x24         | 1.312 | 2.33 | 2               |
| 2            | TF5505x32         | 1.781 | 3.06 | 2-5/8           |

\*Special Order Only

\* Available in stainless steel.

### 90° Male Elbow

Stainless Steel No. 5417x

(Ref. SAE No. 070202)

Example assembly No. C.35405x4

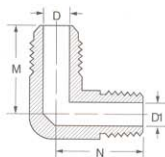

| Tube<br>O.D. | Male<br>Pipe<br>Thread | Catalog<br>Number | D     | D1    | M    | N    | Across<br>Flats |
|--------------|------------------------|-------------------|-------|-------|------|------|-----------------|
| 1/8          | 1/8                    | C5405x2           | .062  | .188  | .77  | .72  | 7/16            |
| 3/16         | 1/8                    | C5405x3           | .125  | .188  | .83  | .72  | 7/16            |
| 1/4          | 1/8                    | C5405x4           | .172  | .188  | .89  | .78  | 7/16            |
| 1/4          | 1/4                    | C5405x4x4         | .172  | .281  | 1.05 | 1.09 | 9/16            |
| 5/16         | 1/8                    | C5405x5           | .234  | .188  | .95  | .78  | 9/16            |
| 5/16         | 1/4                    | C5405x5x4         | .234  | .281  | 1.05 | 1.09 | 9/16            |
| 3/8          | 1/8                    | C5405x6x2         | .297  | .188  | 1.06 | .90  | 9/16            |
| 3/8          | 1/4                    | C5405x6           | .297  | .281  | 1.06 | 1.09 | 9/16            |
| 3/8          | 3/8                    | C5405x6x6         | .297  | .406  | 1.14 | 1.22 | 3/4             |
| 3/8          | 1/2                    | C5405x6x8         | .297  | .531  | 1.22 | 1.47 | 7/8             |
| 1/2          | 1/4                    | C5405x8x4         | .391  | .281  | 1.25 | 1.22 | 3/4             |
| 1/2          | 3/8                    | C5405x8           | .391  | .406  | 1.25 | 1.22 | 3/4             |
| 1/2          | 1/2                    | C5405x8x8         | .391  | .531  | 1.33 | 1.47 | 7/8             |
| 1/2          | 3/4                    | C5405x8x12        | .391  | .719  | 1.42 | 1.59 | 1-1/16          |
| 5/8          | 3/8                    | C5405x10x6        | .484  | .406  | 1.45 | 1.28 | 7/8             |
| 5/8          | 1/2                    | C5405x10          | .484  | .531  | 1.45 | 1.47 | 7/8             |
| 5/8          | 3/4                    | C5405x10x12       | .484  | .719  | 1.54 | 1.59 | 1-1/16          |
| 3/4          | 1/2                    | C5405x12x8        | .609  | .531  | 1.66 | 1.59 | 1-1/16          |
| 3/4          | 3/4                    | C5405x12          | .609  | .719  | 1.66 | 1.59 | 1-1/16          |
| 7/8          | 3/4                    | C5405x14          | .719  | .719  | 1.73 | 1.69 | 1-5/16          |
| 1            | 3/4                    | C5405x16x12       | .844  | .719  | 1.81 | 1.78 | 1-5/16          |
| 1            | 1                      | C5405x16          | .844  | .938  | 1.81 | 1.97 | 1-5/16          |
| 1-1/4        | 1                      | C5405x20x16       | 1.078 | .938  | 2.06 | 2.38 | 1-5/8           |
| 1-1/4        | 1-1/4                  | C5405x20          | 1.078 | 1.250 | 2.06 | 2.38 | 1-5/8           |
| 1-1/2        | 1-1/2                  | C5405x24          | 1.312 | 1.500 | 2.33 | 2.64 | 1-7/8           |
| 2            | 2                      | C5405x32          | 1.781 | 1.938 | 3.06 | 3.00 | 2-9/16          |
| 1/4          | 1/8                    | TF5405x4          | .172  | .188  | .89  | .78  | 1/2             |
| 1/4          | 1/4                    | TF5405x4x4        | .172  | .281  | .95  | 1.09 | 5/8             |
| 1/4          | 3/8                    | TF5405x4x6        | .172  | .406  | 1.05 | 1.22 | 13/16           |
| 1/4          | 1/2                    | TF5405x4x8        | .172  | .531  | 1.11 | 1.47 | 15/16           |
| 5/16         | 1/8                    | TF5405x5          | .234  | .188  | .95  | .78  | 9/16            |
| 5/16         | 1/4                    | TF5405x5x4        | .234  | .281  | .98  | 1.09 | 5/8             |
| 5/16         | 3/8                    | TF5405x5x6        | .234  | .406  | 1.08 | 1.22 | 13/16           |
| 3/8          | 1/8                    | TF5405x6x2        | .297  | .188  | 1.06 | .81  | 5/8             |
| 3/8          | 1/4                    | TF5405x6          | .297  | .281  | 1.06 | 1.09 | 5/8             |
| 3/8          | 3/8                    | TF5405x6x6        | .297  | .406  | 1.16 | 1.22 | 13/16           |
| 3/8          | 1/2                    | TF5405x6x8        | .297  | .531  | 1.22 | 1.47 | 15/16           |
| 3/8          | 3/4                    | TF5405x6x12       | .297  | .719  | 1.31 | 1.59 | 1-1/8           |
| 1/2          | 1/4                    | TF5405x8x4        | .391  | .281  | 1.25 | 1.19 | 13/16           |
| 1/2          | 3/8                    | TF5405x8          | .391  | .406  | 1.25 | 1.22 | 13/16           |
| 1/2          | 1/2                    | TF5405x8x8        | .391  | .531  | 1.31 | 1.47 | 15/16           |
| 1/2          | 3/4                    | TF5405x8x12       | .391  | .719  | 1.41 | 1.59 | 1-1/8           |
| 5/8          | 3/8                    | TF5405x10x6       | .484  | .406  | 1.45 | 1.28 | 15/16           |
| 5/8          | 1/2                    | TF5405x10         | .484  | .531  | 1.45 | 1.47 | 15/16           |
| 5/8          | 3/4                    | TF5405x10x12      | .484  | .719  | 1.55 | 1.59 | 1-1/8           |
| 3/4          | 1/2                    | TF5405x12x8       | .609  | .531  | 1.66 | 1.56 | 1-1/8           |
| 3/4          | 3/4                    | TF5405x12         | .609  | .719  | 1.66 | 1.59 | 1-1/8           |
| 3/4          | 1                      | TF5405x12x16      | .609  | .938  | 1.78 | 1.97 | 1-3/8           |
| 7/8          | 3/4                    | TF5405x14         | .718  | .719  | 1.73 | 1.69 | 1-1/4           |
| 1            | 3/4                    | TF5405x16x12      | .844  | .719  | 1.81 | 1.72 | 1-3/8           |
| 1            | 1                      | TF5405x16         | .844  | .938  | 1.81 | 1.97 | 1-3/8           |
| 1            | 1-1/4                  | TF5405x16x20      | .844  | 1.250 | 2.00 | 2.37 | 1-3/4           |
| 1-1/4        | 1                      | TF5405x20x16      | 1.078 | .938  | 2.06 | 2.16 | 1-3/4           |
| 1-1/4        | 1-1/4                  | TF5405x20         | 1.078 | 1.250 | 2.06 | 2.37 | 1-3/4           |
| 1-1/4        | 1-1/2                  | TF5405x20x24      | 1.078 | 1.500 | 2.19 | 2.64 | 2               |
| 1-1/2        | 1-1/4                  | TF5405x24x20      | 1.312 | 1.250 | 2.33 | 2.50 | 2               |
| 1-1/2        | 1-1/2                  | TF5405x24         | 1.312 | 1.500 | 2.33 | 2.64 | 2               |
| 2            | 2                      | TF5405x32         | 1.781 | 1.938 | 3.06 | 3.00 | 2-5/8           |

\*Special Order Only

\* Available in stainless steel.

Γ mm-16

**90° Male Elbow Long**

(Ref. SAE No. 071502)

Example assembly No. C35425x4

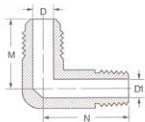
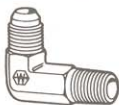

\*Special Order Only.

| Tube<br>O.D. | Male<br>Pipe<br>Thread | Catalog<br>Number | D     | D1    | M    | N    | Across<br>Flats |
|--------------|------------------------|-------------------|-------|-------|------|------|-----------------|
| 1/4          | 1/4                    | C5425x4x4*        | .172  | .281  | 1.05 | 1.58 | 9/16            |
| 3/8          | 1/4                    | C5425x6           | .297  | .281  | 1.06 | 1.58 | 9/16            |
| 1/2          | 3/8                    | C5425x8*          | .391  | .406  | 1.25 | 1.82 | 3/4             |
| 3/4          | 3/4                    | C5425x12          | .609  | .719  | 1.66 | 2.44 | 1-1/16          |
| 1/4          | 1/8                    | TF5425x4          | .172  | .188  | .89  | 1.17 | 1/2             |
| 1/4          | 1/4                    | TF5425x4x4        | .172  | .281  | .95  | 1.58 | 5/8             |
| 5/16         | 1/4                    | TF5425x5x4        | .234  | .281  | .95  | 1.55 | 9/16            |
| 3/8          | 1/4                    | TF5425x6          | .297  | .281  | 1.06 | 1.58 | 5/8             |
| 3/8          | 3/8                    | TF5425x6x6        | .297  | .406  | 1.16 | 1.83 | 13/16           |
| 1/2          | 3/8                    | TF5425x8          | .391  | .406  | 1.25 | 1.83 | 13/16           |
| 1/2          | 1/2                    | TF5425x8x8        | .391  | .531  | 1.31 | 2.17 | 15/16           |
| 1/2          | 3/4                    | TF5425x8x12       | .391  | .719  | 1.41 | 2.44 | 1-1/8           |
| 5/8          | 1/2                    | TF5425x10         | .484  | .531  | 1.45 | 2.17 | 15/16           |
| 3/4          | 3/4                    | TF5425x12         | .609  | .719  | 1.66 | 2.44 | 1-1/8           |
| 7/8          | 3/4                    | TF5425x14         | .718  | .719  | 1.73 | 2.66 | 1-1/4           |
| 1            | 1                      | TF5425x16         | .844  | .938  | 1.81 | 3.02 | 1-3/8           |
| 1-1/4        | 1-1/4                  | TF5425x20         | 1.078 | 1.250 | 2.06 | 3.69 | 1-3/4           |
| 1-1/2        | 1-1/2                  | TF5425x24         | 1.312 | 1.500 | 2.32 | 4.11 | 2               |

**90° Male Elbow Extra Long**

(Ref. SAE No. 071602)

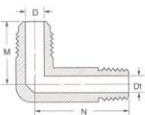
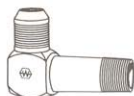

| Tube<br>O.D. | Male<br>Pipe<br>Thread | Catalog<br>Number | D     | D1    | M    | N    | Across<br>Flats |
|--------------|------------------------|-------------------|-------|-------|------|------|-----------------|
| 1/4          | 1/8                    | TF5435x4          | .172  | .188  | .89  | 1.56 | 1/2             |
| 1/4          | 1/4                    | TF5435x4x4        | .172  | .281  | .95  | 2.07 | 5/8             |
| 5/16         | 1/8                    | TF5435x5          | .234  | .188  | .95  | 1.62 | 9/16            |
| 5/16         | 1/4                    | TF5435x5x4        | .234  | .281  | .95  | 2.04 | 9/16            |
| 3/8          | 1/4                    | TF5435x6          | .297  | .281  | 1.06 | 2.08 | 5/8             |
| 3/8          | 3/8                    | TF5435x6x6        | .297  | .406  | 1.06 | 2.42 | 13/16           |
| 1/2          | 3/8                    | TF5435x8          | .391  | .406  | 1.25 | 2.42 | 13/16           |
| 1/2          | 1/2                    | TF5435x8x8        | .391  | .531  | 1.31 | 2.88 | 15/16           |
| 5/8          | 1/2                    | TF5435x10         | .484  | .531  | 1.45 | 2.88 | 15/16           |
| 3/4          | 3/4                    | TF5435x12         | .609  | .719  | 1.66 | 3.28 | 1-1/8           |
| 7/8          | 3/4                    | TF5435x14         | .718  | .719  | 1.73 | 3.62 | 1-1/4           |
| 1            | 1                      | TF5435x16         | .844  | .938  | 1.81 | 4.05 | 1-3/8           |
| 1-1/4        | 1-1/4                  | TF5435x20         | 1.078 | 1.250 | 2.06 | 5.00 | 1-3/4           |

**90° Bulkhead Union Elbow**

Stainless Steel No. 5537x

(Ref. SAE No. 070701)

Example assembly No. C35525x4

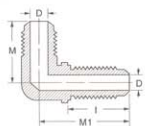
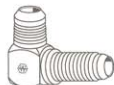

\*Special Order Only.

For Bulkhead nut see page 167. Included with assembly.

| Tube<br>O.D. | Catalog<br>Number | D     | I    | M    | M1   | Across<br>Flats |
|--------------|-------------------|-------|------|------|------|-----------------|
| 1/4          | C5525x4*          | .172  | 1.11 | .97  | 1.59 | 7/16            |
| 5/16         | C5525x5*          | .234  | 1.11 | 1.03 | 1.62 | 9/16            |
| 3/8          | C5525x6*          | .297  | 1.18 | 1.09 | 1.81 | 9/16            |
| 1/2          | C5525x8           | .391  | 1.38 | 1.36 | 2.11 | 3/4             |
| 5/8          | C5525x10*         | .484  | 1.52 | 1.56 | 2.39 | 7/8             |
| 3/4          | C5525x12*         | .609  | 1.69 | 1.78 | 2.67 | 1-1/16          |
| 1            | C5525x16          | .844  | 1.69 | 1.94 | 2.80 | 1-5/16          |
| 1-1/4        | C5525x20          | 1.078 | 1.74 | 2.17 | 3.12 | 1-5/8           |
| 1/4          | TF5525x4          | .172  | 1.11 | .97  | 1.59 | 1/2             |
| 5/16         | TF5525x5          | .234  | 1.11 | 1.03 | 1.62 | 9/16            |
| 3/8          | TF5525x6          | .297  | 1.18 | 1.09 | 1.81 | 5/8             |
| 1/2          | TF5525x8          | .391  | 1.38 | 1.36 | 2.11 | 13/16           |
| 5/8          | TF5525x10         | .484  | 1.52 | 1.56 | 2.39 | 15/16           |
| 3/4          | TF5525x12         | .609  | 1.69 | 1.78 | 2.67 | 1-1/8           |
| 1            | TF5525x16         | .844  | 1.69 | 1.94 | 2.80 | 1-3/8           |



### 90° Female Elbow

Stainless Steel No. 5467x

(Ref. SAE No. 070203)

Example assembly No. C35455x4

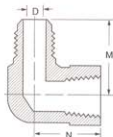

\*Special Order Only.

| Tube O.D. | Fem. Pipe Thread | Catalog Number | D     | M    | N    | Across Flats |
|-----------|------------------|----------------|-------|------|------|--------------|
| 1/4       | 1/8              | C5455x4*       | .172  | 1.08 | .66  | 9/16         |
| 1/4       | 1/4              | C5455x4x4*     | .172  | 1.22 | .88  | 3/4          |
| 5/16      | 1/8              | C5455x5*       | .234  | 1.08 | .66  | 9/16         |
| 3/8       | 1/8              | C5455x6x2      | .297  | 1.06 | .66  | 9/16         |
| 3/8       | 1/4              | C5455x6*       | .297  | 1.23 | .88  | 3/4          |
| 3/8       | 3/8              | C5455x6x6*     | .297  | 1.31 | 1.02 | 7/8          |
| 1/2       | 1/4              | C5455x8x4      | .391  | 1.23 | .88  | 3/4          |
| 1/2       | 3/8              | C5455x8*       | .391  | 1.42 | 1.02 | 7/8          |
| 1/2       | 1/2              | C5455x8x8*     | .391  | 1.52 | 1.23 | 1-1/16       |
| 5/8       | 1/2              | C5455x10       | .484  | 1.64 | 1.23 | 1-1/16       |
| 3/4       | 1/2              | C5455x12x8     | .609  | 1.66 | 1.23 | 1-1/16       |
| 3/4       | 3/4              | C5455x12*      | .609  | 1.89 | 1.36 | 1-5/16       |
| 7/8       | 3/4              | C5455x14       | .718  | 1.86 | 1.42 | 1-5/16       |
| 1         | 1                | C5455x16*      | .844  | 2.17 | 1.62 | 1-5/8        |
| 1-1/4     | 1-1/4            | C5455x20*      | 1.078 | 2.33 | 1.70 | 1-7/8        |
| 1/4       | 1/8              | TF5455x4       | .172  | 1.08 | .66  | 5/8          |
| 1/4       | 1/4              | TF5455x4x4     | .172  | 1.14 | .88  | 3/4          |
| 5/16      | 1/8              | TF5455x5       | .234  | 1.08 | .66  | 5/8          |
| 5/16      | 1/4              | TF5455x5x4     | .234  | 1.30 | 1.02 | 7/8          |
| 3/8       | 1/4              | TF5455x6       | .297  | 1.23 | .88  | 3/4          |
| 3/8       | 3/8              | TF5455x6x6     | .297  | 1.14 | .88  | 3/4          |
| 1/2       | 3/8              | TF5455x8       | .391  | 1.42 | 1.02 | 7/8          |
| 1/2       | 1/2              | TF5455x8x8     | .391  | 1.55 | 1.23 | 1-1/8        |
| 5/8       | 1/2              | TF5455x10      | .484  | 1.64 | 1.23 | 1-1/8        |
| 3/4       | 3/4              | TF5455x12      | .609  | 1.89 | 1.36 | 1-3/8        |
| 7/8       | 3/4              | TF5455x14      | .718  | 1.86 | 1.42 | 1-3/8        |
| 1         | 1                | TF5455x16      | .814  | 2.17 | 1.62 | 1-5/8        |
| 1-1/4     | 1-1/4            | TF5455x20      | 1.078 | 2.33 | 1.70 | 2            |
| 1-1/2     | 1-1/2            | TF5455x24      | 1.312 | 2.89 | 2.08 | 2-3/8        |
| 2         | 2                | TF5455x32      | 1.781 | 3.30 | 2.39 | 2-7/8        |

### 90° Elbow - Swivel Nut

Stainless Steel No. 5518x

(Ref. SAE No. 070221)

Example assembly No. C35506x4

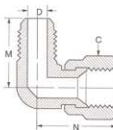

\*Special Order Only.

| Tube O.D. | Catalog Number | Hex C | D     | M    | N    | Across Flats |
|-----------|----------------|-------|-------|------|------|--------------|
| 1/4       | C5506x4*       | 9/16  | .172  | .89  | 1.00 | 7/16         |
| 5/16      | C5506x5        | 5/8   | .234  | .95  | 1.06 | 9/16         |
| 3/8       | C5506x6        | 11/16 | .297  | 1.06 | 1.25 | 9/16         |
| 1/2       | C5506x8*       | 7/8   | .391  | 1.25 | 1.42 | 3/4          |
| 5/8       | C5506x10       | 1     | .484  | 1.43 | 1.62 | 7/8          |
| 3/4       | C5506x12*      | 1-1/4 | .609  | 1.66 | 1.75 | 1-1/16       |
| 7/8       | C5506x14*      | 1-3/8 | .718  | 1.73 | 1.72 | 1-5/16       |
| 1         | C5506x16*      | 1-1/2 | .844  | 1.81 | 2.00 | 1-5/16       |
| 1-1/4     | C5506x20       | 2     | 1.078 | 2.06 | 2.31 | 1-5/8        |
| 1/4       | TF5506x4       | 9/16  | .172  | .89  | 1.00 | 1/2          |
| 5/16      | TF5506x5       | 5/8   | .234  | .95  | 1.06 | 9/16         |
| 3/8       | TF5506x6       | 11/16 | .297  | 1.06 | 1.25 | 5/8          |
| 1/2       | TF5506x8       | 7/8   | .391  | 1.25 | 1.38 | 13/16        |
| 5/8       | TF5506x10      | 1     | .484  | 1.45 | 1.62 | 15/16        |
| 3/4       | TF5506x12      | 1-1/4 | .609  | 1.66 | 1.75 | 1-1/8        |
| 7/8       | TF5506x14      | 1-3/8 | .718  | 1.73 | 1.78 | 1-1/4        |
| 1         | TF5506x16      | 1-1/2 | .844  | 1.81 | 2.00 | 1-3/8        |
| 1-1/4     | TF5506x20      | 2     | 1.078 | 2.06 | 2.31 | 1-3/4        |
| 1-1/2     | TF5506x24      | 2-1/4 | 1.312 | 2.33 | 2.59 | 2            |
| 2         | TF5506x32      | 2-7/8 | 1.781 | 3.06 | 3.38 | 2-5/8        |

\* Available in stainless steel.

## 90° Male Pipe to 37° JIC Swivel

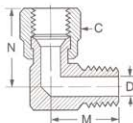

| Tube O.D. | Male Pipe | Catalog Number | D     | M    | N    | Across Flats | Hex C |
|-----------|-----------|----------------|-------|------|------|--------------|-------|
| 1/4       | 1/8       | TF5406x4       | .188  | .78  | 1.00 | 1/2          | 9/16  |
| 3/8       | 1/4       | TF5406x6       | .281  | 1.09 | 1.25 | 5/8          | 11/16 |
| 1/2       | 3/8       | TF5406x8       | .406  | 1.22 | 1.38 | 13/16        | 7/8   |
| 5/8       | 1/2       | TF5406x10      | .531  | 1.47 | 1.62 | 15/16        | 1     |
| 3/4       | 3/4       | TF5406x12      | .719  | 1.59 | 1.75 | 1-1/8        | 1-1/4 |
| 1         | 1         | TF5406x16      | .938  | 1.97 | 2.00 | 1-3/8        | 1-1/2 |
| 1-1/4     | 1-1/4     | TF5406x20      | 1.250 | 2.38 | 2.31 | 1-3/4        | 2     |
| 1-1/2     | 1-1/2     | TF5406x24      | 1.500 | 2.64 | 2.59 | 2            | 2-1/4 |
| 2         | 2         | TF5406x32      | 1.938 | 3.00 | 3.38 | 2-5/8        | 2-7/8 |

## 90° Elbow - Straight Thread O-Ring

Stainless Steel No. 5527x

(Ref. SAE No. 070220)

Example assembly No. C35515x4

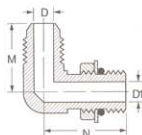

| Tube O.D. | Port Size | Catalog Number | D     | D1    | M    | N    | Across Flats |
|-----------|-----------|----------------|-------|-------|------|------|--------------|
| 3/16      | 3/16      | C5515x3        | .125  | .125  | .83  | .94  | 7/16         |
| 1/4       | 1/4       | C5515x4        | .172  | .172  | .89  | 1.03 | 7/16         |
| 5/16      | 5/16      | C5515x5        | .234  | .234  | .95  | 1.13 | 9/16         |
| 3/8       | 3/8       | C5515x6        | .297  | .297  | 1.06 | 1.25 | 9/16         |
| 3/8       | 1/2       | C5515x6x8      | .297  | .391  | 1.14 | 1.45 | 3/4          |
| 1/2       | 3/8       | C5515x8x6      | .391  | .297  | 1.25 | 1.32 | 3/4          |
| 1/2       | 1/2       | C5515x8        | .391  | .391  | 1.25 | 1.45 | 3/4          |
| 1/2       | 5/8       | C5515x8x10     | .391  | .484  | 1.33 | 1.70 | 7/8          |
| 5/8       | 5/8       | C5515x10       | .484  | .484  | 1.45 | 1.70 | 7/8          |
| 3/4       | 5/8       | C5515x12x10    | .609  | .484  | 1.66 | 1.78 | 1-1/16       |
| 3/4       | 3/4       | C5515x12       | .609  | .609  | 1.66 | 1.94 | 1-1/16       |
| 7/8       | 7/8       | C5515x14       | .718  | .718  | 1.73 | 2.00 | 1-5/16       |
| 1         | 3/4       | C5515x16x12    | .844  | .609  | 1.81 | 2.05 | 1-5/16       |
| 1         | 1         | C5515x16       | .844  | .844  | 1.81 | 2.05 | 1-5/16       |
| 1-1/4     | 1-1/4     | C5515x20       | 1.078 | 1.078 | 2.06 | 2.25 | 1-5/8        |
| 1-1/2     | 1-1/2     | C5515x24       | 1.312 | 1.312 | 2.33 | 2.39 | 1-7/8        |
| 1/4       | 1/4       | TF5515x4       | .172  | .172  | .89  | 1.03 | 1/2          |
| 1/4       | 5/16      | TF5515x4x5     | .172  | .234  | .95  | 1.12 | 5/8          |
| 1/4       | 3/8       | TF5515x4x6     | .172  | .297  | .95  | 1.25 | 5/8          |
| 5/16      | 1/4       | TF5515x5x4     | .234  | .172  | .98  | 1.06 | 9/16         |
| 5/16      | 5/16      | TF5515x5       | .234  | .234  | .95  | 1.09 | 9/16         |
| 5/16      | 3/8       | TF5515x5x6     | .234  | .297  | .98  | 1.25 | 5/8          |
| 3/8       | 1/4       | TF5515x6x4     | .297  | .172  | 1.06 | 1.09 | 5/8          |
| 3/8       | 5/16      | TF5515x6x5     | .297  | .234  | 1.06 | 1.12 | 5/8          |
| 3/8       | 3/8       | TF5515x6       | .297  | .297  | 1.06 | 1.25 | 5/8          |
| 3/8       | 1/2       | TF5515x6x8     | .297  | .391  | 1.16 | 1.45 | 13/16        |
| 3/8       | 5/8       | TF5515x6x10    | .297  | .484  | 1.22 | 1.70 | 15/16        |
| 1/2       | 3/8       | TF5515x8x6     | .391  | .297  | 1.25 | 1.34 | 13/16        |
| 1/2       | 1/2       | TF5515x8       | .391  | .391  | 1.25 | 1.45 | 13/16        |
| 1/2       | 5/8       | TF5515x8x10    | .391  | .484  | 1.31 | 1.70 | 15/16        |
| 1/2       | 3/4       | TF5515x8x12    | .391  | .609  | 1.41 | 1.94 | 1-1/8        |
| 5/8       | 1/2       | TF5515x10x8    | .484  | .391  | 1.45 | 1.52 | 15/16        |
| 5/8       | 5/8       | TF5515x10      | .484  | .484  | 1.45 | 1.70 | 15/16        |
| 5/8       | 3/4       | TF5515x10x12   | .484  | .609  | 1.55 | 1.94 | 1-1/8        |
| 3/4       | 1/2       | TF5515x12x8    | .609  | .391  | 1.66 | 1.61 | 1-1/8        |
| 3/4       | 5/8       | TF5515x12x10   | .609  | .484  | 1.66 | 1.80 | 1-1/8        |
| 3/4       | 3/4       | TF5515x12      | .609  | .609  | 1.66 | 1.94 | 1-1/8        |
| 3/4       | 7/8       | TF5515x12x14   | .609  | .718  | 1.72 | 2.00 | 1-1/4        |
| 3/4       | 1         | TF5515x12x16   | .609  | .844  | 1.78 | 2.05 | 1-3/8        |
| 7/8       | 7/8       | TF5515x14      | .718  | .718  | 1.73 | 2.00 | 1-5/16       |
| 1         | 3/4       | TF5515x16x12   | .844  | .609  | 1.81 | 2.06 | 1-3/8        |
| 1         | 7/8       | TF5515x16x14   | .844  | .718  | 1.81 | 2.06 | 1-3/8        |
| 1         | 1         | TF5515x16      | .844  | .844  | 1.81 | 2.05 | 1-3/8        |
| 1         | 1-1/4     | TF5515x16x20   | .844  | 1.078 | 2.00 | 2.25 | 1-3/4        |
| 1-1/4     | 1         | TF5515x20x16   | 1.078 | .844  | 2.06 | 2.23 | 1-3/4        |
| 1-1/4     | 1-1/4     | TF5515x20      | 1.078 | 1.078 | 2.06 | 2.25 | 1-3/4        |
| 1-1/2     | 1-1/4     | TF5515x24x20   | 1.312 | 1.078 | 2.33 | 2.37 | 2            |
| 1-1/2     | 1-1/2     | TF5515x24      | 1.312 | 1.312 | 2.33 | 2.39 | 2            |
| 2         | 2         | TF5515x32      | 1.781 | 1.781 | 3.06 | 2.89 | 2-5/8        |

Replacement O-rings page 183.

\* Available in stainless steel.

### 90° Elbow Long - Straight Thread O-Ring (Ref. SAE No. 071520)

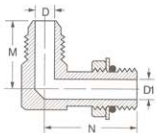

Replacement O-rings page 183.

| Tube O.D. | Port Size | Catalog Number | D    | D1   | M    | N    | Across Flats |
|-----------|-----------|----------------|------|------|------|------|--------------|
| 3/8       | 3/8       | TF5515x6L      | .297 | .297 | 1.06 | 1.66 | 5/8          |
| 1/2       | 1/2       | TF5515x8L      | .391 | .391 | 1.25 | 1.81 | 13/16        |
| 5/8       | 5/8       | TF5515x10L     | .484 | .484 | 1.45 | 2.16 | 15/16        |
| 3/4       | 3/4       | TF5515x12L     | .609 | .609 | 1.66 | 2.47 | 1-1/8        |

### 90° Elbow Extra Long - Straight Thread O-Ring (Ref. SAE No. 071620)

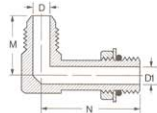
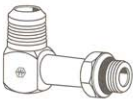

Replacement O-rings page 183.

| Tube O.D. | Port Size | Catalog Number | D    | D1   | M    | N    | Across Flats |
|-----------|-----------|----------------|------|------|------|------|--------------|
| 3/8       | 3/8       | TF5515x6LL     | .297 | .297 | 1.06 | 2.08 | 5/8          |
| 1/2       | 1/2       | TF5515x8LL     | .391 | .391 | 1.25 | 2.50 | 13/16        |
| 5/8       | 5/8       | TF5515x10LL    | .484 | .484 | 1.45 | 3.25 | 15/16        |
| 3/4       | 3/4       | TF5515x12LL    | .609 | .609 | 1.66 | 3.34 | 1-1/8        |

### Union Tee Stainless Steel No. 5717x (Ref. SAE No. 070401) Assembly No. C35705x4

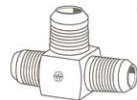
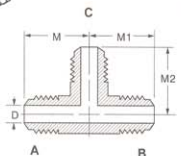
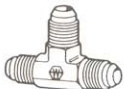

| Tube O.D. A | Tube O.D. B | Tube O.D. C | Catalog Number | D     | M    | M1   | M2   | Across Flats |
|-------------|-------------|-------------|----------------|-------|------|------|------|--------------|
| 1/8         | 1/8         | 1/8         | C5705x2        | .062  | .77  | .77  | .77  | 7/16         |
| 3/16        | 3/16        | 3/16        | C5705x3        | .125  | .83  | .83  | .83  | 7/16         |
| 1/4         | 1/4         | 1/4         | C5705x4        | .172  | .89  | .89  | .89  | 7/16         |
| 5/16        | 5/16        | 5/16        | C5705x5        | .234  | .95  | .95  | .95  | 9/16         |
| 3/8         | 3/8         | 3/8         | C5705x6        | .297  | 1.06 | 1.06 | 1.06 | 9/16         |
| 1/2         | 1/2         | 1/2         | C5705x8        | .391  | 1.25 | 1.25 | 1.25 | 3/4          |
| 5/8         | 5/8         | 5/8         | C5705x10       | .484  | 1.45 | 1.45 | 1.45 | 7/8          |
| 3/4         | 3/4         | 3/4         | C5705x12       | .609  | 1.66 | 1.66 | 1.66 | 1-1/16       |
| 7/8         | 7/8         | 7/8         | C5705x14       | .718  | 1.73 | 1.73 | 1.73 | 1-5/16       |
| 1           | 1           | 1           | C5705x16       | .844  | 1.81 | 1.81 | 1.81 | 1-5/16       |
| 1-1/4       | 1-1/4       | 1-1/4       | C5705x20       | 1.078 | 2.06 | 2.06 | 2.06 | 1-5/8        |
| 1-1/2       | 1-1/2       | 1-1/2       | C5705x24       | 1.312 | 2.33 | 2.33 | 2.33 | 1-7/8        |
| 1/4         | 1/4         | 1/4         | TF5705x4       | .172  | .89  | .89  | .89  | 1/2          |
| 5/16        | 5/16        | 5/16        | TF5705x5       | .234  | .95  | .95  | .95  | 1/2          |
| 3/8         | 3/8         | 3/8         | TF5705x6       | .297  | 1.06 | 1.06 | 1.06 | 5/8          |
| 1/2         | 1/2         | 1/2         | TF5705x8       | .391  | 1.25 | 1.25 | 1.25 | 13/16        |
| 5/8         | 1/2         | 1/2         | TF5705x10x8x8  | .484  | 1.45 | 1.31 | 1.31 | 15/16        |
| 5/8         | 5/8         | 5/8         | TF5705x10      | .484  | 1.45 | 1.45 | 1.45 | 15/16        |
| 5/8         | 5/8         | 1/2         | TF5705x10x10x8 | .484  | 1.45 | 1.45 | 1.31 | 15/16        |
| 3/4         | 3/4         | 3/4         | TF5705x12      | .609  | 1.66 | 1.66 | 1.66 | 1-1/8        |
| 7/8         | 7/8         | 7/8         | TF5705x14      | .718  | 1.73 | 1.73 | 1.73 | 1-1/4        |
| 1           | 1           | 1           | TF5705x16      | .844  | 1.81 | 1.81 | 1.81 | 1-3/8        |
| 1-1/4       | 1-1/4       | 1-1/4       | TF5705x20      | 1.078 | 2.06 | 2.06 | 2.06 | 1-3/4        |
| 1-1/2       | 1-1/2       | 1-1/2       | TF5705x24      | 1.312 | 2.33 | 2.33 | 2.33 | 1-7/8        |
| 2           | 2           | 2           | TF5705x32      | 1.781 | 3.06 | 3.06 | 3.06 | 2-5/8        |

\*Special Order Only.

\* Available in stainless steel.

**Male Run Tee**

 Stainless Steel No. **5767x**

(Ref. SAE No. 070424)

Example assembly No. C35755x4

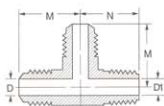

\*Special Order Only

| Tube<br>O.D. | Male Pipe<br>Thread | Catalog<br>Number | D     | D1    | M    | N    | Across<br>Flats |
|--------------|---------------------|-------------------|-------|-------|------|------|-----------------|
| 1/4          | 1/8                 | C5755x4*          | .172  | .188  | .89  | .78  | 7/16            |
| 1/4          | 1/4                 | C5755x4x4x4*      | .172  | .281  | 1.05 | 1.09 | 9/16            |
| 1/2          | 3/8                 | C5755x8*          | .391  | .406  | 1.25 | 1.22 | 3/4             |
| 1/2          | 1/2                 | C5755x8x8x8*      | .391  | .531  | 1.33 | 1.47 | 7/8             |
| 5/8          | 1/2                 | C5755x10          | .484  | .531  | 1.45 | 1.47 | 7/8             |
| 3/4          | 3/4                 | C5755x12          | .609  | .719  | 1.66 | 1.59 | 1-1/16          |
| 1            | 1                   | C5755x16          | .844  | .938  | 1.81 | 1.97 | 1-5/16          |
| 1/4          | 1/8                 | TF5755x4          | .172  | .188  | .89  | .78  | 1/2             |
| 1/4          | 1/4                 | TF5755x4x4x4      | .172  | .281  | .95  | 1.09 | 9/16            |
| 5/16         | 1/8                 | TF5755x5          | .234  | .188  | .95  | .78  | 1/2             |
| 3/8          | 1/4                 | TF5755x6          | .297  | .281  | 1.06 | 1.09 | 9/16            |
| 3/8          | 3/8                 | TF5755x6x6x6      | .297  | .406  | 1.16 | 1.22 | 9/16            |
| 1/2          | 3/8                 | TF5755x8          | .391  | .406  | 1.25 | 1.22 | 13/16           |
| 1/2          | 1/2                 | TF5755x8x8x8      | .391  | .531  | 1.31 | 1.47 | 7/8             |
| 5/8          | 1/2                 | TF5755x10         | .484  | .531  | 1.45 | 1.47 | 15/16           |
| 3/4          | 3/4                 | TF5755x12         | .609  | .719  | 1.66 | 1.59 | 1-1/8           |
| 7/8          | 3/4                 | TF5755x14         | .718  | .719  | 1.73 | 1.69 | 1-1/4           |
| 1            | 1                   | TF5755x16         | .844  | .938  | 1.81 | 1.97 | 1-3/8           |
| 1-1/4        | 1-1/4               | TF5755x20         | 1.078 | 1.250 | 2.06 | 2.38 | 1-3/4           |
| 1-1/2        | 1-1/2               | TF5755x24         | 1.312 | 1.500 | 2.33 | 2.64 | 2               |
| 2            | 2                   | TF5755x32         | 1.781 | 1.938 | 3.06 | 3.00 | 2-5/8           |

**Female Run Tee**

(Ref. SAE No. 070426)

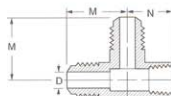

| Tube<br>O.D. | Fem. Pipe<br>Thread | Catalog<br>Number | D    | M    | N    | Across<br>Flats |
|--------------|---------------------|-------------------|------|------|------|-----------------|
| 1/4          | 1/8                 | TF5805x4          | .172 | 1.08 | .66  | 5/8             |
| 3/8          | 1/4                 | TF5805x6          | .297 | 1.23 | .88  | 3/4             |
| 1/2          | 3/8                 | TF5805x8          | .391 | 1.42 | 1.02 | 7/8             |
| 5/8          | 1/2                 | TF5805x10         | .484 | 1.64 | 1.23 | 1-1/8           |
| 3/4          | 3/4                 | TF5805x12         | .609 | 1.89 | 1.36 | 1-3/8           |
| 7/8          | 3/4                 | TF5805x14         | .718 | 1.86 | 1.42 | 1-3/8           |
| 1            | 1                   | TF5805x16         | .844 | 2.17 | 1.62 | 1-5/8           |

**Swivel Nut Run Tee**

 Stainless Steel No. **5718x**

(Ref. SAE No. 070432)

Example assembly No. C35706x4

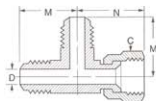
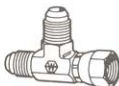

| Tube<br>O.D. | Catalog<br>Number | Hex<br>C | D     | M    | N    | Across<br>Flats |
|--------------|-------------------|----------|-------|------|------|-----------------|
| 1/4          | C5706x4*          | 9/16     | .172  | .89  | 1.00 | 7/16            |
| 5/16         | C5706x5           | 5/8      | .234  | .95  | 1.06 | 9/16            |
| 3/8          | C5706x6*          | 11/16    | .297  | 1.06 | 1.25 | 9/16            |
| 1/2          | C5706x8*          | 7/8      | .391  | 1.25 | 1.44 | 3/4             |
| 5/8          | C5706x10          | 1        | .484  | 1.45 | 1.62 | 7/8             |
| 3/4          | C5706x12*         | 1-1/4    | .609  | 1.66 | 1.75 | 1-1/16          |
| 1            | C5706x16          | 1-1/2    | .844  | 1.81 | 2.00 | 1-5/16          |
| 1-1/4        | C5706x20          | 2        | 1.078 | 2.06 | 2.36 | 1-5/8           |
| 1/4          | TF5706x4          | 9/16     | .172  | .89  | 1.00 | 1/2             |
| 5/16         | TF5706x5          | 5/8      | .234  | .95  | 1.06 | 9/16            |
| 3/8          | TF5706x6          | 11/16    | .297  | 1.06 | 1.25 | 5/8             |
| 1/2          | TF5706x8          | 7/8      | .391  | 1.25 | 1.38 | 13/16           |
| 5/8          | TF5706x10         | 1        | .484  | 1.45 | 1.62 | 15/16           |
| 3/4          | TF5706x12         | 1-1/4    | .609  | 1.66 | 1.75 | 1-1/8           |
| 7/8          | TF5706x14         | 1-3/8    | .719  | 1.73 | 1.78 | 1-1/4           |
| 1            | TF5706x16         | 1-1/2    | .844  | 1.81 | 2.00 | 1-3/8           |
| 1-1/4        | TF5706x20         | 2        | 1.078 | 2.06 | 2.31 | 1-3/4           |
| 1-1/2        | TF5706x24         | 2-1/4    | 1.312 | 2.33 | 2.59 | 2               |
| 2            | TF5706x32         | 2-7/8    | 1.781 | 3.06 | 3.38 | 2-5/8           |

### Bulkhead Run Tee

(Ref. SAE No. 070958)

Example assembly No. C35726x6

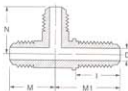
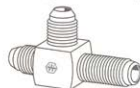

For Bulkhead nut see page 167.  
Included with assembly.

| Tube O.D. | Catalog Number | D    | I    | N    | M    | M1   | Across Flats |
|-----------|----------------|------|------|------|------|------|--------------|
| 3/8       | C5726x6        | .297 | 1.18 | 1.09 | 1.06 | 1.81 | 9/16         |
| 1/2       | TF5726x8       | .391 | 1.38 | 1.36 | 1.36 | 2.11 | 3/4          |

### Straight Thread O-Ring Run Tee

(Ref. SAE No. 070428)

Example assembly No. C35716x4

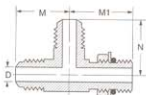
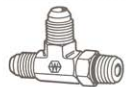

Replacement O-rings page 183.

| Tube O.D. | Port Size | Catalog Number | D     | M    | M1   | Across Flats | N    |
|-----------|-----------|----------------|-------|------|------|--------------|------|
| 1/4       | 1/4       | C5716x4        | .172  | .89  | 1.03 | 7/16         | .89  |
| 5/16      | 5/16      | C5716x5        | .234  | .95  | 1.09 | 9/16         | .95  |
| 3/8       | 3/8       | C5716x6        | .297  | 1.06 | 1.25 | 9/16         | 1.06 |
| 1/2       | 1/2       | C5716x8        | .391  | 1.25 | 1.45 | 3/4          | 1.25 |
| 5/8       | 5/8       | C5716x10       | .484  | 1.45 | 1.70 | 7/8          | 1.45 |
| 3/4       | 3/4       | C5716x12       | .609  | 1.66 | 1.94 | 1-1/16       | 1.66 |
| 1         | 1         | C5716x16       | .844  | 1.81 | 2.05 | 1-5/16       | 1.81 |
| 1-1/4     | 1-1/4     | C5716x20       | 1.078 | 2.06 | 2.25 | 1-5/8        | 2.06 |
| 1/4       | 1/4       | TF5716x4       | .172  | .89  | 1.03 | 1/2          | .89  |
| 5/16      | 5/16      | TF5716x5       | .234  | .95  | 1.09 | 9/16         | .95  |
| 3/8       | 3/8       | TF5716x6       | .297  | 1.06 | 1.25 | 5/8          | 1.06 |
| 1/2       | 1/2       | TF5716x8       | .391  | 1.25 | 1.45 | 13/16        | 1.25 |
| 5/8       | 5/8       | TF5716x10      | .484  | 1.45 | 1.70 | 15/16        | 1.45 |
| 3/4       | 3/4       | TF5716x12      | .609  | 1.66 | 1.94 | 1-1/8        | 1.66 |
| 7/8       | 7/8       | TF5716x14      | .718  | 1.73 | 2.00 | 1-1/4        | 1.73 |
| 1         | 1         | TF5716x16      | .844  | 1.81 | 2.05 | 1-3/8        | 1.81 |
| 1-1/4     | 1-1/4     | TF5716x20      | 1.078 | 2.06 | 2.25 | 1-3/4        | 2.06 |
| 1-1/2     | 1-1/2     | TF5716x24      | 1.312 | 2.33 | 2.39 | 2            | 2.33 |

### Male Branch Tee

Stainless Steel No. 5617x

(Ref. SAE No. 070425)

Example assembly No. C35605x4

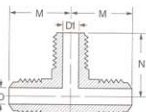

| Tube O.D. | Male Pipe Thread | Catalog Number | D     | D1    | M    | N    | Across Flats |
|-----------|------------------|----------------|-------|-------|------|------|--------------|
| 1/4       | 1/8              | C5605x4*       | .172  | .188  | .89  | .78  | 7/16         |
| 1/4       | 1/4              | C5605x4x4x4    | .172  | .281  | 1.05 | 1.09 | 9/16         |
| 5/16      | 1/8              | C5605x5        | .234  | .188  | .95  | .78  | 9/16         |
| 3/8       | 1/4              | C5605x6*       | .297  | .281  | 1.06 | 1.09 | 9/16         |
| 1/2       | 3/8              | C5605x8        | .391  | .406  | 1.25 | 1.22 | 3/4          |
| 5/8       | 1/2              | C5605x10       | .484  | .531  | 1.45 | 1.47 | 7/8          |
| 3/4       | 3/4              | C5605x12       | .609  | .719  | 1.66 | 1.59 | 1-1/16       |
| 7/8       | 3/4              | C5605x14*      | .718  | .719  | 1.73 | 1.69 | 1-5/16       |
| 1         | 1                | C5605x16       | .844  | .938  | 1.81 | 1.97 | 1-5/16       |
| 1-1/4     | 1-1/4            | C5605x20*      | 1.078 | 1.250 | 2.06 | 2.38 | 1-5/8        |
| 1/4       | 1/8              | TF5605x4       | .172  | .188  | .89  | .78  | 1/2          |
| 1/4       | 1/4              | TF5605x4x4x4   | .172  | .281  | .95  | 1.09 | 5/8          |
| 5/16      | 1/8              | TF5605x5       | .234  | .188  | .95  | .78  | 9/16         |
| 3/8       | 1/4              | TF5605x6       | .297  | .281  | 1.08 | 1.09 | 5/8          |
| 3/8       | 3/8              | TF5605x6x6x6   | .297  | .406  | 1.16 | 1.22 | 13/16        |
| 1/2       | 3/8              | TF5605x8       | .391  | .406  | 1.25 | 1.22 | 13/16        |
| 1/2       | 1/2              | TF5605x8x8x8   | .391  | .531  | 1.31 | 1.47 | 15/16        |
| 5/8       | 1/2              | TF5605x10      | .484  | .531  | 1.45 | 1.47 | 15/16        |
| 3/4       | 3/4              | TF5605x12      | .609  | .719  | 1.66 | 1.59 | 1-1/8        |
| 7/8       | 3/4              | TF5605x14      | .718  | .719  | 1.73 | 1.69 | 1-1/4        |
| 1         | 1                | TF5605x16      | .844  | .938  | 1.81 | 1.97 | 1-3/8        |
| 1-1/4     | 1-1/4            | TF5605x20      | 1.078 | 1.250 | 2.06 | 2.38 | 1-3/4        |
| 1-1/2     | 1-1/2            | TF5605x24      | 1.312 | 1.500 | 2.33 | 2.64 | 2            |
| 2         | 2                | TF5605x32      | 1.781 | 1.938 | 3.06 | 3.00 | 2-5/8        |

\*Special Order Only

\* Available in stainless steel.



## Female Branch Tee

Stainless Steel No. 5667x

(Ref. SAE No. 070427)

Example assembly No. C35655x4

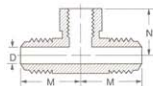

\*Special Order Only

| Tube<br>O.D. | Fem. Pipe<br>Thread | Catalog<br>Number | D     | M    | N    | Across<br>Flats |
|--------------|---------------------|-------------------|-------|------|------|-----------------|
| 1/4          | 1/8                 | C5655x4*          | .172  | 1.08 | .66  | 9/16            |
| 3/8          | 1/4                 | C5655x6*          | .297  | 1.23 | .88  | 3/4             |
| 1/2          | 3/8                 | C5655x8*          | .391  | 1.42 | 1.02 | 7/8             |
| 5/8          | 1/2                 | C5655x10          | .484  | 1.64 | 1.23 | 1-1/16          |
| 3/4          | 3/4                 | C5655x12          | .609  | 1.89 | 1.36 | 1-5/16          |
| 1            | 1                   | C5655x16*         | .844  | 2.17 | 1.62 | 1-5/8           |
| 1/4          | 1/8                 | TF5655x4          | .172  | 1.08 | .66  | 5/8             |
| 1/4          | 1/4                 | TF5655x4x4x4      | .172  | 1.14 | .88  | 3/4             |
| 5/16         | 1/8                 | TF5655x5          | .234  | 1.08 | .66  | 5/8             |
| 3/8          | 1/4                 | TF5655x6          | .297  | 1.23 | .88  | 3/4             |
| 3/8          | 3/8                 | TF5655x6x6x6      | .297  | 1.30 | 1.02 | 7/8             |
| 1/2          | 3/8                 | TF5655x8          | .391  | 1.42 | 1.02 | 7/8             |
| 1/2          | 1/2                 | TF5655x8x8x8      | .391  | 1.55 | 1.23 | 1-1/8           |
| 5/8          | 1/2                 | TF5655x10         | .484  | 1.64 | 1.23 | 1-1/8           |
| 3/4          | 3/4                 | TF5655x12         | .609  | 1.89 | 1.36 | 1-3/8           |
| 7/8          | 3/4                 | TF5655x14         | .718  | 1.86 | 1.42 | 1-3/8           |
| 1            | 1                   | TF5655x16         | .844  | 2.17 | 1.62 | 1-5/8           |
| 1-1/4        | 1-1/4               | TF5655x20         | 1.078 | 2.33 | 1.70 | 2               |
| 1-1/2        | 1-1/2               | TF5655x24         | 1.312 | 2.89 | 2.08 | 2-3/8           |
| 2            | 2                   | TF5655x32         | 1.781 | 3.30 | 2.39 | 2-7/8           |

## Swivel Nut Branch Tee

Stainless Steel No. 5719x

(Ref. SAE No. 070433)

Example assembly No. C35707x4

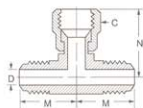

\*Special Order Only

| Tube<br>O.D. | Catalog<br>Number | Hex<br>C | D     | M    | N    | Across<br>Flats |
|--------------|-------------------|----------|-------|------|------|-----------------|
| 1/4          | C5707x4*          | 9/16     | .172  | .89  | 1.00 | 7/16            |
| 3/8          | C5707x6*          | 11/16    | .297  | 1.06 | 1.25 | 9/16            |
| 1/2          | C5707x8*          | 7/8      | .391  | 1.25 | 1.43 | 3/4             |
| 5/8          | C5707x10*         | 1        | .484  | 1.45 | 1.62 | 7/8             |
| 3/4          | C5707x12*         | 1-1/4    | .609  | 1.66 | 1.75 | 1-1/16          |
| 1            | C5707x16          | 1-1/2    | .844  | 1.81 | 2.00 | 1-5/16          |
| 1/4          | TF5707x4          | 9/16     | .172  | .89  | 1.00 | 7/16            |
| 5/16         | TF5707x5          | 5/8      | .234  | .95  | 1.06 | 9/16            |
| 3/8          | TF5707x6          | 11/16    | .297  | 1.06 | 1.25 | 5/8             |
| 1/2          | TF5707x8          | 7/8      | .391  | 1.25 | 1.38 | 13/16           |
| 5/8          | TF5707x10         | 1        | .484  | 1.45 | 1.62 | 7/8             |
| 3/4          | TF5707x12         | 1-1/4    | .609  | 1.66 | 1.75 | 1-1/8           |
| 7/8          | TF5707x14         | 1-3/8    | .719  | 1.73 | 1.78 | 1-1/4           |
| 1            | TF5707x16         | 1-1/2    | .844  | 1.81 | 2.00 | 1-3/8           |
| 1-1/4        | TF5707x20         | 2        | 1.078 | 2.06 | 2.31 | 2               |
| 1-1/2        | TF5707x24         | 2-1/4    | 1.312 | 2.33 | 2.59 | 2               |
| 2            | TF5707x32         | 2-7/8    | 1.781 | 3.06 | 3.38 | 2-5/8           |

## Bulkhead Union Tee

(Ref. SAE No. 070959)

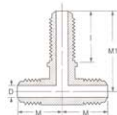
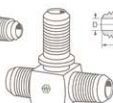
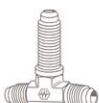

\*Stainless Steel Construction

For bulkhead nut see page 167. Included with assembly.

| Tube<br>O.D. | Catalog<br>Number | I    | D    | M    | M1   | Across<br>Flats |
|--------------|-------------------|------|------|------|------|-----------------|
| 1/4          | TF5725x4          | 1.11 | .172 | .97  | 1.59 | 1/2             |
| 3/8          | TF5725x6          | 1.18 | .297 | 1.06 | 1.81 | 5/8             |
| 1/2          | TF5725x8          | 1.38 | .391 | 1.36 | 2.11 | 13/16           |
| 5/8          | TF5725x10         | 1.52 | .484 | 1.56 | 2.39 | 15/16           |
| 3/4          | TF5725x12         | 1.69 | .609 | 1.78 | 2.67 | 1-1/8           |
| 1            | TF5725x16         | 1.69 | .844 | 1.94 | 2.80 | 1-3/8           |
| 1/4          | 5737x4#           | 1.11 | .172 | .97  | 1.59 | 7/16            |
| 3/8          | 5737x6#           | 1.18 | .297 | 1.09 | 1.81 | 9/16            |

### Straight Thread O-Ring Branch Tee

(Ref. SAE No. 070429)

Example assembly No. C35715x4

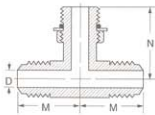

Replacement O-rings listed below.

\*Special Order Only.

| Tube O.D. | Port Size | Catalog Number | D     | M    | N    | Across Flats |
|-----------|-----------|----------------|-------|------|------|--------------|
| 1/4       | 1/4       | C5715x4        | .172  | .89  | 1.03 | 7/16         |
| 5/16      | 5/16      | C5715x5*       | .234  | .95  | 1.09 | 9/16         |
| 3/8       | 3/8       | C5715x6        | .297  | 1.06 | 1.25 | 9/16         |
| 1/2       | 1/2       | C5715x8        | .391  | 1.25 | 1.45 | 3/4          |
| 5/8       | 5/8       | C5715x10       | .484  | 1.45 | 1.70 | 7/8          |
| 3/4       | 3/4       | C5715x12       | .609  | 1.66 | 1.94 | 1-1/16       |
| 1         | 1         | C5715x16       | .844  | 1.81 | 2.05 | 1-5/16       |
| 1/4       | 1/4       | TF5715x4       | .172  | .89  | 1.03 | 7/16         |
| 5/16      | 5/16      | TF5715x5       | .234  | .95  | 1.09 | 9/16         |
| 3/8       | 3/8       | TF5715x6       | .297  | 1.06 | 1.25 | 5/8          |
| 1/2       | 1/2       | TF5715x8       | .391  | 1.25 | 1.45 | 3/4          |
| 5/8       | 5/8       | TF5715x10      | .484  | 1.45 | 1.70 | 15/16        |
| 3/4       | 3/4       | TF5715x12      | .609  | 1.66 | 1.94 | 1-1/8        |
| 7/8       | 7/8       | TF5715x14      | .719  | 1.73 | 2.00 | 1-1/4        |
| 1         | 1         | TF5715x16      | .844  | 1.81 | 2.05 | 1-3/8        |
| 1-1/4     | 1-1/4     | TF5715x20      | 1.078 | 2.06 | 2.25 | 1-3/4        |
| 1-1/2     | 1-1/2     | TF5715x24      | 1.312 | 2.33 | 2.39 | 2            |

### Cross

(Ref. SAE No. 070501)

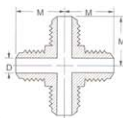

#Stainless Steel Construction

| Tube O.D. | Catalog Number | D     | M    | Across Flats |
|-----------|----------------|-------|------|--------------|
| 1/4       | TF5955x4       | .172  | .89  | 1/2          |
| 5/16      | TF5955x5       | .234  | .95  | 9/16         |
| 3/8       | TF5955x6       | .297  | 1.06 | 5/8          |
| 1/2       | TF5955x8       | .391  | 1.25 | 13/16        |
| 5/8       | TF5955x10      | .484  | 1.45 | 15/16        |
| 3/4       | TF5955x12      | .609  | 1.66 | 1-1/8        |
| 7/8       | TF5955x14      | .718  | 1.73 | 1-1/4        |
| 1         | TF5955x16      | .844  | 1.81 | 1-3/8        |
| 1-1/4     | TF5955x20      | 1.078 | 2.06 | 1-3/4        |
| 1-1/2     | TF5955x24      | 1.312 | 2.33 | 2            |
| 1/4       | 5967x4#        | .172  | .89  | 7/16         |
| 3/8       | 5967x6#        | .297  | 1.06 | 9/16         |
| 1/2       | 5967x8#        | .391  | 1.25 | 3/4          |

### Straight Thread O-Ring

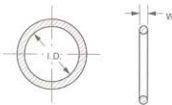

Material: Buna-N 90 Durometer

Temperature Range: -40°F to +250°F  
(-40°C to +121°C)

Standard O-ring complies with SAE specification SAE J515 Type CH.

| Tube O.D. | Catalog Number | W    | I.D.  |
|-----------|----------------|------|-------|
| 1/16      | 7629x1         | .058 | .185  |
| 1/8       | 7629x2         | .064 | .239  |
| 3/16      | 7629x3         | .064 | .301  |
| 1/4       | 7629x4         | .072 | .351  |
| 5/16      | 7629x5         | .072 | .414  |
| 3/8       | 7629x6         | .078 | .468  |
| 7/16      | 7629x7         | .082 | .530  |
| 1/2       | 7629x8         | .087 | .644  |
| 5/8       | 7629x10        | .097 | .755  |
| 3/4       | 7629x12        | .116 | .924  |
| 7/8       | 7629x14        | .116 | 1.048 |
| 1         | 7629x16        | .116 | 1.171 |
| 1-1/4     | 7629x20        | .118 | 1.475 |
| 1-1/2     | 7629x24        | .118 | 1.720 |
| 2         | 7629x32        | .118 | 2.337 |