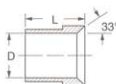
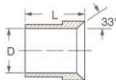

Sleeve 3 Piece
Stainless Steel No. 5177x
 (Ref. SAE No. 070115)

Tube O.D.	Catalog Number	D	L
1/8	C5165x2-	.130	.34
3/16	C5165x3-	.193	.34
1/4	C5165x4-	.255	.41
5/16	C5165x5-	.318	.44
3/8	C5165x6-	.380	.50
1/2	C5165x8-	.505	.56
5/8	C5165x10-	.631	.66
3/4	C5165x12-	.756	.68
7/8	C5165x14	.881	.76
1	C5165x16-	1.006	.78
1-1/4	C5165x20-	1.260	.91
1-1/2	C5165x24-	1.510	1.12
2	C5165x32-	2.014	1.19

Sleeve 3 Piece Metric
 (Ref. SAE No. 070115)

Adapts Standard SAE Flare-Twin® fittings for use with metric tubing.

Tube O.D. (Inch Size)	Tube O.D. (Metric Size)	Catalog Number	D	L
1/4	6MM	C5165x4x6MM	.241	.41
5/16	8MM	C5165x5x8MM	.320	.44
3/8	10MM	C5165x6x10MM	.399	.50
1/2	12MM	C5165x8x12MM	.478	.56
5/8	14MM	C5165x10x14MM	.556	.66
5/8	15MM	C5165x10x15MM	.596	.66
5/8	16MM	C5165x10x16MM	.636	.66
3/4	18MM	C5165x12x18MM	.717	.68
7/8	20MM	C5165x14x20MM	.793	.76
1	25MM	C5165x16x25MM	.990	.78
1-1/4	30MM	C5165x20x30MM	1.191	.91
1-1/4	32MM	C5165x20x32MM	1.270	.91
1-1/2	38MM	C5165x24x38MM	1.510	1.12

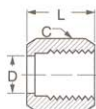
Nut 3 Piece
Stainless Steel No. 5117x
 (Ref. SAE No. 070110)

SAE style 'B'

Tube O.D.	Catalog Number	Hex C	D	L
1/8	C5105x2-	3/8	.181	.55
3/16	C5105x3-	7/16	.243	.61
1/4	C5105x4-	9/16	.306	.62
5/16	C5105x5-	5/8	.375	.68
3/8	C5105x6-	11/16	.441	.73
1/2	C5105x8-	7/8	.571	.85
5/8	C5105x10-	1	.698	.98
3/4	C5105x12-	1-1/4	.835	1.03
7/8	C5105x14	1-3/8	.961	1.09
1	C5105x16-	1-1/2	1.089	1.13
1-1/4	C5105x20-	2	1.347	1.23
1-1/2	C5105x24-	2-1/4	1.617	1.42
2	C5105x32-	2-7/8	2.167	1.75

2 Piece Nut (Short)

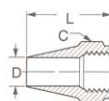

Tube O.D.	Catalog Number	Hex C	D	L
1/4	C5125x4	9/16	.255	.59
5/16	C5125x5	5/8	.318	.59
3/8	C5125x6	11/16	.380	.66
1/2	C5125x8	7/8	.505	.81
5/8	C5125x10	1	.631	.94
3/4	C5125x12	1-1/4	.756	1.14

2 Piece Nut
 (Ref. SAE No. 070111)

SAE style 'A'

Tube O.D.	Catalog Number	Hex C	D	L
1/4	C5115x4	9/16	.255	1.00
5/16	C5115x5	5/8	.318	1.06
3/8	C5115x6	11/16	.380	1.09
1/2	C5115x8	7/8	.505	1.28
5/8	C5115x10	1	.631	1.48
3/4	C5115x12	1-1/4	.756	1.66
7/8	C5115x14	1-3/8	.881	1.81
1	C5115x16	1-1/2	1.006	1.94
1-1/4	C5115x20	2	1.260	2.19
1-1/2	C5115x24	2-1/4	1.510	2.31

* Available in stainless steel.

 Refer to safety information regarding tubing selection on page 1.

- **Typical Application:** Pressure hydraulic systems.
- **Sealing Method:** Performed by an elastomeric O-ring.
- **NOTE:** For pressure, material and plating information, refer to appropriate steel fitting sections of this catalog:

Pipe - See page 141. For-Seal - See page 149. JIC 37° - See page 159.

Ermeto - See page 190. Swivel Adapters - See page 214.

Straight Thread O-Ring Hex Socket Plug (Ref. SAE No. 090109B)



Replacement O-rings page 194.
NOTE: Parts furnished with zinc plate.

Port Size	Catalog Number	Hex C	L
1/8	7238x2	1/8	.40
3/16	7238x3	1/8	.40
1/4	7238x4	3/16	.47
5/16	7238x5	3/16	.47
3/8	7238x6	1/4	.50
1/2	7238x8	5/16	.58
5/8	7238x10	3/8	.65
3/4	7238x12	9/16	.77
7/8	7238x14	9/16	.77
1	7238x16	5/8	.77
1-1/4	7238x20	3/4	.78

Straight Thread O-Ring Hex Head Plug (Ref. SAE No. 090109A)

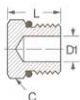

Replacement O-rings page 194.
NOTE: Parts furnished with zinc plate.

Port Size	Catalog Number	Hex C	L	D1 Opt.
1/8	7237x2	7/16	.60	.093
3/16	7237x3	1/2	.60	.125
1/4	7237x4	9/16	.67	.203
5/16	7237x5	5/8	.67	.234
3/8	7237x6	11/16	.73	.297
1/2	7237x8	7/8	.80	.422
5/8	7237x10	1	.93	.500
3/4	7237x12	1-1/4	1.09	.656
7/8	7237x14	1-3/8	1.09	.718
1	7237x16	1-1/2	1.12	.875
1-1/4	7237x20	1-7/8	1.20	1.093
1-1/2	7237x24	2-1/8	1.27	1.344
2	7237x32	2-3/4	1.42	1.815

Male Straight Thread/Female Straight Thread O-Ring Boss

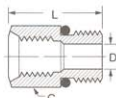

Replacement O-rings page 194.
NOTE: Parts furnished with zinc plate.

Male Port Size	Fem. Port Size	Catalog Number	Hex C	D	L
1/2	3/8	7033x8x6	7/8	.391	1.16
5/8	1/2	7033x10x8	1	.484	1.34
3/4	1/2	7033x12x8	1-1/4	.671	1.44
7/8	3/4	7033x14x12	1-3/8	.719	1.72
1	1/2	7033x16x8	1-1/2	.687	1.12
1	3/4	7033x16x12	1-1/2	.844	1.70
1-1/4	3/4	7033x20x12	1-7/8	.968	1.20
1-1/2	1-1/4	7033x24x20	2-1/8	1.312	1.75
2	1-1/2	7033x32x24	2-3/4	1.781	1.44

Straight Thread O-Ring Union

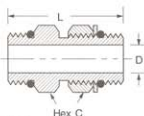

Replacement O-rings page 194.

Port Size	Catalog Number	Hex C	D	L
1/4	C5314x4x4	9/16	.172	1.37
3/8	C5314x6x6	11/16	.297	1.50
1/2	C5314x8x8	7/8	.391	1.56
5/8	C5314x10x10	1	.484	1.80
3/4	C5314x12x12	1-1/4	.609	2.33
1	C5314x16x16	1-1/2	.844	2.28
1-1/4	C5314x20x20	1-7/8	1.078	2.13
1-1/2	C5314x24x24	2-1/8	1.312	2.13
2	C5314x32x32	2-3/4	1.781	2.13