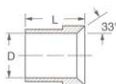
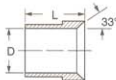

Sleeve 3 Piece
Stainless Steel No. 5177x
 (Ref. SAE No. 070115)

Tube O.D.	Catalog Number	D	L
1/8	C5165x2-	.130	.34
3/16	C5165x3-	.193	.34
1/4	C5165x4-	.255	.41
5/16	C5165x5-	.318	.44
3/8	C5165x6-	.380	.50
1/2	C5165x8-	.505	.56
5/8	C5165x10-	.631	.66
3/4	C5165x12-	.756	.68
7/8	C5165x14	.881	.76
1	C5165x16-	1.006	.78
1-1/4	C5165x20-	1.260	.91
1-1/2	C5165x24-	1.510	1.12
2	C5165x32-	2.014	1.19

Sleeve 3 Piece Metric
 (Ref. SAE No. 070115)

Adapts Standard SAE Flare-Twin® fittings for use with metric tubing.

Tube O.D. (Inch Size)	Tube O.D. (Metric Size)	Catalog Number	D	L
1/4	6MM	C5165x4x6MM	.241	.41
5/16	8MM	C5165x5x8MM	.320	.44
3/8	10MM	C5165x6x10MM	.399	.50
1/2	12MM	C5165x8x12MM	.478	.56
5/8	14MM	C5165x10x14MM	.556	.66
5/8	15MM	C5165x10x15MM	.596	.66
5/8	16MM	C5165x10x16MM	.636	.66
3/4	18MM	C5165x12x18MM	.717	.68
7/8	20MM	C5165x14x20MM	.793	.76
1	25MM	C5165x16x25MM	.990	.78
1-1/4	30MM	C5165x20x30MM	1.191	.91
1-1/4	32MM	C5165x20x32MM	1.270	.91
1-1/2	38MM	C5165x24x38MM	1.510	1.12

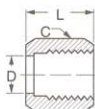
Nut 3 Piece
Stainless Steel No. 5117x
 (Ref. SAE No. 070110)

SAE style 'B'

Tube O.D.	Catalog Number	Hex C	D	L
1/8	C5105x2-	3/8	.181	.55
3/16	C5105x3-	7/16	.243	.61
1/4	C5105x4-	9/16	.306	.62
5/16	C5105x5-	5/8	.375	.68
3/8	C5105x6-	11/16	.441	.73
1/2	C5105x8-	7/8	.571	.85
5/8	C5105x10-	1	.698	.98
3/4	C5105x12-	1-1/4	.835	1.03
7/8	C5105x14	1-3/8	.961	1.09
1	C5105x16-	1-1/2	1.089	1.13
1-1/4	C5105x20-	2	1.347	1.23
1-1/2	C5105x24-	2-1/4	1.617	1.42
2	C5105x32-	2-7/8	2.167	1.75

2 Piece Nut (Short)

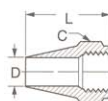

Tube O.D.	Catalog Number	Hex C	D	L
1/4	C5125x4	9/16	.255	.59
5/16	C5125x5	5/8	.318	.59
3/8	C5125x6	11/16	.380	.66
1/2	C5125x8	7/8	.505	.81
5/8	C5125x10	1	.631	.94
3/4	C5125x12	1-1/4	.756	1.14

2 Piece Nut
 (Ref. SAE No. 070111)

SAE style 'A'

Tube O.D.	Catalog Number	Hex C	D	L
1/4	C5115x4	9/16	.255	1.00
5/16	C5115x5	5/8	.318	1.06
3/8	C5115x6	11/16	.380	1.09
1/2	C5115x8	7/8	.505	1.28
5/8	C5115x10	1	.631	1.48
3/4	C5115x12	1-1/4	.756	1.66
7/8	C5115x14	1-3/8	.881	1.81
1	C5115x16	1-1/2	1.006	1.94
1-1/4	C5115x20	2	1.260	2.19
1-1/2	C5115x24	2-1/4	1.510	2.31

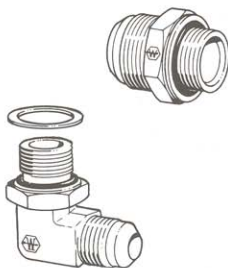
* Available in stainless steel.



- **Typical Application**
Used in applications to adapt connections and tubing to male and female swivel 37° JIC flare.
- **Sealing Method**
Tapered pipe thread, or o-ring, or 37° flare.
- **Vibration Rating**
Fair resistance.
- **Material**
Carbon Steel – SAE 12L14.
- **Plating**
Zinc yellow dichromate finish.
- **Advantages**
Provides an adapter to convert Metric ports to 37° JIC allowing the use of standard hose and end fittings. Also metric tubing that can be flared can be adapted to a standard 37° JIC connection by the use of sleeves.
- **Ordering Information**
Order individually by catalog number.

Sleeve 3 Piece Metric (Ref. SAE No. 070115)

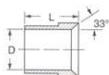

Adapts standard JIC Flare-Twin® fittings for use with metric tubing.

Tube O.D. (Inch Size)	Tube O.D. (Metric Size)	Catalog Number	D	L
1/4	6MM	C5165x4x6MM	.241	.41
5/16	8MM	C5165x5x8MM	.320	.44
3/8	10MM	C5165x6x10MM	.399	.50
1/2	12MM	C5165x8x12MM	.478	.56
5/8	14MM	C5165x10x14MM	.556	.66
5/8	15MM	C5165x10x15MM	.596	.66
5/8	16MM	C5165x10x16MM	.636	.66
3/4	18MM	C5165x12x18MM	.717	.68
7/8	20MM	C5165x14x20MM	.793	.76
7/8	22MM	C5165x14x22MM	.866	.76
1	25MM	C5165x16x25MM	.990	.78
1-1/4	30MM	C5165x20x30MM	1.191	.91
1-1/4	32MM	C5165x20x32MM	1.270	.91
1-1/2	38MM	C5165x24x38MM	1.500	1.12

Male JIC 37° to Male Metric Straight Thread Connector (Port Per ISO 9974)

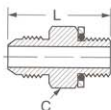

Tube O.D.	Male Metric Thread	Catalog Number	L	Hex C
1/4	M10x1.0	MC5315x4x10	1.18	5/8
1/4	M12x1.5	MC5315x4x12	1.22	5/8
1/4	M14x1.5	MC5315x4x14	1.22	3/4
3/8	M14x1.5	MC5315x6x14	1.22	3/4
3/8	M16x1.5	MC5315x6x16	1.32	7/8
1/2	M18x1.5	MC5315x8x18	1.48	15/16
1/2	M22x1.5	MC5315x8x22	1.61	1-1/16
5/8	M20x1.5	MC5315x10x20	1.71	1
3/4	M22x1.5	MC5315x12x22	1.81	1-1/8
3/4	M27x2.0	MC5315x12x27	1.95	1-1/4
1	M33x2.0	MC5315x16x33	2.03	1-5/8
1-1/4	M42x2.0	MC5315x20x42	2.19	2

Replacement retaining rings and O-rings page 214.

NOTE: Multiply millimeters (mm) by 0.03937 to obtain inches.



MA-100 • Metric Adapter Assortment

The MA-100 is an ideal assortment to begin a metric adapter inventory. Offered are a variety of male British Standard Tapered Pipe and British Standard Parallel fittings in straight and 90° elbow configurations, sizes ranging from 1/8" through 1-1/4". Two male DIN (German metric) fittings adapt SAE fittings and hose ends to metric size tubing, and a third DIN fitting connects SAE fittings with metric female swivel adapters, sizes ranging from 6mm through 42mm. The C5165X metric sleeves adapt metric tubing used with standard JIC fittings. The MA-100 is supplied with cabinet for accurate and easy access to your metric fittings.

Replacement Drawers: **PD-49** (Individual)

Replacement Dividers: **PD-75 Set** (25/set)

MA-100 Contents

Catalog Number	Qty.	Catalog Number	Qty.	Catalog Number	Qty.	Catalog Number	Qty.	Catalog Number	Qty.
7165X6MM	5	M9700X5X8	2	MB5515X6X4	5	MC5208X6X6	2	MH7105X6	5
7165X8MM	2	M9700X6X10	2	MB5515X6X6	5	MC5208X8X10	2	MH7105X8	5
7165X10MM	5	M9700X8X12	2	MB5515X8X6	5	MC5208X10X14	2	MH7105X10	5
7165X12MM	5	M9700X10X14	2	MB5515X8X8	5	MC5208X12X16	2	MH7105X12	5
7165X14MM	5	M9700X12X20	2	MB5515X10X12	5	MC5315X4X10	2	MH7105X14	5
7165X15MM	5	M9700X16X25	2	MB5515X12X12	5	MC5315X4X12	2	MH7105X16	5
7165X16MM	5	M9700X20X32	1	MB5515X16X16	2	MC5315X6X14	2	MH7105X20	5
7165X18MM	5	M9800X4X4	2	MB5515X20X20	2	MC5315X6X16	2	MH7105X25	5
7165X20MM	5	M9800X5X4	2	MC5205X4X2	5	MC5315X8X18	2	MH7105X30	5
7165X22MM	5	M9800X6X4	2	MC5205X4X4	5	MC5315X10X20	2	ML7105X6	5
7165X25MM	5	M9800X8X4	2	MC5205X5X4	5	MC5315X12X22	2	ML7105X8	5
7165X28MM	5	M9800X8X6	2	MC5205X6X4	5	MC5315X12X27	2	ML7105X10	5
7165X30MM	5	M9800X8X8	2	MC5205X6X6	5	MC5315X16X33	2	ML7105X12	5
M7629X10	5	M9800X10X8	2	MC5205X8X6	5	MC5315X20X42	1	ML7105X15	5
M7629X14	5	M9800X12X8	2	MC5205X8X8	5	MC5405X4X4	5	ML7105X18	5
M7629X16	5	M9800X12X12	2	MC5205X10X8	5	MC5405X5X4	5	ML7105X22	5
M7629X18	5	M9800X16X12	2	MC5205X10X12	5	MC5405X6X4	5	ML7105X28	5
M7629X20	5	M9800X16X16	2	MC5205X12X12	5	MC5405X6X6	5	C5165X4X6MM	5
M7629X22	5	M9800X20X20	1	MC5205X16X16	2	MC5405X8X6	5	C5165X5X8MM	5
M7629X27	5	MB5315X4X2	5	MC5205X20X20	2	MC5405X8X8	5	C5165X6X10MM	5
M7629X33	5	MB5315X4X4	5	MC5206X4X6	2	MC5405X10X12	5	C5165X8X12MM	5
M7629X42	5	MB5315X5X4	5	MC5206X6X8	2	MC5405X12X12	5	C5165X10X14MM	5
M9600X4X4	2	MB5315X6X4	5	MC5206X8X10	2	MC5405X16X16	2	C5165X10X15MM	5
M9600X5X4	2	MB5315X6X6	5	MC5206X8X12	2	MC5405X20X20	2	C5165X10X16MM	5
M9600X6X4	2	MB5315X8X6	5	MC5206X10X15	2	MC5515X4X12	2	C5165X12X18MM	5
M9600X6X6	2	MB5315X8X8	5	MC5206X12X18	2	MC5515X6X14	2	C5165X14X20MM	5
M9600X8X6	2	MB5315X10X12	5	MC5207X4X6	2	MC5515X6X16	2	C5165X16X25MM	5
M9600X8X8	2	MB5315X12X12	5	MC5207X6X8	2	MC5515X8X18	2	C5165X20X30MM	5
M9600X10X8	2	MB5315X16X16	2	MC5207X6X10	2	MC5515X10X20	2	C5165X20X32MM	5
M9600X12X12	2	MB5315X20X20	2	MC5207X8X12	2	MC5515X12X22	2	C-5X	1
M9600X16X16	2	MB5515X4X4	5	MC5207X10X15	2	MC5515X12X27	2	C-63X	1
M9600X20X20	1	MB5515X5X4	5	MC5207X12X18	2	MC5515X16X33	1	CL-502	1
M9700X4X6	2							TA-1002	1