

Metric Tube O.D.	6	8	10	12	14	15	16	18	20	22	25	28	30	38
Light	M12x1.5	M14x1.5	M16x1.5	M18x1.5	—	M22x1.5	—	M26x1.5	—	M30x2.0	—	M36x2.0	—	—
Heavy	M14x1.5	M16x1.5	M18x1.5	M20x1.5	M22x1.5	—	M24x1.5	—	M30x2.0	—	M36x2.0	—	M42x2.0	M52x2.0

• Typical Application

Used in applications to adapt connections made to DIN (Deutsche Industrie Norme) specifications to male 37° JIC Flare.

• Sealing Method

Three-Piece Flareless Bite Type or 60° or 24° Tube Seat, or 37° Flare.

• Vibration Rating

Three-Piece Flareless Bite Type or 60° or 24° Tube Seat. Fair Resistance.

• Material

Carbon Steel - SAE 12L14

• Plating

Bodies and Sleeves - Zinc Yellow Dichromate Finish
Nuts - Phosphate Coating.

• Advantages

Provides an adapter to convert a metric hose assembly to JIC 37° allowing the use of standard hose and end fittings. Can also be used in the repair of metric tubing.

• Presetting Instructions

1. Preset with preset tool. All sleeves should be preset in tool prior to installation.
1. Cut the tubing squarely and lightly deburr the end of the tubing inside and out.
2. Lubricate the sleeve, nut and threads with a good grade of lubricant compatible with the system fluid.
3. Slide the nut and sleeve on the tubing. The thicker end of the sleeve should be towards the nut.
4. Insert the tube into the preset tool making sure it is bottomed on the tube stop. Tighten the nut by hand as much as possible.

5. On the tube sizes up to and including 18mm O.D., tighten the nut 1-1/2 turns past hand tight. For larger tube O.D.'s, tighten the nut 1-1/4 turns past hand tight.
6. To inspect preset, mark the nut location and remove nut.
7. To reinstall, tighten the nut 1/6 turn (one hex flat) past the previous nut location.

• Ordering Information

Order individually by catalog number. Preset tools found on page 222.

Metric Flareless Sleeve

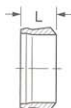

Tube O.D. (mm)	Catalog Number	L (mm)
6	7165x6MM	8.5
8	7165x8MM	8.5
10	7165x10MM	9.5
12	7165x12MM	9.5
14	7165x14MM	10.0
15	7165x15MM	10.0
16	7165x16MM	10.0
18	7165x18MM	10.0
20	7165x20MM	11.5
22	7165x22MM	11.5
25	7165x25MM	11.5
28	7165x28MM	11.5
30	7165x30MM	13.5
38	7165x38MM	13.5

Metric Flareless Nut Light Series (DIN 3901/3902L)

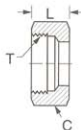

Tube O.D. (mm)	Catalog Number	T Thread	Hex C (mm)	L (mm)
6	ML7105x6	M12x1.5	14	14.5
8	ML7105x8	M14x1.5	17	14.5
10	ML7105x10	M16x1.5	19	15.5
12	ML7105x12	M18x1.5	22	15.5
15	ML7105x15	M22x1.5	27	17.0
18	ML7105x18	M26x1.5	32	18.0
22	ML7105x22	M30x2.0	36	20.0
28	ML7105x28	M36x2.0	41	21.0

Metric Flareless Nut Heavy Series (DIN 3901/3902S)

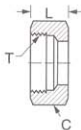

Tube O.D. (mm)	Catalog Number	T Thread	Hex C (mm)	L (mm)
6	MH7105x6	M14x1.5	17	16.5
8	MH7105x8	M16x1.5	19	16.5
10	MH7105x10	M18x1.5	22	17.5
12	MH7105x12	M20x1.5	24	17.5
14	MH7105x14	M22x1.5	27	20.5
16	MH7105x16	M24x1.5	30	20.5
20	MH7105x20	M30x2.0	36	24.0
25	MH7105x25	M36x2.0	46	27.0
30	MH7105x30	M42x2.0	50	29.0
38	MH7105x38	M52x2.0	60	32.5

NOTE: Multiply millimeters (mm) by 0.03937 to obtain inches.

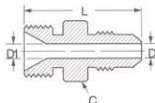
**Male JIC 37° to 24° Metric Tube
Seat (Light)**
(DIN 3901/3902L)

Tube O.D.	Tube O.D. (mm)	Catalog Number	Metric Thread	Hex C	D	D1	L
1/4	6	MC5206x4x6	M12x1.5	5/8	.171	.171	1.22
3/8	8	MC5206x6x8	M14x1.5	3/4	.297	.240	1.22
1/2	10	MC5206x8x10	M16x1.5	7/8	.391	.322	1.41
1/2	12	MC5206x8x12	M18x1.5	15/16	.391	.398	1.48
5/8	15	MC5206x10x15	M22x1.5	1-1/16	.484	.478	1.70
3/4	18	MC5206x12x18	M26x1.5	1-3/4	.609	.596	1.91

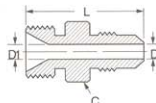
**Male JIC 37° to 24° Metric Tube
Seat (Heavy)**
(DIN 3901/3902S)

Tube O.D.	Tube O.D. (mm)	Catalog Number	Metric Thread	Hex C	D	D1	L
3/8	6	MC5208x6x6	M14x1.5	3/4	.297	.167	1.22
1/2	10	MC5208x8x10	M18x1.5	15/16	.391	.283	1.48
5/8	14	MC5208x10x14	M22x1.5	1-1/16	.484	.397	1.70
3/4	16	MC5208x12x16	M24x1.5	1-1/8	.609	.476	1.77

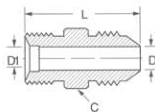
**Male JIC 37° to 60° Metric Tube
Seat**
(DIN 7631)

Tube O.D.	Tube O.D. (mm)	Catalog Number	Metric Thread	Hex C	D	D1	L
1/4	6	MC5207x4x6	M12x1.5	1/2	.171	.157	1.22
3/8	8	MC5207x6x8	M14x1.5	5/8	.297	.242	1.22
3/8	10	MC5207x6x10	M16x1.5	7/8	.297	.321	1.32
1/2	12	MC5207x8x12	M18x1.5	15/16	.391	.394	1.48
5/8	15	MC5207x10x15	M22x1.5	1-1/16	.472	.472	1.52
3/4	18	MC5207x12x18	M26x1.5	1-1/8	.609	.596	1.91

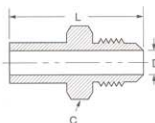
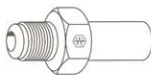
**Male JIC 37° to Male Metric
Standpipe**
(DIN 7631)

Tube O.D.	Tube O.D. (mm)	Catalog Number	Hex C	L	D
1/4	6MM	MC5019x4x6	9/16	1.58	.16
1/4	8MM	MC5019x4x8	9/16	1.68	.17
3/8	10MM	MC5019x6x10	3/4	1.67	.28
1/2	12MM	MC5019x8x12	7/8	1.97	.32
1/2	14MM	MC5019x8x14	7/8	1.89	.39
5/8	15MM	MC5019x10x15	1	2.03	.43
5/8	16MM	MC5019x10x16	1	2.07	.47
3/4	16MM	MC5019x12x16	1-1/4	2.22	.47
3/4	18MM	MC5019x12x18	1-1/4	2.12	.55
3/4	20MM	MC5019x12x20	1-1/4	2.38	.61
1	22MM	MC5019x16x22	1-1/2	2.21	.67
1	25MM	MC5019x16x25	1-1/2	2.54	.79

NOTE: Multiply millimeters (mm) by 0.03937 to obtain inches.