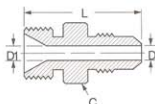
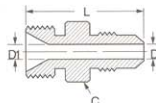
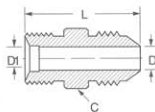

**Male JIC 37° to 24° Metric Tube
Seat (Light)**
(DIN 3901/3902L)

Tube O.D.	Tube O.D. (mm)	Catalog Number	Metric Thread	Hex C	D	D1	L
1/4	6	MC5206x4x6	M12x1.5	5/8	.171	.171	1.22
3/8	8	MC5206x6x8	M14x1.5	3/4	.297	.240	1.22
1/2	10	MC5206x8x10	M16x1.5	7/8	.391	.322	1.41
1/2	12	MC5206x8x12	M18x1.5	15/16	.391	.398	1.48
5/8	15	MC5206x10x15	M22x1.5	1-1/16	.484	.478	1.70
3/4	18	MC5206x12x18	M26x1.5	1-3/4	.609	.596	1.91

**Male JIC 37° to 24° Metric Tube
Seat (Heavy)**
(DIN 3901/3902S)

Tube O.D.	Tube O.D. (mm)	Catalog Number	Metric Thread	Hex C	D	D1	L
3/8	6	MC5208x6x6	M14x1.5	3/4	.297	.167	1.22
1/2	10	MC5208x8x10	M18x1.5	15/16	.391	.283	1.48
5/8	14	MC5208x10x14	M22x1.5	1-1/16	.484	.397	1.70
3/4	16	MC5208x12x16	M24x1.5	1-1/8	.609	.476	1.77

**Male JIC 37° to 60° Metric Tube
Seat**
(DIN 7631)

Tube O.D.	Tube O.D. (mm)	Catalog Number	Metric Thread	Hex C	D	D1	L
1/4	6	MC5207x4x6	M12x1.5	1/2	.171	.157	1.22
3/8	8	MC5207x6x8	M14x1.5	5/8	.297	.242	1.22
3/8	10	MC5207x6x10	M16x1.5	7/8	.297	.321	1.32
1/2	12	MC5207x8x12	M18x1.5	15/16	.391	.394	1.48
5/8	15	MC5207x10x15	M22x1.5	1-1/16	.472	.472	1.52
3/4	18	MC5207x12x18	M26x1.5	1-1/8	.609	.596	1.91

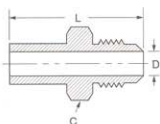
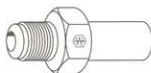
**Male JIC 37° to Male Metric
Standpipe**
(DIN 7631)

Tube O.D.	Tube O.D. (mm)	Catalog Number	Hex C	L	D
1/4	6MM	MC5019x4x6	9/16	1.58	.16
1/4	8MM	MC5019x4x8	9/16	1.68	.17
3/8	10MM	MC5019x6x10	3/4	1.67	.28
1/2	12MM	MC5019x8x12	7/8	1.97	.32
1/2	14MM	MC5019x8x14	7/8	1.89	.39
5/8	15MM	MC5019x10x15	1	2.03	.43
5/8	16MM	MC5019x10x16	1	2.07	.47
3/4	16MM	MC5019x12x16	1-1/4	2.22	.47
3/4	18MM	MC5019x12x18	1-1/4	2.12	.55
3/4	20MM	MC5019x12x20	1-1/4	2.38	.61
1	22MM	MC5019x16x22	1-1/2	2.21	.67
1	25MM	MC5019x16x25	1-1/2	2.54	.79

NOTE: Multiply millimeters (mm) by 0.03937 to obtain inches.



MA-100 • Metric Adapter Assortment

The MA-100 is an ideal assortment to begin a metric adapter inventory. Offered are a variety of male British Standard Tapered Pipe and British Standard Parallel fittings in straight and 90° elbow configurations, sizes ranging from 1/8" through 1-1/4". Two male DIN (German metric) fittings adapt SAE fittings and hose ends to metric size tubing, and a third DIN fitting connects SAE fittings with metric female swivel adapters, sizes ranging from 6mm through 42mm. The C5165X metric sleeves adapt metric tubing used with standard JIC fittings. The MA-100 is supplied with cabinet for accurate and easy access to your metric fittings.

Replacement Drawers: **PD-49** (Individual)

Replacement Dividers: **PD-75 Set** (25/set)

MA-100 Contents

Catalog Number	Qty.	Catalog Number	Qty.	Catalog Number	Qty.	Catalog Number	Qty.	Catalog Number	Qty.
7165X6MM	5	M9700X5X8	2	MB5515X6X4	5	MC5208X6X6	2	MH7105X6	5
7165X8MM	5	M9700X6X10	2	MB5515X6X6	5	MC5208X8X10	2	MH7105X8	5
7165X10MM	5	M9700X8X12	2	MB5515X8X6	5	MC5208X10X14	2	MH7105X10	5
7165X12MM	5	M9700X10X14	2	MB5515X8X8	5	MC5208X12X16	2	MH7105X12	5
7165X14MM	5	M9700X12X20	2	MB5515X10X12	5	MC5315X4X10	2	MH7105X14	5
7165X15MM	5	M9700X16X25	2	MB5515X12X12	5	MC5315X4X12	2	MH7105X16	5
7165X16MM	5	M9700X20X32	1	MB5515X16X16	2	MC5315X6X14	2	MH7105X20	5
7165X18MM	5	M9800X4X4	2	MB5515X20X20	2	MC5315X6X16	2	MH7105X25	5
7165X20MM	5	M9800X5X4	2	MC5205X4X2	5	MC5315X8X18	2	MH7105X30	5
7165X22MM	5	M9800X6X4	2	MC5205X4X4	5	MC5315X10X20	2	ML7105X6	5
7165X25MM	5	M9800X8X4	2	MC5205X5X4	5	MC5315X12X22	2	ML7105X8	5
7165X28MM	5	M9800X8X6	2	MC5205X6X4	5	MC5315X12X27	2	ML7105X10	5
7165X30MM	5	M9800X8X8	2	MC5205X6X6	5	MC5315X16X33	2	ML7105X12	5
M7629X10	5	M9800X10X8	2	MC5205X8X6	5	MC5315X20X42	1	ML7105X15	5
M7629X14	5	M9800X12X8	2	MC5205X8X8	5	MC5405X4X4	5	ML7105X18	5
M7629X16	5	M9800X12X12	2	MC5205X10X8	5	MC5405X5X4	5	ML7105X22	5
M7629X18	5	M9800X16X12	2	MC5205X10X12	5	MC5405X6X4	5	ML7105X28	5
M7629X20	5	M9800X16X16	2	MC5205X12X12	5	MC5405X6X6	5	C5165X4X6MM	5
M7629X22	5	M9800X20X20	1	MC5205X16X16	2	MC5405X8X6	5	C5165X5X8MM	5
M7629X27	5	MB5315X4X2	5	MC5205X20X20	2	MC5405X8X8	5	C5165X6X10MM	5
M7629X33	5	MB5315X4X4	5	MC5206X4X6	2	MC5405X10X12	5	C5165X8X12MM	5
M7629X42	5	MB5315X5X4	5	MC5206X6X8	2	MC5405X12X12	5	C5165X10X14MM	5
M9600X4X4	2	MB5315X6X4	5	MC5206X8X10	2	MC5405X16X16	2	C5165X10X15MM	5
M9600X5X4	2	MB5315X6X6	5	MC5206X8X12	2	MC5405X20X20	2	C5165X10X16MM	5
M9600X6X4	2	MB5315X8X6	5	MC5206X10X15	2	MC5515X4X12	2	C5165X12X18MM	5
M9600X6X6	2	MB5315X8X8	5	MC5206X12X18	2	MC5515X6X14	2	C5165X14X20MM	5
M9600X8X6	2	MB5315X10X12	5	MC5207X4X6	2	MC5515X6X16	2	C5165X16X25MM	5
M9600X8X8	2	MB5315X12X12	5	MC5207X6X8	2	MC5515X8X18	2	C5165X20X30MM	5
M9600X10X8	2	MB5315X16X16	2	MC5207X6X10	2	MC5515X10X20	2	C5165X20X32MM	5
M9600X12X12	2	MB5315X20X20	2	MC5207X8X12	2	MC5515X12X22	2	C-5X	1
M9600X16X16	2	MB5515X4X4	5	MC5207X10X15	2	MC5515X12X27	2	C-63X	1
M9600X20X20	1	MB5515X5X4	5	MC5207X12X18	2	MC5515X16X33	1	CL-502	1
M9700X4X6	2							TA-1002	1