

- Typical Application**
 Used in applications to adapt connections made to BSP (British Standard Pipe) specifications to male or female swivel JIC 37° flare.
- Sealing Method**
 Tapered (BSPT) or Parallel Pipe Thread (BSPP), O-ring or 37° flare.
- Vibration Rating**
 Fair resistance.
- Material**
 Carbon Steel – SAE 12L14.
- Plating**
 Zinc with yellow or green dichromate finish.
- Advantages**
 Provides an adapter to convert BSP ports to 37° JIC allowing the use of standard hose and end fittings.
- Ordering Information**
 Order individually by catalog number.

Pipe Size	1/8	1/4	3/8	1/2	5/8	3/4	1	1-1/4
Thread Size	1/8-28	1/4-19	3/8-19	1/2-14	5/8-14	3/4-14	1-11	1-1/4-11

Hex Head Plug

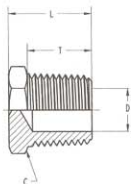

BSPT Pipe Size	Catalog Number	Hex C (mm)	Hex		D Opt. Dia.
			L	T	
1/8	MC3159x2	11	.58	.385	.16
1/4	MC3159x4	14	.76	.577	.25
3/8	MC3159x6	17	.80	.577	.38
1/2	MC3159x8	22	.98	.765	.50
3/4	MC3159x12	27	1.11	.796	.69
1	MC3159x16	36	1.27	.943	.88

Coupling

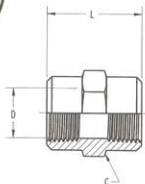

BSPT Pipe Size	Catalog Number	Hex C (mm)	Hex		D Dia.
			L	T	
1/8	MC3309x2	17	.75	.337	
1/4	MC3309x4	19	1.13	.450	
3/8	MC3309x6	22	1.13	.588	
1/2	MC3309x8	30	1.50	.733	
3/4	MC3309x12	36	1.53	.949	
1	MC3309x16	41	1.89	1.192	

Hex Nipple

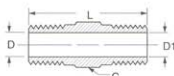

BSPT Pipe Size A	BSPT Pipe Size A1	Catalog Number	Hex C		T1	D	D1	
			L	T				
1/8	1/8	MC3069x2x2	11	1.06	.395	.395	.188	.188
1/4	1/8	MC3069x4x2	17	1.26	.575	.395	.281	.188
1/4	1/4	MC3069x4x4	17	1.45	.575	.575	.281	.281
3/8	1/4	MC3069x6x4	19	1.45	.575	.575	.406	.281
3/8	3/8	MC3069x6x6	19	1.45	.575	.575	.406	.406
1/2	3/8	MC3069x8x6	22	1.70	.765	.575	.531	.406
1/2	1/2	MC3069x8x8	22	1.89	.765	.765	.531	.531
3/4	1/2	MC3069x12x8	30	1.99	.795	.765	.719	.531
3/4	3/4	MC3069x12x12	30	2.02	.795	.795	.719	.719
1	3/4	MC3069x16x12	36	2.18	.955	.795	.939	.719
1	1	MC3069x16x16	36	2.34	.955	.955	.939	.939
1-1/4	1	MC3069x20x16	46	2.51	1.045	.955	1.252	.939
1-1/4	1-1/4	MC3069x20x20	46	2.60	1.045	1.045	1.252	1.252
1-1/2	1-1/4	MC3069x24x20	50	2.67	1.045	1.045	1.502	1.252
1-1/2	1-1/2	MC3069x24x24	50	2.67	1.045	1.045	1.502	1.502
2	1-1/2	MC3069x32x24	65	2.98	1.205	1.045	1.940	1.502
2	2	MC3069x32x32	65	3.14	1.205	1.205	1.940	1.940

Male Connector to Male JIC 37°

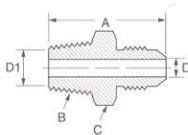

37° Tube O.D.	BSPT Pipe Size	Catalog Number	BSPT Thread B	L	Hex C		D	D1
					D	D1		
1/4	1/8	MC5205x4x2	1/8-28	1.22	1/2	.172	.281	
1/4	1/4	MC5205x4x4	1/4-19	1.42	9/16	.172	.188	
1/4	3/8	MC5205x4x6	1/4-19	1.42	1/2	.172	.406	
5/16	1/4	MC5205x5x4	1/4-19	1.22	9/16	.234	.281	
5/16	3/8	MC5205x5x6	3/8-19	1.42	47/64	.234	.406	
3/8	1/4	MC5205x6x4	1/4-19	1.21	5/8	.297	.406	
3/8	3/8	MC5205x6x6	3/8-19	1.29	3/4	.297	.281	
3/8	1/2	MC5205x6x8	1/2-14	1.69	55/64	.297	.531	
3/8	3/4	MC5205x6x12	3/4-14	1.78	1-5/32	.297	.719	
1/2	3/8	MC5205x8x6	3/8-19	1.41	13/16	.391	.531	
1/2	1/2	MC5205x8x8	1/2-14	1.59	15/16	.391	.406	
1/2	3/4	MC5205x8x12	3/4-14	1.88	1-5/32	.391	.719	
5/8	1/2	MC5205x10x8	1/2-14	1.66	15/16	.484	.531	
5/8	3/4	MC5205x10x12	3/4-14	1.99	1-1/8	.484	.719	
5/8	1	MC5205x10x16	1-11	2.15	1-13/32	.484	.939	
3/4	1/2	MC5205x12x8	1/2-14	2.06	1-5/32	.609	.719	
3/4	3/4	MC5205x12x12	3/4-14	1.93	1-1/8	.719	.942	
3/4	1	MC5205x12x16	1-11	2.25	1-13/32	.609	.531	
7/8	3/4	MC5205x14x12	3/4-14	2.12	1-5/32	.609	.939	
7/8	1	MC5205x14x16	1-11	2.28	1-13/32	.719	.719	
1	3/4	MC5205x16x12	3/4-14	2.14	1-13/32	.845	.939	
1	1	MC5205x16x16	1-11	2.13	1-3/8	.845	.719	
1-1/4	1-1/4	MC5205x20x20	1-1/4-11	2.34	1-11/16	1.080	1.252	
1-1/2	1-1/2	MC5205x24x24	1-1/2-11	2.71	1-15/16	1.314	1.502	
2	2	MC5205x32x32	2-11	3.27	2-3/4	1.784	1.940	

BSPP Male To NPTF Female Adapter



Male BSPP Thread	Female NPTF Thread	Catalog Number	H	L	SW (mm)
1/4	1/4	1150x4x4PP	.32	.91	17
3/8	3/8	1150x6x6PP	.35	.96	22
1/2	1/2	1150x8x8PP	.39	1.16	27

BSP Fittings

Steel Fittings

BSP Female To NPTF Male Adapter



1UNF thread

Female BSPP	Male NPTF Thread	Catalog Number	H	L	SW (mm)
M5*	10-32†	1100x5MMxA	.18	.47	8
1/8	1/8	1100x2PPx2	.37	.77	14
1/4	1/4	1100x4PPx4	.51	1.06	17
3/8	3/8	1100x6PPx6	.51	1.08	19

*M5 has 0.8mm Thread Pitch. M5 seals with nylon washer, included.

Male British Standard Parallel Pipe to Male JIC 37°

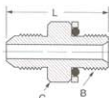

Replacement retaining rings and O-rings page 218.

Tube O.D.	BSPP Pipe Size	Catalog Number	BSPP Thread B	L	Hex C
1/4	1/8	MB5315x4x2	1/8-28	1.10	5/8
1/4	1/4	MB5315x4x4	1/4-19	1.24	3/4
5/16	1/4	MB5315x5x4	1/4-19	1.24	3/4
3/8	1/4	MB5315x6x4	1/4-19	1.25	3/4
3/8	3/8	MB5315x6x6	3/8-19	1.31	7/8
1/2	3/8	MB5315x8x6	3/8-19	1.48	7/8
1/2	1/2	MB5315x8x8	1/2-14	1.67	1-1/8
5/8	3/4	MB5315x10x12	3/4-14	1.83	1-3/8
3/4	3/4	MB5315x12x12	3/4-14	1.93	1-3/8
1	1	MB5315x16x16	1-11	2.20	1-3/4
1-1/4	1-1/4	MB5315x20x20	1-14-11	2.32	2

Female JIC 37° Swivel to Male British Standard Pipe Tapered BSPT Thread

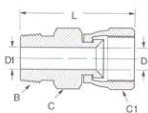
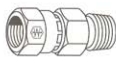

*Optional counterbore.

Tube O.D.	BSPT Pipe Size	Catalog Number	BSPT Thread B	Hex C	Hex C1	D	D1	L
1/4	1/4	M9800x4x4	1/4-19	9/16	9/16	.172	.281*	1.56
5/16	1/4	M9800x5x4	1/4-19	11/16	5/8	.234	.281*	1.63
3/8	1/4	M9800x6x4	1/4-19	11/16	11/16	.297	.281	1.69
1/2	1/4	M9800x8x4	1/4-19	7/8	7/8	.391	.281	1.87
1/2	3/8	M9800x8x6	3/8-19	7/8	7/8	.391	.406*	1.87
1/2	1/2	M9800x8x8	1/2-14	7/8	7/8	.391	.531*	2.06
5/8	1/2	M9800x10x8	1/2-14	1	1	.484	.531*	2.11
3/4	1/2	M9800x12x8	1/2-14	1-1/8	1-1/4	.609	.531	2.21
3/4	3/4	M9800x12x12	3/4-14	1-1/8	1-1/4	.609	.719*	2.24
1	3/4	M9800x16x12	3/4-14	1-3/8	1-1/2	.845	.719	2.39
1	1	M9800x16x16	1-11	1-3/8	1-1/2	.845	.938*	2.55
1-1/4	1-1/4	M9800x20x20	1-14-11	1-7/8	2	1.079	1.125*	2.73

Female 37° JIC Swivel to Male British Standard Pipe Parallel BSPP Thread

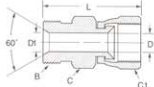

*Optional counterbore.

Tube O.D.	BSPP Pipe Size	Catalog Number	BSPP Thread B	Hex C1	Hex C	D	D1	L
1/4	1/4	M9600x4x4	1/4-19	9/16	9/16	.172	.198*	1.43
5/16	1/4	M9600x5x4	1/4-19	5/8	11/16	.234	.198	1.50
3/8	1/4	M9600x6x4	1/4-19	11/16	11/16	.297	.198	1.56
3/8	3/8	M9600x6x6	3/8-19	11/16	11/16	.297	.322*	1.66
1/2	3/8	M9600x8x6	3/8-19	7/8	7/8	.391	.322	1.77
1/2	1/2	M9600x8x8	1/2-14	7/8	7/8	.391	.448*	1.92
5/8	1/2	M9600x10x8	1/2-14	1	1	.484	.448	1.97
3/4	3/4	M9600x12x12	3/4-14	1-1/4	1-1/8	.609	.666*	2.25
1	1	M9600x16x16	1-11	1-1/2	1-3/8	.845	.885*	2.48
1-1/4	1-1/4	M9600x20x20	1-14-11	2	1-7/8	1.078	1.125*	2.64

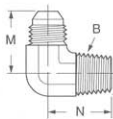
**90° Elbow - Male British
Standard Pipe Tapered BSPT
to Male JIC 37°**

Tube O.D.	BSPT Pipe Size	Catalog Number	BSPT Thread B	M	N	Across Flats
1/4	1/4	MC5405x4x4	1/4-19	1.05	1.09	7/16
5/16	1/4	MC5405x5x4	1/4-19	1.05	1.09	1/2
3/8	1/4	MC5405x6x4	1/4-19	1.06	1.09	9/16
3/8	3/8	MC5405x6x6	3/8-19	1.14	1.22	3/4
1/2	3/8	MC5405x8x6	3/8-19	1.25	1.22	3/4
1/2	1/2	MC5405x8x8	1/2-14	1.33	1.47	7/8
5/8	3/4	MC5405x10x12	3/4-14	1.54	1.59	1-1/16
3/4	3/4	MC5405x12x12	3/4-14	1.66	1.59	1-1/16
1	1	MC5405x16x16	1-11	1.81	1.97	1-5/16
1-1/4	1-1/4	MC5405x20x20	1-1/4-11	2.06	2.38	1-5/8

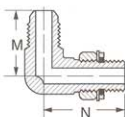
**90° Elbow - Male British
Standard Pipe Parallel BSPP
to Male JIC 37°**

Replacement retaining rings and O-rings see below.

Tube O.D.	BSPP Pipe Size	Catalog Number	BSPP Thread	M	N	Across Flats
1/4	1/4	MB5515x4x4	1/4-19	1.05	1.25	9/16
5/16	1/4	MB5515x5x4	1/4-19	.95	1.25	9/16
3/8	1/4	MB5515x6x4	1/4-19	1.06	1.25	9/16
3/8	3/8	MB5515x6x6	3/8-19	1.14	1.45	3/4
1/2	3/8	MB5515x8x6	3/8-19	1.25	1.45	3/4
1/2	1/2	MB5515x8x8	1/2-14	1.33	1.70	7/8
5/8	3/4	MB5515x10x12	3/4-14	1.34	1.94	1-1/16
3/4	3/4	MB5515x12x12	3/4-14	1.66	1.94	1-1/16
1	1	MB5515x16x16	1-11	1.81	2.05	1-5/16
1-1/4	1-1/4	MB5515x20x20	1-1/4-11	2.06	2.25	1-5/8

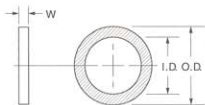
British Retaining Ring

Tube O.D.	Catalog Number	Ring I.D.	Ring O.D.	W
2	MB7630x2	.45	.60	.044
4	MB7630x4	.63	.81	.067
6	MB7630x6	.77	.93	.067
8	MB7630x8	.91	1.12	.067
10	MB7630x10	1.00	1.24	.067
12	MB7630x12	1.12	1.37	.067
16	MB7630x16	1.44	1.74	.092
20	MB7630x20	1.76	2.18	.092
24	MB7630x24	2.02	2.43	.092

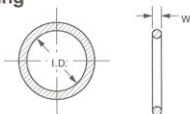
British O-Ring

Material: Buna N 90 Durometer
Temperature Range: -40°F to +250°F
(-40°C to +121°C)

Tube O.D.	Catalog Number	W	I.D.
2	MB7629x2	.070	.239
4	MB7629x4	.103	.424
6	MB7629x6	.103	.549
8	MB7629x8	.103	.695
10	MB7629x10	.103	.818
12	MB7629x12	.103	.924
16	MB7629x16	.139	1.171
20	MB7629x20	.139	1.484