

Hex Nipple

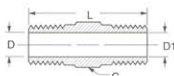

BSPT Pipe Size A	BSPT Pipe Size A1	Catalog Number	Hex C					
			L	T	T1	D	D1	
1/8	1/8	MC3069x2x2	11	1.06	.395	.395	.188	.188
1/4	1/8	MC3069x4x2	17	1.26	.575	.395	.281	.188
1/4	1/4	MC3069x4x4	17	1.45	.575	.575	.281	.281
3/8	1/4	MC3069x6x4	19	1.45	.575	.575	.406	.281
3/8	3/8	MC3069x6x6	19	1.45	.575	.575	.406	.406
1/2	3/8	MC3069x8x6	22	1.70	.765	.575	.531	.406
1/2	1/2	MC3069x8x8	22	1.89	.765	.765	.531	.531
3/4	1/2	MC3069x12x8	30	1.99	.795	.765	.719	.531
3/4	3/4	MC3069x12x12	30	2.02	.795	.795	.719	.719
1	3/4	MC3069x16x12	36	2.18	.955	.795	.939	.719
1	1	MC3069x16x16	36	2.34	.955	.955	.939	.939
1-1/4	1	MC3069x20x16	46	2.51	1.045	.955	1.252	.939
1-1/4	1-1/4	MC3069x20x20	46	2.60	1.045	1.045	1.252	1.252
1-1/2	1-1/4	MC3069x24x20	50	2.67	1.045	1.045	1.502	1.252
1-1/2	1-1/2	MC3069x24x24	50	2.67	1.045	1.045	1.502	1.502
2	1-1/2	MC3069x32x24	65	2.98	1.205	1.045	1.940	1.502
2	2	MC3069x32x32	65	3.14	1.205	1.205	1.940	1.940

Male Connector to Male JIC 37°

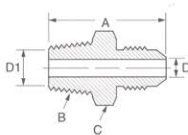

37° Tube O.D.	BSPT Pipe Size	Catalog Number	BSPT Thread B	L	Hex C		
					D	D1	
1/4	1/8	MC5205x4x2	1/8-28	1.22	1/2	.172	.281
1/4	1/4	MC5205x4x4	1/4-19	1.42	9/16	.172	.188
1/4	3/8	MC5205x4x6	1/4-19	1.42	1/2	.172	.406
5/16	1/4	MC5205x5x4	1/4-19	1.22	9/16	.234	.281
5/16	3/8	MC5205x5x6	3/8-19	1.42	47/64	.234	.406
3/8	1/4	MC5205x6x4	1/4-19	1.21	5/8	.297	.406
3/8	3/8	MC5205x6x6	3/8-19	1.29	3/4	.297	.281
3/8	1/2	MC5205x6x8	1/2-14	1.69	55/64	.297	.531
3/8	3/4	MC5205x6x12	3/4-14	1.78	1-5/32	.297	.719
1/2	3/8	MC5205x8x6	3/8-19	1.41	13/16	.391	.531
1/2	1/2	MC5205x8x8	1/2-14	1.59	15/16	.391	.406
1/2	3/4	MC5205x8x12	3/4-14	1.88	1-5/32	.391	.719
5/8	1/2	MC5205x10x8	1/2-14	1.66	15/16	.484	.531
5/8	3/4	MC5205x10x12	3/4-14	1.99	1-1/8	.484	.719
5/8	1	MC5205x10x16	1-11	2.15	1-13/32	.484	.939
3/4	1/2	MC5205x12x8	1/2-14	2.06	1-5/32	.609	.719
3/4	3/4	MC5205x12x12	3/4-14	1.93	1-1/8	.719	.942
3/4	1	MC5205x12x16	1-11	2.25	1-13/32	.609	.531
7/8	3/4	MC5205x14x12	3/4-14	2.12	1-5/32	.609	.939
7/8	1	MC5205x14x16	1-11	2.28	1-13/32	.719	.719
1	3/4	MC5205x16x12	3/4-14	2.14	1-13/32	.845	.939
1	1	MC5205x16x16	1-11	2.13	1-3/8	.845	.719
1-1/4	1-1/4	MC5205x20x20	1-1/4-11	2.34	1-11/16	1.080	1.252
1-1/2	1-1/2	MC5205x24x24	1-1/2-11	2.71	1-15/16	1.314	1.502
2	2	MC5205x32x32	2-11	3.27	2-3/4	1.784	1.940

BSPP Male To NPTF Female
Adapter

Male BSPP	Female NPTF Thread	Catalog Number	H	L	SW
					(mm)
1/8	1/8	1150x2x2PP	.27	.67	14
1/4	1/4	1150x4x4PP	.32	.91	17
3/8	3/8	1150x6x6PP	.35	.96	22
1/2	1/2	1150x8x8PP	.39	1.16	27



MA-100 • Metric Adapter Assortment

The MA-100 is an ideal assortment to begin a metric adapter inventory. Offered are a variety of male British Standard Tapered Pipe and British Standard Parallel fittings in straight and 90° elbow configurations, sizes ranging from 1/8" through 1-1/4". Two male DIN (German metric) fittings adapt SAE fittings and hose ends to metric size tubing, and a third DIN fitting connects SAE fittings with metric female swivel adapters, sizes ranging from 6mm through 42mm. The C5165X metric sleeves adapt metric tubing used with standard JIC fittings. The MA-100 is supplied with cabinet for accurate and easy access to your metric fittings.

Replacement Drawers: **PD-49** (Individual)

Replacement Dividers: **PD-75 Set** (25/set)

MA-100 Contents

Catalog Number	Qty.	Catalog Number	Qty.	Catalog Number	Qty.	Catalog Number	Qty.	Catalog Number	Qty.
7165X6MM	5	M9700X5X8	2	MB5515X6X4	5	MC5208X6X6	2	MH7105X6	5
7165X8MM	5	M9700X6X10	2	MB5515X6X6	5	MC5208X8X10	2	MH7105X8	5
7165X10MM	5	M9700X8X12	2	MB5515X8X6	5	MC5208X10X14	2	MH7105X10	5
7165X12MM	5	M9700X10X14	2	MB5515X8X8	5	MC5208X12X16	2	MH7105X12	5
7165X14MM	5	M9700X12X20	2	MB5515X10X12	5	MC5315X4X10	2	MH7105X14	5
7165X15MM	5	M9700X16X25	2	MB5515X12X12	5	MC5315X4X12	2	MH7105X16	5
7165X16MM	5	M9700X20X32	1	MB5515X16X16	2	MC5315X6X14	2	MH7105X20	5
7165X18MM	5	M9800X4X4	2	MB5515X20X20	2	MC5315X6X16	2	MH7105X25	5
7165X20MM	5	M9800X5X4	2	MC5205X4X2	5	MC5315X8X18	2	MH7105X30	5
7165X22MM	5	M9800X6X4	2	MC5205X4X4	5	MC5315X10X20	2	ML7105X6	5
7165X25MM	5	M9800X8X4	2	MC5205X5X4	5	MC5315X12X22	2	ML7105X8	5
7165X28MM	5	M9800X8X6	2	MC5205X6X4	5	MC5315X12X27	2	ML7105X10	5
7165X30MM	5	M9800X8X8	2	MC5205X6X6	5	MC5315X16X33	2	ML7105X12	5
M7629X10	5	M9800X10X8	2	MC5205X8X6	5	MC5315X20X42	1	ML7105X15	5
M7629X14	5	M9800X12X8	2	MC5205X8X8	5	MC5405X4X4	5	ML7105X18	5
M7629X16	5	M9800X12X12	2	MC5205X10X8	5	MC5405X5X4	5	ML7105X22	5
M7629X18	5	M9800X16X12	2	MC5205X10X12	5	MC5405X6X4	5	ML7105X28	5
M7629X20	5	M9800X16X16	2	MC5205X12X12	5	MC5405X6X6	5	C5165X4X6MM	5
M7629X22	5	M9800X20X20	1	MC5205X16X16	2	MC5405X8X6	5	C5165X5X8MM	5
M7629X27	5	MB5315X4X2	5	MC5205X20X20	2	MC5405X8X8	5	C5165X6X10MM	5
M7629X33	5	MB5315X4X4	5	MC5206X4X6	2	MC5405X10X12	5	C5165X8X12MM	5
M7629X42	5	MB5315X5X4	5	MC5206X6X8	2	MC5405X12X12	5	C5165X10X14MM	5
M9600X4X4	2	MB5315X6X4	5	MC5206X8X10	2	MC5405X16X16	2	C5165X10X15MM	5
M9600X5X4	2	MB5315X6X6	5	MC5206X8X12	2	MC5405X20X20	2	C5165X10X16MM	5
M9600X6X4	2	MB5315X8X6	5	MC5206X10X15	2	MC5515X4X12	2	C5165X12X18MM	5
M9600X6X6	2	MB5315X8X8	5	MC5206X12X18	2	MC5515X6X14	2	C5165X14X20MM	5
M9600X8X6	2	MB5315X10X12	5	MC5207X4X6	2	MC5515X6X16	2	C5165X16X25MM	5
M9600X8X8	2	MB5315X12X12	5	MC5207X6X8	2	MC5515X8X18	2	C5165X20X30MM	5
M9600X10X8	2	MB5315X16X16	2	MC5207X6X10	2	MC5515X10X20	2	C5165X20X32MM	5
M9600X12X12	2	MB5315X20X20	2	MC5207X8X12	2	MC5515X12X22	2	C-5X	1
M9600X16X16	2	MB5515X4X4	5	MC5207X10X15	2	MC5515X12X27	2	C-63X	1
M9600X20X20	1	MB5515X5X4	5	MC5207X12X18	2	MC5515X16X33	1	CL-502	1
M9700X4X6	2							TA-1002	1