

Refer to safety information regarding proper selection of tubing and tube fittings on page 1.

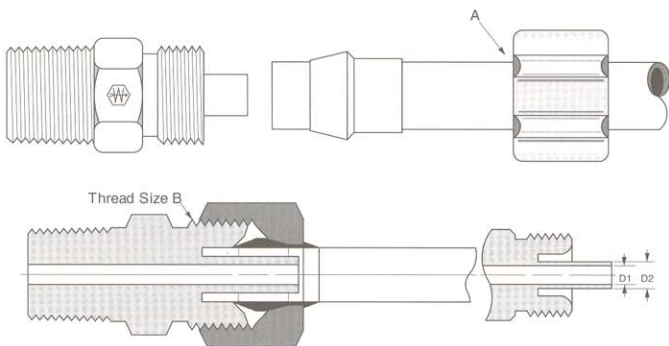

Size	x2	x3	x46	x4	x5	x6	x8
Tube O.D.	1/8	3/16	1/4	1/4	5/16	3/8	1/2
Thread Size-B	5/16-24	3/8-24	3/8-24	3/8-24	7/16-24	1/2-24	11/16-20
Flow Dia. (D1)	.094*	.125*	.078	.125	.141	.203	.312
Support Dia. (D2)	-	-	.120	.166	.180	.245	.370

*No tube support in assembly – Flow Diameter for body only.

• Typical Application

Pneumatic instrumentation circuits, lubricant and cooling lines.

• Pressure

Working pressure up to 500 psi with a 4:1 safety factor depending on tube size. When using plastic tubing, use the working pressure for type used.

• Vibration

Excellent resistance.

• Temperature Range

-65°F to +250°F (-53°C to +121°C) with brass sleeve and metal tubing. When using compatible plastic tubing do not exceed the tubing temperature range. (Refer to tubing temperature range.)

• Material

CA360 Brass body, plastic sleeve.

• Used With

Aluminum, copper and hard plastic tubing requires brass sleeve.

• Used With (Continued)

Weatherhead PT200 and PT240 plastic tubing use plastic sleeve. Not recommended for steel tubing. See page 28-32 for material compatibility and pages 33-34 for plastic tubing.

• Advantages

No flaring of tubing required. Easy installation, captive sleeve, pre-assembled for installation and can be reassembled.

• Conformance

An exclusive item with Weatherhead. User approvals only.

• How to Order

Order 1/4" O.D. tubing with .040 wall, use suffix x4. Example: 1262x4. When .062 wall is desired, use suffix x46. Example: 1262x46.

Ordered as complete assemblies (body, nuts and sleeves) by catalog number. Nuts, sleeves and nut/sleeve assemblies can be ordered separately by catalog number.

NOTE: 1/8" and 3/16" tube O.D. assemblies are supplied with brass sleeves and no inserts.

• NOTE

Refer to current price list for availability of cataloged items. Quotations and delivery of non-stock items supplied on request. Configurations and dimensions subject to change without notice.

• Assembly Instructions

1. Cut tubing to desired length.
2. Slide nut/sleeve assembly on tube. Threaded end "A" of nut must face toward fitting.
3. Bottom tubing into fitting.
4. **Plastic sleeve** - tighten nut, hand tight.
Brass sleeve - tighten nut, hand tight, then additional 3/4 turn.

Label Set: FS-2100 (adhesive)
CL-498 (non-adhesive)

Plastic Sleeve

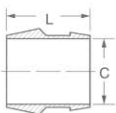

Tube O.D.	Catalog Number	C	L
1/4	1260x4	.259	.34
5/16	1260x5	.321	.39
3/8	1260x6	.384	.41
1/2	1260x8	.509	.44

Brass Sleeve

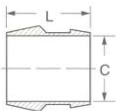

NOTE: 1/8" and 3/16" sleeve configurations vary from style illustrated

Tube O.D.	Catalog Number	C	L
1/4	1260x2B*	.130	.34
3/16	1260x3B*	.192	.30
1/4	1260x4B*	.263	.31
5/16	1260x5B*	.320	.36
3/8	1260x6B*	.384	.38
1/2	1260x8B*	.510	.41

Brass Nut

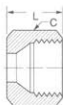

NOTE: 1/8" and 3/16" Nuts are flat Hex type

Tube O.D.	Catalog Number	Dia. C	L
1/8	1261x2	3/8	.38
3/16	1261x3	7/16	.38
1/4	1261x4	7/16	.34
5/16	1261x5*	1/2	.34
3/8	1261x6	9/16	.38
1/2	1261x8*	13/16	.44

Brass Nut/Plastic Sleeve Assembly

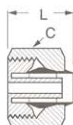

Tube O.D.	Catalog Number	Dia. C	L
1/4	1261x4A	7/16	.43
3/8	1261x6A	9/16	.49

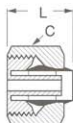
**Brass Nut/Brass Sleeve
Assembly**

NOTE: 1/8" and 3/16" Nuts are flat Hex type

Tube O.D.	Catalog Number	Dia. C	L
1/4	1261x4B*	9/16	.43
3/8	1261x6B*	13/16	.49

Brass Bulkhead Nut

For use with 1274x Bulkhead Unions, ref. pages 63 & 64.

Tube O.D.	Catalog Number	Hex C	L
1/8	1202x2*	5/16	.25
1/4	1202x4*	9/16	.19
5/16	1202x5*	5/8	.19
3/8	1202x6*	11/16	.19
1/2	1202x8*	7/8	.19

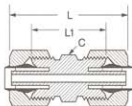
Union

Tube O.D.	Catalog Number	Hex C	L	L1
1/8	1262x2*	5/16	—	.66
1/4	1262x4	3/8	1.00	.69
3/8	1262x6	1/2	1.03	.72
1/2	1262x8*	11/16	1.28	.84

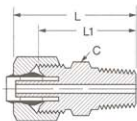
Male Connector

Tube O.D.	Male Pipe Thread	Catalog Number	Hex C	L	L1
1/8	1/8	1268x2*	7/16	—	.78
3/16	1/8	1268x3*	7/16	—	.84
1/4	1/16	1268x4x1	7/16	.97	.81
1/4	1/8	1268x4	7/16	.97	.81
1/4	1/4	1268x4x4	9/16	1.15	1.00
1/4	3/8	1268x4x6*	11/16	1.18	1.03
5/16	1/8	1268x5*	7/16	.97	.81
5/16	1/4	1268x5x4*	9/16	1.16	1.00
3/8	1/8	1268x6x2	1/2	1.00	.84
3/8	1/4	1268x6	9/16	1.19	1.03
3/8	3/8	1268x6x6	11/16	1.19	1.03
1/2	1/4	1268x8x4*	11/16	1.31	1.09
1/2	3/8	1268x8	11/16	1.31	1.09
1/2	1/2	1268x8x8*	11/16	1.62	1.03

*10-32 Straight Thread

Female Connector

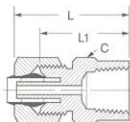

Tube O.D.	Fem. Pipe Thread	Catalog Number	Hex C	L	L1
1/8	1/8	1266x2	9/16	—	.75
1/4	1/8	1266x4	1/2	.87	.72
1/4	1/4	1266x4x4	5/8	1.09	.93
3/8	1/4	1266x6	5/8	1.09	.94

Bulkhead Union

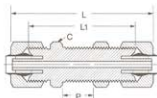

Tube O.D.	Catalog Number	Hex C	L	L1	Max. P
1/4	1274x4*	9/16	1.56	1.25	.38
5/16	1274x5*	5/8	1.56	1.25	.38
3/8	1274x6*	11/16	1.68	1.38	.47
1/2	1274x8*	7/8	2.09	1.66	.63

For Bulkhead Nuts, ref. page 62.

Male Elbow

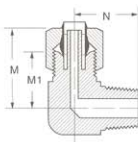

Tube O.D.	Male Pipe Thread	Catalog Number	M	M1	N
3/16	1/8	1269x3*	—	.59	.66
1/4	1/16	1269x4x1	.75	.59	.72
1/4	1/8	1269x4	.75	.59	.72
1/4	1/4	1269x4x4	.81	.66	.94
1/4	1/4	1269x4x4L*	.81	.66	1.38
1/4	3/8	1269x4x6	.84	.69	1.08
5/16	1/8	1269x5*	.75	.59	.72
3/8	1/8	1269x6x2	.88	.66	.75
3/8	1/4	1269x6	.87	.72	1.00
3/8	3/8	1269x6x6	.87	.72	1.08
1/2	3/8	1269x8*	1.06	.84	1.12

*"L" Suffix designates long leg elbow

Female Elbow

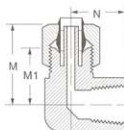

Tube O.D.	Fem. Pipe Thread	Catalog Number	M	M1	N
1/4	1/8	1270x4	.87	.66	.56
1/4	1/4	1270x4x4	.96	.75	.69
5/16	1/8	1270x5*	.92	.66	.56
3/8	1/4	1270x6*	.86	.75	.69
1/2	3/8	1270x8*	1.19	.91	.94

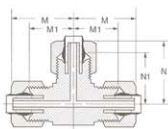
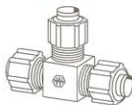
Union Tee

Tube O.D.	Catalog Number	M	M1	N	N1
1/4	1264x4	.75	.59	.75	.59
5/16	1264x5*	.75	.59	.75	.59
3/8x3/8x1/4	1264x6x6x4*	.88	.72	.81	.65
3/8	1264x6	.87	.72	.87	.72
1/2	1264x8*	1.06	.84	1.06	.84

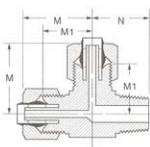
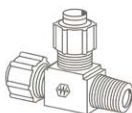
Male Run Tee

Tube O.D.	Male Pipe Thread	Catalog Number	M	M1	N
1/4	1/8	1271x4	.75	.59	.72
1/4	1/4	1271x4x4x4*	.81	.66	.94
5/16	1/8	1271x5*	.75	.59	.72
3/8	1/4	1271x6*	.87	.72	1.00
1/2	3/8	1271x8*	1.06	.84	1.12

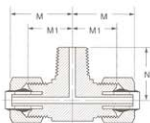
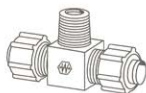
Male Branch Tee

Tube O.D.	Male Pipe Thread	Catalog Number	M	M1	N
1/4	1/8	1272x4*	.75	.59	.72
1/4	1/4	1272x4x4x4*	.81	.66	.94
5/16	1/8	1272x5*	.75	.59	.72
3/8	1/4	1272x6*	.87	.72	1.00
1/2	3/8	1272x8*	1.06	.84	1.12