

Refer to safety information regarding proper selection of tubing and tube fittings on page 1.

Push > Connect®

Push > Connect® Metric

Push > Connect® Flow Controls

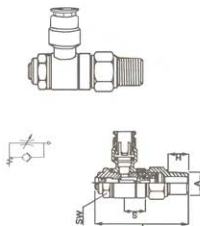
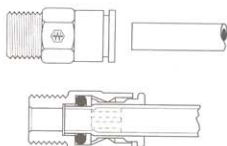
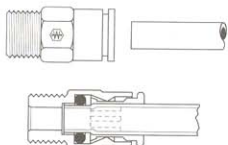

- **Typical Application:** Compressed air, pneumatic instrumentation, circuit, lubricant and cooling lines.
- **Pressure:** Up to 250 psi depending on tube size.
- **Sealing Method:** O-Ring of Buna-N Construction. (Viton available on request by special order.)
- **Temperature Range:** When using compatible plastic tubing do not exceed the tubing temperature range (Refer to tubing temperature range).
- **Material:** Brass, Nickel Plated.
- **Vacuum:** Fittings rated at 29.5 inches of mercury vacuum.
- **Used With:** PT230 and TP160 nylon, and PT240 Polyethylene tubing. See page 28-32 for material compatibility and pages 33-34 for plastic tubing.
- **Advantages:** Ease of assembly. No tools required, reusability of fittings and the time savings of assembly and disassembly.
- **Hex Dimensions:** All hexes are in inches.
- **How to Order:** Individually by catalog number.
- **NOTE:** Refer to current price list for availability of cataloged items. Quotations and delivery of non-stock items supplied on request. Configurations and dimensions subject to change without notice.
- **Assembly Instructions**
 1. To connect, simply push the tubing into the fitting.
 2. To disconnect, depress the collet ring with two fingers and withdraw.

Nominal Size	2	4	5MM	6	8
Thread			M5 x .8		
MM					
BSPT	1/8 (2PT)	1/4 (4PT)		3/8 (6PT)	1/2 (8PT)
BSPP	1/8 (2PP)	1/4 (4PP)		3/8 (6PP)	1/2

- **Typical Application:** Compressed air, pneumatic instrumentation, circuit, lubricant and cooling lines.
- **Pressure:** Up to 250 psi depending on tube size.
- **Sealing Method:** O-Ring of Buna-N Construction. (Viton available on request by special order.)
- **Temperature Range:** -40°F to 200°F (-40°C to 93°C).
- **Material:** Brass, Nickel Plated.
- **Used With:** MTP160 nylon tubing. See page 28-32 for material compatibility and page 34 for plastic tubing.
- **Advantages:** Ease of assembly. No tools required, reusability of fittings and the time savings of assembly and disassembly.
- **Hex Dimensions:** All hexes are metric.
- **How to Order:** Individually by catalog number.
- **NOTE:** Refer to current price list for availability of cataloged items. Quotations and delivery of non-stock items supplied on request. Configurations and dimensions subject to change without notice.
- **Assembly Instructions**
 1. To connect, simply push the tubing into the fitting.
 2. To disconnect, depress the collet ring with two fingers and withdraw.

SUFFIX CHART

MM - Metric Screw Thread
MMS - Metric Screw Thread Swivel
MRP - Metric Red Plug
PP - British Parallel Plug
PPS - British Parallel Pipe Swivel
PT - British Tapered Pipe
PTS - British Tapered Pipe Swivel

- **Typical Application:** Compressed air, pneumatic instrumentation, circuit, lubricant and cooling lines. Also excellent for assembly equipment and cylinder control.
- **Pressure:** Up to 250 psi depending on tube size.
- **Sealing Method:** O-Ring of Buna-N Construction. (Viton available on request by special order.)
- **Temperature Range:** 0°F to +160°F (-17.8°C to +71°C)
- **Material:** Brass, Nickel Plated.
- **Used With:** PT230 and TP160 nylon, and PT240 Polyethylene tubing. See page 28-32 for material compatibility and pages 33-35 for plastic tubing.
- **Advantages:** Ease of assembly. No tools required, reusability of fittings and the time savings of assembly and disassembly. These flow controls have a simple design, but offer excellent ability to control the speed of a cylinder or motor.
- **Hex Dimensions:** All hexes are in inches.
- **How to Order:** Individually by catalog number.
- **NOTE:** Refer to current price list for availability of cataloged items. Quotations and delivery of non-stock items supplied on request. Configurations and dimensions subject to change without notice.
- **Assembly Instructions**
 1. To connect, simply push the tubing into the fitting.
 2. To disconnect, depress the collet ring with two fingers and withdraw.

Label Set: CL-499 (non-adhesive)

See Push > Connect®
Fittings on pages 66-70.

See Push > Connect®
Fittings on pages 71-74.

See Push > Connect®
Fittings on pages 75 & 76.

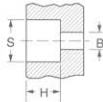
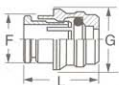
Cartridge

Cartridge body is not Nickel-plated.

Tube O.D.	Catalog Number	F	G	L	S	H	B
1/8	1161x2	.34	.35	.59	.344	.433	.14
5/32	1161x2.5	.34	.35	.57	.344	.433	.14
1/4	1161x4	.46	.48	.65	.470	.472	.16
5/16	1161x5	.54	.56	.67	.549	.551	.25
3/8	1161x6	.62	.64	.79	.627	.590	.32
1/2	1161x8	.74	.76	.83	.746	.629	.42

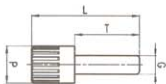
**Plug
(Plastic)**

Tube O.D.	Catalog Number	L	P	T
1/8	1129x2	1.04	.24	.65
5/32	1129x2.5	1.04	.24	.65
1/4	1129x4	1.10	.32	.71
5/16	1129x5	1.20	.39	.81
3/8	1129x6	1.38	.47	.91
1/2	1129x8	1.42	.55	.94

Double Union



NOTE: Joins Push>Connect® Fittings.

Tube O.D.	Catalog Number	L
1/8	1105x2	1.28
5/32	1105x2.5	1.28
1/4	1105x4	1.40
5/16	1105x5	1.59
3/8	1105x6	1.81
1/2	1105x8	1.89

Reducer

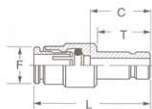

A

B

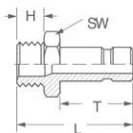

Tube O.D. A	Tube O.D. B	Catalog Number	C	F	L	T
1/8	1/4	1109x2x4	.79	.39	1.38	.71
5/32	1/4	1109x2.5x4	.79	.39	1.34	.71
1/4	3/8	1109x4x6	.86	.51	1.50	.91
1/4	1/2	1109x4x8	.86	.51	1.50	.91
3/8	1/2	1109x6x8	1.00	.67	1.80	.94

Stem Adapter



Tube O.D.	Male Pipe Thread	Catalog Number	H	T	L	SW (mm)
1/8	1/8	1180x2	.37	.65	1.20	12
1/8	1/4	1180x2x4	.51	.65	1.36	14
5/32	1/8	1180x2.5	.37	.65	1.20	12
5/32	1/4	1180x2.5x4	.51	.65	1.36	14
1/4	1/8	1180x4	.37	.71	1.26	12
1/4	1/4	1180x4x4	.51	.71	1.42	14
5/16	1/8	1180x5	.37	.81	1.36	12
5/16	1/4	1180x5x4	.51	.81	1.34	14
3/8	1/4	1180x6	.51	.91	1.61	17
3/8	3/8	1180x6x6	.51	.91	1.61	19
1/2	3/8	1180x8	.51	.94	1.65	19
1/2	1/2	1180x8x8	.71	.94	1.87	22

Union

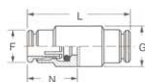

NOTE: Joins tubing.

Tube O.D.	Catalog Number	F	G	L	N
1/8	1162x2	.35	.39	1.26	.59
5/32	1162x2.5	.35	.39	1.18	.55
1/4	1162x4	.46	.47	1.40	.64
5/16	1162x5	.54	.55	1.23	.69
3/8	1162x6	.64	.67	1.67	.79
1/2	1162x8	.72	.75	1.75	.83

Bulkhead Union

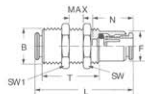

Tube O.D.	Catalog Number	B	F	L	N	MAX	SW (mm)	SW1 (mm)	T
1/8	1174x2	M10x1	.35	1.26	.59	.35	14	14	.83
5/32	1174x2.5	M10x1	.35	1.18	.55	.32	14	14	.79
1/4	1174x4	M14x1	.49	1.40	.64	.37	17	17	.83
5/16	1174x5	M16x1	.54	1.50	.69	.41	19	19	.83
3/8	1174x6	M18x1	.64	1.67	.77	.47	22	22	.93
1/2	1174x8	M20x1	.72	1.75	.83	.53	24	24	.98

Union "Y"

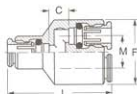

Tube O.D.	Catalog Number	C	F	L	M
1/8	1107x2	.24	.83	1.42	.39
5/32	1107x2.5	.24	.83	1.34	.39
1/4	1107x4	.24	.96	1.52	.49

NOTE: UNF thread seal with nylon washer included.

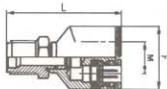
Swivel Male "Y"

*UNF Thread

NOTE: Swivel for installation purposes only.

Tube O.D.	Male Pipe Thread	Catalog Number	F	M	L
1/8	10-32*	1108x2AS	.83	.39	1.12
1/8	1/8	1108x2S	.83	.39	1.32
5/32	1/8	1108x2.5S	.83	.39	1.29
1/4	1/8	1108x4S	.96	.49	1.40

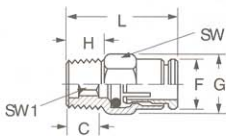
Male Connector

*UNF Thread

Allen wrench use permits close quarter installation not possible with a standard wrench.

Tube O.D.	Male Pipe Thread	Catalog Number	C	F	G	H	L	SW (mm)	SW1 (mm)
1/8	10-32*	1168x2A	.26	.35	.41	.18	.85	9	2
1/8	1/8	1168x2	.26	.35	.55	.37	.85	12	2
1/8	1/4	1168x2x4	.39	.35	.63	.51	.98	14	2
5/32	10-32*	1168x2.5A	.26	.35	.41	.18	.81	9	2
5/32	1/8	1168x2.5	.26	.35	.55	.37	.81	12	2.5
5/32	1/4	1168x2.5x4	.39	.35	.63	.51	.94	14	2.5
1/4	10-32*	1168x4A	.27	.46	.55	.18	.91	12	2
1/4	1/8	1168x4	.35	.46	.55	.37	.98	12	4
1/4	1/4	1168x4x4	.44	.46	.63	.51	1.08	14	4
1/4	3/8	1168x4x6	.46	.46	.87	.51	1.10	19	4
5/16	1/8	1168x5	.45	.54	.63	.37	1.14	14	5
5/16	1/4	1168x5x4	.45	.54	.63	.51	1.14	14	6
5/16	3/8	1168x5x6	.45	.54	.87	.51	1.14	19	6
3/8	1/8	1168x6x2	.59	.64	.78	.51	1.38	17	7
3/8	1/4	1168x6	.59	.64	.78	.51	1.38	17	7
3/8	3/8	1168x6x6	.39	.64	.87	.51	1.18	19	7
3/8	1/2	1168x6x8	.47	.64	1.00	.71	1.26	22	7
1/2	3/8	1168x8	.53	.72	.87	.51	1.36	19	10
1/2	1/2	1168x8x8	.53	.72	1.00	.71	1.36	22	10

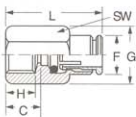
Female Connector

Tube O.D.	Fem. Pipe Thread	Catalog Number	C	F	G	H	L	SW (mm)
1/8	1/8	1166x2	.41	.35	.64	.34	1.00	14
1/8	1/4	1166x2x4	.55	.35	.78	.47	1.14	17
5/32	1/8	1166x2.5	.41	.35	.64	.34	.96	14
5/32	1/4	1166x2.5x4	.55	.35	.78	.47	1.10	17
1/4	1/8	1166x4	.43	.46	.64	.34	1.06	14
1/4	1/4	1166x4x4	.56	.46	.78	.47	1.20	17
3/8	1/4	1166x6	.57	.64	.78	.47	1.36	17
3/8	3/8	1166x6x6	.59	.64	1.00	.49	1.38	22

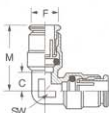
Union Elbow

Tube O.D.	Catalog Number	C	F	M	SW (mm)
1/8	1165x2	.24	.39	.83	9
5/32	1165x2.5	.24	.39	.79	9
1/4	1165x4	.27	.50	.91	10
5/16	1165x5	.30	.59	.98	12
3/8	1165x6	.34	.69	1.12	14
1/2	1165x8	.39	.77	1.22	17

NOTE: UNF Thread seals with nylon washer, included.

Swivel Male Elbow

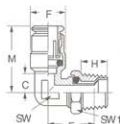

*UNF Thread

NOTE: Swivel for installation purposes only.

Tube O.D.	Male Pipe Thread	Catalog Number	C	E	F	H	M	SW (mm)	SW1 (mm)
1/8	10-32*	1169x2AS	.24	.53	.39	.18	.83	9	8
1/8	1/8	1169x2S	.24	.71	.39	.37	.83	9	12
1/8	1/4	1169x2x4S	.24	.87	.39	.51	.83	9	14
5/32	10-32*	1169x2.5AS	.24	.53	.39	.18	.79	9	8
5/32	1/8	1169x2.5S	.24	.71	.39	.37	.79	9	12
5/32	1/4	1169x2.5x4S	.24	.87	.39	.51	.83	9	14
1/4	1/8	1169x4S	.27	.73	.50	.37	.91	10	12
1/4	1/4	1169x4x4S	.27	.81	.50	.51	.91	10	14
1/4	3/8	1169x4x6S	.29	.87	.50	.51	.93	12	19
5/16	1/8	1169x5S	.30	.77	.59	.37	.98	12	12
5/16	1/4	1169x5x4S	.30	.85	.59	.51	.98	12	14
5/16	3/8	1169x5x6S	.30	.87	.59	.51	.98	12	19
3/8	1/8	1169x6x2S	.34	.75	.64	.20	1.10	14	14
3/8	1/4	1169x6S	.34	.89	.69	.51	1.12	14	14
3/8	3/8	1169x6x6S	.34	.91	.69	.51	1.12	14	19
3/8	1/2	1169x6x8S	.34	1.04	.69	.71	1.12	14	22
1/2	1/4	1169x8x4S	.39	.95	.77	.51	1.22	17	14
1/2	3/8	1169x8S	.39	.95	.77	.51	1.22	17	19
1/2	1/2	1169x8x8S	.39	1.12	.77	.71	1.22	17	22

Male Elbow

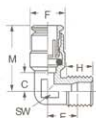

Tube O.D.	Male Pipe Thread	Catalog Number	C	E	F	H	M	SW (mm)
1/4	1/8	1169x4	.27	.53	.50	.38	.91	10
1/4	1/4	1169x4x4	.27	.59	.50	.51	.91	10
3/8	1/4	1169x6	.34	.69	.69	.51	1.12	14
3/8	3/8	1169x6x6	.34	.69	.69	.51	1.12	14

Union Tee



Tube O.D.	Catalog Number	C	F	L	M	SW (mm)
1/8	1164x2	.24	.39	1.65	.83	9
5/32	1164x2.5	.24	.39	1.57	.79	9
1/4	1164x4	.27	.50	1.81	.91	10
5/16	1164x5	.30	.59	1.97	.98	12
3/8	1164x6	.34	.69	2.24	1.12	14
1/2	1164x8	.39	.77	2.44	1.22	19

Male Run Tee Swivel

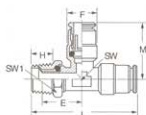

*UNF Thread

NOTE: Swivel for installation purposes only.

Tube O.D.	Male Pipe Thread	Catalog Number	E	F	H	L	M	SW (mm)	SW1 (mm)
1/8	10-32*	1171x2AS	.53	.39	.18	1.53	.83	9	8
1/8	1/8	1171x2S	.59	.35	.20	1.59	.80	9	12
5/32	10-32*	1171x2.5AS	.53	.39	.18	1.50	.79	9	8
5/32	1/8	1171x2.5S	.59	.35	.20	1.57	.79	9	12
5/32	1/4	1171x2.5x4S	.63	.35	.26	1.67	.79	9	14
1/4	1/8	1171x4S	.61	.46	.20	1.69	.89	10	12
1/4	1/4	1171x4x4S	.65	.46	.26	1.79	.89	10	14
1/4	3/8	1171x4x6S	.65	.46	.29	1.83	.89	12	19
3/8	1/4	1171x6S	.77	.64	.26	2.17	1.10	14	14
3/8	3/8	1171x6x6S	.77	.64	.29	2.26	1.10	14	19
3/8	1/2	1171x6x8S	.79	.64	.34	2.22	1.10	14	22
1/2	1/4	1171x8x4S	.81	.72	.26	2.26	1.20	17	13
1/2	3/8	1171x8S	.81	.72	.29	2.30	1.20	17	19
1/2	1/2	1171x8x8S	.83	.72	.34	2.36	1.20	17	22

NOTE: UNF Thread seals with nylon washer, included.

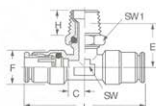
Male Branch Tee Swivel

*UNF Thread

NOTE: Swivel for installation purposes only.

Tube O.D.	Male Pipe Thread	Catalog Number	C	E	F	H	L	SW (mm)	SW1 (mm)
1/8	10-32*	1172x2AS	.24	.53	.39	.18	1.61	.35	.32
1/8	1/8	1172x2S	.24	.59	.35	.20	1.57	.35	.47
5/32	10-32*	1172x2.5AS	.24	.53	.39	.18	1.57	.35	.32
5/32	1/8	1172x2.5S	.24	.59	.35	.20	1.57	.35	.47
5/32	1/4	1172x2.5x4S	.24	.63	.35	.26	1.57	.35	.55
1/4	1/8	1172x4S	.28	.60	.46	.20	1.77	.39	.47
1/4	1/4	1172x4x4S	.28	.65	.46	.26	1.77	.39	.55
1/4	3/8	1172x4x6S	.28	.65	.46	.29	1.77	.47	.75
3/8	1/4	1172x6S	.34	.77	.64	.26	2.20	.55	.55
3/8	3/8	1172x6x6S	.34	.77	.64	.29	2.20	.55	.75
3/8	1/2	1172x6x8S	.34	.79	.64	.34	2.20	.55	.87
1/2	1/4	1172x8x4S	.39	.80	.72	.26	2.40	.67	.55
1/2	3/8	1172x8S	.39	.80	.72	.29	2.40	.67	.75
1/2	1/2	1172x8x8S	.39	.83	.72	.34	2.40	.67	.87

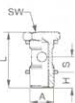
Stud Manifolds

*UNF Thread

Male Pipe Thread A	Catalog Number	H	L	S (mm)	SW (mm)
10-32*	1184x1xA	.16	.71	.18	.32
1/8	1184x1x2	.24	1.06	.34	.55
1/4	1184x1x4	.35	1.16	.34	.67
3/8	1184x1x6	.35	1.18	.34	.75

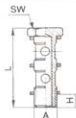
Stud Manifolds

Male Pipe Thread A	Catalog Number	H	L	SW (mm)
1/8	1185x2x2	.24	1.69	.55
1/4	1185x2x4	.32	1.79	.67
3/8	1185x2x6	.32	1.81	.75

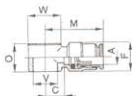
Banjo

Tube O.D. A	Catalog Number	C	F	M	O	V	W
5/32	1181x2.5A	.20	.35	.75	.35	.20	.35
1/8	1181x2x2	.32	.39	.89	.57	.39	.55
5/32	1181x2.5x2	.32	.39	.89	.57	.39	.55
1/4	1181x4x2	.35	.50	.98	.57	.39	.55
1/4	1181x4x4	.43	.50	1.06	.57	.52	.71
3/8	1181x6x4	.39	.69	1.18	.57	.52	.71
3/8	1181x6x6	.45	.69	1.24	.57	.66	.83

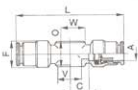
Double Banjo

Tube O.D. A	Catalog Number	C	F	L	O	V	W
5/32	1182x2.5A	.20	.35	1.50	.35	.21	.35
1/4	1182x4x2	.32	.51	1.89	.57	.39	.55
1/4	1182x4x4	.39	.51	2.09	.57	.52	.71
3/8	1182x6x4	.39	.69	2.32	.57	.52	.71
3/8	1182x6x6	.45	.69	2.44	.57	.66	.83

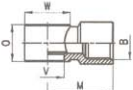
Female Banjo

*UNF Thread

Female Pipe Thread B	Catalog Number	V	O	M	W
10-32*	1183xAxA	10-32	.35	.41	.35
1/8	1183x2x2	1/8	.57	.83	.55
1/4	1183x4x4	1/4	.57	1.02	.71
3/8	1183x6x6	3/8	.57	1.12	.83

NOTE: UNF Thread seals with nylon washer, included.