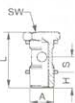

Male Branch Tee Swivel

*UNF Thread

NOTE: Swivel for installation purposes only.

Tube O.D.	Male Pipe Thread	Catalog Number	C	E	F	H	L	SW (mm)	SW1 (mm)
1/8	10-32*	1172x2AS	.24	.53	.39	.18	1.61	.35	.32
1/8	1/8	1172x2S	.24	.59	.35	.20	1.57	.35	.47
5/32	10-32*	1172x2.5AS	.24	.53	.39	.18	1.57	.35	.32
5/32	1/8	1172x2.5S	.24	.59	.35	.20	1.57	.35	.47
5/32	1/4	1172x2.5x4S	.24	.63	.35	.26	1.57	.35	.55
1/4	1/8	1172x4S	.28	.60	.46	.20	1.77	.39	.47
1/4	1/4	1172x4x4S	.28	.65	.46	.26	1.77	.39	.55
1/4	3/8	1172x4x6S	.28	.65	.46	.29	1.77	.47	.75
3/8	1/4	1172x6S	.34	.77	.64	.26	2.20	.55	.55
3/8	3/8	1172x6x6S	.34	.77	.64	.29	2.20	.55	.75
3/8	1/2	1172x6x8S	.34	.79	.64	.34	2.20	.55	.87
1/2	1/4	1172x8x4S	.39	.80	.72	.26	2.40	.67	.55
1/2	3/8	1172x8S	.39	.80	.72	.29	2.40	.67	.75
1/2	1/2	1172x8x8S	.39	.83	.72	.34	2.40	.67	.87

Stud Manifolds

*UNF Thread

Male Pipe Thread A	Catalog Number	H	L	S (mm)	SW (mm)
10-32*	1184x1xA	.16	.71	.18	.32
1/8	1184x1x2	.24	1.06	.34	.55
1/4	1184x1x4	.35	1.16	.34	.67
3/8	1184x1x6	.35	1.18	.34	.75

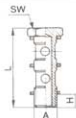
Stud Manifolds

Male Pipe Thread A	Catalog Number	H	L	SW (mm)
1/8	1185x2x2	.24	1.69	.55
1/4	1185x2x4	.32	1.79	.67
3/8	1185x2x6	.32	1.81	.75

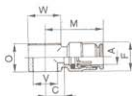
Banjo

Tube O.D. A	Catalog Number	C	F	M	O	V	W
5/32	1181x2.5A	.20	.35	.75	.35	.20	.35
1/8	1181x2x2	.32	.39	.89	.57	.39	.55
5/32	1181x2.5x2	.32	.39	.89	.57	.39	.55
1/4	1181x4x2	.35	.50	.98	.57	.39	.55
1/4	1181x4x4	.43	.50	1.06	.57	.52	.71
3/8	1181x6x4	.39	.69	1.18	.57	.52	.71
3/8	1181x6x6	.45	.69	1.24	.57	.66	.83

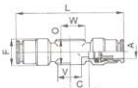
Double Banjo

Tube O.D. A	Catalog Number	C	F	L	O	V	W
5/32	1182x2.5A	.20	.35	1.50	.35	.21	.35
1/4	1182x4x2	.32	.51	1.89	.57	.39	.55
1/4	1182x4x4	.39	.51	2.09	.57	.52	.71
3/8	1182x6x4	.39	.69	2.32	.57	.52	.71
3/8	1182x6x6	.45	.69	2.44	.57	.66	.83

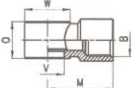
Female Banjo

*UNF Thread

Female Pipe Thread B	Catalog Number	V	O	M	W
10-32*	1183xAxA	10-32	.35	.41	.35
1/8	1183x2x2	1/8	.57	.83	.55
1/4	1183x4x4	1/4	.57	1.02	.71
3/8	1183x6x6	3/8	.57	1.12	.83

NOTE: UNF Thread seals with nylon washer, included.



DC-121 • PLASTIC DRAIN COCK ASSORTMENT

To address your plastic drain cock needs, Weatherhead now offers a full assortment of domestic and offshore drain cocks. This kit comes complete with a plastic box and a label with part number and application information.

Catalog Number	Qty.	Catalog Number	Qty.	Catalog Number	Qty.
110	2	113	2	116	2
111	2	114	2	117	2
112	2	115	2	135	2
				145	2

PC-48 • PUSH > CONNECT FITTINGS ASSORTMENT

Weatherhead PUSH > CONNECT fittings are designed for quick assembly without the need for a wrench. Ideal for pneumatic applications where space is tight. Then fittings are also easily disconnected; simply depress the collet ring with two fingers and withdraw the tube. The PC-48 provides the 48 most popular PUSH > CONNECT fittings in a compact, handy plastic box to make your assortment organized and accessible.



Catalog Number	Qty.	Catalog Number	Qty.	Catalog Number	Qty.
1162x2	5	1168x2.5A	5	1169x4S	5
1162x4	5	1168x2.5x4	5	1169x4x4S	5
1162x6	5	1168x2x4	5	1169x4x6S	5
1164x2.5	5	1168x4	5	1169x6S	5
1164x4	5	1168x4A	5	1169x6x6S	5
1164x6	5	1168x4x4	5	1169x8S	2
1164x8	2	1168x4x6	5	1169x8x4S	2
1165x2.5	5	1168x5	5	1171x4S	5
1165x4	5	1168x5x4	5	1171x4x4S	5
1165x6	5	1168x6	5	1171x6S	5
1165x8	2	1168x6x6	5	1172x4S	5
1166x4	5	1168x6x8	2	1172x4x4S	5
1166x4x4	5	1168x8	5	1174x2	5
1166x6	5	1168x8x8	2	1174x4	5
1166x6x6	2	1169x2.5S	5	CL-499	1
1168x2	2	1169x2S	5	FC-16X	1
1168x2.5	5	1169x2x4S	5		