

Cartridge

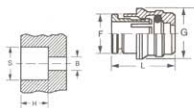

| Tube O.D. (mm) | Catalog Number | F | G | L | S | H | B |
|----------------|----------------|------|------|------|-------|------|-----|
| 4 | 1161x4M | 8.6 | 9.0 | 14.5 | 8.75 | 11.0 | 3.5 |
| 5 | 1161x5M | 9.6 | 10.0 | 15.5 | 9.75 | 11.5 | 3.5 |
| 6 | 1161x6M | 11.8 | 12.2 | 16.5 | 11.95 | 12.0 | 4.0 |
| 8 | 1161x8M | 13.8 | 14.2 | 18.0 | 13.95 | 14.0 | 6.0 |
| 10 | 1161x10M | 15.8 | 16.2 | 20.5 | 15.95 | 15.0 | 8.0 |

Plug (plastic)

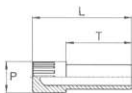

| Tube O.D. (mm) | Catalog Number | L | P | T |
|----------------|----------------|------|----|------|
| 4 | 1129x4MRP | 25.0 | 8 | 16.0 |
| 5 | 1129x5MRP | 25.5 | 8 | 16.5 |
| 6 | 1129x6MRP | 26.5 | 8 | 17.5 |
| 8 | 1129x8MRP | 29.5 | 12 | 19.5 |
| 10 | 1129x10MRP | 32.0 | 12 | 19.5 |
| 12 | 1129x12MRP | 35.5 | 16 | 23.5 |

Double Union

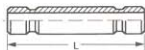

NOTE: Joins Metric Push>Connect® fittings.

| Tube O.D. (mm) | Catalog Number | L |
|----------------|----------------|------|
| 4 | 1105x4M | 32.5 |
| 5 | 1105x5M | 35.0 |
| 6 | 1105x6M | 35.5 |
| 8 | 1105x8M | 40.5 |
| 10 | 1105x10M | 46.0 |
| 12 | 1105x12M | 48.0 |

Reducer

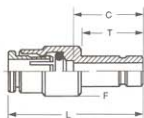

| Tube O.D. A (mm) | Tube O.D. B (mm) | Catalog Number | C | F | L | T |
|------------------|------------------|----------------|------|----|------|------|
| 4 | 5 | 1109x4Mx5M | 20.0 | 10 | 34.0 | 18.0 |
| 4 | 6 | 1109x4Mx6M | 20.0 | 10 | 34.0 | 18.0 |
| 4 | 8 | 1109x4Mx8M | 19.0 | 10 | 33.0 | 20.5 |
| 5 | 6 | 1109x5Mx6M | 20.0 | 11 | 35.0 | 18.0 |
| 5 | 8 | 1109x5Mx8M | 19.0 | 11 | 34.0 | 20.5 |
| 6 | 8 | 1109x6Mx8M | 22.5 | 13 | 38.5 | 20.5 |
| 6 | 10 | 1109x6Mx10M | 21.0 | 13 | 36.5 | 23.0 |
| 6 | 12 | 1109x6Mx12M | 22.0 | 13 | 37.5 | 24.0 |
| 8 | 10 | 1109x8Mx10M | 25.0 | 14 | 42.5 | 23.0 |
| 8 | 12 | 1109x8Mx12M | 22.5 | 14 | 40.0 | 24.0 |
| 10 | 12 | 1109x10Mx12M | 25.5 | 17 | 45.5 | 24.0 |

Stem Adapter



| Tube O.D. (mm) | Thd. Size BSPP D | Catalog Number | H | T | L | SW (mm) |
|----------------|------------------|----------------|-----|------|------|---------|
| 4 | 1/8 | 1180x4Mx2PP | 5.5 | 16.5 | 27.8 | 12 |
| 5 | 1/8 | 1180x5Mx2PP | 5.5 | 18.0 | 29.3 | 12 |
| 6 | 1/8 | 1180x6Mx2PP | 5.5 | 18.0 | 29.3 | 12 |
| 6 | 1/4 | 1180x6Mx4PP | 7.0 | 18.0 | 31.0 | 14 |
| 8 | 1/8 | 1180x8Mx2PP | 5.5 | 20.5 | 31.8 | 12 |
| 8 | 1/4 | 1180x8Mx4PP | 7.0 | 20.5 | 33.5 | 14 |
| 10 | 1/4 | 1180x10Mx4PP | 7.0 | 23.0 | 36.0 | 14 |
| 10 | 3/8 | 1180x10Mx6PP | 8.0 | 23.0 | 37.3 | 19 |
| 12 | 3/8 | 1180x12Mx6PP | 8.0 | 24.0 | 38.3 | 19 |

Union

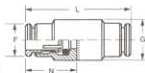

NOTE: Joins metric tubing.

| Tube O.D. (mm) | Catalog Number | F | G | L | N |
|----------------|----------------|------|----|------|------|
| 4 | 1162x4M | 8.8 | 10 | 30.0 | 14.0 |
| 5 | 1162x5M | 9.8 | 11 | 33.0 | 15.0 |
| 6 | 1162x6M | 11.7 | 12 | 34.0 | 15.5 |
| 8 | 1162x8M | 13.7 | 14 | 38.0 | 17.5 |
| 10 | 1162x10M | 16.3 | 17 | 41.5 | 19.5 |
| 12 | 1162x12M | 18.3 | 19 | 44.5 | 21.0 |

Bulkhead Union

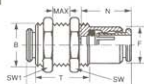

| Tube O.D. (mm) | Catalog Number | B | F | L | N | MAX | SW | SW1 | T |
|----------------|----------------|-------|------|------|------|------|----|-----|------|
| 4 | 1174x4M | M10x1 | 8.6 | 30.0 | 14.0 | 10.5 | 14 | 14 | 20.0 |
| 5 | 1174x5M | M12x1 | 9.8 | 33.0 | 14.5 | 10.5 | 17 | 17 | 20.0 |
| 6 | 1174x6M | M14x1 | 12.5 | 34.0 | 15.5 | 10.5 | 17 | 17 | 20.0 |
| 8 | 1174x8M | M16x1 | 14.5 | 38.0 | 17.5 | 11.5 | 19 | 19 | 21.0 |
| 10 | 1174x10M | M18x1 | 16.3 | 42.5 | 20.0 | 13.0 | 22 | 22 | 23.5 |
| 12 | 1174x12M | M20x1 | 18.3 | 44.5 | 21.0 | 14.5 | 24 | 24 | 25.0 |

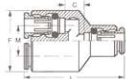
Union "Y"

| Tube O.D. (mm) | Catalog Number | F | C | L | M |
|----------------|----------------|------|------|------|------|
| 4 | 1107x4M | 18.0 | 6.0 | 33.0 | 10.0 |
| 6 | 1107x6M | 24.5 | 7.0 | 39.0 | 12.5 |
| 8 | 1107x8M | 29.5 | 9.0 | 44.0 | 14.5 |
| 10 | 1107x10M | 33.5 | 15.5 | 53.5 | 16.0 |

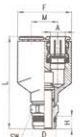
Male "Y"

| Tube O.D. (mm) A | Thread Size BSP D | Catalog Number | F | H | M | L | SW (mm) |
|------------------|-------------------|----------------|------|-----|------|------|---------|
| 4 | 1/8 | 1108x4Mx2PT | 18.0 | 5.5 | 10.0 | 38.0 | 12 |
| 4 | M5* | 1108x4Mx5MM | 18.0 | — | 10.0 | 27.0 | N/A |
| 6 | 1/8 | 1108x6Mx2PT | 24.5 | 5.5 | 12.5 | 41.5 | 12 |
| 6 | M5* | 1108x6Mx5MM | 24.5 | — | 12.5 | 31.0 | N/A |
| 8 | 1/8 | 1108x8Mx2PT | 29.5 | 5.5 | 14.5 | 48.5 | 14 |
| 8 | 1/4 | 1108x8Mx4PT | 29.5 | 7.0 | 14.5 | 50.0 | 14 |

*M5 metric screw thread.

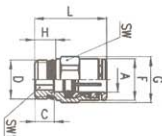
Male Connector (Universal BSPT/BSPP)

Allen wrench use permits close quarter installation not possible with a standard wrench.

| Tube O.D. (mm) A | Thread Size BSP D | Catalog Number | C | F | G | H | L | SW (mm) | SW1 (mm) |
|------------------|-------------------|----------------|------|------|------|-----|------|---------|----------|
| 4 | 1/8 | 1168x4Mx2PT | 3.8 | 8.8 | 13.2 | 5.5 | 18.0 | 12 | 2.5 |
| 4 | 1/4 | 1168x4Mx4PT | 6.0 | 8.8 | 15.2 | 7.0 | 19.5 | 14 | 2.5 |
| 5 | 1/8 | 1168x5Mx2PT | 3.8 | 9.8 | 13.2 | 5.5 | 19.0 | 12 | 3.0 |
| 5 | 1/4 | 1168x5Mx4PT | 5.5 | 9.8 | 15.2 | 7.0 | 20.0 | 14 | 3.0 |
| 6 | 1/8 | 1168x6Mx2PT | 5.0 | 11.7 | 13.2 | 5.5 | 20.5 | 12 | 4.0 |
| 6 | 1/4 | 1168x6Mx4PT | 5.5 | 11.7 | 15.2 | 7.0 | 21.0 | 14 | 4.0 |
| 8 | 1/8 | 1168x8Mx2PT | 7.5 | 13.7 | 15.2 | 5.5 | 25.0 | 14 | 5.0 |
| 8 | 1/4 | 1168x8Mx4PT | 6.5 | 13.7 | 15.2 | 7.0 | 24.0 | 14 | 6.0 |
| 8 | 3/8 | 1168x8Mx6PT | 6.5 | 13.7 | 20.5 | 8.0 | 23.5 | 19 | 6.0 |
| 10 | 1/4 | 1168x10Mx4PT | 8.5 | 16.3 | 18.5 | 7.0 | 28.5 | 17 | 7.0 |
| 10 | 3/8 | 1168x10Mx6PT | 5.5 | 16.3 | 20.5 | 8.0 | 25.5 | 19 | 8.0 |
| 10 | 1/2 | 1168x10Mx8PT | 5.0 | 16.3 | 24.5 | 9.0 | 25.0 | 22 | 8.0 |
| 12 | 1/4 | 1168x12Mx4PT | 10.5 | 18.3 | 20.5 | 7.0 | 31.5 | 19 | 7.0 |
| 12 | 3/8 | 1168x12Mx6PT | 9.5 | 18.3 | 20.5 | 8.0 | 30.5 | 19 | 9.0 |
| 12 | 1/2 | 1168x12Mx8PT | 6.0 | 18.3 | 24.5 | 9.0 | 27.0 | 22 | 10.0 |

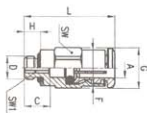
Male Connector (BSPP)

*M5 metric screw thread.

Allen wrench use permits close quarter installation not possible with a standard wrench.

| Tube O.D. (mm) A | Thread Size BSPP D | Catalog Number | C | F | G | H | L | SW (mm) | SW1 (mm) |
|------------------|--------------------|----------------|-----|------|------|-----|------|---------|----------|
| 4 | M5* | 1168x4Mx5MM | 5.5 | 7.8 | 8.8 | 3.5 | 19.5 | 8 | 2 |
| 5 | M5* | 1168x5Mx5MM | 5.5 | 8.8 | 9.9 | 3.5 | 20.5 | 9 | 2 |
| 6 | M5* | 1168x6Mx5MM | 5.5 | 11.7 | 13.2 | 3.5 | 21.5 | 12 | 2 |

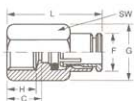
Female Connector (BSPP)

*M5 is M profile thread.

| Tube O.D. (mm) | Thread Size BSPP | Catalog Number | C | F | G | H | L | SW (mm) |
|----------------|------------------|----------------|------|------|------|------|------|---------|
| 4 | 1/8 | 1166x4Mx2PP | 9.5 | 9.0 | 15.2 | 7.5 | 23.5 | 14 |
| 4 | M5* | 1166x4Mx5MM | 6.5 | 8.8 | 9.9 | 5.0 | 20.5 | 9 |
| 6 | 1/8 | 1166x6Mx2PP | 9.5 | 11.7 | 15.2 | 7.5 | 25.5 | 14 |
| 6 | 1/4 | 1166x6Mx4PP | 13.0 | 11.7 | 18.5 | 11.0 | 29.0 | 17 |
| 8 | 1/8 | 1166x8Mx2PP | 10.0 | 13.7 | 15.3 | 7.5 | 27.5 | 14 |
| 8 | 1/4 | 1166x8Mx4PP | 13.5 | 13.7 | 18.5 | 11.0 | 31.0 | 17 |
| 10 | 1/4 | 1166x10Mx4PP | 13.5 | 16.3 | 18.5 | 11.0 | 33.0 | 17 |

NOTE: M5 has 0.8 mm thread pitch. M5 seals with nylon washer, included.

Union Elbow

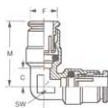

| Tube O.D. (mm) | Catalog Number | C | F | M | SW (mm) |
|----------------|----------------|------|------|----|---------|
| 4 | 1165x4M | 6.0 | 10.0 | 20 | 9 |
| 5 | 1165x5M | 6.0 | 11.0 | 21 | 9 |
| 6 | 1165x6M | 6.5 | 13.0 | 22 | 10 |
| 8 | 1165x8M | 7.5 | 15.0 | 25 | 12 |
| 10 | 1165x10M | 8.5 | 17.5 | 28 | 14 |
| 12 | 1165x12M | 10.0 | 19.5 | 31 | 16 |

Male Elbow (BSPT)

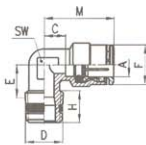

| Tube O.D. A (mm) | Thread Size BSPT D | Catalog Number | C | E | F | H | M | SW (mm) |
|------------------|--------------------|----------------|------|------|------|------|----|---------|
| 4 | 1/8 | 1169x4Mx2PT | 6.0 | 14.5 | 10.0 | 7.5 | 20 | 9 |
| 4 | 1/4 | 1169x4Mx4PT | 6.0 | 14.5 | 10.0 | 11.0 | 20 | 9 |
| 5 | 1/8 | 1169x5Mx2PT | 6.0 | 14.5 | 11.0 | 7.5 | 21 | 9 |
| 5 | 1/4 | 1169x5Mx4PT | 6.0 | 14.5 | 11.0 | 11.0 | 21 | 9 |
| 6 | 1/8 | 1169x6Mx2PT | 6.5 | 15.0 | 12.7 | 8.5 | 22 | 10 |
| 6 | 1/4 | 1169x6Mx4PT | 6.5 | 15.0 | 12.7 | 11.5 | 22 | 10 |
| 8 | 1/8 | 1169x8Mx2PT | 7.5 | 16.0 | 15.0 | 8.5 | 25 | 12 |
| 8 | 1/4 | 1169x8Mx4PT | 7.5 | 16.0 | 15.0 | 11.0 | 25 | 12 |
| 8 | 3/8 | 1169x8Mx6PT | 7.5 | 16.3 | 15.0 | 11.5 | 25 | 12 |
| 10 | 1/4 | 1169x10Mx4PT | 7.5 | 18.5 | 17.5 | 11.5 | 27 | 14 |
| 10 | 3/8 | 1169x10Mx6PT | 7.5 | 19.0 | 17.5 | 11.5 | 27 | 14 |
| 12 | 1/4 | 1169x12Mx4PT | 10.0 | 20.0 | 19.5 | 11.5 | 31 | 16 |
| 12 | 3/8 | 1169x12Mx6PT | 10.0 | 20.0 | 19.5 | 11.5 | 31 | 16 |

Male Elbow Swivel (Universal BSPT/BSPP)

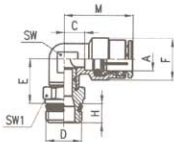

| Tube O.D. A (mm) | Thread Size BSPT D | Catalog Number | C | E | F | H | M | SW | SW1 (mm) |
|------------------|--------------------|----------------|------|------|------|-----|------|----|----------|
| 4 | 1/8 | 1169x4Mx2PTS | 6.0 | 14.5 | 10.0 | 5.5 | 20.0 | 9 | 12 |
| 4 | 1/4 | 1169x4Mx4PTS | 6.0 | 14.5 | 10.0 | 7.0 | 20.0 | 9 | 14 |
| 5 | 1/8 | 1169x5Mx2PTS | 6.0 | 14.5 | 11.0 | 5.5 | 21.0 | 9 | 12 |
| 5 | 1/4 | 1169x5Mx4PTS | 6.0 | 14.5 | 11.0 | 7.0 | 21.0 | 9 | 14 |
| 6 | 1/8 | 1169x6Mx2PTS | 6.5 | 15.0 | 12.7 | 5.5 | 22.0 | 10 | 12 |
| 6 | 1/4 | 1169x6Mx4PTS | 6.5 | 15.0 | 12.7 | 7.0 | 22.5 | 10 | 14 |
| 8 | 1/8 | 1169x8Mx2PTS | 7.5 | 16.0 | 15.0 | 5.5 | 25.5 | 12 | 12 |
| 8 | 1/4 | 1169x8Mx4PTS | 7.5 | 16.0 | 15.0 | 7.0 | 25.0 | 12 | 14 |
| 8 | 3/8 | 1169x8Mx6PTS | 7.5 | 16.5 | 15.0 | 8.0 | 25.0 | 12 | 19 |
| 10 | 1/4 | 1169x10Mx4PTS | 8.5 | 18.5 | 17.5 | 7.0 | 28.5 | 14 | 14 |
| 10 | 3/8 | 1169x10Mx6PTS | 8.5 | 19.0 | 17.5 | 8.0 | 28.5 | 14 | 19 |
| 10 | 1/2 | 1169x10Mx8PTS | 8.5 | 19.5 | 17.5 | 9.0 | 28.5 | 14 | 22 |
| 12 | 1/4 | 1169x12Mx4PTS | 10.0 | 20.0 | 19.5 | 7.0 | 31.0 | 16 | 17 |
| 12 | 3/8 | 1169x12Mx6PTS | 10.0 | 20.0 | 19.5 | 8.0 | 31.0 | 16 | 19 |
| 12 | 1/2 | 1169x12Mx8PTS | 10.0 | 20.5 | 19.5 | 9.0 | 31.0 | 16 | 22 |

NOTE: Swivel for installation purposes only.

Male Elbow Swivel (BSPP)

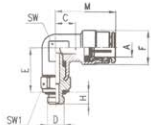

| Tube O.D. A (mm) | Thread Size BSPP D | Catalog Number | C | E | F | H | M | SW | SW1 (mm) |
|------------------|--------------------|----------------|---|----|----|-----|----|----|----------|
| 4 | M5* | 1169x4Mx5MMS | 6 | 13 | 10 | 3.5 | 20 | 9 | 8 |
| 5 | M5* | 1169x5Mx5MMS | 6 | 13 | 11 | 3.5 | 21 | 9 | 8 |

NOTE: Swivel for installation purposes only.
*M5 metric screw thread.

Union Tee



| Tube O.D. (mm) | Catalog Number | C | F | L | M | SW (mm) |
|----------------|----------------|------|------|----|------|---------|
| 4 | 1164x4M | 6.0 | 10.0 | 40 | 20.0 | 9 |
| 5 | 1164x5M | 6.0 | 11.0 | 42 | 21.0 | 9 |
| 6 | 1164x6M | 6.5 | 12.7 | 45 | 22.5 | 10 |
| 8 | 1164x8M | 7.5 | 15.0 | 50 | 25.0 | 12 |
| 10 | 1164x10M | 8.5 | 17.5 | 57 | 28.5 | 14 |
| 12 | 1164x12M | 10.0 | 19.5 | 62 | 31.0 | 16 |

NOTE: M5 has 0.8 mm thread pitch. M5 seals with nylon washer, included.

Male Run Tee Swivel (Universal BSPT/BSPP)

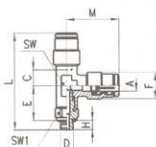

NOTE: Swivel for installation purposes only.

| Tube O.D. A (mm) | Thread Size BSP D | Catalog Number | C | E | F | H | L | M | SW | SW1 (mm) |
|------------------|-------------------|----------------|------|------|------|-----|------|------|----|----------|
| 4 | 1/8 | 1171x4Mx2PTS | 6.0 | 14.5 | 10.0 | 5.5 | 40.0 | 20.0 | 9 | 12 |
| 5 | 1/8 | 1171x5Mx2PTS | 6.0 | 14.5 | 11.0 | 5.5 | 41.0 | 21.0 | 9 | 12 |
| 5 | 1/4 | 1171x5Mx4PTS | 6.0 | 14.5 | 11.0 | 7.0 | 42.5 | 21.0 | 9 | 14 |
| 6 | 1/8 | 1171x6Mx2PTS | 6.5 | 15.0 | 12.7 | 5.5 | 42.5 | 22.5 | 10 | 12 |
| 6 | 1/4 | 1171x6Mx4PTS | 6.5 | 15.0 | 12.7 | 7.0 | 44.0 | 22.5 | 10 | 14 |
| 8 | 1/8 | 1171x8Mx2PTS | 7.5 | 16.0 | 15.0 | 5.5 | 46.5 | 25.0 | 12 | 12 |
| 8 | 1/4 | 1171x8Mx4PTS | 7.5 | 16.0 | 15.0 | 7.0 | 48.0 | 25.0 | 12 | 14 |
| 8 | 3/8 | 1171x8Mx6PTS | 7.5 | 16.5 | 15.0 | 8.0 | 49.5 | 25.0 | 12 | 19 |
| 10 | 1/4 | 1171x10Mx4PTS | 8.5 | 18.5 | 17.5 | 7.0 | 54.0 | 28.5 | 14 | 14 |
| 10 | 3/8 | 1171x10Mx6PTS | 8.5 | 18.5 | 17.5 | 8.0 | 55.5 | 28.5 | 14 | 19 |
| 12 | 3/8 | 1171x12Mx6PTS | 10.0 | 19.5 | 19.5 | 8.0 | 59.0 | 31.0 | 16 | 19 |

Male Run Tee Swivel (BSPP)

NOTE: Swivel for installation purposes only.
*M5 metric screw thread

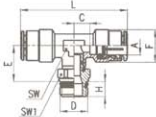
| Tube O.D. A (mm) | Thread Size BSP D | Catalog Number | C | E | F | H | L | M | SW | SW1 (mm) |
|------------------|-------------------|----------------|---|----|----|-----|------|----|----|----------|
| 4 | M5* | 1171x4Mx5MMS | 6 | 13 | 10 | 3.5 | 36.5 | 20 | 9 | 8 |
| 5 | M5* | 1171x5Mx5MMS | 6 | 13 | 11 | 3.5 | 37.5 | 21 | 9 | 8 |

Male Branch Tee Swivel (BSPT)

NOTE: Swivel for installation purposes only.

| Tube O.D. A (mm) | Thread Size BSP D | Catalog Number | C | E | F | H | L | SW | SW1 (mm) |
|------------------|-------------------|----------------|------|------|------|-----|----|----|----------|
| 4 | 1/8 | 1172x4Mx2PTS | 6.0 | 14.5 | 10.0 | 5.5 | 40 | 9 | 12 |
| 5 | 1/8 | 1172x5Mx2PTS | 6.0 | 14.5 | 11.0 | 5.5 | 42 | 9 | 12 |
| 5 | 1/4 | 1172x5Mx4PTS | 6.0 | 14.5 | 11.0 | 7.0 | 42 | 9 | 14 |
| 6 | 1/8 | 1172x6Mx2PTS | 6.5 | 15.0 | 12.7 | 5.5 | 44 | 10 | 12 |
| 6 | 1/4 | 1172x6Mx4PTS | 6.5 | 15.0 | 12.7 | 7.0 | 44 | 10 | 14 |
| 8 | 1/8 | 1172x8Mx2PTS | 7.5 | 16.0 | 15.0 | 5.5 | 50 | 12 | 12 |
| 8 | 1/4 | 1172x8Mx4PTS | 7.5 | 16.0 | 15.0 | 7.0 | 50 | 12 | 14 |
| 8 | 3/8 | 1172x8Mx6PTS | 7.5 | 16.5 | 15.0 | 8.0 | 50 | 12 | 19 |
| 10 | 1/4 | 1172x10Mx4PTS | 8.5 | 18.5 | 17.5 | 7.0 | 57 | 14 | 14 |
| 10 | 3/8 | 1172x10Mx6PTS | 8.5 | 19.0 | 17.5 | 8.0 | 57 | 14 | 19 |
| 12 | 1/4 | 1172x12Mx4PTS | 10.0 | 20.0 | 19.5 | 7.0 | 62 | 16 | 17 |
| 12 | 3/8 | 1172x12Mx6PTS | 10.0 | 20.0 | 19.5 | 8.0 | 62 | 16 | 19 |
| 12 | 1/2 | 1172x12Mx8PTS | 10.0 | 20.5 | 19.5 | 9.0 | 62 | 16 | 22 |

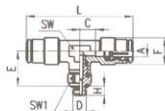
Male Branch Tee Swivel (BSPP)

NOTE: Swivel for installation purposes only.
*M5 metric screw thread

| Tube O.D. A (mm) | Thread Size BSP D | Catalog Number | C | E | F | H | L | SW | SW1 (mm) |
|------------------|-------------------|----------------|---|----|----|-----|----|----|----------|
| 4 | M5* | 1172x4Mx5MMS | 6 | 13 | 10 | 3.5 | 40 | 9 | 8 |
| 5 | M5* | 1172x5Mx5MMS | 6 | 13 | 11 | 3.5 | 42 | 9 | 8 |

NOTE: M5 has 0.8 mm thread pitch. M5 seals with nylon washer, included.