

Refer to safety information regarding tubing selection on page 1.

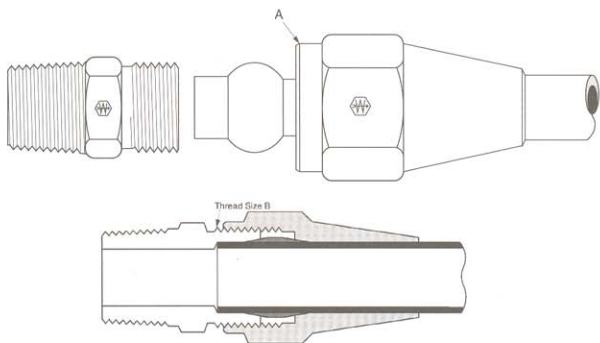

Tube O.D.	1/4	3/8	1/2	5/8	3/4	1
Thread Size-B	7/16-24	17/32-24	11/16-20	13/16-18	1-18	1-1/4-16

• Typical Application

Air brake systems.

• Pressure

Maximum operating pressure of 150 psi.

• Vibration

Fair resistance.

• Temperature Range

-65°F to +250°F (-53°C to +121°C) with copper tubing.

• Material

CA360 Brass.

• Used With

Copper tubing in air brake systems.

• Advantages

Easy to assemble (no flaring). May be used with nylon tubing by replacing long nut and spherical sleeve with insert, rigid sleeve and nut. See page 91 for details.

• Conformance

Meets specifications and standards of SAE and DOT.

• How to Order

For complete assemblies (body, nuts and sleeves), order by catalog number. Example: 1368x4. To order body only (less nut and sleeve), add prefix "B" to catalog number. Example: B1368x4. Nuts and sleeve can be ordered separately by catalog number.

To order complete assembly with pipe sealant (Seal-A-Thread), add suffix "Z" to catalog number. Example: 1368x4Z (special order only).

• NOTE

Refer to current price list for availability of cataloged items. Quotations and delivery of non-stock items supplied on request. Configurations and dimensions subject to change without notice. Additional information can be found in SAE J246.

• Assembly Instructions

1. Cut tubing to desired length. Make sure all burrs are removed and the ends are cut square.
2. Slide nut and then sleeve on tubing. Threaded end of nut "A" must face toward fitting body.
3. Insert tubing into fitting. Be sure tubing is bottomed on fitting shoulder.
4. Thread nut onto fitting body until it is hand tight.
5. From that point, tighten with a wrench the number of turns indicated in the chart below.

Tube Size	Additional Number of Turns from Hand Tight
1/4, 3/8	1-3/4
1/2, 5/8, 3/4	3-1/4

Label Set: **FS-800** (adhesive)
CL-491 (non-adhesive)

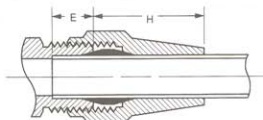

NOTE: H is hand tight dimensions.

Tube O.D.	E Tube Depth	H
1/4	.25	.58
3/8	.31	.87
1/2	.44	.95
5/8	.44	1.05
3/4	.56	1.25

Sleeve

(Ref. SAE No. 120115)



Tube O.D.	Catalog Number	D	F	L
1/4	1360x4	.255	.322	.250
3/8	1360x6	.382	.461	.313
1/2	1360x8	.507	.594	.375
5/8	1360x10	.632	.734	.438
3/4	1360x12	.758	.874	.500

Nut

(Ref. SAE No. 120111)

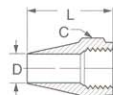

*Compressor Nut with V groove Hex.

Tube O.D.	Catalog Number	Hex C	D	L
1/4	1361x4	9/16	.256	.75
3/8	1361x6	5/8	.384	1.13
1/2	1361x8	13/16	.509	1.25
5/8	1361x10	15/16	.634	1.38
5/8	1361x10V*	1	.634	1.38
3/4	1361x12	1-1/8	.760	1.56

Union

(Ref. SAE No. 120101BA)

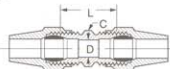

Tube O.D.	Catalog Number	Hex C	D	L
1/4	1362x4	7/16	.188	.85
3/8	1362x6	9/16	.312	1.10
1/2	1362x8	11/16	.406	1.31
5/8	1362x10	13/16	.531	1.43
3/4	1362x12	1	.656	1.60
1	1362x16	1-1/4	.875	1.78

Male Connector

(Ref. SAE No. 120102BA)

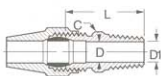

Tube O.D.	Male Pipe Thread	Catalog Number	Hex C	D	D1	L
1/4	1/8	1368x4	7/16	.188	.188	.88
1/4	1/4	1368x4x4	9/16	.188	.188	1.09
3/8	1/8	1368x6x2	9/16	.312	.188	1.02
3/8	1/4	1368x6	9/16	.312	.312	1.20
3/8	3/8	1368x6x6	11/16	.312	.406 opt.	1.23
3/8	1/2	1368x6x8	7/8	.312	.531 opt.	1.42
1/2	1/4	1368x8x4	11/16	.406	.312	1.32
1/2	3/8	1368x8	11/16	.406	.406	1.32
1/2	1/2	1368x8x8	7/8	.406	.531 opt.	1.51
5/8	3/8	1368x10x6	13/16	.531	.406	1.38
5/8	1/2	1368x10	7/8	.531	.531	1.57
3/4	1/2	1368x12	1	.656	.531	1.67
3/4	3/4	1368x12x12	1-1/16	.656	.719 opt.	1.70

Air Brake - Copper Tubing

**Brass
Fittings**

Female Connector (Ref. SAE No. 120103BA)

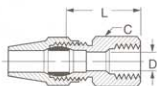

Tube O.D.	Fem. Pipe Thread	Catalog Number	Hex C	D	L
3/8	1/4	1366x6	11/16	.312	1.19
3/8	3/8	1366x6x6	7/8	.312	1.19
1/2	3/8	1366x8	7/8	.406	1.28

45° Male Elbow (Ref. SAE No. 120302BA)

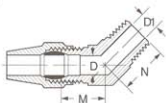

Tube O.D.	Male Pipe Thread	Catalog Number	D	D1	M	N
3/8	1/4	1380x6	.312	.312	.72	.86
3/8	3/8	1380x6x6	.312	.406	.76	.95
1/2	3/8	1380x8	.406	.406	.85	.95
5/8	1/2	1380x10	.531	.531	.94	1.17

Union Elbow (Ref. SAE No. 120201BA)

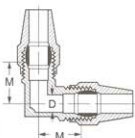

Tube O.D.	Catalog Number	M	D
3/8	1365x6*	.80	.312
1/2	1365x8*	.94	.406
5/8	1365x10*	1.10	.531

90° Male Elbow (Ref. SAE No. 120202BA)

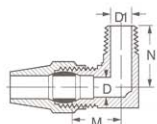

Tube O.D.	Male Pipe Thread	Catalog Number	D	D1	M	N
1/4	1/8	1369x4	.188	.188	.63	.67
1/4	1/4	1369x4x4	.188	.312	.69	.88
3/8	1/8	1369x6x2	.312	.188	.73	.75
3/8	1/4	1369x6	.312	.312	.80	.93
3/8	3/8	1369x6x6	.312	.406	.85	.92
3/8	1/2	1369x6x8	.312	.531	.95	1.11
1/2	1/4	1369x8x4	.406	.312	.87	1.00
1/2	3/8	1369x8	.406	.406	.94	1.00
1/2	1/2	1369x8x8	.406	.531	1.04	1.19
5/8	3/8	1369x10x6	.531	.406	1.01	1.06
5/8	1/2	1369x10	.531	.531	1.10	1.25

90° Male Elbow - Long

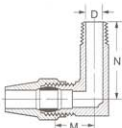

Tube O.D.	Male Pipe Thread	Catalog Number	D	M	N
3/8	1/8	1369x6x2L*	.188	.75	1.88
3/8	1/4	1369x6L	.312	.81	1.44
1/2	3/8	1369x8L	.406	1.25	1.38
3/4	1/2	1369x12L*	.531	1.31	1.81

*MTO - Made To Order

WEATHERHEAD®

99

0012-0000

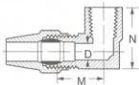
90° Female Elbow
(Ref. SAE No. 120203BA)

Tube O.D.	Fem. Pipe Thread	Catalog Number	D	M	N
1/2	3/8	1370x8*	.406	1.04	.83

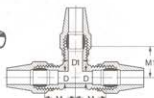
Union Tee
(Ref. SAE No. 120401BA)

Tube O.D.	Catalog Number	M	M1	D	D1
3/8	1364x6	.80	.80	.312	.312
3/8x3/8x1/2	1364x6x6x8*	.86	.86	.312	.406
1/2	1364x8	.94	.94	.406	.406

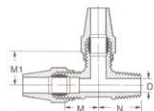
Male Run Tee
(Ref. SAE No. 120424BA)

Tube O.D.	Male Pipe Thread	Catalog Number	D	M	M1	N
3/8	1/4	1371x6	.312	.80	.80	.93
3/8	3/8	1371x6x6x6	.406	.85	.85	.92
1/2	3/8	1371x8*	.406	.94	.94	1.00

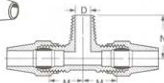
Male Branch Tee
(Ref. SAE No. 120425BA)

Tube O.D. A	Tube O.D. B	Male Pipe Thread	Catalog Number	D	M	N
3/8	3/8	1/8	1372x6x6x2*	.188	.73	.75
3/8	3/8	1/4	1372x6	.312	.80	.93
3/8	3/8	3/8	1372x6x6x6	.406	.85	.92
1/2	1/2	3/8	1372x8	.406	.94	1.00
5/8	1/2	1/2	1372x10x8x8*	.530	1.120	1.060

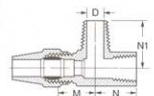
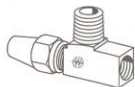
Adapter Tee

Tube O.D.	M&F Pipe Thread	Catalog Number	D	M	N	N1
3/8	1/4	1382x6x4x4*	.312	.88	.75	.94

Bulkhead Coupling (Brass)

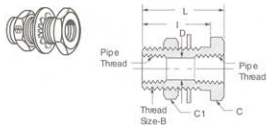

Fem. Pipe Thread	Catalog Thread	Thread Size B	Hex C	Hex C1	D	I	L
1/4	1344	3/4-16	1	15/16	.422	1.25	1.50
1/4	1345	3/4-16	1	15/16	.422	.69	.94
3/8	1346	1-14	1-1/8	1-3/8	.563	1.06	1.31
1/2	1351	1-1/8-14	1-1/4	1-3/8	.703	1.19	1.50

Bulkhead Coupling (Brass)

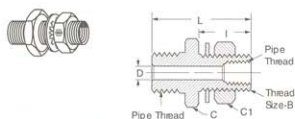

Male Pipe Thread	Fem. Pipe Thread	Catalog Number	Thread Size B	Hex C	Hex C1	D	I	L
1/2	1/4	1340	3/4-16	1-1/4	15/16	.312	1.13	2.16
1/2	1/4	1341	3/4-16	1-1/4	15/16	.312	1.53	2.53

Bulkhead Coupling (Brass)

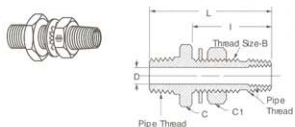

Male Pipe Thread	Fem. Pipe Thread	Catalog Number	Thread Size B	Hex C	Hex C1	D	I	L
1/2	1/4	1342	1-14	1-1/4	1-3/8	.375	1.88	2.94
1/2	1/4	1343	1-14	1-1/4	1-3/8	.375	2.88	3.94

Draincock

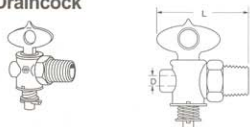

Male Pipe Thread	Catalog Number	D	L
1/4	W15310	.188	1.56

Shut Off Valve



Rating: 125 psi with one 1/4" bubble in 5 seconds permissible key leakage.

Male Pipe Thread	Fem. Pipe Thread	Catalog Number	Hex C	Hex C1	D	L
1/4	1/4	W20332	5/8	3/4	.218	1.81

External Seat Draincock

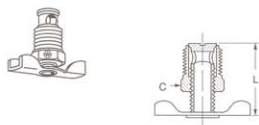

Male Pipe Thread	Catalog Number	Hex C	L
1/4	145	9/16	1.00