

# TWIN SERIES CLAMPS – ORDERING EXAMPLE

**\*\*AT4 – 26.9 – A**

CLAMP SET MATERIAL	
Polypropylene (Green)	AT
Polyamide*	MT
Rubber*	RT

\* SPECIAL ORDER

GROUP SIZE
Refer to Chart on Page 92

CLAMP SET ID
Refer to Chart on Page 92

DESCRIPTION	
<b>A</b>	Clamp with Weld Plate & Cover Plate
<b>SK</b>	Clamp with Stacking Kit
<b>R</b>	Clamp with Rail Nuts & Cover Plate
<b>■</b>	Clamp Set Only

CLAMP SET BORE
Pipe and tube clamp sizes have a profiled bore. For hose and special applications add "H" to the part number for a smooth bore.

\*\*"S" PREFIX = STAINLESS STEEL HARDWARE  
AVAILABLE BY SPECIAL ORDER ONLY.

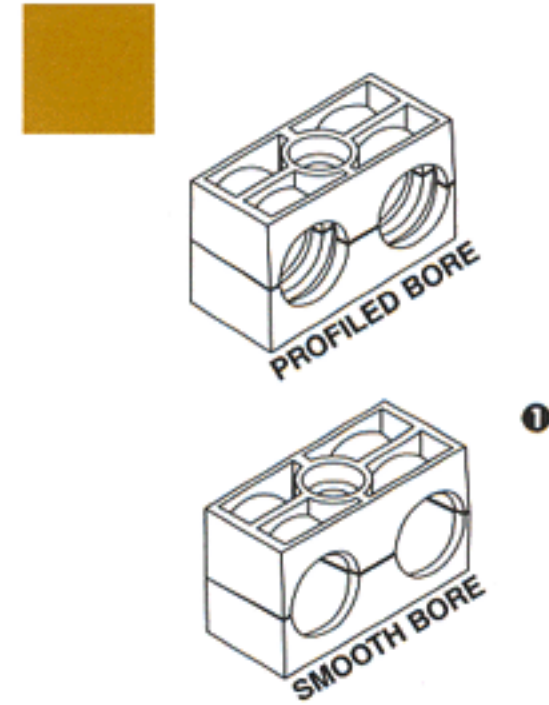
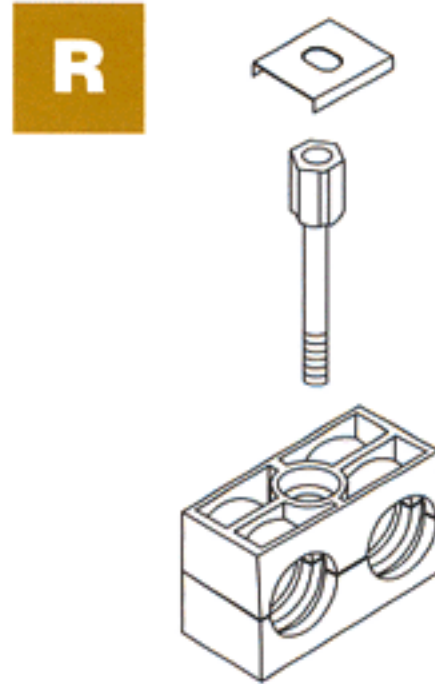
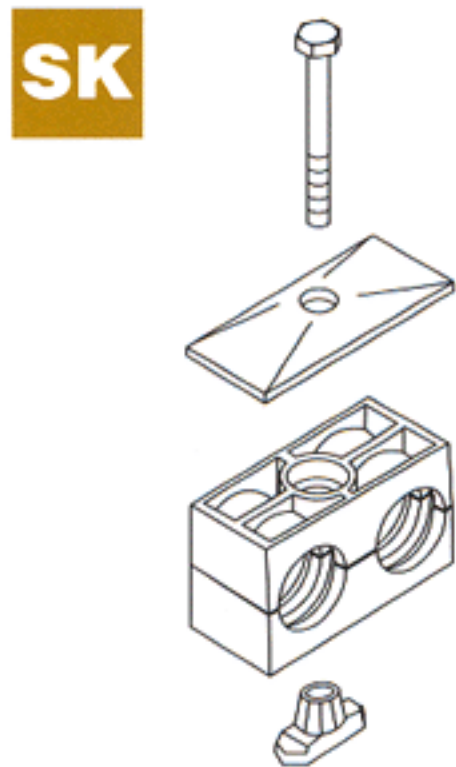
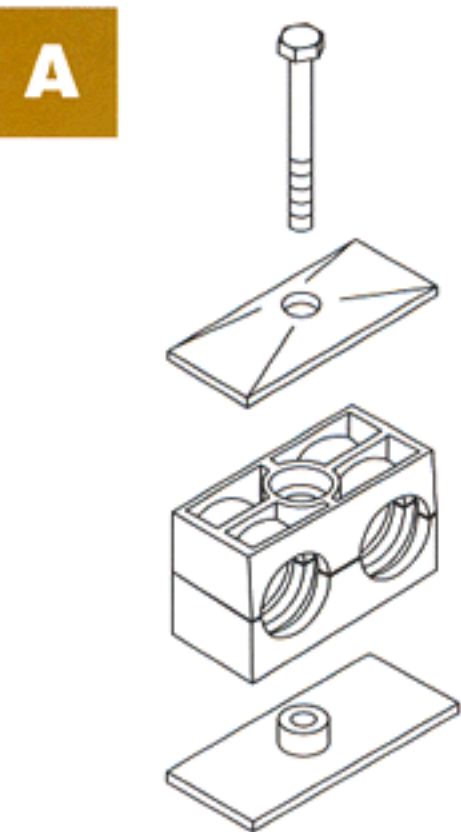

ⓘ NOT AVAILABLE IN ALL SIZES. CONTACT PCI FOR AVAILABILITY.



# TWIN SERIES – SIZES AND DIMENSIONS

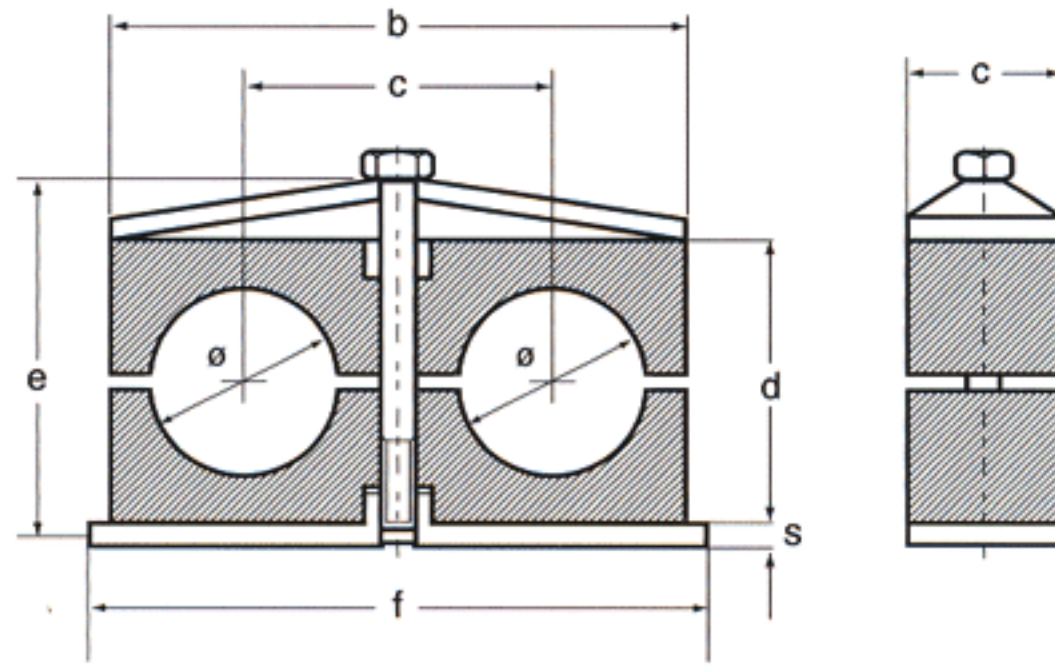

PCI		DIN		DIAMETER			DIMENSIONS						
GROUP	GROUP	Ø mm	Ø Inch	PIPE NOMINAL BORE	TUBE O.D.	PART #	A	B	C	D	F	S	H
1	1	6	0.24			AT1-06-A							
		6.4	0.25			1/4" AT1-6.4-A							
		8	0.31			5/16" AT1-08-A	30mm	37mm	20mm	25mm	37mm	3mm	35mm
		9.5	0.37			3/8" AT1-9.5-A	1.18"	1.46"	.79"	.98"	1.46"	.12"	1.36"
		10	0.39	1/8"		AT1-10-A							
		12	0.47			AT1-12-A							
2	2	12.7	0.50			1/2" AT2-12.7-A							
		13.5	0.53	1/4"		AT2-13.5-A							
		14	0.55			AT2-14-A							
		15	0.59			AT2-15-A	30mm	53mm	29mm	26mm	55mm	5mm	36mm
		16	0.63			5/8" AT2-16-A	1.18"	2.09"	1.14"	1.02"	2.17"	.20"	1.42"
		17.2	0.67	3/8"		AT2-17.2-A							
18	0.71			AT2-18-A									
3	3	19	0.75			3/4" AT3-19-A							
		20	0.79			AT3-20-A							
		21.3	0.84	1/2"		AT3-21.3-A	30mm	67mm	36mm	37mm	70mm	5mm	47mm
		22	0.87			7/8" AT3-22-A	1.18"	2.64"	1.42"	1.46"	2.76"	.20"	1.85"
		25	0.98			AT3-25-A							
		25.4	1.00			1" AT3-25.4-A							
4	4	26.9	1.06	3/4"		AT4-26.9-A	30mm	82mm	45mm	42mm	85mm	5mm	52mm
		28	1.10			AT4-28-A	1.18"	3.23"	1.77"	1.65"	3.35"	.20"	2.05"
		30	1.18			AT4-30-A							
5	5	32	1.25			1 1/4" AT5-32-A							
		33.7	1.33	1"		AT5-33.7-A							
		35	1.38			AT5-35-A							
		38	1.50			1 1/2" AT5-38-A	30mm	106mm	56mm	54mm	110mm	5mm	64mm
		40	1.57			AT5-40-A	1.18"	4.17"	2.20"	2.13"	4.33"	.20"	2.52"
		42	1.65			AT5-42-A							
42.4	1.67	1 1/4"		AT5-42.4-A									

ADD "S" PREFIX FOR STAINLESS STEEL HARDWARE. SPECIAL ORDER ONLY.



# TWIN SERIES – COMPONENTS

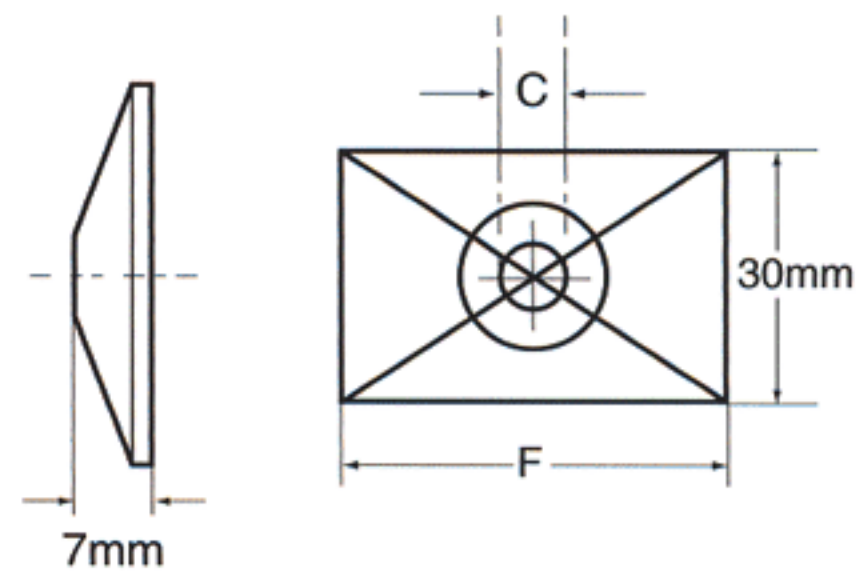
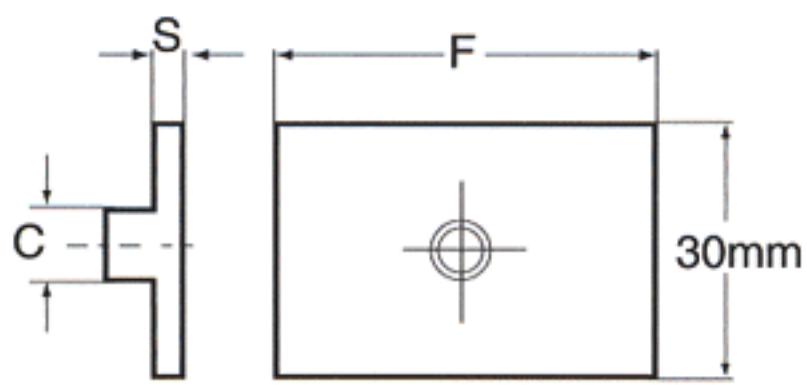

## WELD PLATE

## COVER PLATE

GROUP	PART NUMBER	DIMENSIONS			PART NUMBER	DIMENSIONS	
		F	C	S		F	C
1	WPT1	37mm 1.46"	12mm 0.79"	3mm 0.12"	CPT1	35mm 1.38"	7mm 0.28"
2	WPT2	55mm 2.17"	14mm 0.55"	5mm 0.20"	CPT2	52mm 2.05"	9mm 0.35"
3	WPT3	70mm 2.76"	14mm 0.55"	5mm 0.20"	CPT3	66mm 2.60"	9mm 0.35"
4	WPT4	85mm 3.35"	14mm 0.55"	5mm 0.20"	CPT4	81mm 3.19"	9mm 0.35"
5	WPT5	110mm 4.33"	14mm 0.55"	5mm 0.20"	CPT5	105mm 4.13"	9mm 0.35"

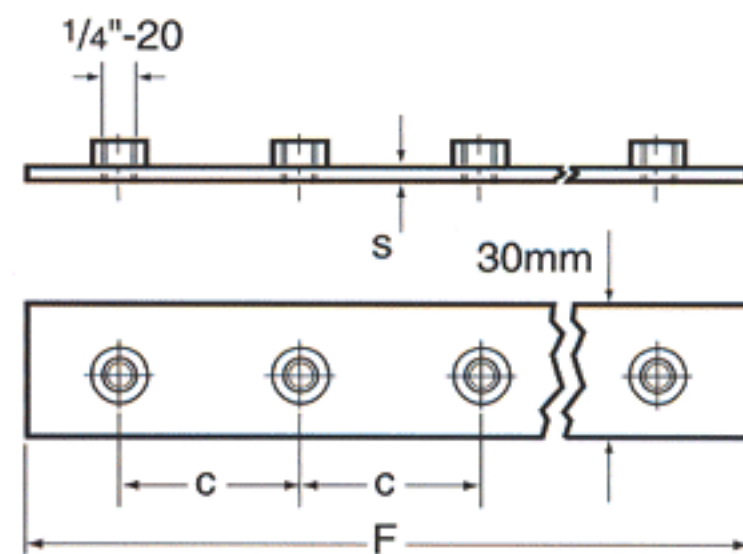
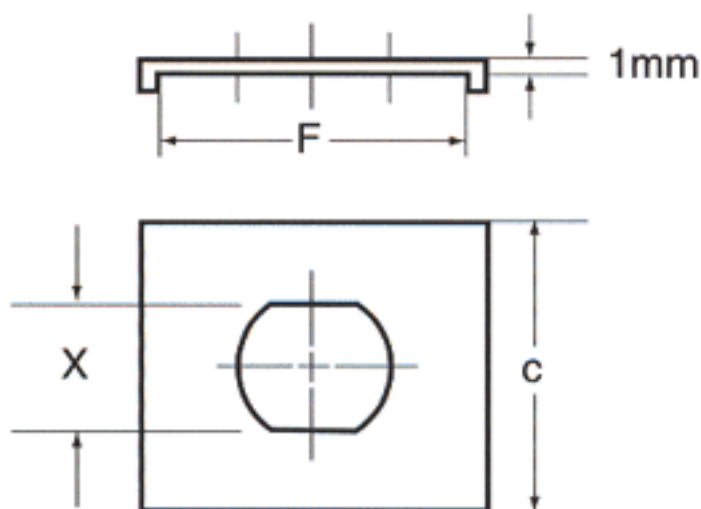

## SECURITY PLATE

## MULTIPLE WELD PLATE

GROUP	PART NUMBER	DIMENSIONS			PART NUMBER	DIMENSIONS			NUMBER OF CLAMPS PER PLATE
		F	C	X		F	C	S	
1	SPT1	30mm 1.18"	30mm 1.18"	11mm 0.43"	MWPT1	200mm 7.87"	40mm 1.57"	3mm 0.12"	5
2	SPT2	30mm 1.18"	30mm 1.18"	13mm 0.51"	MWPT2	290mm 11.42"	58mm 2.28"	5mm 0.20"	5
3	SPT3	30mm 1.18"	30mm 1.18"	13mm 0.51"	MWPT3	360mm 14.17"	72mm 2.83"	5mm 0.20"	5
4	SPT4	30mm 1.18"	30mm 1.18"	13mm 0.51"	MWPT4	450mm 17.72"	90mm 3.54"	5mm 0.20"	5
5	SPT5	30mm 1.18"	30mm 1.18"	13mm 0.51"	MWPT5	560mm 22.05"	112mm 4.41"	5mm 0.20"	5



# TWIN SERIES – COMPONENTS

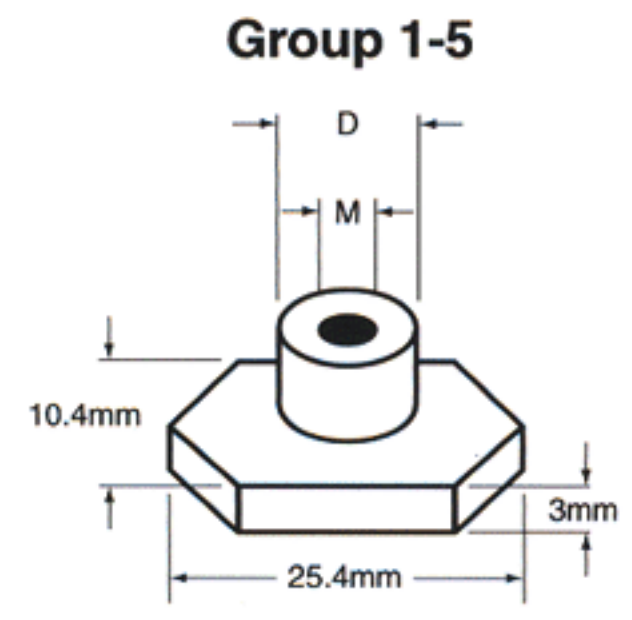
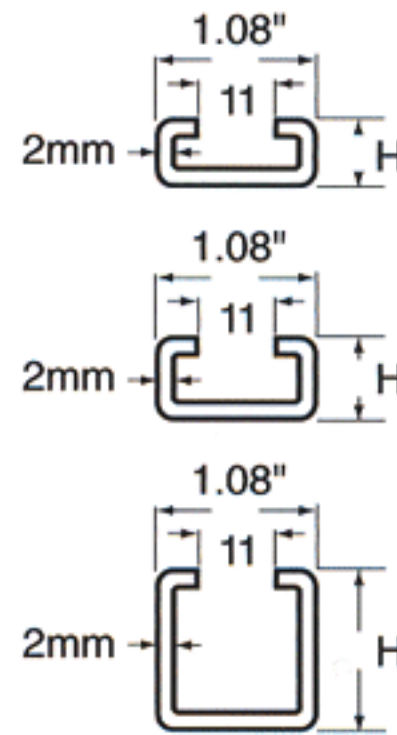

GROUP	HEX HEAD BOLT	STACKING BOLT	MOUNTING RAIL		RAIL NUT	
	PART NUMBER SIZE	PART NUMBER SIZE	PART NUMBER HEIGHT H	PART NUMBER LENGTH L	PART NUMBER M	PART NUMBER D
<b>1</b>	HB2/T1 1/4"-20 x 13/8"	SBT/1 1/4"-20 x .79"	MR-11-2 11 0.43	2M 6.56	RNS/T1 1/4"-20	12mm 0.47"
<b>2</b>	HBT/2 5/16"-18 x 13/8"	SBT/2 5/16"-18 x .79"	MR-14-1 14 0.55	1M 3.28	RNT2/5 5/16"-18	14mm 0.55"
<b>3</b>	HBT/3 5/16"-18 x 13/4"	SBT/3 5/16"-18 x 1.14"	MR-14-2 14 0.55	1M 6.56		
<b>4</b>	HBT/4 5/16"-18 x 2"	SBT/4 5/16"-18 x 1.34"	MR-30-1 30 1.18	1M 3.28		
<b>5</b>	HBT/5 5/16"-18 x 2 1/2"	SBT/5 5/16"-18 x 1.85"	MR-30-2 30 1.18	2M 6.56		