

Bulkhead Coupling (Brass)

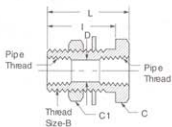

Fem. Pipe Thread	Catalog Thread	Thread Size B	Hex C	Hex C1	D	I	L
1/4	1344	3/4-16	1	15/16	.422	1.25	1.50
1/4	1345	3/4-16	1	15/16	.422	.69	.94
3/8	1346	1-14	1-1/8	1-3/8	.563	1.06	1.31
1/2	1351	1-1/8-14	1-1/4	1-3/8	.703	1.19	1.50

Bulkhead Coupling (Brass)

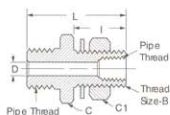

Male Pipe Thread	Fem. Pipe Thread	Catalog Number	Thread Size B	Hex C	Hex C1	D	I	L
1/2	1/4	1340	3/4-16	1-1/4	15/16	.312	1.13	2.16
1/2	1/4	1341	3/4-16	1-1/4	15/16	.312	1.53	2.53

Bulkhead Coupling (Brass)

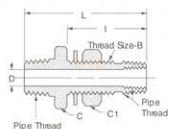

Male Pipe Thread	Fem. Pipe Thread	Catalog Number	Thread Size B	Hex C	Hex C1	D	I	L
1/2	1/4	1342	1-14	1-1/4	1-3/8	.375	1.88	2.94
1/2	1/4	1343	1-14	1-1/4	1-3/8	.375	2.88	3.94

Draincock

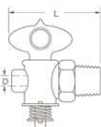

Male Pipe Thread	Catalog Number	D	L
1/4	W15310	.188	1.56

Shut Off Valve

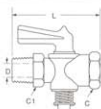

Rating: 125 psi with one 1/4" bubble in 5 seconds permissible key leakage.

Male Pipe Thread	Fem. Pipe Thread	Catalog Number	Hex C	Hex C1	D	L
1/4	1/4	W20332	5/8	3/4	.218	1.81

External Seat Draincock

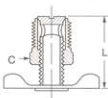

Male Pipe Thread	Catalog Number	Hex C	L
1/4	145	9/16	1.00

SAE 45° Flare Straightway

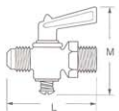

Tube O.D.	Male Pipe Thread	Catalog Number	L	M
1/4	1/8	537	2.00	1.88
5/16	1/8	632	2.03	1.88
5/16	1/4	702	2.03	1.88
3/8	1/4	703	2.06	1.88

Compression Double

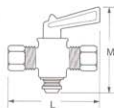

"S" suffix designates Selfalign® with Nuts and Sleeves.

Tube O.D.	Catalog Number	L	M
1/4	A6769	2.12	1.88
1/4	A6769S	2.12	1.88
5/16	A6774	2.19	1.88
3/8	A6779	2.25	1.88
3/8	A6779S	2.25	1.88

Compression Straightway

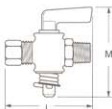

"S" suffix designates Selfalign® with Nuts and Sleeves.

Tube O.D.	Male Pipe Thread	Catalog Number	L	M
1/4	1/8	A694	2.19	1.88
1/4	1/8	A694S	2.19	1.88
1/4	1/4	A6754	2.19	1.88
1/4	1/4	A6754S	2.19	1.88
5/16	1/8	A664	2.19	1.88
5/16	1/4	A6759	2.25	1.88
3/8	1/4	A6764	2.38	1.88
3/8	1/4	A6764S	2.38	1.88

Male to Female Pipe

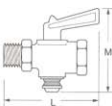

Male Pipe Thread	Female Pipe Thread	Catalog Number	L	M
1/8	1/8	6824	2.00	1.88
1/4	1/4	6829	2.12	1.88

Truck Shut Off Male to Female Pipe

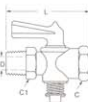

Male Pipe Thread	Female Pipe Thread	Catalog Number	Hex C	Hex C1	L	D
1/4	1/4	W20332	5/8	3/4	1.96	.219

Ratings: Valves are designed to hold air pressure of 125 psi with one 1/4" bubble in 5 seconds permissible key leakage.